

Adapters, In-Series

SMA, DC - 18GHz, Flange Mount



SPECIFICATIONS:

Models: 5313

Electrical:

Frequency Range _____ DC - 18.0 GHz
 VSWR
 DC - 4 GHz _____ 1.10:1 Max.
 4 - 8 GHz _____ 1.15:1 Max.
 8 - 18 GHz _____ 1.25:1 Max.
 Impedance _____ 50 Ohms
 Operating Temp Range _____ -65°C to +125°C

Mechanical:

Connectors _____ Passivated Stainless Steel
 (Mates with MIL-STD-348)
 Conductors _____ Gold Plated Beryllium Copper

Model Number: **5313**
 Female/Female Connector

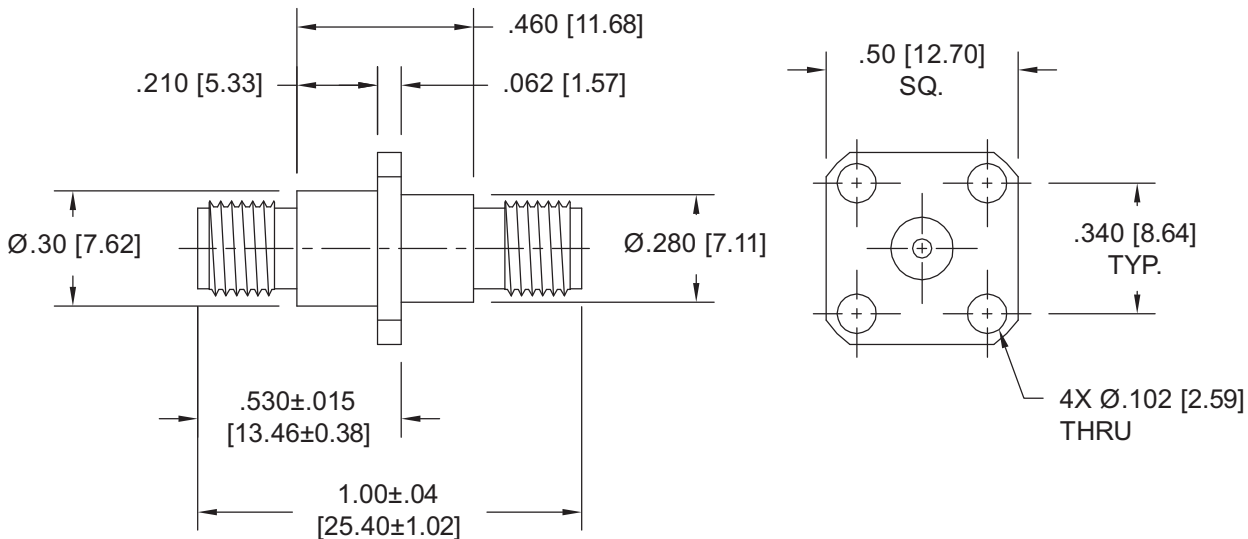

Note: Dimensions in Brackets are Expressed in Millimeters and are for Reference Only.
 Design specifications are subject to change without notice.
 Contact factory for technical specifications before purchasing or use.

5313: REV G



Aeroflex / Inmet, Inc. • 300 Dino Drive, Ann Arbor, MI 48103 • U.S.A.
 888-244-6638 or 734-426-5553 • FAX: 734-426-5557
 www.aeroflex.com/inmet • inmet@aeroflex.com