

# ADAPTERS, IN-SERIES

## 2.9mm, DC - 26.5 GHz, Flange Mount

### SPECIFICATIONS:

Models: 5338

**RoHS**  
Compliant

<b>Electrical:</b>	
Frequency Range	_____ DC - 26.5 GHz
VSWR	
DC - 18 GHz	_____ 1:15:1 Max.
18 - 26.5 GHz	_____ 1:25:1 Max.
Impedance	_____ 50 Ohms
Operating Temp Range	_____ -65°C to +125°C
<b>Mechanical:</b>	
Connectors	_____ Passivated Stainless Steel
Mates both Mechanically and Electrically with SMA, 3.5mm and K* Series Connectors	
Conductors	_____ Gold Plated Beryllium Copper

\* K is a Trademark of Anritsu Corp.



Model Number: **5338**  
Female/Female Connector

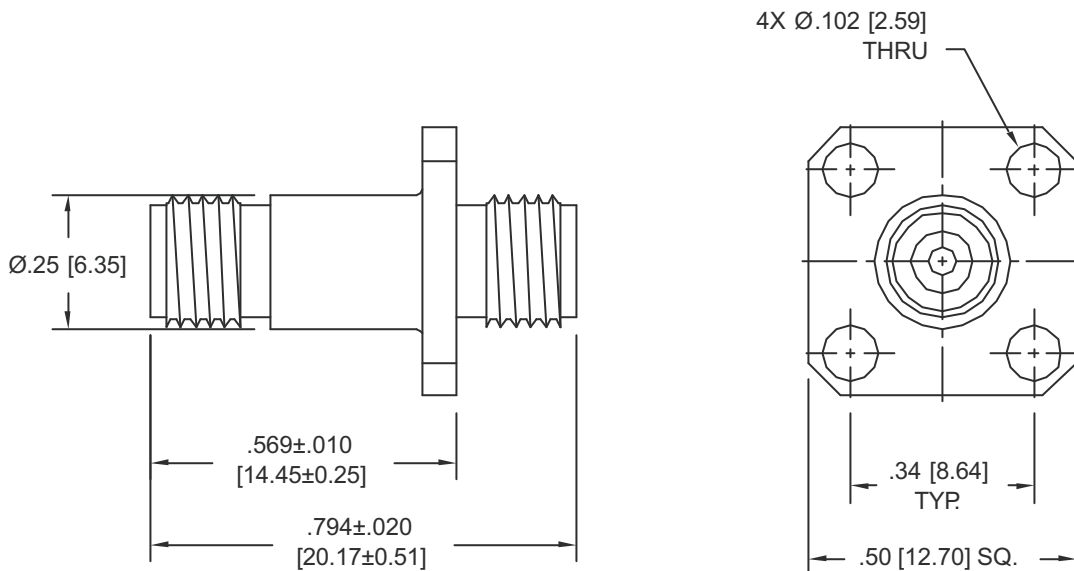

Note: Dimensions in Brackets are Expressed in Millimeters and are for Reference Only.

5338: REV B



Aeroflex / Inmet, Inc. • 300 Dino Drive, Ann Arbor, MI 48103 • U.S.A.  
888-244-6638 or 734-426-5553 • FAX: 734-426-5557  
www.aeroflex.com/inmet • inmet@aeroflex.com