

# DC BLOCK

7/16 DIN, 300 MHz - 2.5 GHz, Inner Only

## SPECIFICATIONS:

Models: 8100

**RoHS**  
Compliant

<b>Electrical:</b>	
Frequency Range	300 MHz - 2.5 GHz
VSWR	1.20:1 Max.
Impedance	50 Ohms
Insertion Loss	0.1 dB Max.
Voltage Rating	100 Volts Max.
RF Power, CW	500 Watts
RF Power, Peak	1000 Watts
Isolation	73dB Typical @ 1 KHz
Operating Temp. Range	-65°C to +125°C
<b>Mechanical:</b>	
7/16 - DIN Connectors	Silver Plated Brass <small>IAW DIN 47 223</small>
Conductors	Silver Plated Beryllium Copper



Model Number: 8100

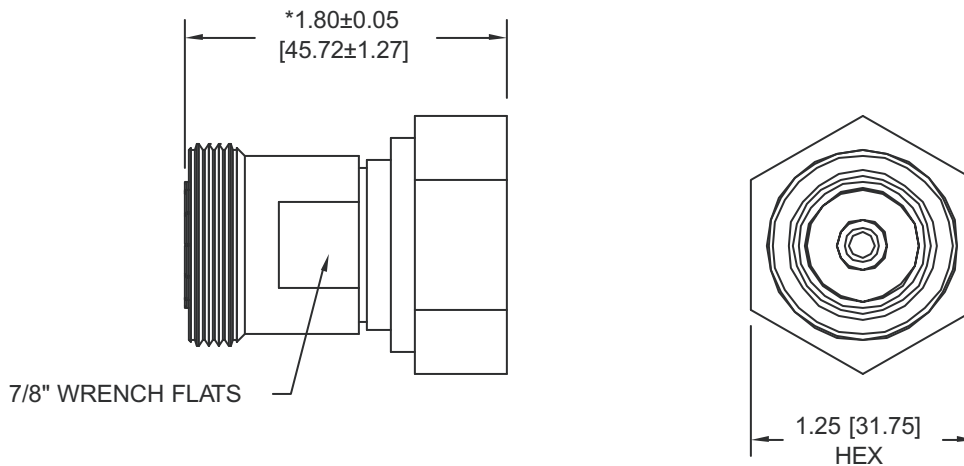

\*Dimension Occurs with Nut Biased Forward

Note: Dimensions in Brackets are Expressed in Millimeters and are for Reference Only.

8100: REV-



Aeroflex / Inmet, Inc. • 300 Dino Drive, Ann Arbor, MI 48103 • U.S.A.  
888-244-6638 or 734-426-5553 • FAX: 734-426-5557  
www.aeroflex.com/inmet • inmet@aeroflex.com