

DC BLOCK

7/16 DIN, 800 MHz - 2.8 GHz, Inner Only

SPECIFICATIONS:

Models: 8550

RoHS
Compliant

Electrical:

Frequency Range _____ 800 MHz - 2.8 GHz
VSWR _____ 1.20:1 Max.
Impedance _____ 50 Ohms
Insertion Loss _____ 0.2 dB Max.
Voltage Rating _____ 3000 Volts Max.
RF Power, CW _____ 500 Watts
RF Power, Peak _____ 1000 Watts
Isolation _____ 64dB Typical @ 1 KHz
Operating Temp. Range _____ -65°C to +125°C

Mechanical:

7/16 - DIN Connectors _____ Silver Plated Brass
IAW DIN 47 223
Conductors _____ Silver Plated Beryllium Copper



Model Number: **8550**

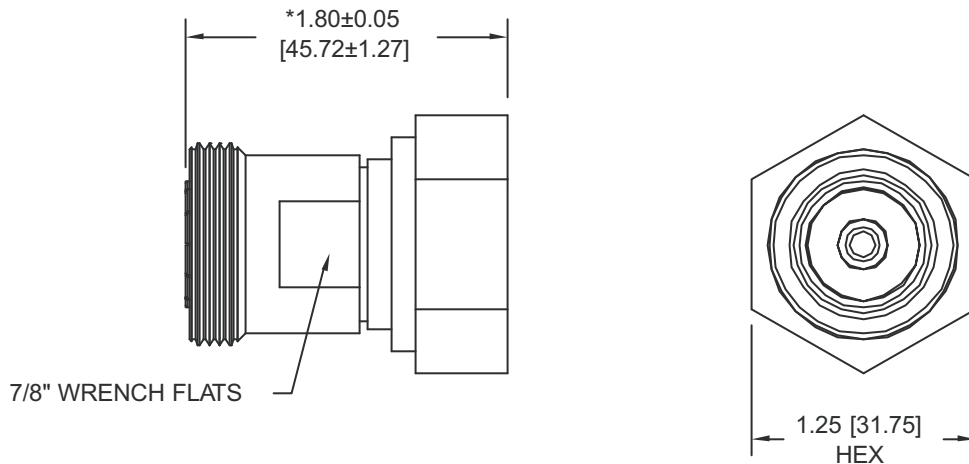

*Dimension Occurs with Nut Biased Forward

Note: Dimensions in Brackets are Expressed in Millimeters and are for Reference Only.

8550: REV-



Aeroflex / Inmet, Inc. • 300 Dino Drive, Ann Arbor, MI 48103 • U.S.A.
888-244-6638 or 734-426-5553 • FAX: 734-426-5557
www.aeroflex.com/inmet • inmet@aeroflex.com