

TERMINATIONS

SMA, up to 6.0 GHz, 100 Watts

SPECIFICATIONS:

Models: TSXXXM-100W & TSXXXF-100W

RoHS
Compliant

AEROFLEX
A passion for performance.

Electrical:

Frequency Range _____ DC - 6.0 GHz
 Standard Freq. Values _____ 2.5 & 6 GHz
 VSWR
 DC - 1.5 GHz _____ 1.20:1 Max.
 1.5 - 2.5 GHz _____ 1.30:1 Max.
 2.5 - 6.0 GHz _____ 1.40:1 Max.
 Input Power _____ 100 Watts Avg.
Derated Linearly to 20 Watts @ +125°C
 Peak Power _____ 1 kW Max.
(5uSec Pulse, .05% Duty Cycle)
 Impedance _____ 50 Ohms
 Operating Temp. Range _____ -55°C to +125°C

Mechanical:

SMA Connectors _____ Passivated Stainless Steel
Mates with MILSTD-348
 Conductors _____ Gold Plated Beryllium Copper
 Housing _____ Anodized Aluminum

Custom Mtg. hole Config.
may be Added to this
Surface.

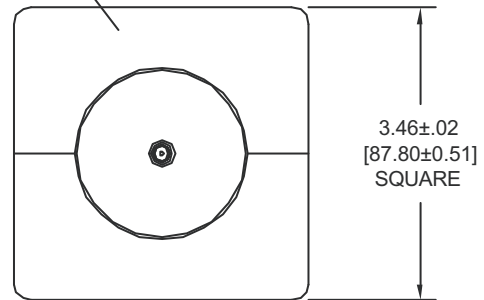

END VIEW
TYPICAL

Model Number: TSXXXF-100W
 SMA Female Connector
 Length: 5.25 ±.05 [133.4 ±1.3]
 Pictured

Model Number: TSXXXM-100W
 SMA Male Connector
 Length: 5.38 ±.05 [136.7 ±1.3]

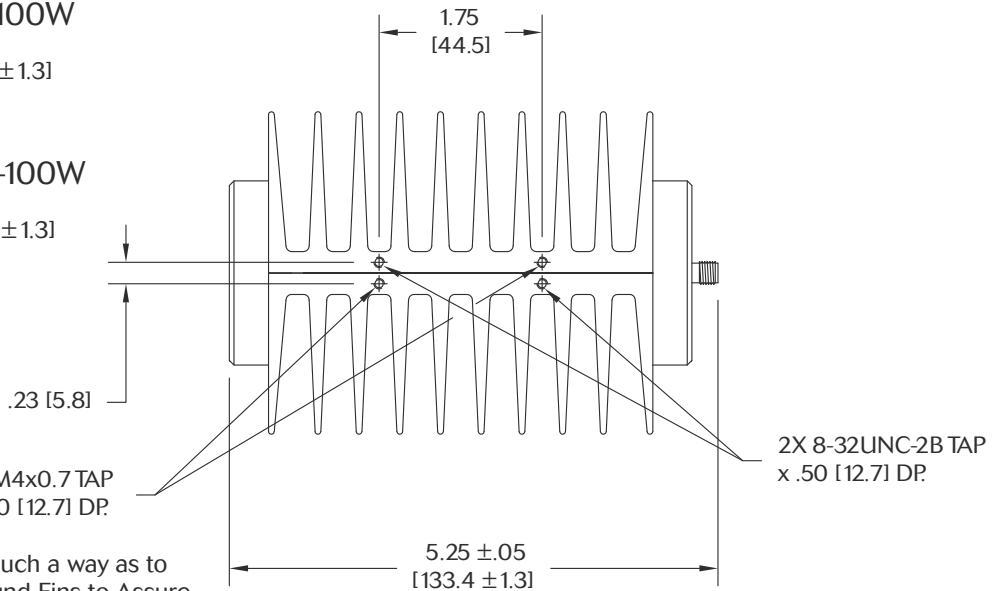

Units must be Mounted in such a way as to
 Allow for Free Air Flow Around Fins to Assure
 Performance

HOW TO ORDER:

Model Number: TSXXX \overline{Y} -100W

Freq. Range | Connector Configuration
 020 = DC - 2.5 GHz | F = Female
 060 = DC - 6 GHz | M = Male

Ordering Examples:

Model Number: TS020M-100W
 DC - 2.5 GHz, SMA Male CONN.

Model Number: TS060F-100W
 DC - 6 GHz, SMA Female CONN.

Note: Dimensions in Brackets are Expressed in Millimeters and are for Reference Only.
 Design specifications are subject to change without notice.
 Contact factory for technical specifications before purchasing or use.

TSXXX \overline{Y} -100W: REV F



Aeroflex / Inmet, Inc. • 300 Dino Drive, Ann Arbor, MI 48103 • U.S.A.
 888-244-6638 or 734-426-5553 • FAX: 734-426-5557
 www.aeroflex.com/inmet • inmet-sales@eroflex.com