

4mm Full Safety Spade Terminal

Features

- UL/CSA Compliant
- Accepts All Industry Standard 4mm Test Lead Plugs
- Tiered Spade Opening Accommodates a Variety of Test Point Sizes



NTE Type No.	Color	Diag No.
72-026	Black	TL-017
72-027	Red	TL-017
NEW 72-027-KIT	Contains 1 ea. of 72-026 & 72-027	

TL-017

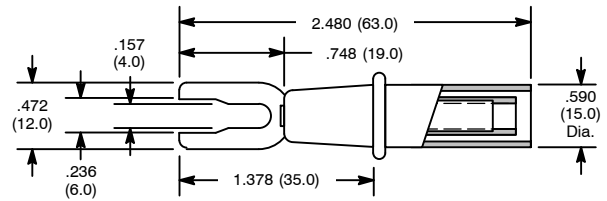

Specifications

IEC 1010 Rating: 1000V CAT3 / 600V CAT4 □ 20 Amps

4mm to 4mm Safety Plug Adaptor

Features

- Accepts All Industry Standard 4mm Test Lead Plugs
- Adapts Old Style Non Shrouded Sockets to Accept Full Safety Shrouded Plugs



NTE Type No.	Color	Diag No.
72-028	Black	TL-018
72-029	Red	TL-018
NEW 72-029-KIT	Contains 1 ea. of 72-028 & 72-029	

TL-018

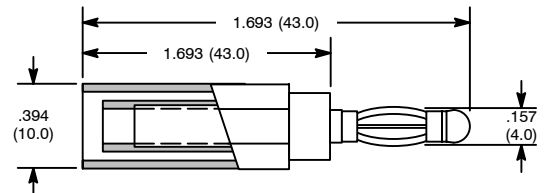

4mm to 4mm Coupler

Features

- Ideal for Connecting Two Test Leads Together
- Standard Colors: Black, Red



NTE Type No.	Color	Diag No.
72-051	Black	TL-020
72-052	Red	TL-020
NEW 72-052-KIT	Contains 1 ea. of 72-051 & 72-052	

TL-020

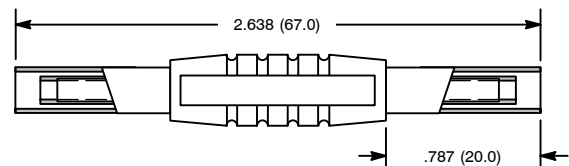

Specifications

IEC 1010 Rating: 1000V CAT3 □ 10 Amps

DIN Rail Terminal Test Adaptor

Features

- Enables DIN Rail Mounted Terminals to Accept 4mm Test Leads
- Adaptor Screws into Current Bar and Allows Easy and Convenient Access
- Uses M3 Thread Connection

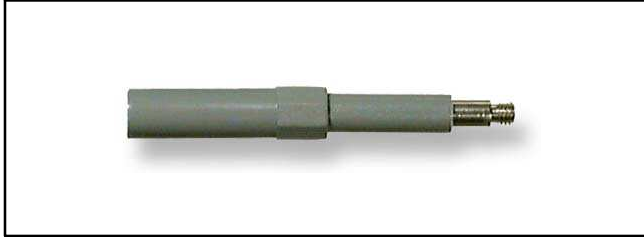

NTE Type No.	Color	Diag No.
72-030	Grey	TL-019

TL-019

