

# Customer Information Sheet

DRAWING No.: M22-307XX00

SHEET 2 OF 2

IF IN DOUBT - ASK

©

NOT TO SCALE

THIRD ANGLE PROJECTION

ALL DIMENSIONS IN mm

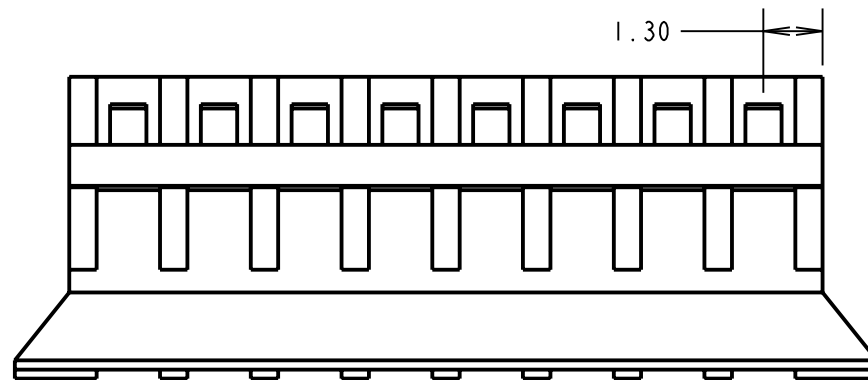
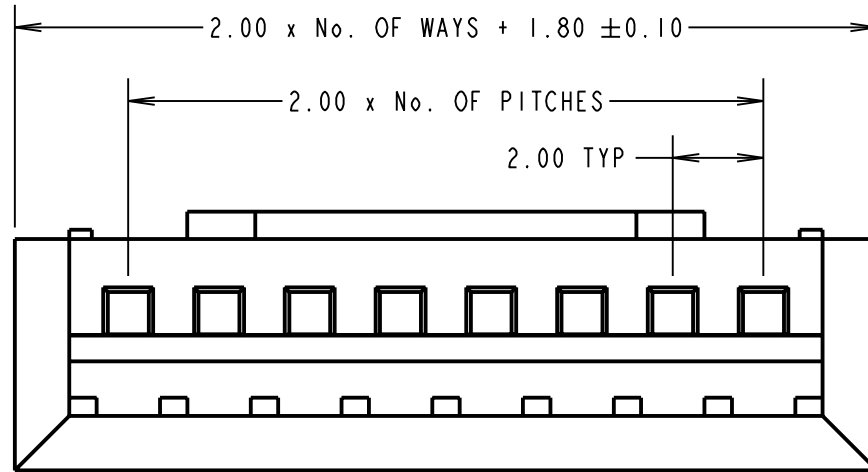

## SPECIFICATIONS

### MATERIAL:

NYLON 66 UL94V-0

### ELECTRICAL:

VOLTAGE RATING = 100V AC/DC

CURRENT RATING = 1A

DIELECTRIC WITHSTANDING = 800V AC/MINUTE

INSULATION RESISTANCE = 1000MΩ/MINUTE

### ENVIRONMENTAL

TEMPERATURE RANGE = -25°C TO +95°C

FOR COMPLETE SPECIFICATION, SEE COMPONENT SPECIFICATION C018XX (LATEST ISSUE)

## NOTES:

1. THIS MOULDING ACCEPTS M22-306006 AND M22-308006 CRIMP TERMINALS.
2. THE ABOVE SPECIFICATIONS APPLY WHEN USED WITH CRIMP TERMINALS M22-306006 AND M22-308006.
3. ALL TOLERANCES  $\pm 0.20$  UNLESS OTHERWISE STATED.

ORDER CODE:

**M22-307XX00**

No. OF WAYS   
02 TO 15

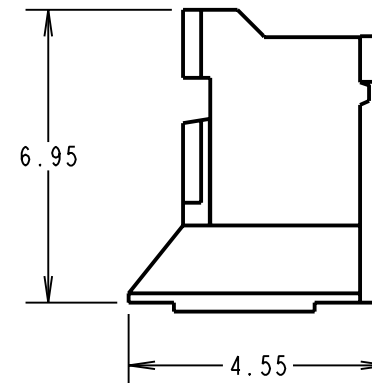

SM	5	21.04.10	10753
NAME	ISS.	DATE	C/NOTE
APPROVED: S. MCCULLAGH			
CHECKED:		R. ADDE	
DRAWN:		D. BECK	
CUSTOMER REF.:			
ASSEMBLY DRG:			

# HARWIN

HARWIN USA  
TEL: 603 893 5376  
FAX: 603 893 5396  
mis@harwin.com

HARWIN Europe (UK)  
TEL: 023 9231 4545  
FAX: 023 9231 4590  
mis@harwin.co.uk

HARWIN Asia  
TEL: +65 6 779 4909  
FAX: +65 6 779 3868  
mis@harwin.com.sg

THIS DRAWING AND ANY INFORMATION OR DESCRIPTIVE MATTER SET OUT HEREON ARE CONFIDENTIAL AND COPYRIGHT PROPERTY OF THE HARWIN GROUP AND MUST NOT BE DISCLOSED, LOANED, COPIED OR USED FOR MANUFACTURING, TENDERING OR FOR ANY OTHER PURPOSE WITHOUT THEIR WRITTEN PERMISSION.

**TOLERANCES**  
~~X = ±1mm  
 X.X = ±0.25mm  
 X.XX = ±0.10mm  
 X.XXX = ±0.01mm  
 ANGLES = ±5°  
 UNLESS STATED~~

MATERIAL:

SEE ABOVE

FINISH: CLEAN

S/AREA:

mm<sup>2</sup>

TITLE:

2mm CRIMP TERMINAL MOULDING

DRAWING NUMBER:

**M22-307XX00**

SHT  
2  
OF  
2