

Customer Information Sheet

DRAWING No.: M80-400000FS-XX-XXX-00-000

SHEET 2 OF 2

IF IN DOUBT - ASK

©

NOT TO SCALE

THIRD ANGLE PROJECTION

ALL DIMENSIONS IN mm

SPECIFICATIONS:

MATERIAL:
 MOULDING: GLASS FILLED PPS, UL94V-0, BLACK
POWER & COAX CONTACT:
 BODY = COPPER ALLOY
 INNER CONTACT, LATCHING COLLAR = BERYLLIUM COPPER
 INSULATOR = PTFE
 JACKSCREW, CIRCLIP: STAINLESS STEEL
FINISH:
 POWER & COAX CONTACT
 BODY, SLEEVE, INNER CONTACT = GOLD
 LATCHING COLLAR: = NICKEL
ELECTRICAL:
 WORKING VOLTAGE = 800V AC/DC
 VOLTAGE PROOF = 1200V AC/DC
 INSULATION RESISTANCE = 100MΩ MIN
POWER CONTACT:
 CONTACT RESISTANCE = 6mΩ MAX
 CURRENT RATING = M80-325 20A MAX 12AWG,
 M80-326 15A MAX 14AWG, M80-327 10A MAX 16AWG,
 M80-328 8A MAX 18AWG, M80-329 5A MAX 20AWG,
 M80-32A 20A MAX 12AWG, M80-32B 15A MAX 14AWG,
 M80-32C 10A MAX 16AWG, CONTACT AS SPECIFIED
COAX CONTACT:
 FREQUENCY RANGE = 6GHz
 IMPEDANCE = 50 Ω
 V.S.W.R = 1.05 + (0.04 x FREQUENCY) GHz MAX
 CONTACT RESISTANCE 6 mΩ MAX
 INSULATION RESISTANCE = 10⁶MΩ @250V AC
 OPERATING VOLTAGE = 180V AC @ 500mA
 MAXIMUM VOLTAGE = 1000V AC
MECHANICAL:
 DURABILITY = 500 OPERATIONS
POWER & COAX CONTACT:
 INSERTION FORCE = 5N MAX
 WITHDRAWAL FORCE = 0.5N MIN
ENVIRONMENTAL:
 TEMPERATURE RANGE = -55°C TO +125°C
PACKING:
 BAG
 FOR COMPLETE SPECIFICATION SEE COMPONENT SPECIFICATION C005XX (LATEST ISSUE)

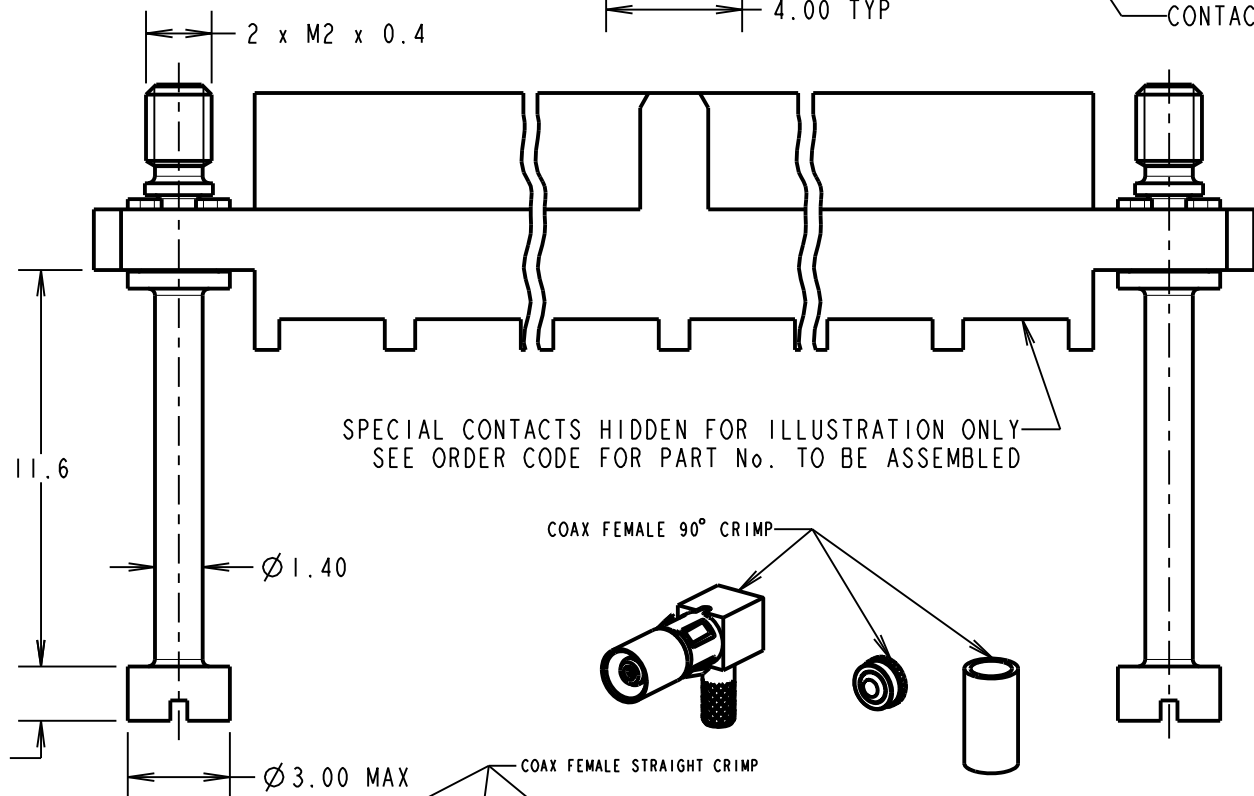
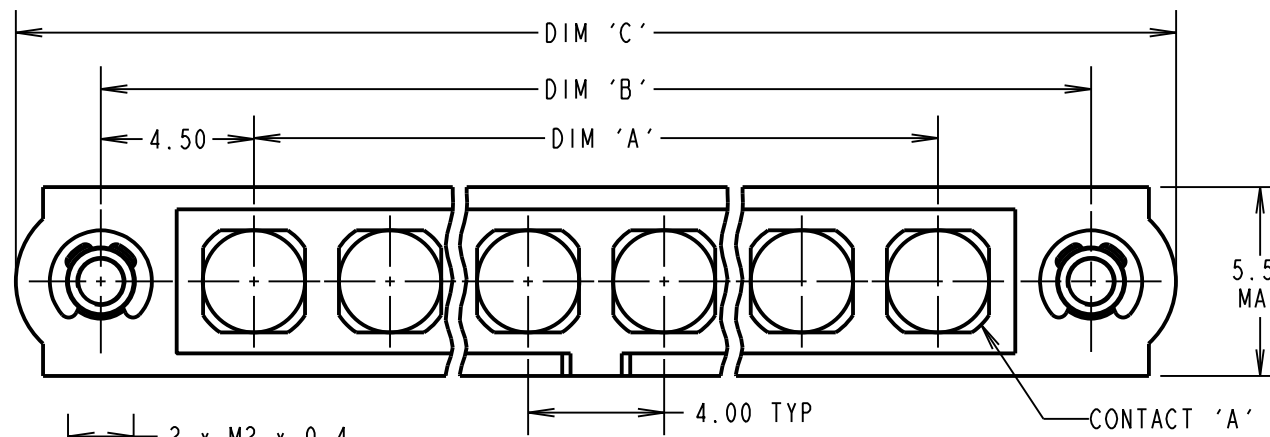

SPECIAL CONTACTS HIDDEN FOR ILLUSTRATION ONLY
 SEE ORDER CODE FOR PART No. TO BE ASSEMBLED

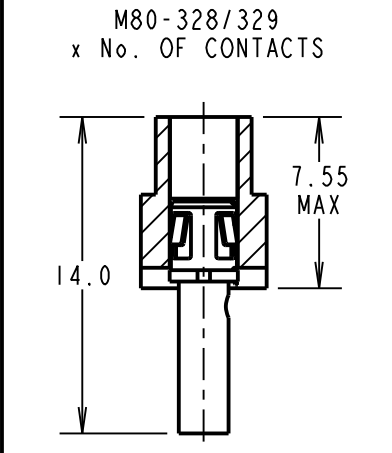
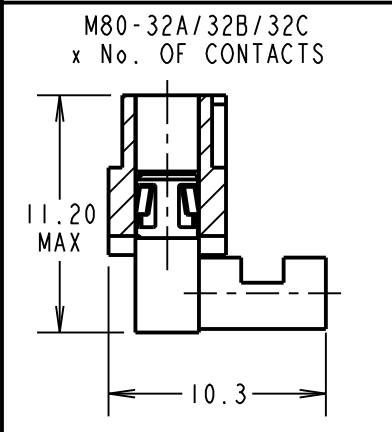
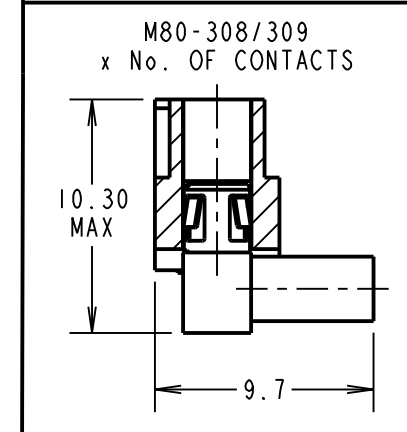
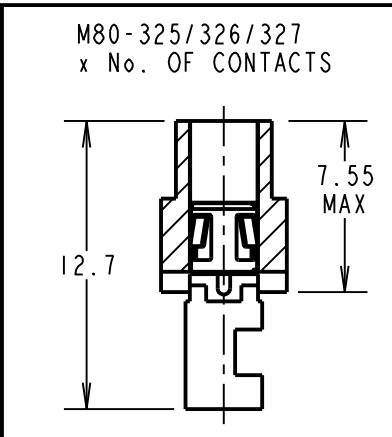
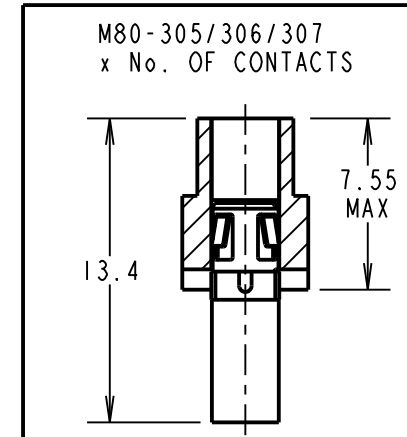
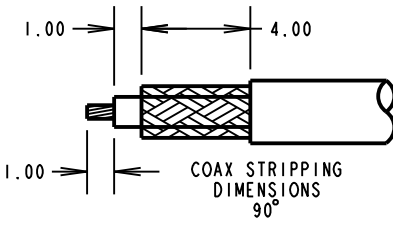
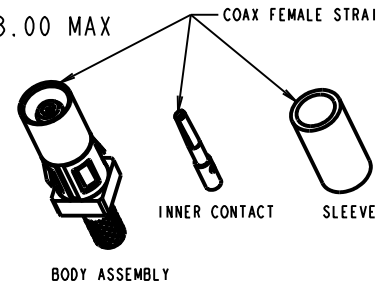
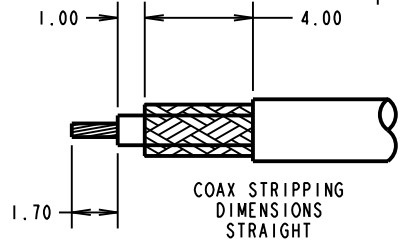
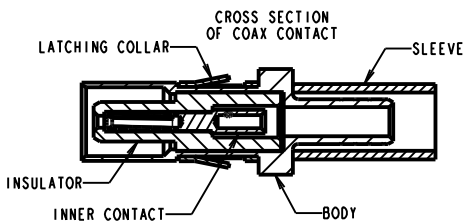
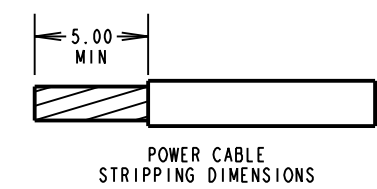
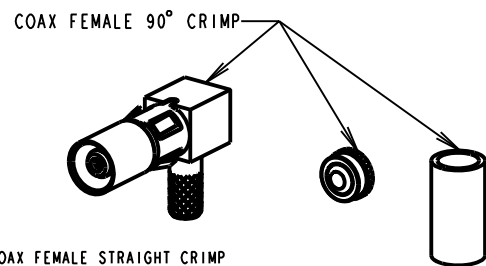

CRIMP/SOLDER CONTACTS ONLY

ORDER CODE: (CRIMP/SOLDER)
M80-400000FS-XX-XXX-00-000

TOTAL No. OF CONTACTS _____
 02 TO 12

- SPECIAL CONTACTS**
- 305 = COAX CONTACT CRIMP 2.0mm M80-305
 - 306 = COAX CONTACT CRIMP 2.4mm M80-306
 - 307 = COAX CONTACT CRIMP 2.7mm M80-307
 - 308 = 90° COAX CONTACT CRIMP 2.0mm M80-308
 - 309 = 90° COAX CONTACT CRIMP 2.7mm M80-309
 - 325 = POWER CONTACT SOLDER 12AWG M80-325
 - 326 = POWER CONTACT SOLDER 14AWG M80-326
 - 327 = POWER CONTACT SOLDER 16AWG M80-327
 - 328 = POWER CONTACT SOLDER OR CRIMP 18AWG M80-328
 - 329 = POWER CONTACT SOLDER OR CRIMP 20AWG M80-329
 - 32A = 90° POWER CONTACT SOLDER 12AWG M80-32A
 - 32B = 90° POWER CONTACT SOLDER 14AWG M80-32B
 - 32C = 90° POWER CONTACT SOLDER 16AWG M80-32C

DIMENSION	CALCULATION
DIM 'A'	4 x No. OF CONTACTS - 4.00
DIM 'B'	4 x No. OF CONTACTS + 5.00
DIM 'C'	4 x No. OF CONTACTS + 10.00
EXAMPLE 1: CONNECTOR WITH 08 COAX CONTACTS, M80-400000FS-08-305-00-000 DIM 'A' = 28.00mm, DIM 'B' = 37.00mm, DIM 'C' = 42.00mm, DIM 'D' = 13.4mm	
EXAMPLE 2: CONNECTOR WITH 10 POWER CONTACTS, M80-400000FS-10-325-00-000 DIM 'A' = 36.00mm, DIM 'B' = 45.00mm, DIM 'C' = 50.00mm, DIM 'E' = 12.7mm	

- NOTES:**
1. CONNECTORS ARE SUPPLIED WITH CONTACTS LOOSE.
 2. COAX CONTACT IS SUPPLIED AS A KIT OF PARTS: BODY, INSULATOR AND LATCHING COLLAR ARE PRE-ASSEMBLED AND SLEEVE AND INNER CONTACT ARE SEPARATE.
 3. FOR EXTRA COAX CONTACTS, USE PART NUMBER M80-305/306/307/308/309 FOR EXTRA POWER CONTACTS, USE PART NUMBER M80-325/326/327/328/329/32A/32B/32C.
 4. RECOMMENDED HAND CRIMP TOOL FOR COAX INNER CONTACT = Z80-292 WITH POSITIONER Z80-291 AND RECOMMENDED HAND CRIMP TOOL AND DIE SET FOR COAX SLEEVE = Z80-293.
 5. POWER AND COAX CONTACT EXTRACTION TOOL = Z80-290
 6. INSTRUCTION SHEETS ARE AVAILABLE.
 7. FOR EXAMPLE OF ALL COAX SPECIAL CONTACTS ORDER CODE SEE EXAMPLE 1 IN TABLE
 8. FOR EXAMPLE OF ALL POWER SPECIAL CONTACTS ORDER CODE SEE EXAMPLE 2 IN TABLE.

HARWIN

www.harwin.com
 technical@harwin.com

THIS DRAWING AND ANY INFORMATION OR DESCRIPTIVE MATTER SET OUT HEREON ARE CONFIDENTIAL AND COPYRIGHT PROPERTY OF THE HARWIN GROUP AND MUST NOT BE DISCLOSED, LOANED, COPIED OR USED FOR MANUFACTURING, TENDERING OR FOR ANY OTHER PURPOSE WITHOUT THEIR WRITTEN PERMISSION.

TOLERANCES
 X. = ±1mm
 X.X = ±0.25mm
 X.XX = ±0.10mm
 X.XXX = ±0.01mm
 ANGLES = ±5°
 UNLESS STATED

MATERIAL:
 SEE ABOVE
FINISH: SEE ABOVE
S/AREA: mm²

TITLE:
 DATAMATE MIX-TEK FEMALE ASSY.
 WITH EXTENDED JACKSCREW
DRAWING NUMBER:
M80-400000FS-XX-XXX-00-000
 SHT 2 OF 2

MGP	1	30.03.12	11695
NAME	ISS.	DATE	C/NOTE
APPROVED: MGP			
CHECKED: SF			
DRAWN: M G PLESTED			
CUSTOMER REF.:			
ASSEMBLY DRG:			