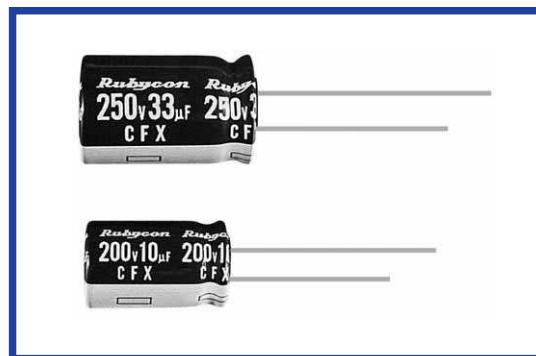

CFX SERIES
Load Life : 105°C 5000 hours.
◆FEATURES

- High Ripple Current.
- For Electronic Ballast, Power Supply.
- RoHS compliance.

◆SPECIFICATIONS

Items	Characteristics													
Category Temperature Range	-25~+105°C													
Rated Voltage Range	200~400V.DC													
Capacitance Tolerance	±20% (20°C, 120Hz)													
Leakage Current(MAX)	CV ≤ 1000	CV > 1000	I=(µA) Leakage Current C=(µF) Rated Capacitance V=(V) Rated Voltage											
	I=0.1CV+40µA (1 minute) I=0.03CV+15µA (5 minute)	I=0.04CV+100µA (1 minute) I=0.02CV+25µA (5 minute)												
(tanδ) Dissipation Factor(MAX)	<table border="1"> <tr> <td>Rated Voltage</td> <td>200</td> <td>250</td> <td>350</td> <td>400</td> <td>(20°C, 120Hz)</td> </tr> <tr> <td>tanδ</td> <td>0.15</td> <td>0.15</td> <td>0.20</td> <td>0.20</td> <td></td> </tr> </table>		Rated Voltage	200	250	350	400	(20°C, 120Hz)	tanδ	0.15	0.15	0.20	0.20	
Rated Voltage	200	250	350	400	(20°C, 120Hz)									
tanδ	0.15	0.15	0.20	0.20										
Endurance	After applying rated voltage with rated ripple current for 5000 hrs at 105°C, the capacitors shall meet the following requirements.													
	Capacitance Change	Within ±20% of the initial value.												
	Dissipation Factor	Not more than 200% of the specified value.												
Low Temperature Stability Impedance Ratio(MAX)	<table border="1"> <tr> <td>Rated Voltage</td> <td>200</td> <td>250</td> <td>350</td> <td>400</td> <td>(120Hz)</td> </tr> <tr> <td>Z(-25°C)/Z(20°C)</td> <td>3</td> <td>3</td> <td>6</td> <td>6</td> <td></td> </tr> </table>		Rated Voltage	200	250	350	400	(120Hz)	Z(-25°C)/Z(20°C)	3	3	6	6	
	Rated Voltage	200	250	350	400	(120Hz)								
Z(-25°C)/Z(20°C)	3	3	6	6										

◆MULTIPLIER FOR RIPPLE CURRENT

Frequency Coefficient

(Hz) Frequency		120	1k	10k	100k≤
Coefficient	2.2~4.7µF	0.2	0.4	0.8	1.0
	6.8~10µF	0.3	0.6	0.9	1.0
	22~100µF	0.5	0.8	0.9	1.0

◆OPTION

	Code
PET Sleeve	EFC

◆PART NUMBER

□□□	CFX	□□□□□	M	□□□	□□	DXL
Rated Voltage	Series	Rated Capacitance	Capacitance Tolerance	Option	Lead Forming	Case Size

◆ **DIMENSIONS**

(mm)

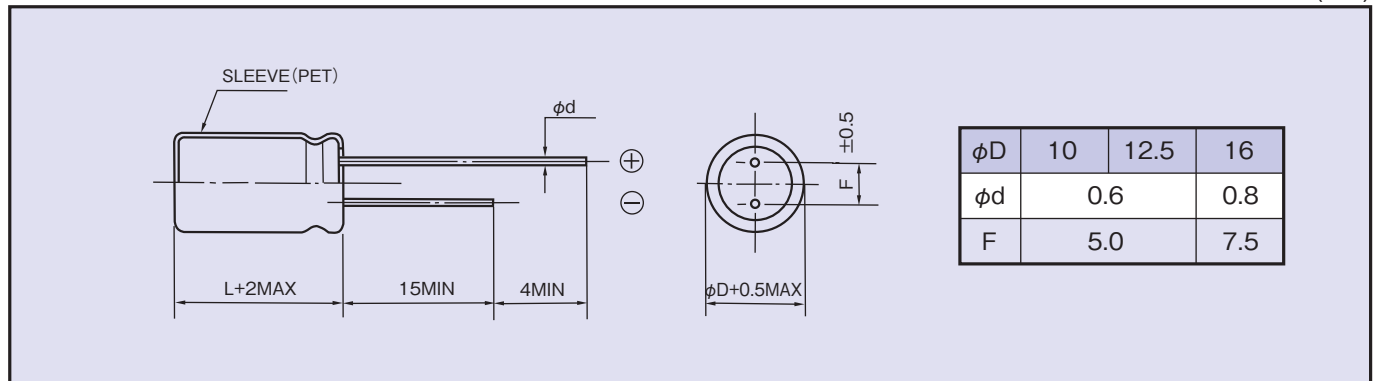

◆ **STANDARD SIZE**

Size $\phi D \times L$ (mm), Ripple Current (mA r.m.s./105°C, 100kHz)

Cap(μF) \ WV (V.DC)	200 (2D)		250 (2E)	
	Size	Ripple	Size	Ripple
10	10×16	300	10×16	300
22	10×16	360	10×20	500
33	10×20	500	12.5×20	600
47	12.5×20	660	12.5×25	720
68	12.5×25	760	16×25	920
100	16×25	1120		

Cap(μF) \ WV (V.DC)	350 (2V)		400 (2G)	
	Size	Ripple	Size	Ripple
2.2			10×16	160
3.3	10×16	180	10×16	180
4.7	10×16	220	10×16	220
6.8	10×16	220	10×16	220
8.2			8×23	400
10	10×20	280	10×20	280
22	12.5×20	350	12.5×25	430
33	12.5×25	430	16×25	640
47	16×25	660		