



804-028 and 804-029
Series 804 Push-Pull High Speed Mighty Mouse
Quick-Disconnect Receptacle Connector • #23 Contacts
Crimp Rear Release • Ordering Information



In-Line
804-028-01



Rear Panel Jam Nut
Mount
804-028-07



Front Panel Jam Nut
Mount
804-028-00

Integral Band Platform for direct attachment of a cable shield. Install a boot, or overmold directly onto the band platform. Or, choose an accessory thread for attaching strain reliefs and backshells.

Three Shell Styles
Jam nut with O-ring for front or rear panel mounting, or in-line receptacles for free-hanging cables.

Watertight, Shielded
O-ring inside the receptacle provides a dynamic seal when mated. Gold-plated spring provides secure mechanical retention and low shell-to-shell resistance for excellent EMI shielding.

How To Order

Sample Part Number

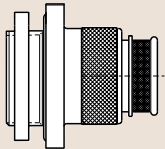
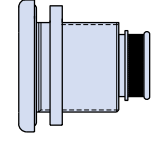
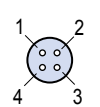
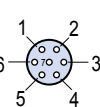
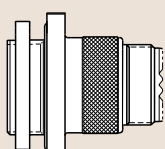
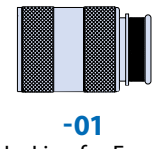
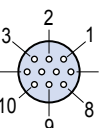
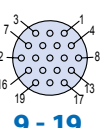
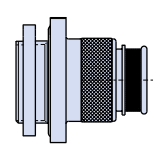
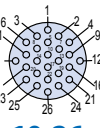
804-028	-07	M	6-7	P	A
Series	Shell Style	Shell Material / Finish	Shell Size- Insert Arrangement	Contact Type	Shell Key Position
 804-028 Receptacle with Banding Platform	 -00 Jam Nut for Front Panel Mounting	C Aluminum / Black Anodize (Non-Conductive) RoHS Compliant	 6 - 4	<i>Connector supplied with contacts</i> P Pin S Socket G Pin with 30 AWG Crimp Barrel H Socket with 30 AWG Crimp Barrel	OMIT for Single Master Key A Pos. A (Normal) B Pos. B C Pos. C D Pos. D E Pos. E F Pos. F
		M Aluminum / Electroless Nickel RoHS Compliant	 6 - 7		
 804-029 Receptacle with Accessory Thread	 -01 In-Line for Free-Hanging Cable	NF Aluminum / Olive Drab Cadmium over Electroless Nickel Finish	 7 - 10	<i>Connector supplied without contacts</i> A Pin Connector, Less Contacts B Socket Connector, Less Contacts	
		ZN Aluminum / Zinc-Nickel over Electroless Nickel ZNU Aluminum / Zinc-Nickel Black over Electroless Nickel	 9 - 19		
	 -07 Jam Nut For Rear Panel Mounting	Z1 Stainless Steel / Passivate ZB Stainless Steel / Olive Drab Chromate over Cadmium ZC Stainless Steel / Zinc Cobalt Alloy / Black Chromate	 10-26	Connectors with contacts are supplied with signal and/or power crimp contacts. These contacts are not installed. Coaxial contacts and non-standard signal contacts are ordered separately.	

804-028-07 and 804-029-07
Series 804 Push-Pull High Speed Mighty Mouse
Jam Nut Rear Panel Mount Receptacle • #23 Contacts
Crimp Rear Release • Dimensions

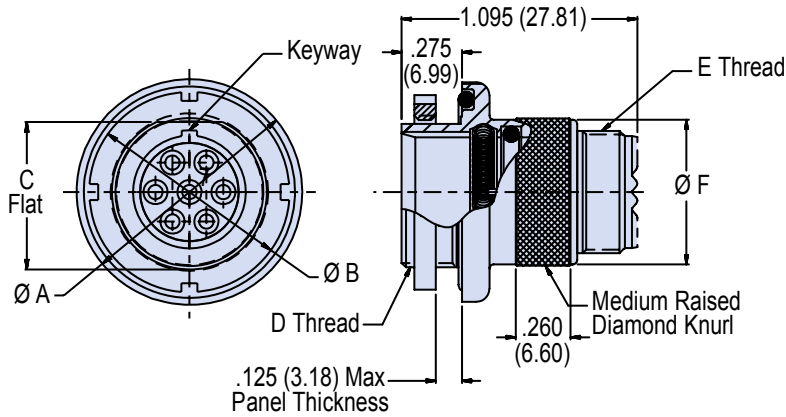

Accessory Thread
804-029-07

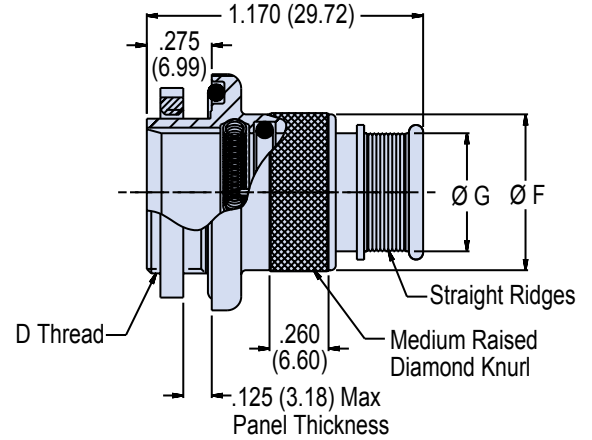

Integral Band Platform
804-028-07

Dimensions												
Shell Size	Ø A		Ø B		C Flat		D Threads	E Threads	Ø F		Ø G	
	In.	mm.	In.	mm.	In.	mm.			In.	mm.	In.	mm.
6	.830	21.08	.625	15.87	.467	14.40	.5000-32 UN-2A	.3125-32 UNEF-2A	.520	13.21	.286	7.26
7	.910	23.11	.750	19.05	.594	15.09	.6250-28 UN-2A	.4375-28 UNEF-2A	.580	14.73	.390	9.91
9	1.000	25.40	.812	20.62	.655	16.64	.6875-28 UN-2A	.5625-24 UNEF-2A	.695	17.65	.500	12.70
10	1.085	27.48	.875	22.22	.721	18.31	.7500-28 UN-2A	.6250-24 UNEF-2A	.735	18.67	.564	14.33

Receptacle Key Positions		
Position	A°	B°
A	150°	210°
B	75°	210°
C	95°	230°
D	140°	275°
E	75°	275°
F	95°	210°

Rear Mount Jam Nut Panel Cutout				
Shell Size	M Flat		Ø N	
	In.	mm.	In. ± .005	mm. ± 0.13
6	.479	12.17	.510	12.95
	.475	12.07		
7	.606	15.39	.635	16.13
	.602	15.29		
9	.667	16.94	.698	17.73
	.663	16.84		
10	.734	18.64	.760	19.30
	.729	18.52		

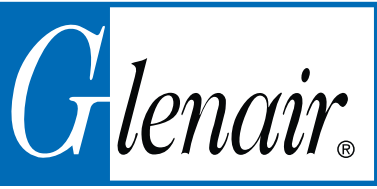

804-028-00 and 804-029-00
Series 804 Push-Pull High Speed Mighty Mouse
Jam Nut Front Panel Mount Receptacle • #23 Contacts
Crimp Rear Release • Dimensions

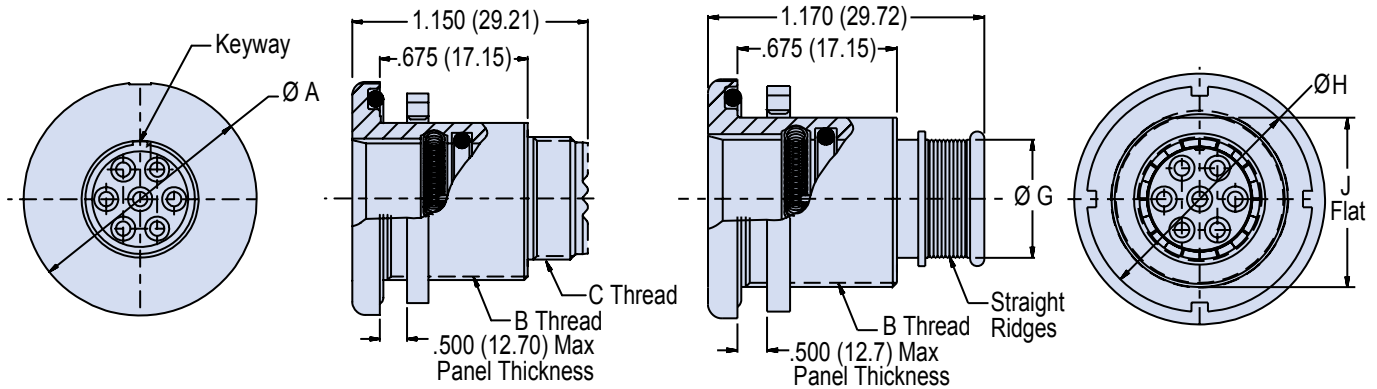

Accessory Thread
804-029-00

Integral Band Platform
804-028-00

Dimensions										
Shell Size	Ø A		B Threads	C Threads	Ø G		Ø H		J Flat	
	In.	mm.			In.	mm.	In.	mm.	In.	mm.
6	.885	22.48	.5625-32 UN-2A	.3125-32 UNEF-2A	.286	7.26	.688	17.47	.530	13.46
7	.995	25.27	.6875-28 UN-2A	.4375-28 UNEF-2A	.390	9.91	.812	20.62	.663	16.84
9	1.075	27.31	.7500-28 UN-2A	.5625-24 UNEF-2A	.500	12.70	.875	22.22	.720	18.29
10	1.140	28.95	.8125-28 UN-2A	.6250-24 UNEF-2A	.564	14.33	.938	23.82	.788	20.02

Receptacle Key Positions

Position	A°	B°
A	150°	210°
B	75°	210°
C	95°	230°
D	140°	275°
E	75°	275°
F	95°	210°

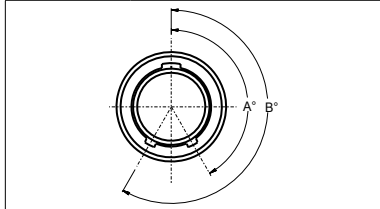

Rear Mount Jam Nut Panel Cutout

Shell Size	M Flat		Ø N	
	In.	mm.	In. ± .005	mm. ± 0.13
6	.479	12.17	.510	12.95
	.475	12.07		
7	.606	15.39	.635	16.13
	.602	15.29		
9	.667	16.94	.698	17.73
	.663	16.84		
10	.734	18.64	.760	19.30
	.729	18.52		

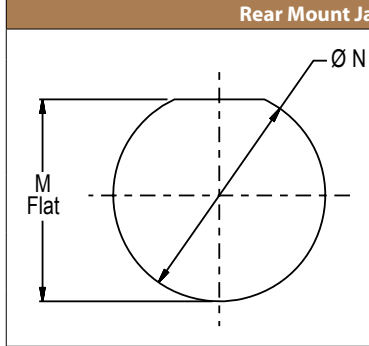

804-028-01 and 804-029-01
Series 804 Push-Pull High Speed Mighty Mouse
In-Line Receptacle • #23 Contacts
Crimp Rear Release • Dimensions

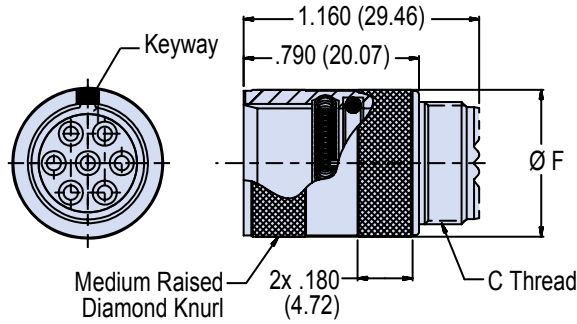

Accessory Thread
804-029-01

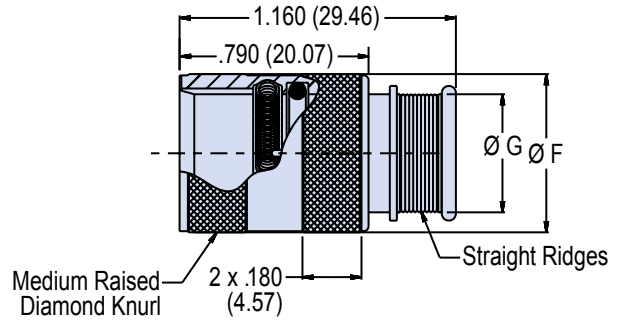

Integral Band Platform
804-028-01

Dimensions					
Shell Size	Ø F		C Threads	Ø G	
	In.	mm.		In.	mm.
6	.520	13.21	.3125-32 UNEF-2A	.286	7.26
7	.580	14.73	.4375-28 UNEF-2A	.390	9.91
9	.695	17.65	.5625-24 UNEF-2A	.500	12.70
10	.735	18.67	.6250-24 UNEF-2A	.564	14.33

Receptacle Key Positions		
Position	A°	B°
A	150°	210°
B	75°	210°
C	95°	230°
D	140°	275°
E	75°	275°
F	95°	210°

