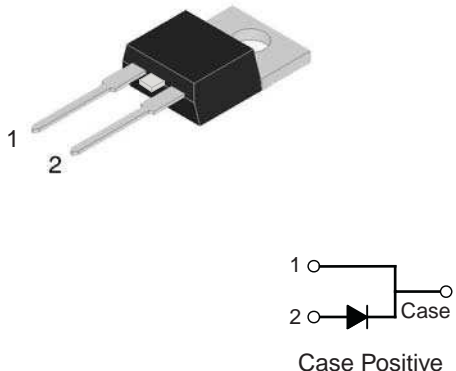

## 20.0 Amp. Schottky Barrier Rectifiers

<p><b>TO-220AC</b></p> 	<p><b>Voltage</b> 20 to 150 V</p>	<p><b>Current</b> 20.0 A</p>
	<ul style="list-style-type: none"> <li>• Low power loss, high efficiency</li> <li>• High current capability, Low VF</li> <li>• High reliability</li> <li>• High surge current capability</li> <li>• Epitaxial construction</li> <li>• Guard-ring for transient protection</li> <li>• For use in low voltage, high frequency inverter, free wheeling, and polarity protection application</li> </ul>	
	<p><b>Mechanical Data</b></p> <ul style="list-style-type: none"> <li>• Cases: TO-220AC molded plastic</li> <li>• Epoxy: UL 94V-O rate flame retardant</li> <li>• Terminals: Pure tin plated, lead free, solderable per MIL-STD-202, Method 208 guaranteed</li> <li>• Polarity: As marked</li> <li>• High temperature soldering guaranteed: 260 °C/10 seconds, 6.35mm, from case.</li> <li>• Weight: 2.24 grams</li> </ul>	

### Absolute Maximum Ratings, according to IEC publication No. 134

		SRA 2020	SRA 2040	SRA 2060	SRA 20100	SRA 20150
V <sub>RRM</sub>	Maximum Recurrent Peak Reverse Voltage (V)	20	40	60	100	150
V <sub>RMS</sub>	Maximum RMS Voltage (V)	14	28	42	70	105
V <sub>DC</sub>	Maximum DC Blocking Voltage (V)	20	40	60	100	150
I <sub>F(AV)</sub>	Maximum Average Forward Rectified Current See Fig. 1	20 A				
I <sub>FSM</sub>	Peak Forward Surge Current 8.3 ms. single Half Sine-wave Superimposed on Rated Load (JEDEC Method)	300 A				
T <sub>j</sub>	Operating Junction Temperature Range	- 65 to + 125 °C		- 65 to + 150 °C		
T <sub>stg</sub>	Storage Temperature Range	- 65 to + 150 °C				

### Electrical Characteristics

		SRA 2020	SRA 2040	SRA 2060	SRA 20100	SRA 20150
V <sub>F</sub>	Max. Instantaneous Forward Voltage @ 20 A	0.55 V		0.70 V	0.92 V	1.02 V
I <sub>R</sub>	Maximum DC Reverse Current @ T <sub>C</sub> = 25 °C at Rated DC Blocking Voltage @ T <sub>C</sub> = 100 °C	0.5 mA			0.1 mA	
		15 mA		10 mA	5.0 mA	
R <sub>thj-C</sub>	Typical Thermal Resistance (Note)	1.5 °C/W				

Notes: Mounted on Heatsink Size of 50.8 mm x 76.2 mm x 6.35 mm Al-Plate.

### Rating And Characteristic Curves

MAXIMUM FORWARD CURRENT DERATING CURVE

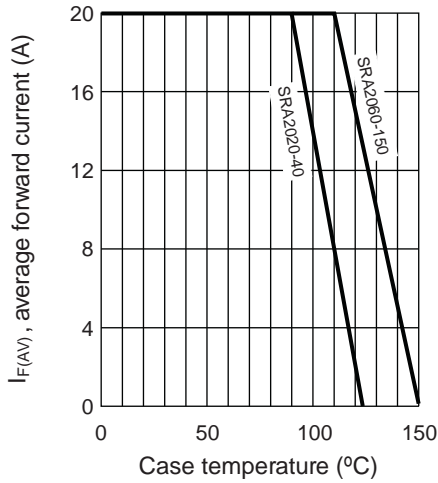

TYPICAL FORWARD CHARACTERISTICS

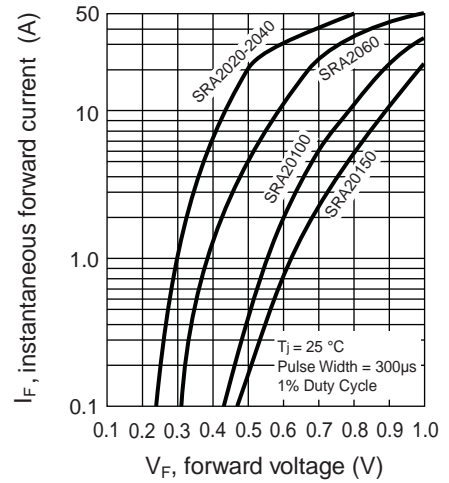

MAXIMUM NON-REPETITIVE FORWARD SURGE CURRENT

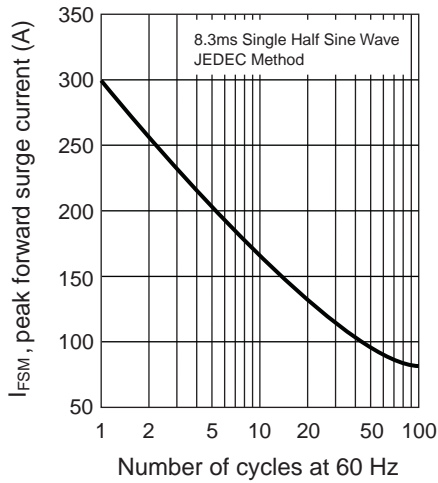

TYPICAL JUNCTION CAPACITANCE PER LEG

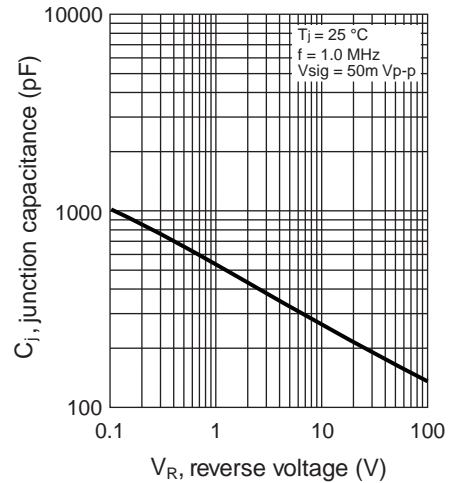

TYPICAL REVERSE CHARACTERISTICS

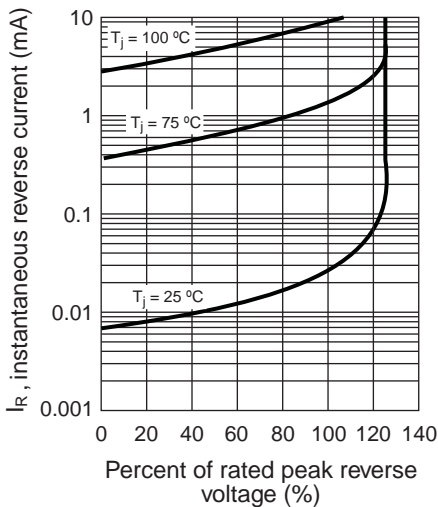

TYPICAL TRANSIENT THERMAL CHARACTERISTICS

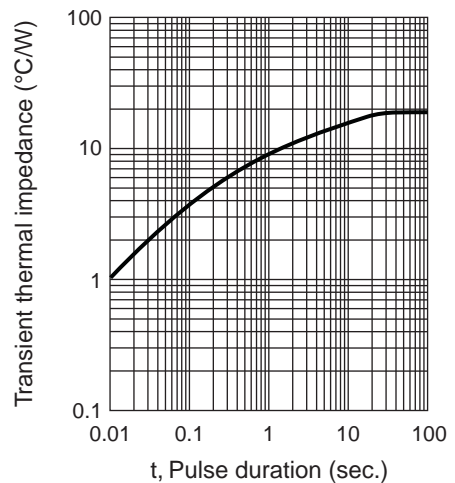

**PACKAGE MECHANICAL DATA TO-220AC**

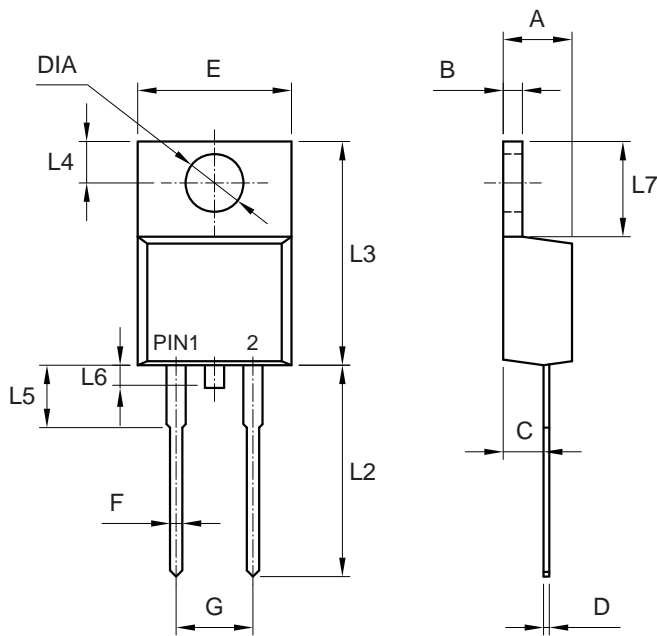

REF.	DIMENSIONS	
	Milimeters	
	Min.	Max.
A	4.44	4.70
B	1.14	1.40
C	2.54	2.79
D	0.35	0.64
E	-	10.50
F	0.68	0.94
G	4.95	5.20
L2	13.46	14.22
L3	14.9	15.10
L4	2.62	2.87
L5	3.56	4.06
L6	-	1.60
L7	5.84	6.86
DIA	3.74	3.91