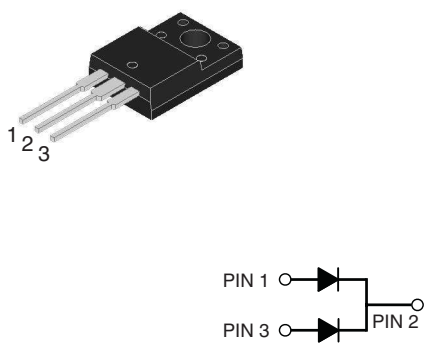

5 Amp. Glass Passivated Ultrafast Rectifiers

<p>ITO-220AB</p> 	<p>Voltage 200 V to 600 V</p> <p>Current 5 A</p> <ul style="list-style-type: none"> High efficiency, low VF High current capability High reliability High surge current capability Low power loss. For use in low voltage, high frequency inverter, free wheeling, and polarity protection application. <p>MECHANICAL DATA</p> <ul style="list-style-type: none"> Cases: ITO-220AB Molded plastic Epoxy: UL 94V-0 rate flame retardant Terminals: Pure tin plated, lead free, solderable per MIL-STD-202, Method 208 guaranteed Polarity: As marked High temperature soldering guaranteed: 260 °C/10 seconds, 4.06mm from case. Weight: 2.24 grams
---	---

Absolute Maximum Ratings, according to IEC publication No. 134

		SFF 504G	SFF 506G	SFF 508G
V_{RRM}	Maximum Recurrent Peak Reverse Voltage (V)	200	400	600
V_{RMS}	Maximum RMS Voltage (V)	140	280	420
V_{DC}	Maximum DC Blocking Voltage (V)	200	400	600
$I_{F(AV)}$	Maximum Average Forward Rectified Current 9.5mm Lead Length @ $T_c = 100\text{ °C}$	5.0 A		
I_{FSM}	Peak Forward Surge Current, 8.3 ms Single Half Sine-wave Superimposed on Rated Load (JEDEC Method)	70 A		
T_{rr}	Maximum Reverse Recovery Time from $I_F = 0.5A$; $I_R = 1A$; $I_{RR} = 0.25A$	35 nS		
C_j	Typical Junction Capacitance at 1 MHz and reverse voltage of $4V_{DC}$	70 pF	50 pF	
T_j	Operating Temperature Range	-65 to +150 °C		
T_{stg}	Storage Temperature Range	-65 to +150 °C		

Electrical Characteristics

V_F	Maximum Instantaneous Forward Voltage @ 10 A	0.98 V	1.3 V	1.7 V
I_R	Maximum DC Reverse Current @ $T_A = 25\text{ °C}$ at Rated DC Blocking Voltage @ $T_A = 100\text{ °C}$	10 μ A 400 μ A		
$R_{th(j-c)}$	Typical Thermal Resistance (See note)	5.5 °C/W		

NOTE: Mounted on Heatsink Size of 50.8mm x 76.2mm x 6.35mm, Al-Plate.

Rating And Characteristic Curves

TYPICAL FORWARD CHARACTERISTICS PER LEG

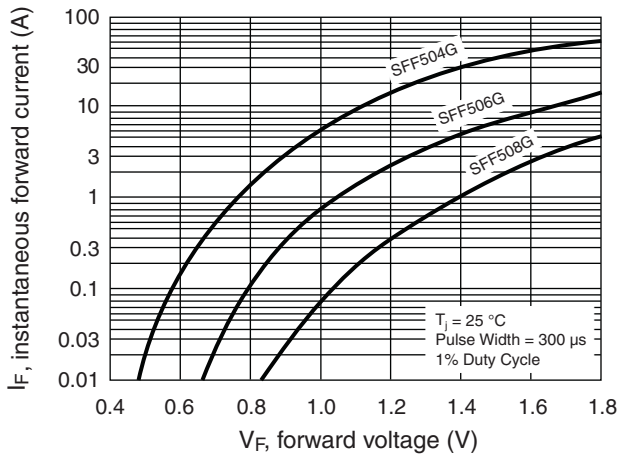

MAXIMUM AVERAGE FORWARD CURRENT DERATING CURVE

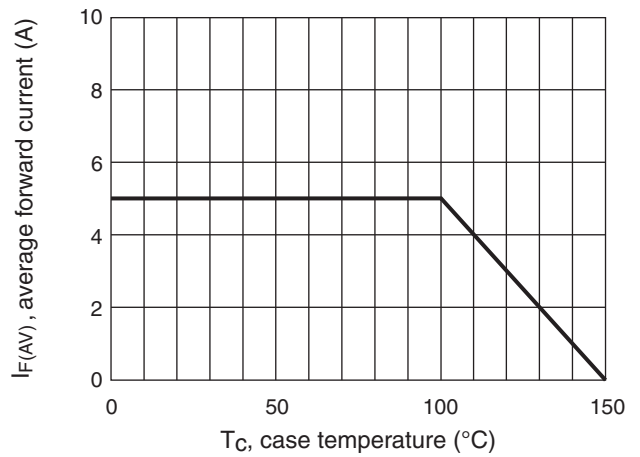

MAXIMUM NON-REPETITIVE FORWARD SURGE CURRENT PER LEG

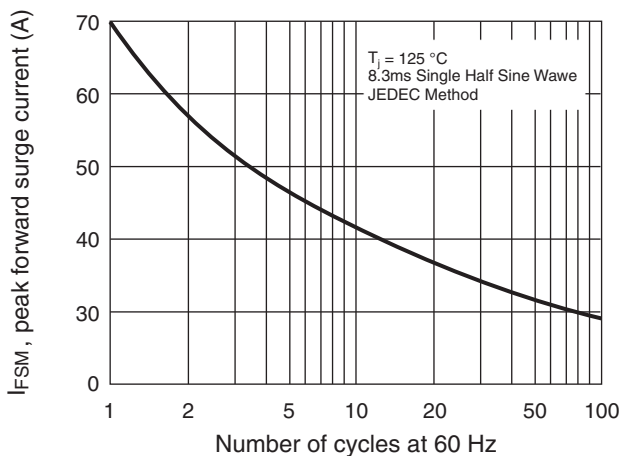

TYPICAL JUNCTION CAPACITANCE PER LEG

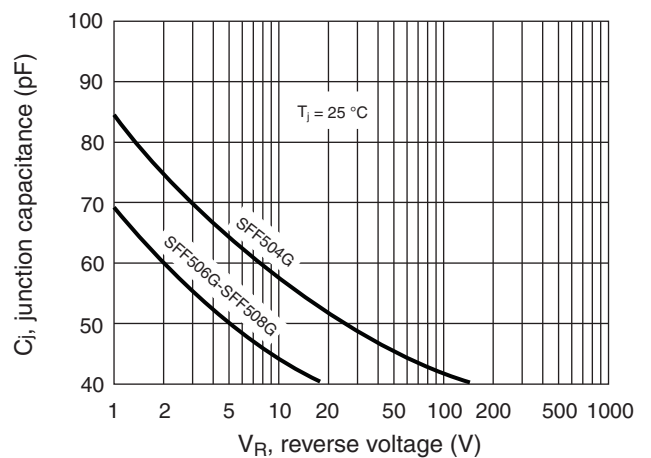

TYPICAL REVERSE CHARACTERISTICS

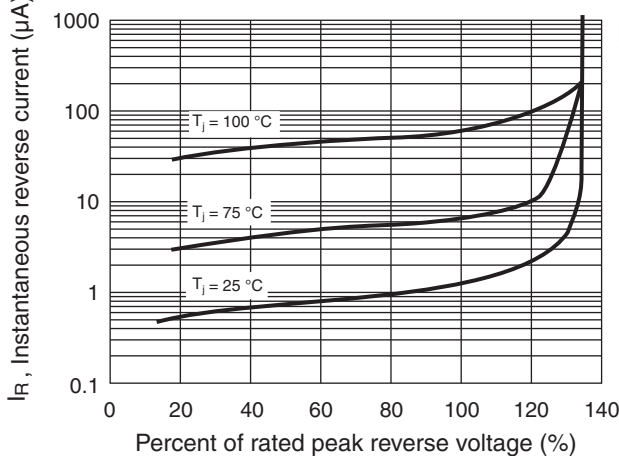

REVERSE RECOVERY TIME CHARACTERISTIC AND TEST CIRCUIT DIAGRAM

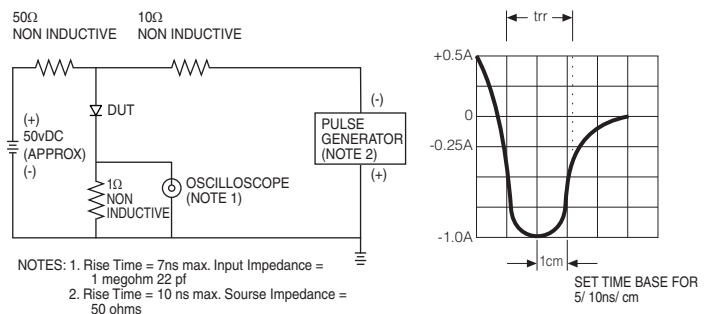

5 Amp. Glass Passivated Ultrafast Recovery Rectifier

PACKAGE MECHANICAL DATA

ITO-220AB

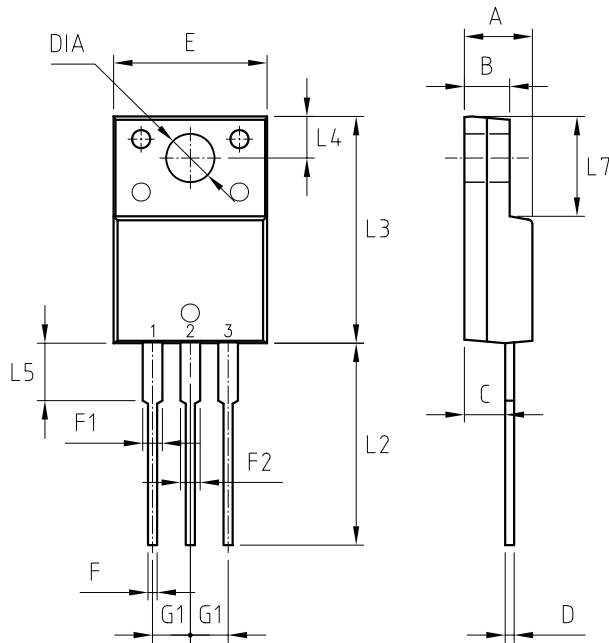

REF.	DIMENSIONS		
	Millimeters		
	Min.	Nominal	Max.
A	-	-	4.7
B	-	-	3.16
C	2.5	-	2.8
D	-	-	0.76
E	-	-	10.3
F	-	-	0.9
F1	-	-	1.4
F2	-	-	1.8
G1	-	2.55	-
L2	13.2	-	13.8
L3	14.8	-	15.5
L4	2.55	-	2.85
L5	-	-	4.1
L7	6.3	-	6.9
DIA	3.0	-	3.4