



**RDL**<sup>®</sup>  
Radio Design Labs

SPECIALISTS IN PRACTICAL PRECISION ENGINEERING™

# ACCESSORIES

## Model PM-3T/W/G Pole Mount Tray

## Installation/Operation



EN55103-1 E1-E5; EN55103-2 E1-E4  
Typical Performance reflects product at publication time exclusive of EMC data, if any, supplied with product. Specifications are subject to change without notice.

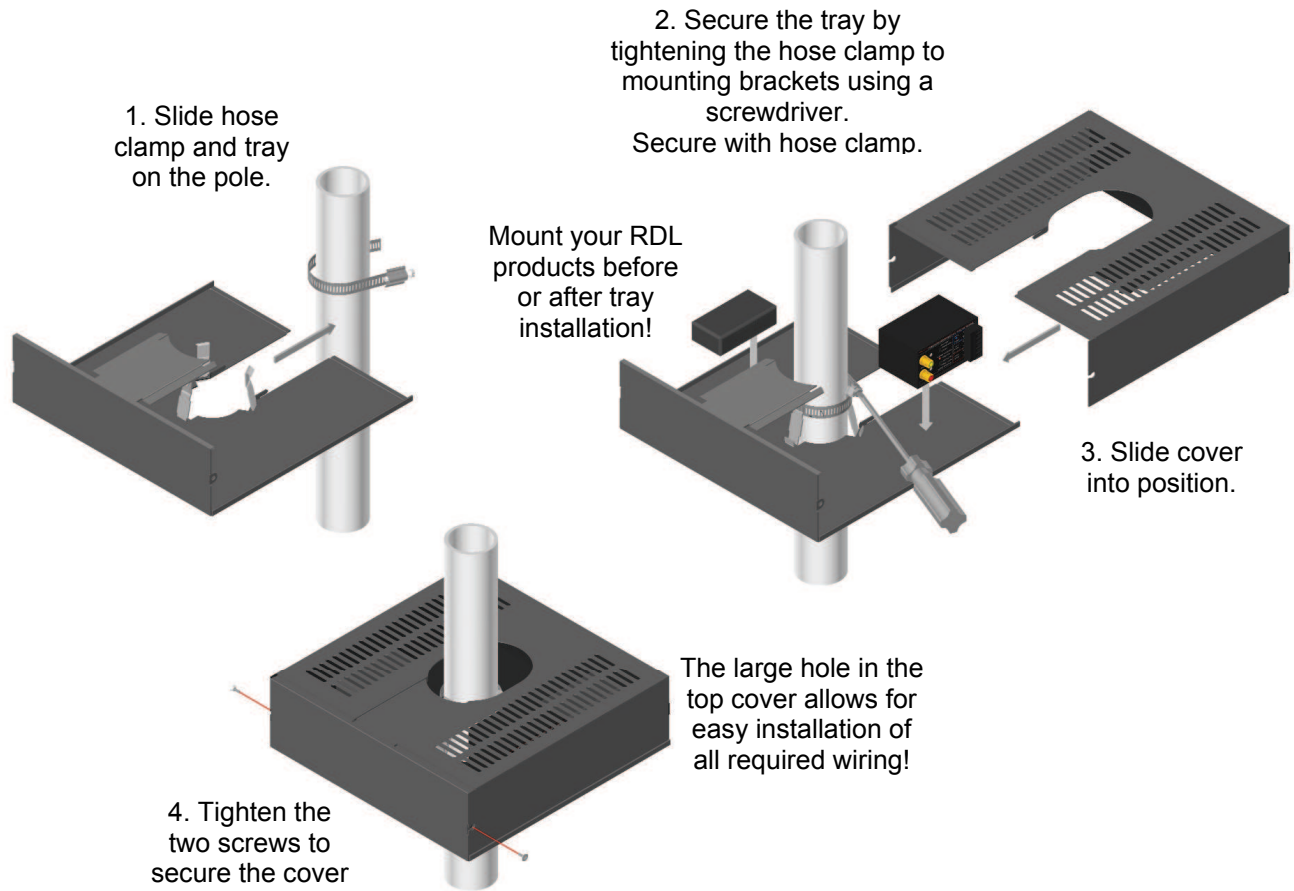

The PM-3T is a tray that mounts above a projector using a standard (1.5" I.D.) round projector pole or any smaller round or rectangular pole. The tray accommodates any RU, TX, FP or STICK-ON Audio Power Amplifier and its associated RDL power supply. The unique design of the PM-3T permits installation above a projector without removing the projector or pole. The durable steel tray is constructed in two pieces to slide over the projector pole from each side, making installation fast and convenient. The PM-3T is available in three colors. The standard color is black (PM-3T). It is also available in white (PM-3TW) and gray (PM-3TG).

Dimensions (each):                      Height: 2.96" (7.52cm) Depth: 10" (25.4cm) Width: 10" (25.4cm)  
Material:                                      18-gauge steel  
Finish:    RDL Black, White, Gray

**Radio Design Labs Technical Support Centers**  
U.S.A. (800) 933-1780, (520) 778-3554; Fax: (520) 778-3506  
Europe [NH Amsterdam] (++31) 20-6238 983; Fax: (++31) 20-6225-287