



RDL[®]
Radio Design Labs

SPECIALISTS IN PRACTICAL PRECISION ENGINEERING™

STICK-ON[®] SERIES

Model ST-CX2 Line-Level Crossover

ANYWHERE YOU NEED...

- Active Low-Frequency Woofer Equalization
- Active Full-Range Equalization
- Adjustable Equalization
- Crossover with Loop-through Output
- Low-Noise and Low-Distortion Crossover
- RDL SupplyFlex™ Power Input Configuration



You Need The ST-CX2!

The ST-CX2 is part of the group of versatile STICK-ON products from Radio Design Labs. STICK-ONs feature the advanced circuitry for which RDL products are known, combined with unequalled versatility in mounting possibilities. The durable adhesives provided with the ST-CX2 permit permanent or detachable mounting. Numerous available mounting accessories, brackets and rack-mount chassis are optionally available to facilitate any system design.

APPLICATION: The ST-CX2 is a line-level two band crossover to drive audio power amplifiers. The input and outputs are balanced and may be connected unbalanced if necessary. The input accepts a +4 dBu line-level signal. The module operates at nominal unity gain.

The FULL RANGE output is designed for use with full-range speaker systems which do not contain a woofer (below 100 Hz). The passband is 100 Hz to 30 kHz, with an equalization adjustment centered at 2 kHz. Through the application of a smile-curve providing up to 8 dB attenuation through midband audio frequencies, the performance of the whole system may be significantly enhanced.

The WOOFER output is designed for use with woofers amplified independently of any full-range speakers. The passband is 40 Hz to 165 Hz when set flat, with an equalization BOOST adjustment centered at 50 Hz.

For systems also incorporating subwoofers, the LOOP THRU output connects to an input of the RDL ST-CX1S Subwoofer Crossover. The ST-CX2 features RDL's SupplyFlex power input configuration for operation directly from ground-referenced, floating or bipolar 24 Vdc power.

The ST-CX2 features excellent frequency response, accurate active state-of-the-art filtering, and the exceptional low-noise performance for which RDL products are known.

Wherever high quality, active equalization is needed to tailor the sound in a speaker system, the ST-CX2 is the ideal choice. Use the ST-CX2 individually, or combine it with other RDL RACK-UP[®], STICK-ON, TX[™], or FLAT-PAK[™] series products as part of a complete audio/video system.

STICK-ON[®] SERIES

Model ST-CX2 Line-Level Crossover

Installation/Operation



EN55103-1 E1-E5; EN55103-2 E1-E4
Typical Performance reflects product at publication time exclusive of EMC data, if any, supplied with product. Specifications are subject to change without notice.

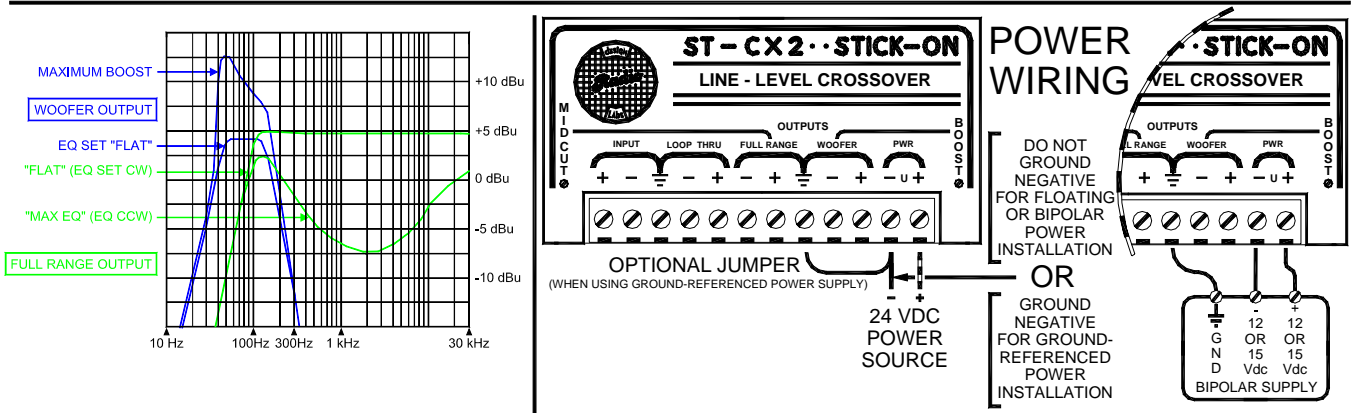
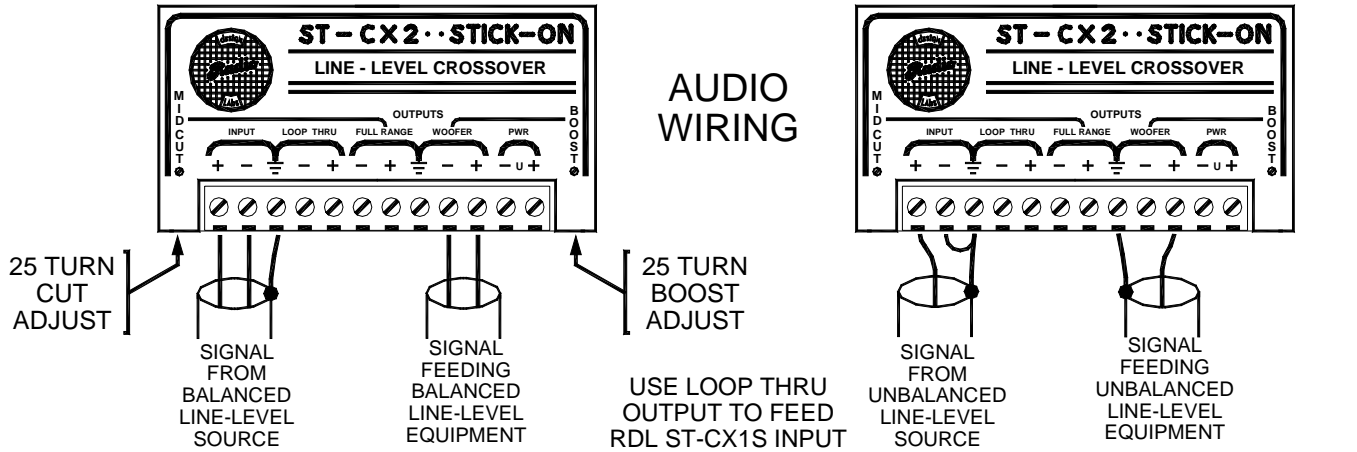

TYPICAL PERFORMANCE

Input :	50 kΩ balanced line-level (+4 dBu)
Outputs (2):	150 Ω balanced line-level (+4 dBu)
Headroom:	> 18 dB
Gain:	Unity (nominal, equalization set flat)
Out-of-Band Rolloff:	18 dB/octave
FULL RANGE Output:	
Frequency Response:	100 Hz to 30 kHz (+/- 0.5 dB)
THD+N:	< 0.075% (100 Hz to 30 kHz)
Residual Noise:	< -80 dB (referred to +4 dBu)
WOOFER Output:	
Frequency Response:	40 Hz to 165 Hz (+/- 0.5 dB)
THD+N:	< 0.025% (40 Hz to 165 Hz)
Residual Noise:	< -95 dB (referred to +4 dBu)
Power Requirement:	24 to 33 Vdc @ 40 mA, SupplyFlex (Ground-referenced or Floating)