

REVISIONS

P	LTR	DESCRIPTION	DATE	DWN	APVD
C		LOGO CHANGE	02APR2013	TR	KZ

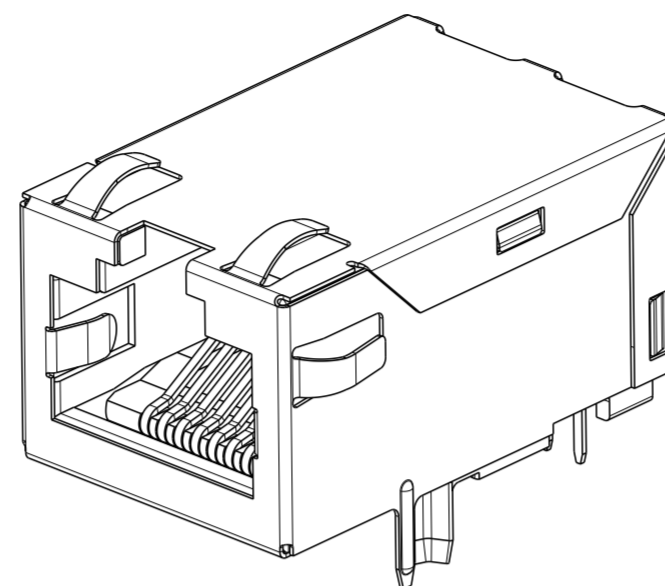
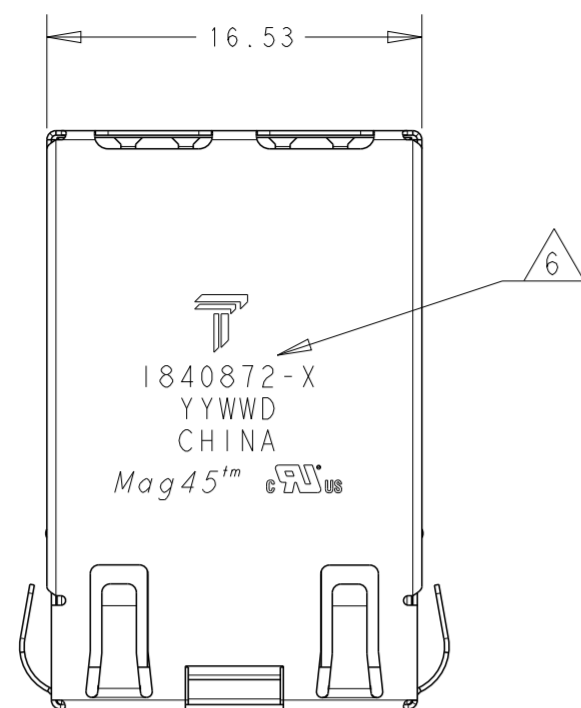

- 1 MATERIAL  
HOUSING: THERMOPLASTIC BLACK, FLAMMABILITY RATING UL 94V-0  
SHIELD: 0.20mm THICK, BRASS  
PREPLATED WITH MIN 0.76um SEMI-BRIGHT NICKEL  
POST-DIPPED WITH 2.54um MIN SAC SOLDER AT GROUND PINS.  
CONTACT TAILS: PHOSPHOR BRONZE,  
WITH 1.27um MIN OVERALL NICKEL UNDERPLATE AND  
SELECTIVE 1.27um MIN GOLD PLATING AT MATING INTERFACE  
SOLDER TAIL: 0.25mm THICK, PHOSPHOR BRONZE, 1.27um MIN OVERALL NICKEL  
UNDERPLATE, 3um MIN TIN PLATE.

- 2 RJ45 CAVITY CONFORMS TO FCC RULES AND REGULATIONS PART 68, SUB-PART F.

- 3 MAGNETICS  
-APPLICATION: 10/100 BASE-T.  
-IMPEDANCE: 100 OHMS  
-TURNS RATIO (CHIP:CABLE): TX = 1:1, RX = 1:1  
-OPEN CIRCUIT INDUCTANCE (OCL): 350uH MIN @100kHz, 0.1VRMS,  
8mADC BIAS FROM 0°C TO 70°C, TX AND RX  
-PERFORMANCE @ 25°C:  
INSERTION LOSS (IL): 1.1dB MAX FROM 0.5MHz TO 100MHz  
RETURN LOSS (RL): 18dB MIN FROM 0.5MHz TO 30MHz  
18-20LOG(f/30)dB MIN FROM 30.1MHz TO 60MHz  
12dB MIN FROM 60.1MHz TO 80MHz  
CROSSTALK ATTENUATION: 35dB MIN FROM 0.5MHz TO 40MHz  
33-20LOG(f/50)dB MIN FROM 40.1MHz TO 100MHz  
COMMON MODE REJECTION RATIO (CMRR): 30dB MIN FROM 0.5MHz TO 100MHz  
-ISOLATION VOLTAGE: 2250VDC (MAX) FOR 60 SECONDS WITH A RISE TIME  
OF 500V/SEC.

- 4. OPERATING TEMPERATURE: 0°C TO 70°C
- 5 THE MAGNETIC CIRCUITS ARE SYMMETRICAL TO SUPPORT AUTO-MDIX OPERATION.
- 6 TRP LOGO, PART NUMBER, DATE CODE, COUNTRY OF ORIGIN, AGENCY APPROVAL  
MARKING LOGO LOCATED IN APPROXIMATE AREA AS SHOWN. DATE CODE YY IS YEAR, WW IS  
WORK WEEK, D IS DAY OF WEEK, WITH SUNDAY=1
- 7. THE PART IS RECOMMENDED FOR WAVE SOLDERING PROCESS, PREHEAT  
TEMPERATURE IS 120°C TO 160°C, 120 SECONDS TO 180 SECONDS, PEAK  
WAVE SOLDERING TEMPERATURE IS 260°C MAX, 10 SECONDS MAX.

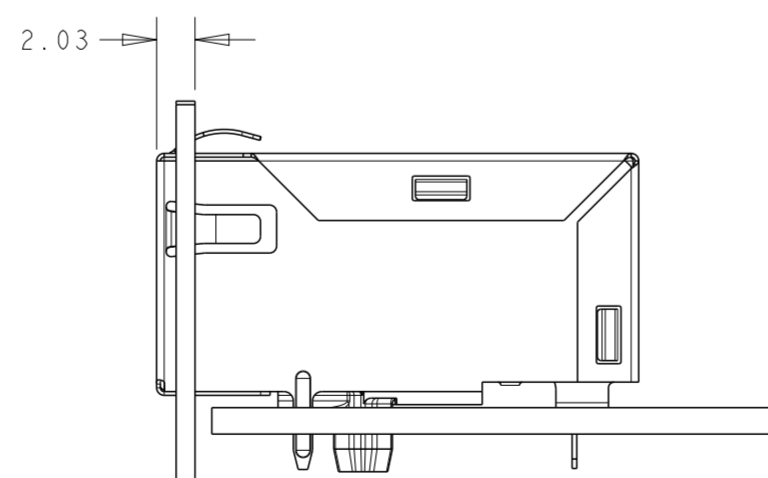
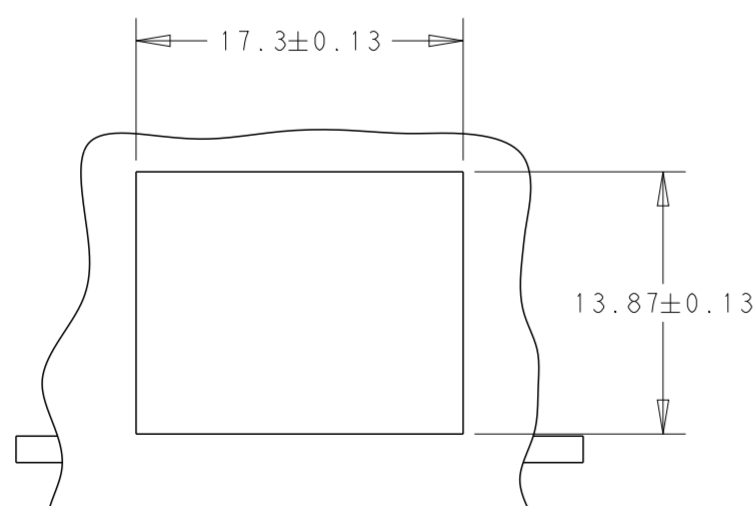
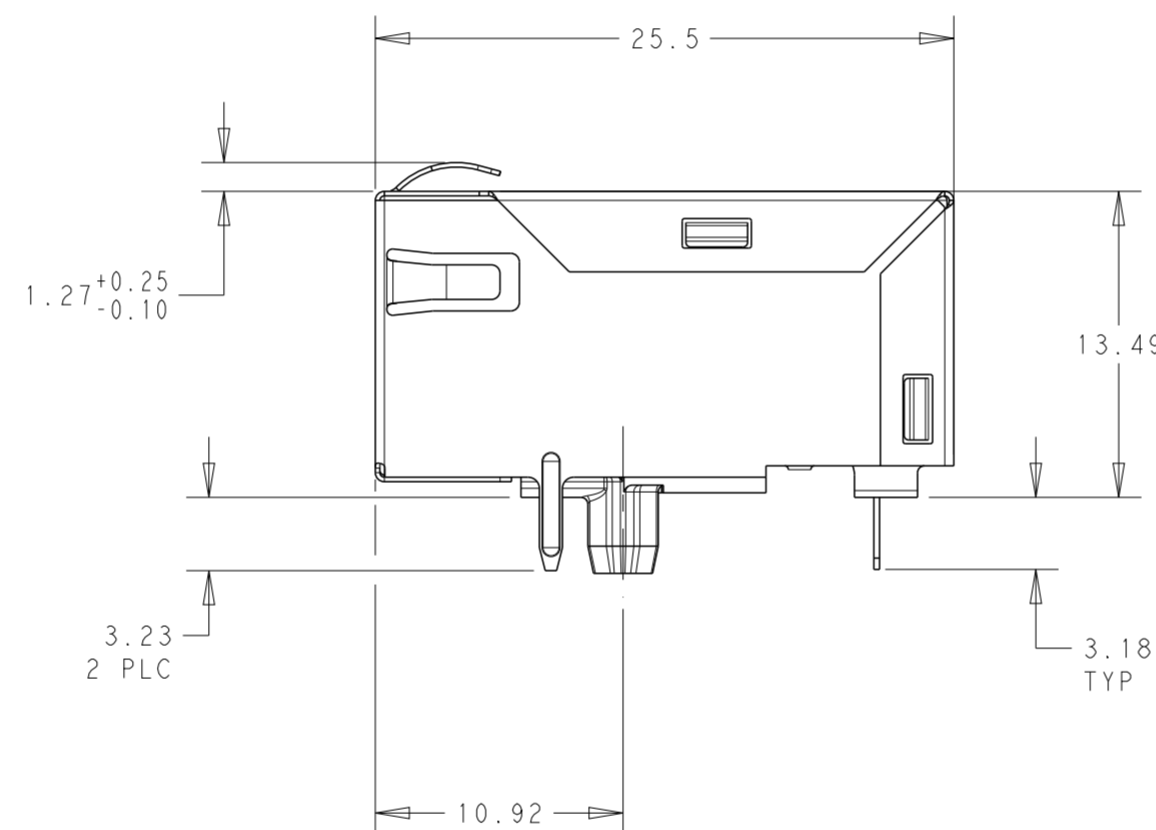
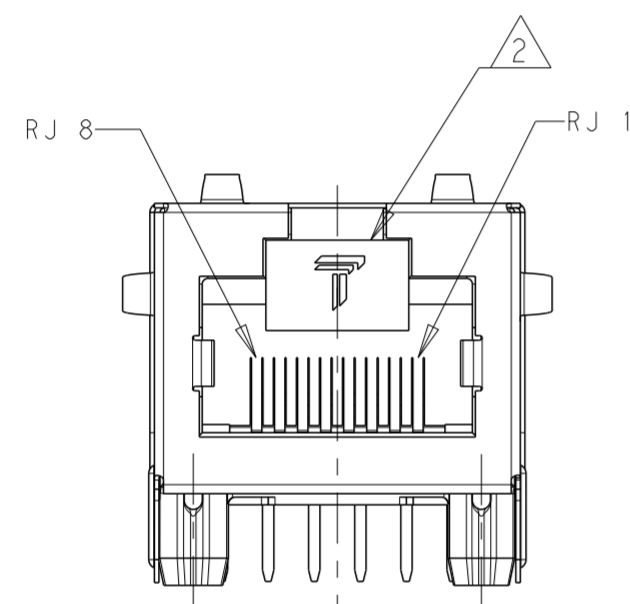

SUGGESTED PANEL CUTOUT

CONNECTOR ASSEMBLED TO PANEL AND PCB

1840872-1  
PART NUMBER

THIS DRAWING IS A CONTROLLED DOCUMENT.		DWN TERRY YU 31JANT0			TRP connector Dongguan China	
DIMENSIONS: mm		CHK TONY YUAN 31JANT0			NAME 1X1 MAG45(TM) MODULAR JACK, 726P12 10/100 CIRCUIT, SHIELD, NO LEDS	
TOLERANCES UNLESS OTHERWISE SPECIFIED:		APVD KEITH ZHU 31JANT0	PRODUCT SPEC 108-104004		SIZE A2	CAGE CODE
0 PLC ±-		APPLICATION SPEC -	DRAWING NO C-1840872		RESTRICTED TO -	
1 PLC ±0.25		WEIGHT -	SCALE 3:1		SHEET 1 OF 2	REV C
2 PLC ±0.25		CUSTOMER DRAWING				
3 PLC ±-						
4 PLC ±-						
ANGLES ±1°						
FINISH						

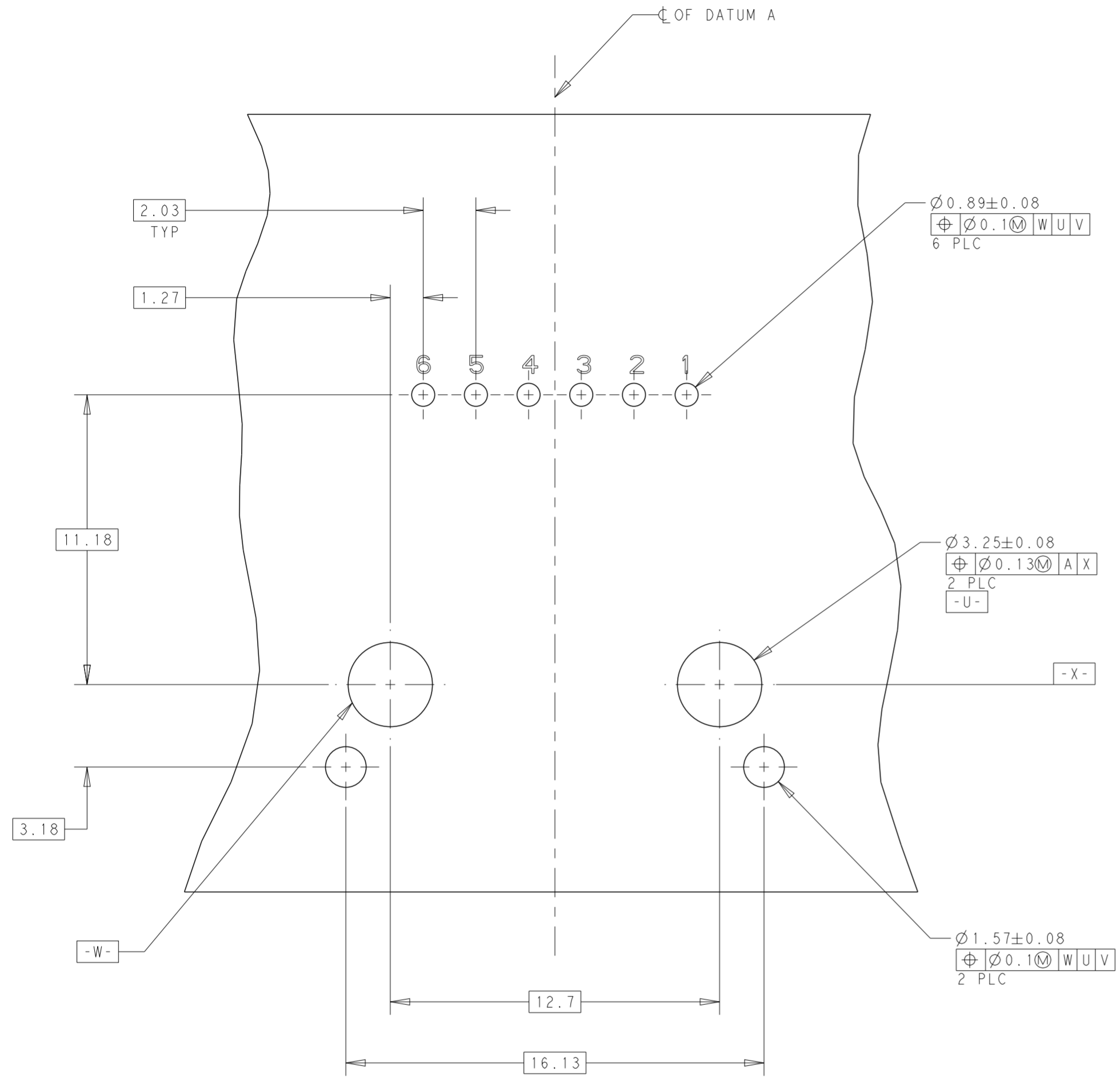

# 726P12 10/100 CIRCUIT

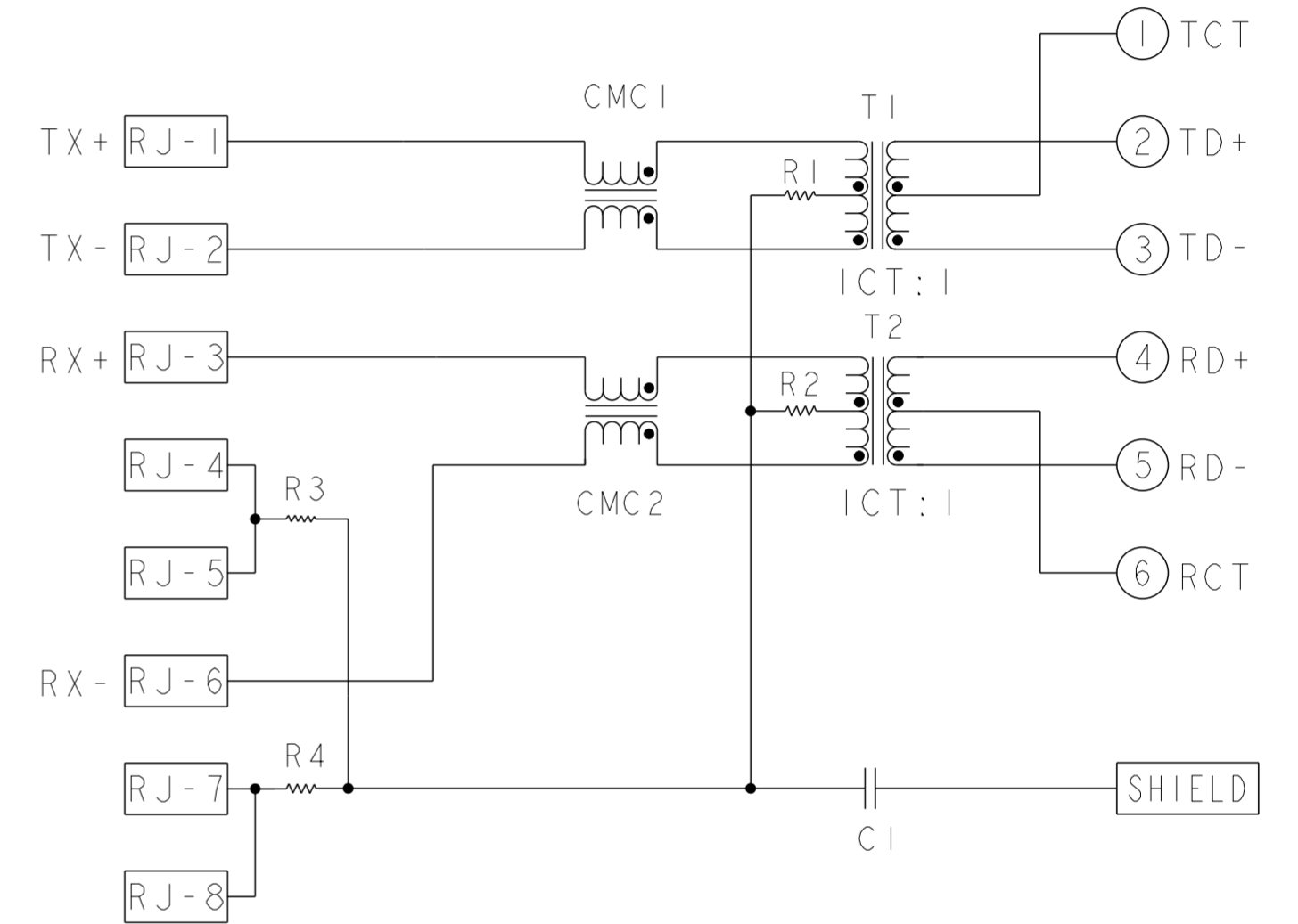

C1=1000pF, 2kV, DECOUPLING CAP  
R1~R4=75Ω, 1/16W, RESISTORS

THIS DRAWING IS A CONTROLLED DOCUMENT.		DWN TERRY YU 31JAN10	 TRP connector Dongguan China	
DIMENSIONS: mm		CHK TONY YUAN 31JAN10		
TOLERANCES UNLESS OTHERWISE SPECIFIED:		APVD KEITH ZHU 31JAN10	NAME 1X1 MAG45(TM) MODULAR JACK, 726P12 10/100 CIRCUIT, SHIELD, NO LEDS	
0 PLC ±0.25 1 PLC ±0.25 2 PLC ±0.25 3 PLC ±0.25 4 PLC ± ANGLES ±1° FINISH		PRODUCT SPEC 108-104004	SIZE A2	DRAWING NO C-1840872
MATERIAL		APPL. SPEC	RESTRICTED TO	
		WEIGHT	SCALE 3:1	SHEET 2 OF 2 REV C
		Customer Drawing		