

REVISIONS				
P	LTR	DESCRIPTION	DATE	DWN APVD
E		LOGO CHANGE	07APR2013	PP KZ

MECHANICAL:

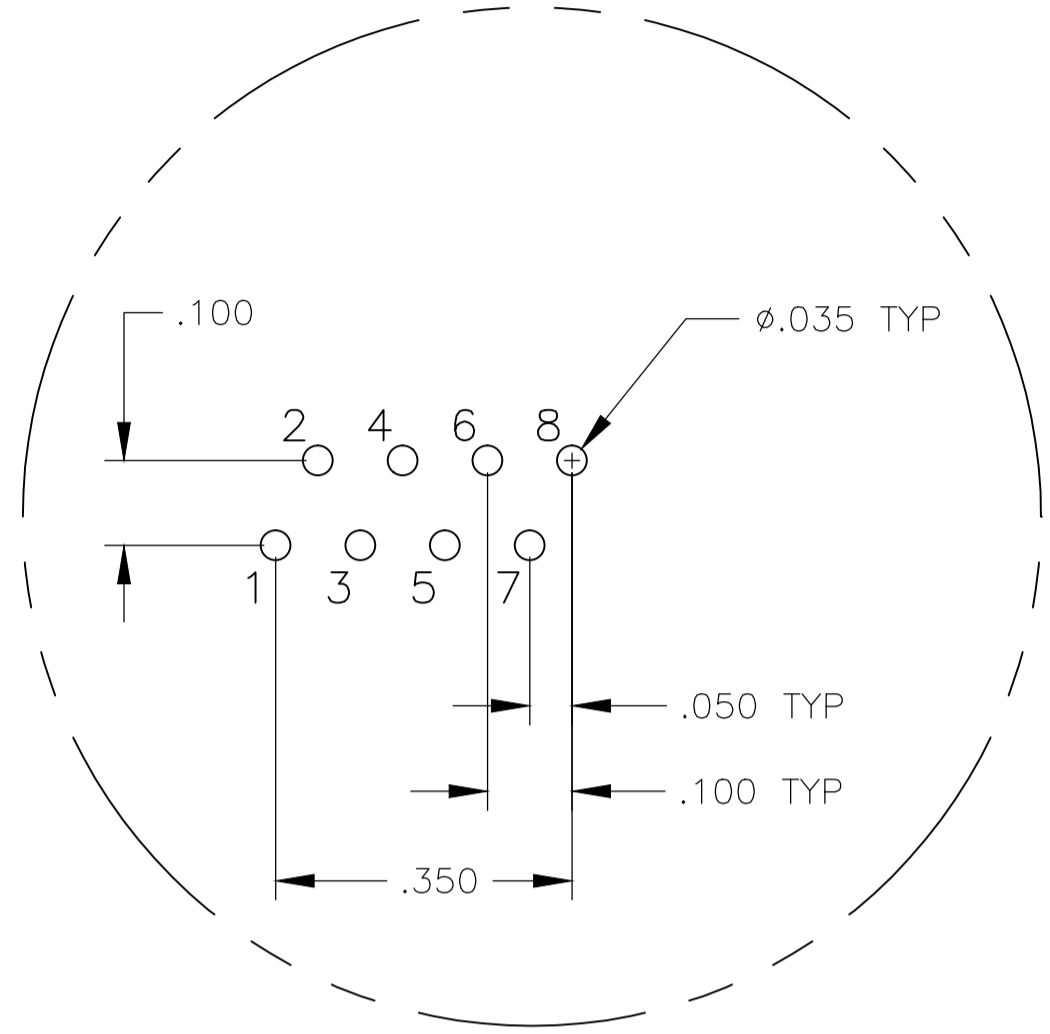
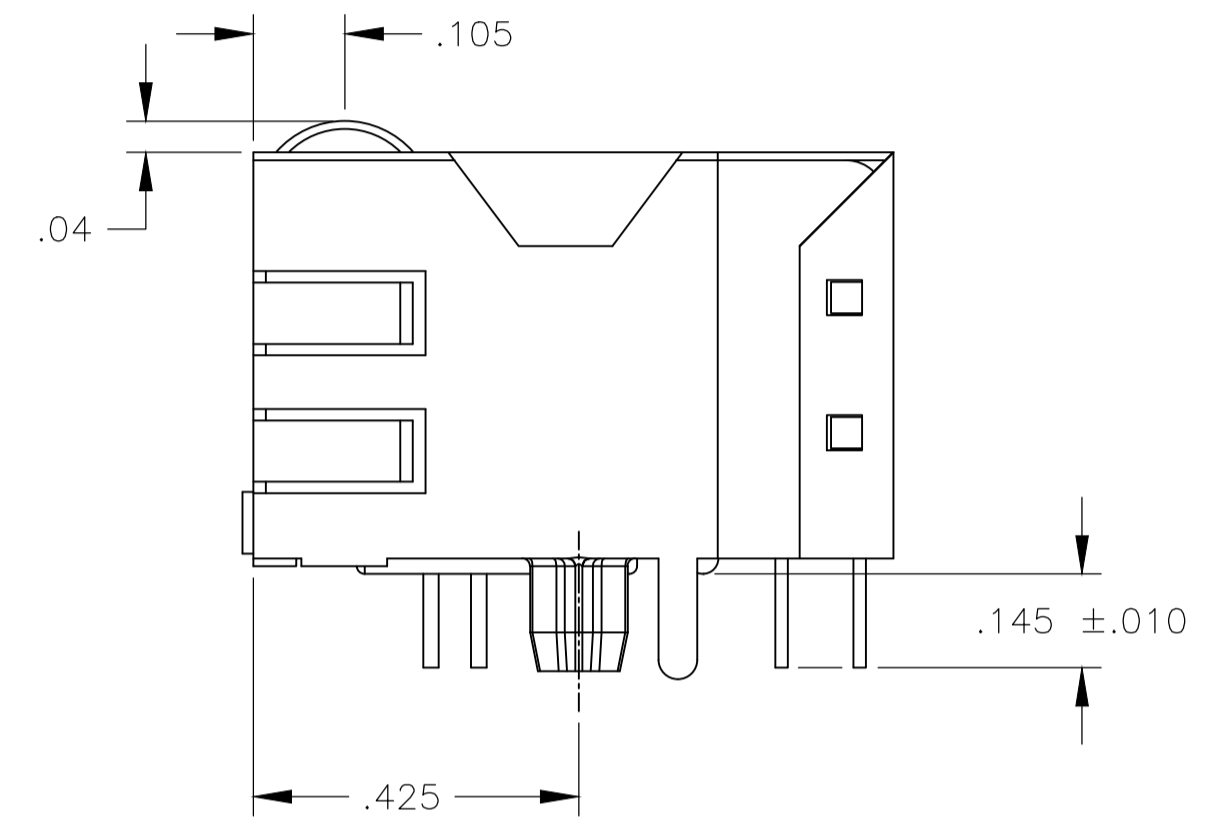
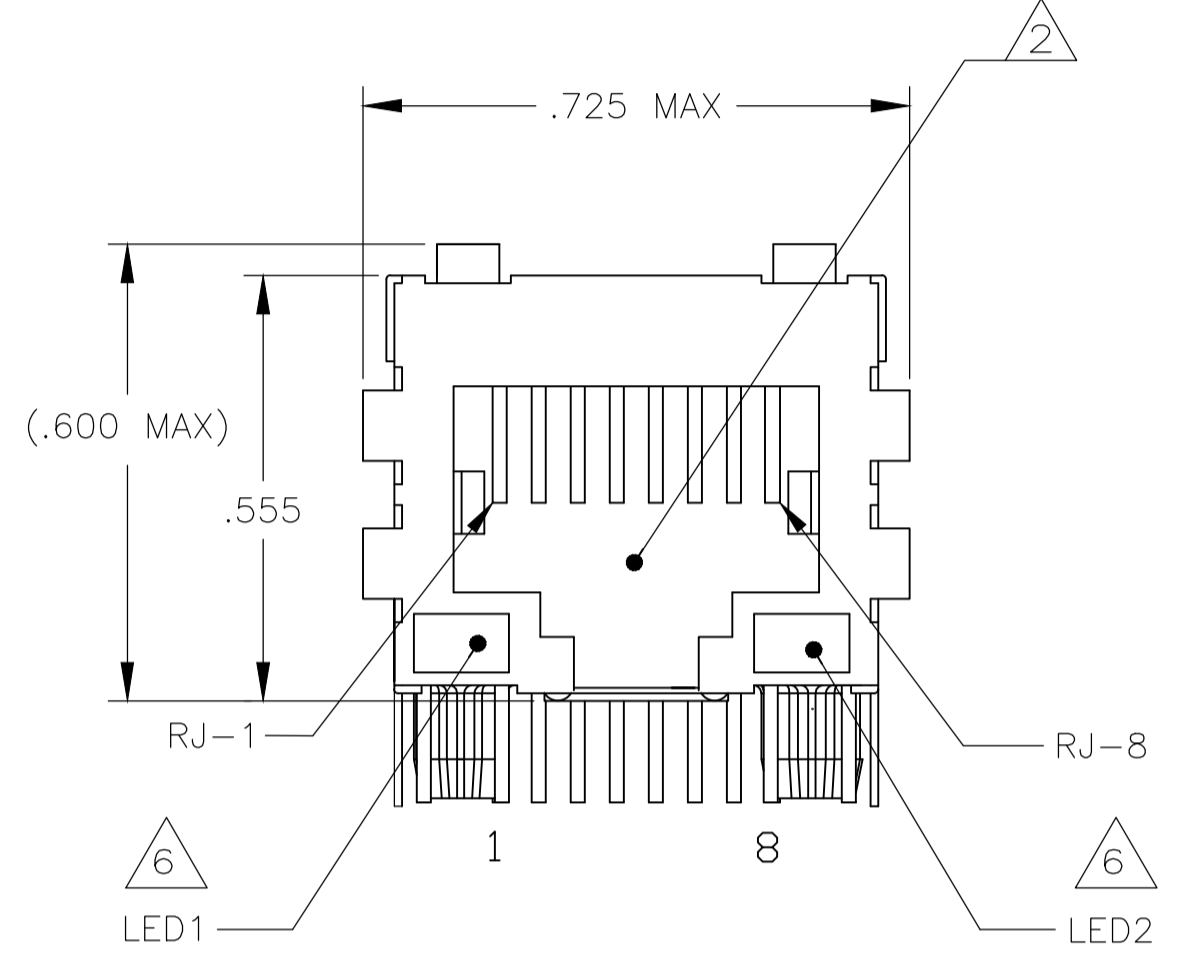
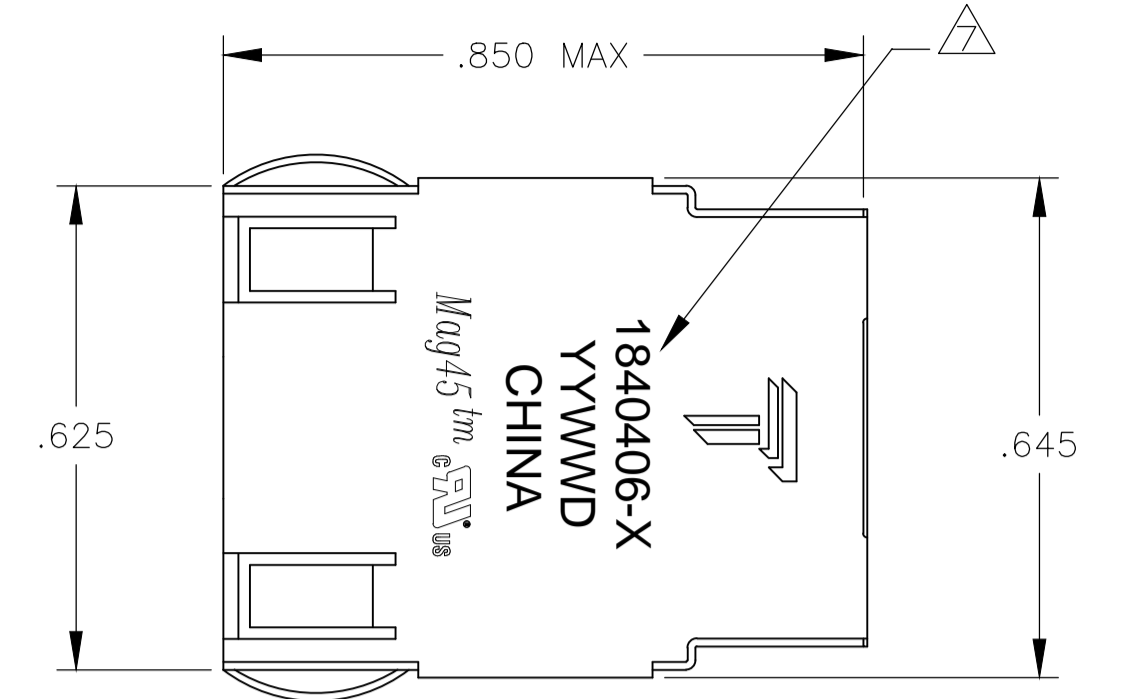

Pin Designations

ELECTRICAL:

326P13 MAGNETIC CIRCUIT

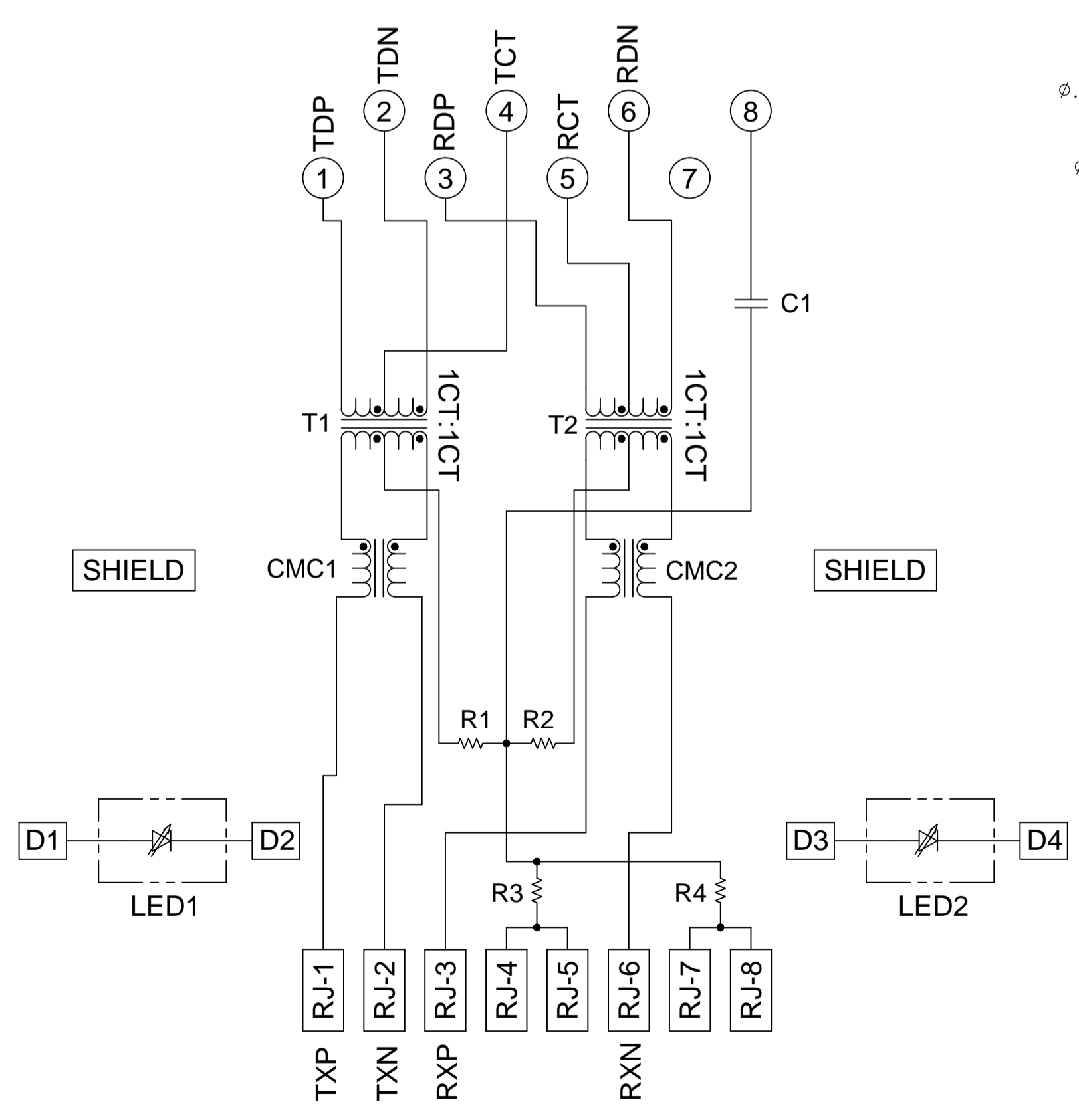

C1=1000pF, 2kV CAPACITOR
 R1-R4=75 OHMS, 5%, 1/16W RESISTORS

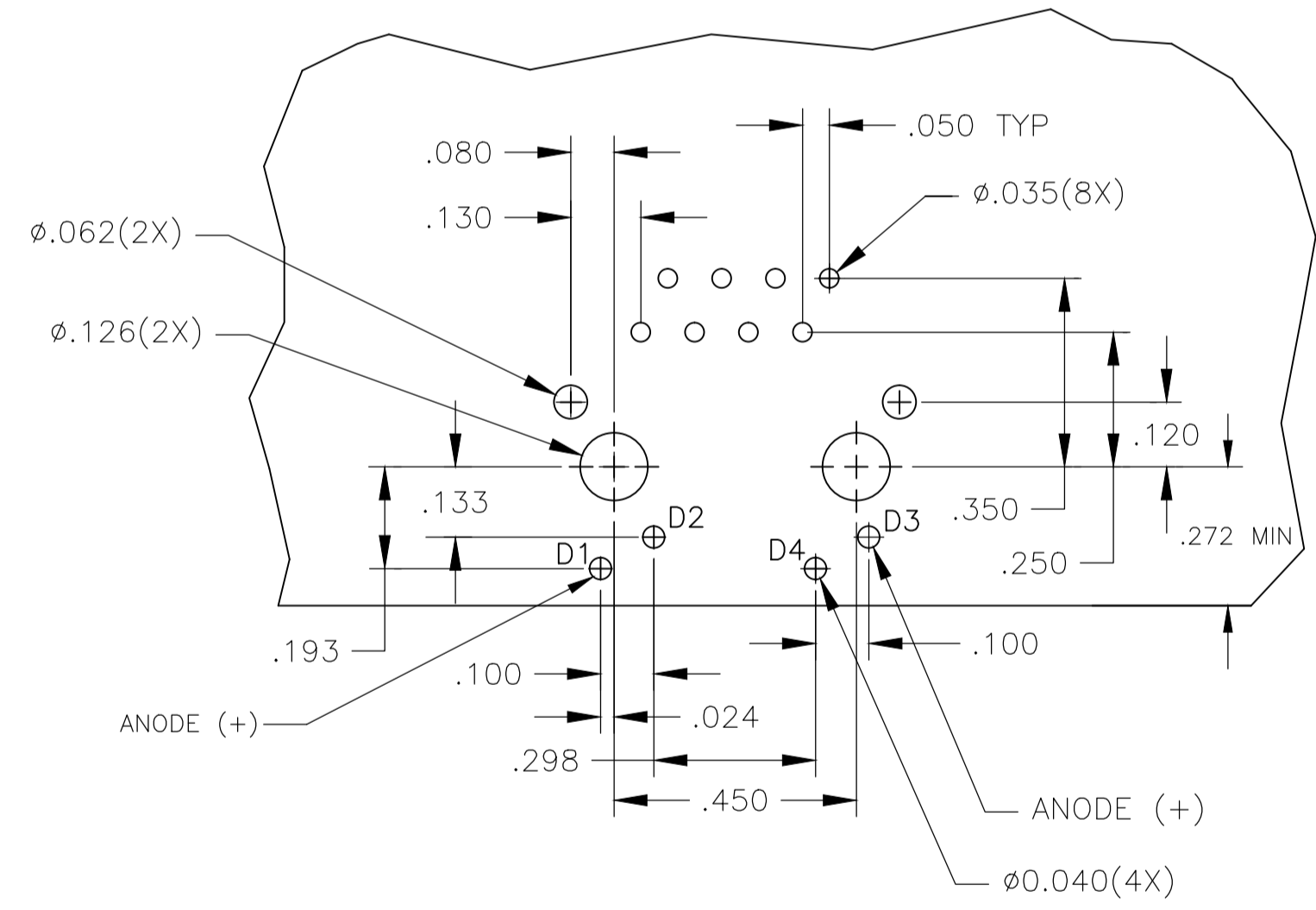

Suggested PCB Layout (Component Side)

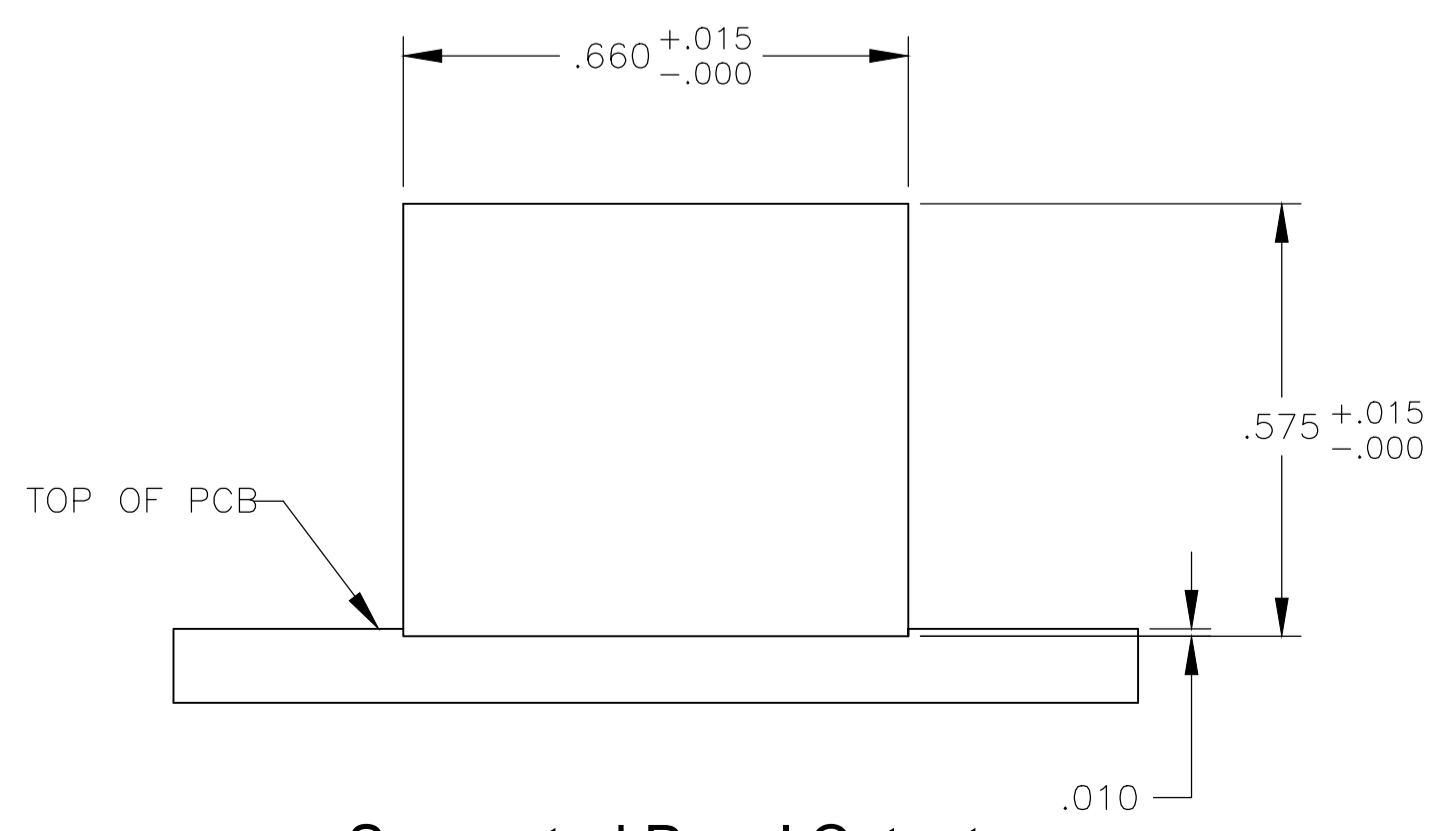

Suggested Panel Cutout

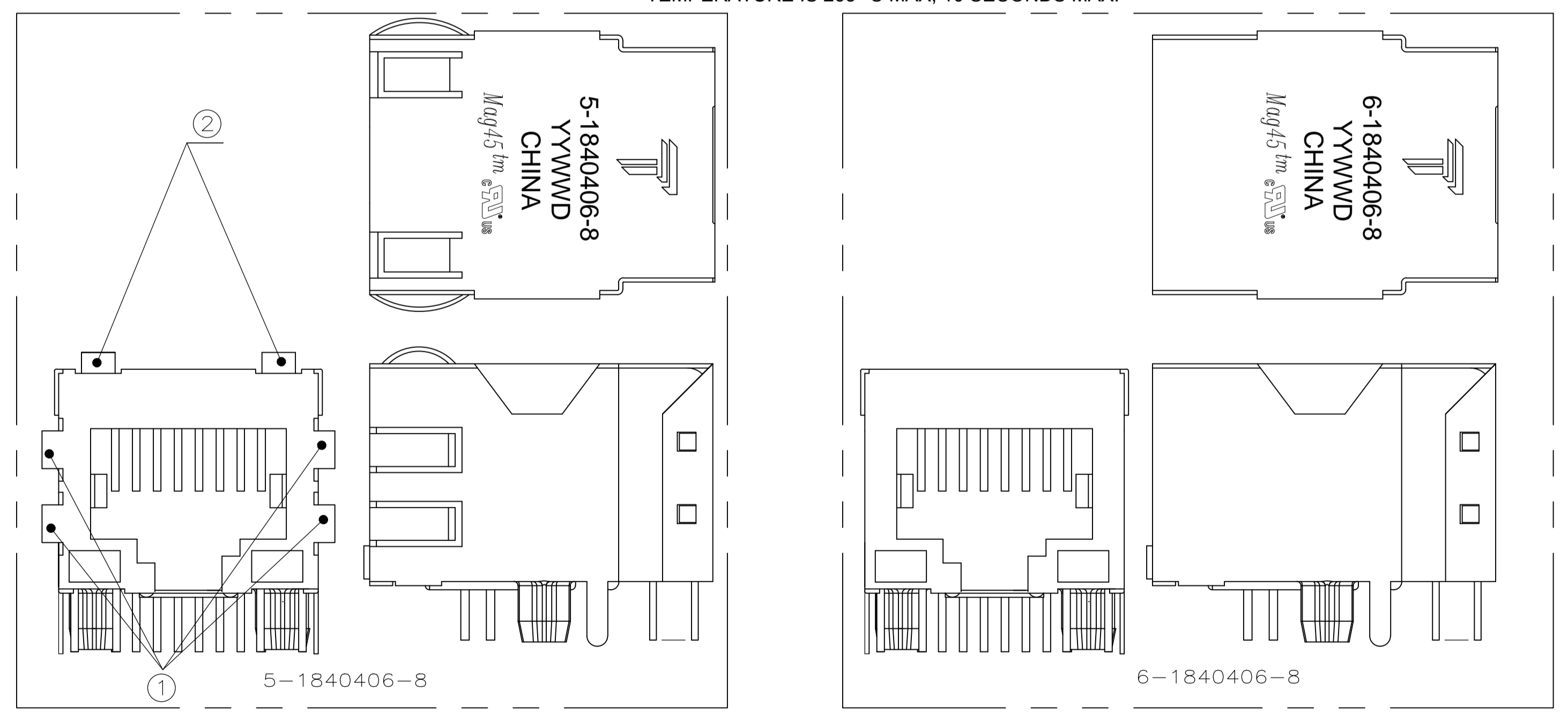

- ⚠ **MATERIALS:**
 - HOUSING - THERMOPLASTIC PET POLYESTER FLAMMABILITY RATING UL 94V-0.
 - SHIELD - .010" THICK, C26800 BRASS PREPLATED WITH 30uinch SEMI-BRIGHT NICKEL;
 - SOLDER TABS POST-DIPPED WITH 100uinch MIN SAC SOLDER
 - MOD JACK CONTACTS - .0157" x .018" THICK, PHOSPHOR BRONZE, 50uinch MIN OVERALL NICKEL UNDERPLATE, WITH SELECT 50uinch MIN HARD GOLD FINISH PLATE.
 - SOLDERTAILS WITH 100uinch MATTE TIN AND/OR SAC SOLDER DIP.
 - LIGHT EMITTING DIODE(LED) - DIFFUSED EPOXY LENS, .020" x .020" CARBON STEEL WIREFRAME LEADS PREPLATED WITH 80 uINCH SILVER OVER 40 uINCH NICKEL UNDERPLATE OVER 40uINCH COPPER UNDERPLATE;
 - POST-PLATED WITH 100 uINCH MIN MATTE TIN AND/OR SAC SOLDER DIP OR PURE TIN SOLDER DIP.
- ⚠ RJ45 JACK CAVITY CONFORMS TO FCC RULES AND REGULATIONS PART 68, SUB PART F.
- ⚠ **MAGNETICS**
 - APPLICATION: 10/100 BASE-T
 - IMPEDANCE: 100 OHMS
 - TURNS RATIO (CHIP:CABLE): TX = 1:1, RX = 1:1
 - OPEN CIRCUIT INDUCTANCE (OCL): 350uH MIN @100kHz, 0.1VRMS, 8mADC BIAS FROM 0°C TO 70°C, TX AND RX
 - PERFORMANCE @ 25°C:
 - INSERTION LOSS (IL): 1.1dB MAX FROM 0.5MHz TO 100MHz
 - RETURN LOSS (RL): 18dB MIN FROM 0.5MHz TO 30MHz
 - 18-20LOG(f/30)dB MIN FROM 30.1MHz TO 60MHz
 - 12dB MIN FROM 60.1MHz TO 80MHz
 - CROSSTALK ATTENUATION: 35dB MIN FROM 0.5MHz TO 40MHz
 - 33-20LOG(f/50)dB MIN FROM 40.1MHz TO 100MHz
 - COMMON MODE REJECTION RATIO (CMRR): 30dB MIN FROM 0.5MHz TO 100MHz
 - ISOLATION VOLTAGE: COMPLIES WITH IEEE802.3 2002, PARA 23.5.1.1, ITEM b.
- 4. OPERATING TEMPERATURE: FROM 0°C TO +70°C.
- ⚠ THE MAGNETICS ARE SYMMETRICAL, AND SUPPORTS AUTO-MDI/MDIX.
- ⚠ **LEDS WITHOUT BUILT-IN RESISTOR**
 - LEDS ARE DRIVEN WITH CONSTANT CURRENT AT APPROX 20 mA
 - LED COLOR: DOMINANT WAVELENGTH (λD): GREEN 568 nm TYP @ IF=20 mA
 - FORWARD VOLTAGE (VF): GREEN 2.2V TYP @ IF=20 mA
 - DOMINANT WAVELENGTH (λD): YELLOW 588 nm TYP @ IF=20 mA
 - FORWARD VOLTAGE (VF): YELLOW 2.1V TYP @ IF=20 mA
- ⚠ TRP CONNECTOR LOGO, PART NUMBER, DATE CODE, COUNTRY OF ORIGIN AND AGENCY APPROVAL MARKING IN APPROXIMATE LOCATION SHOWN.
- 8. THE PART IS RECOMMENDED FOR WAVE SOLDERING PROCESS, PEAK SOLDERING TEMPERATURE IS 265 °C MAX, 10 SECONDS MAX.

NO	NO	GREEN	YELLOW	6-1840406-8
YES	YES	GREEN	YELLOW	5-1840406-8
TOP FINGER	② LEFT AND RIGHT FINGER	LED1	LED2	PART NUMBER

THIS DRAWING IS A CONTROLLED DOCUMENT.		DWN: CLOUD ZENG 4MAY2006	TRP connector Dongguan China
DIMENSIONS: INCHES		CHK: MICHAEL ZHANG 4MAY2006	
TOLERANCES UNLESS OTHERWISE SPECIFIED:		APVD: TEDDY XIONG 4MAY2006	
0 PLC ± - 1 PLC ± .010 2 PLC ± .010 3 PLC ± .005 4 PLC ± - ANGLES ± -		PRODUCT SPEC: 108-2100 APPLICATION SPEC: - SIZE: - WEIGHT: - CUSTOMER DRAWING: -	
NAME: 1X1 MAG45(TM), 4N2P13 10/100 ETHERNET SCHEMATIC, 326P13 MAGNETIC CIRCUIT, SHIELDED, DECOUPLING CAPACITOR, WITH LEADS SCALE: NTS SHEET: 1 OF 1 REV: E		CAGE CODE: 00779 DRAWING NO: 1840406	