

REVISIONS		DATE	BY
T	TRP		200
C	LOGO CHANGE	07/HR2013	PP KZ

MECHANICAL:

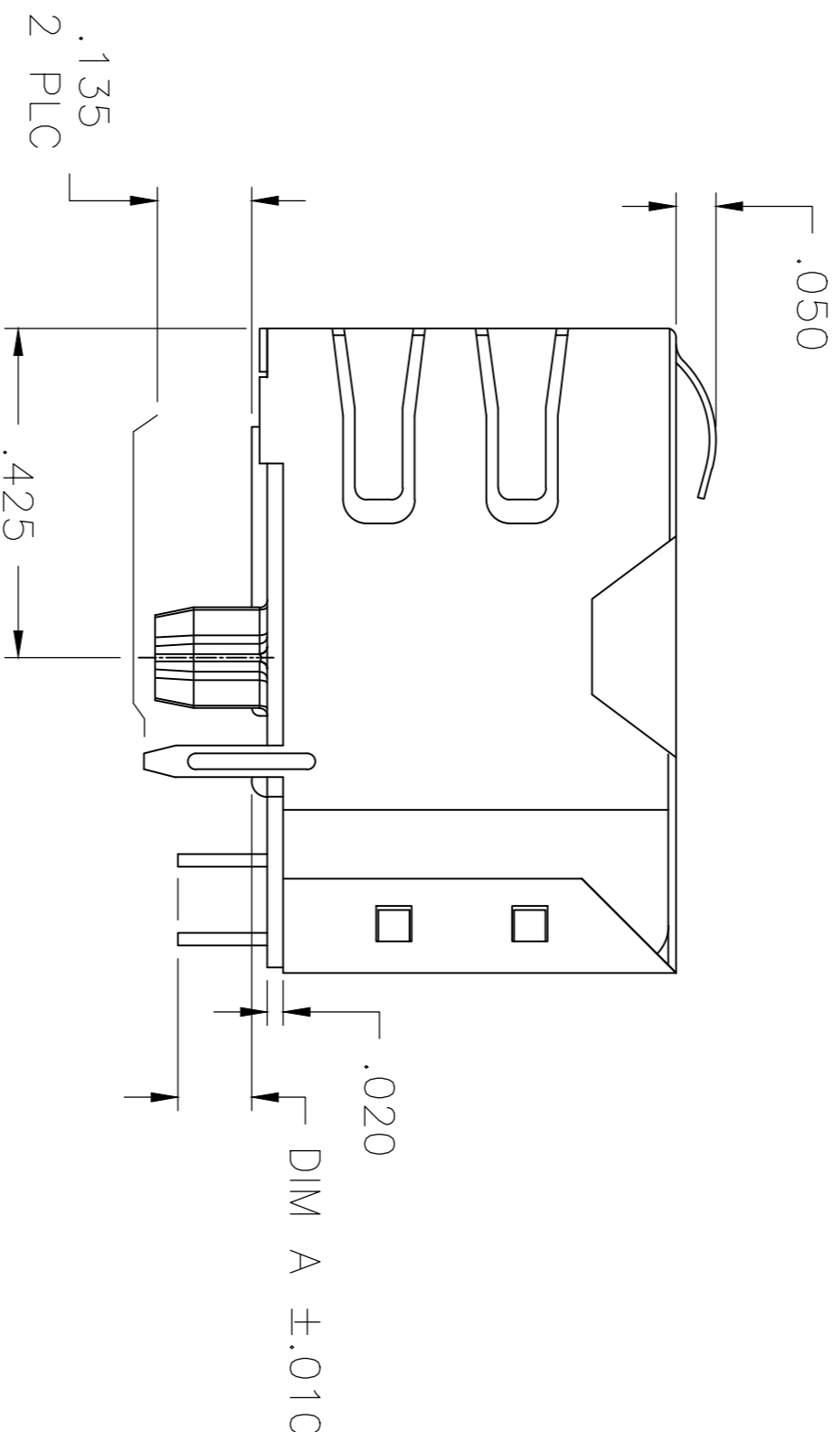
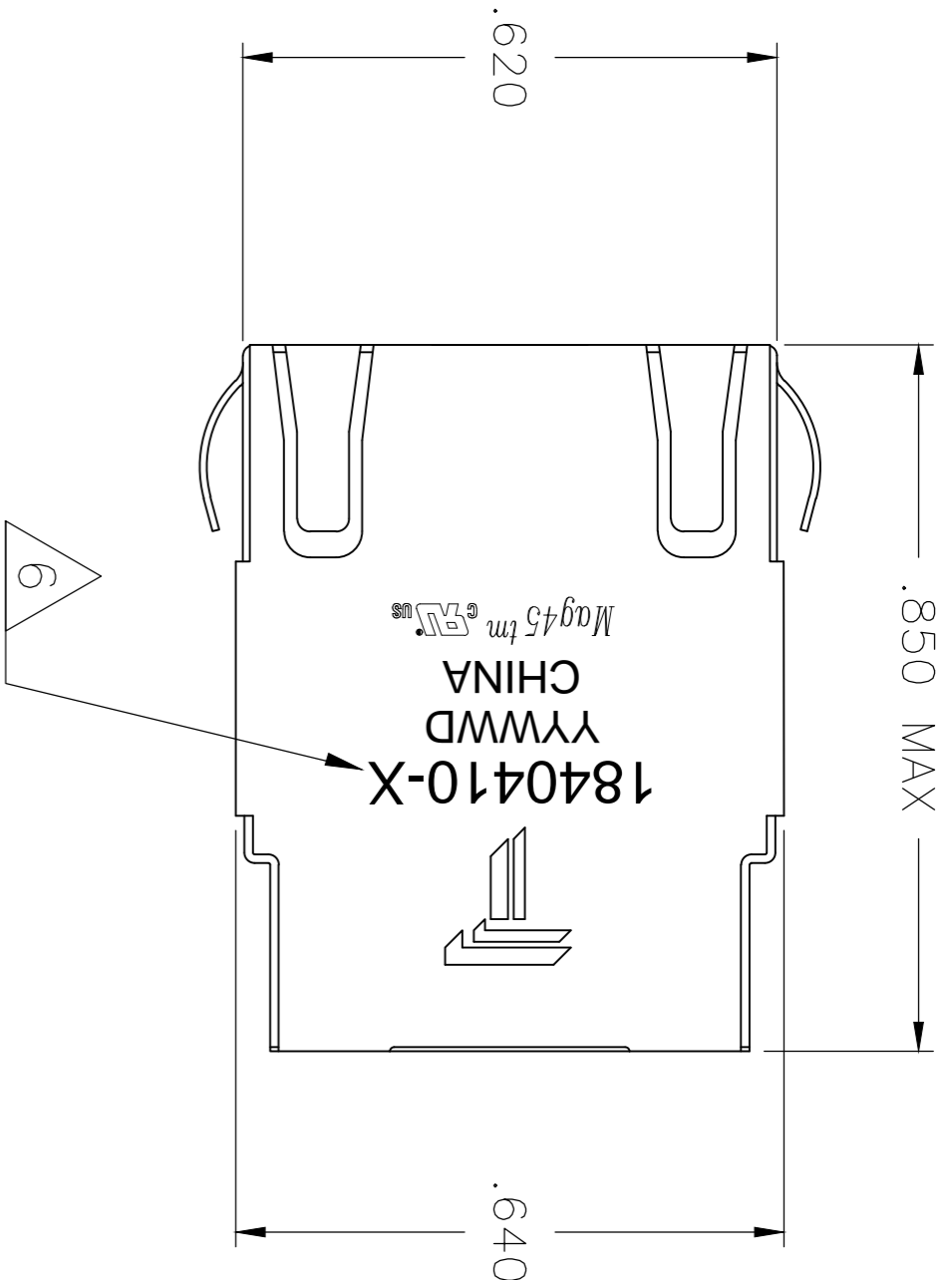
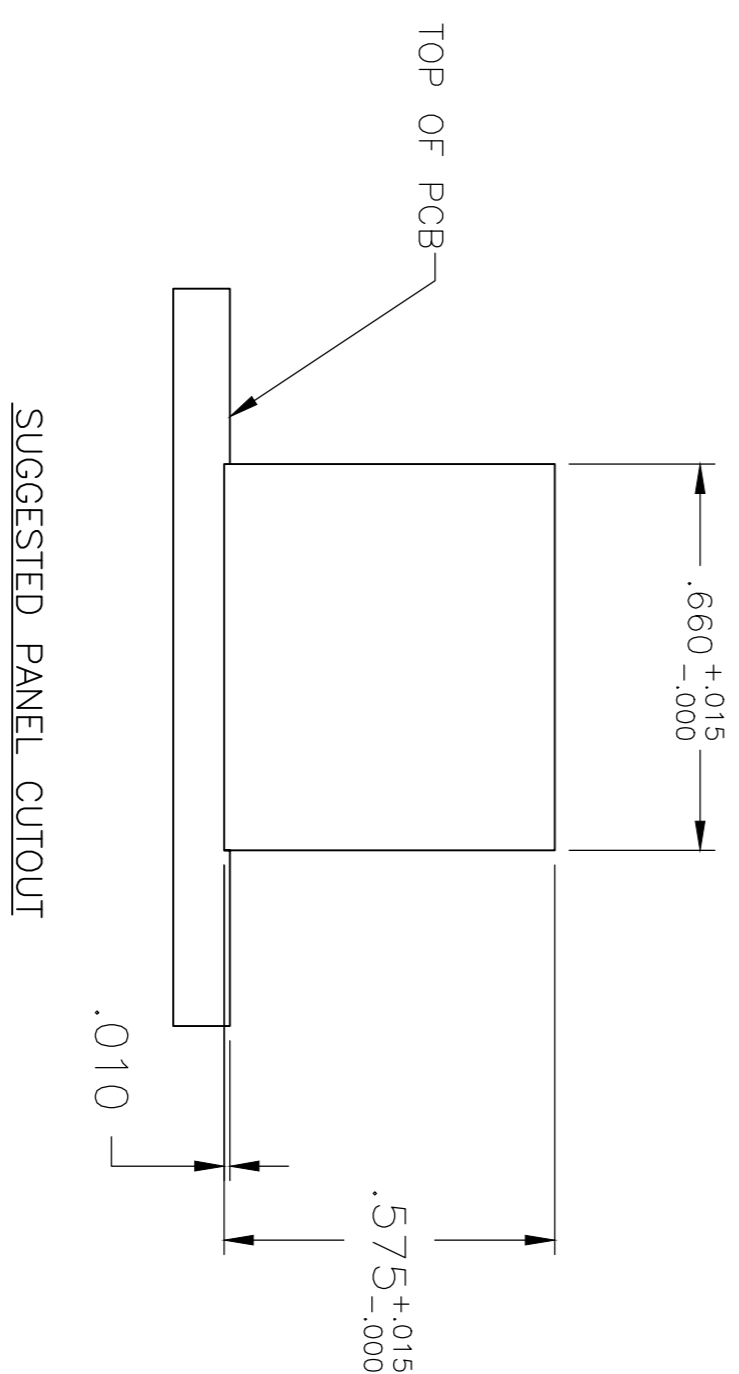
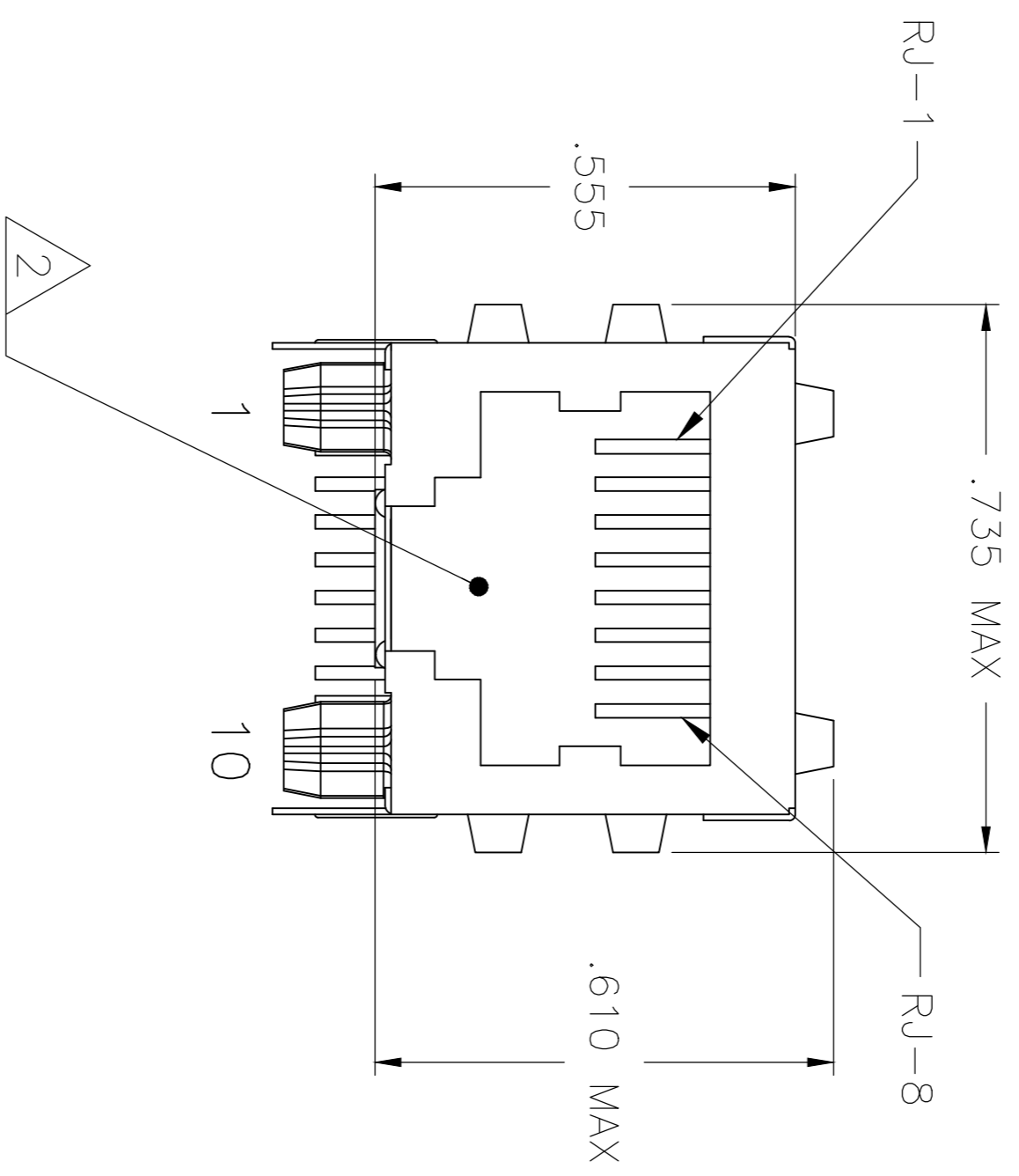
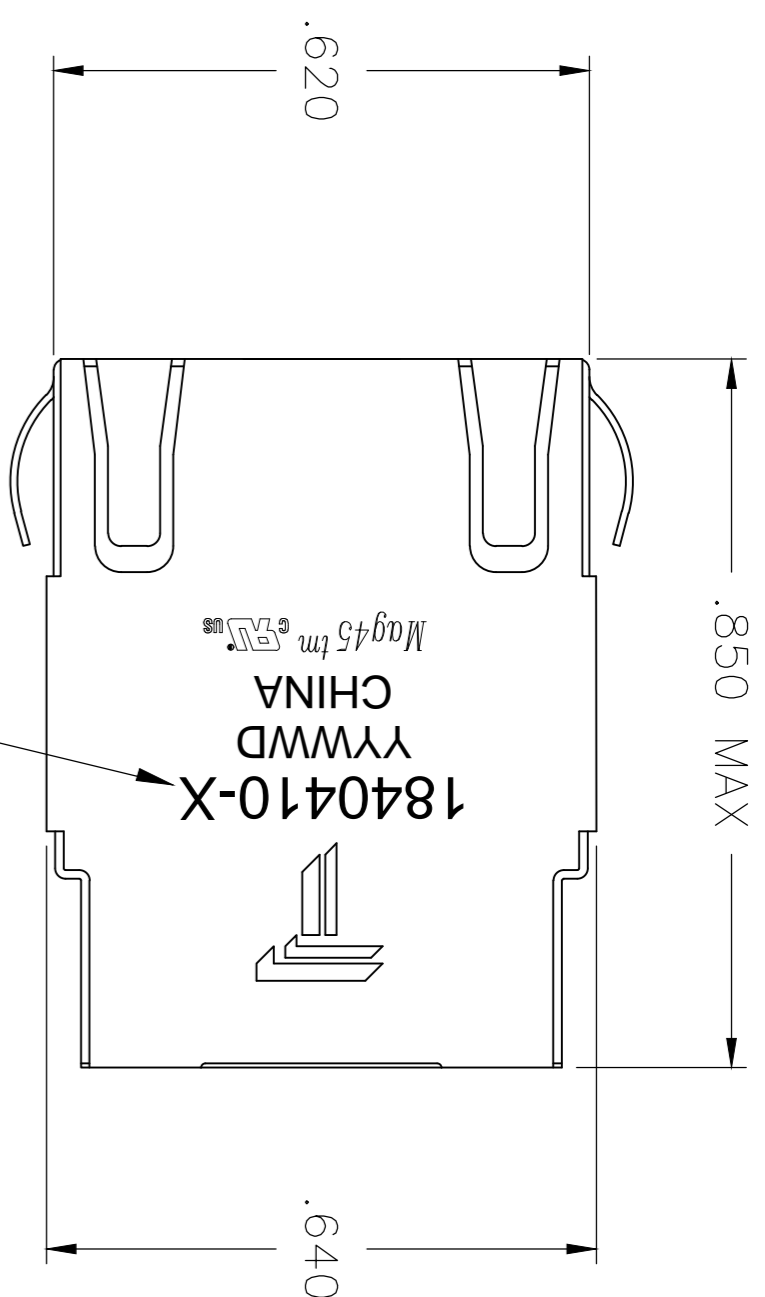

ELECTRICAL:

4G46ETP1 GIGABIT CIRCUIT

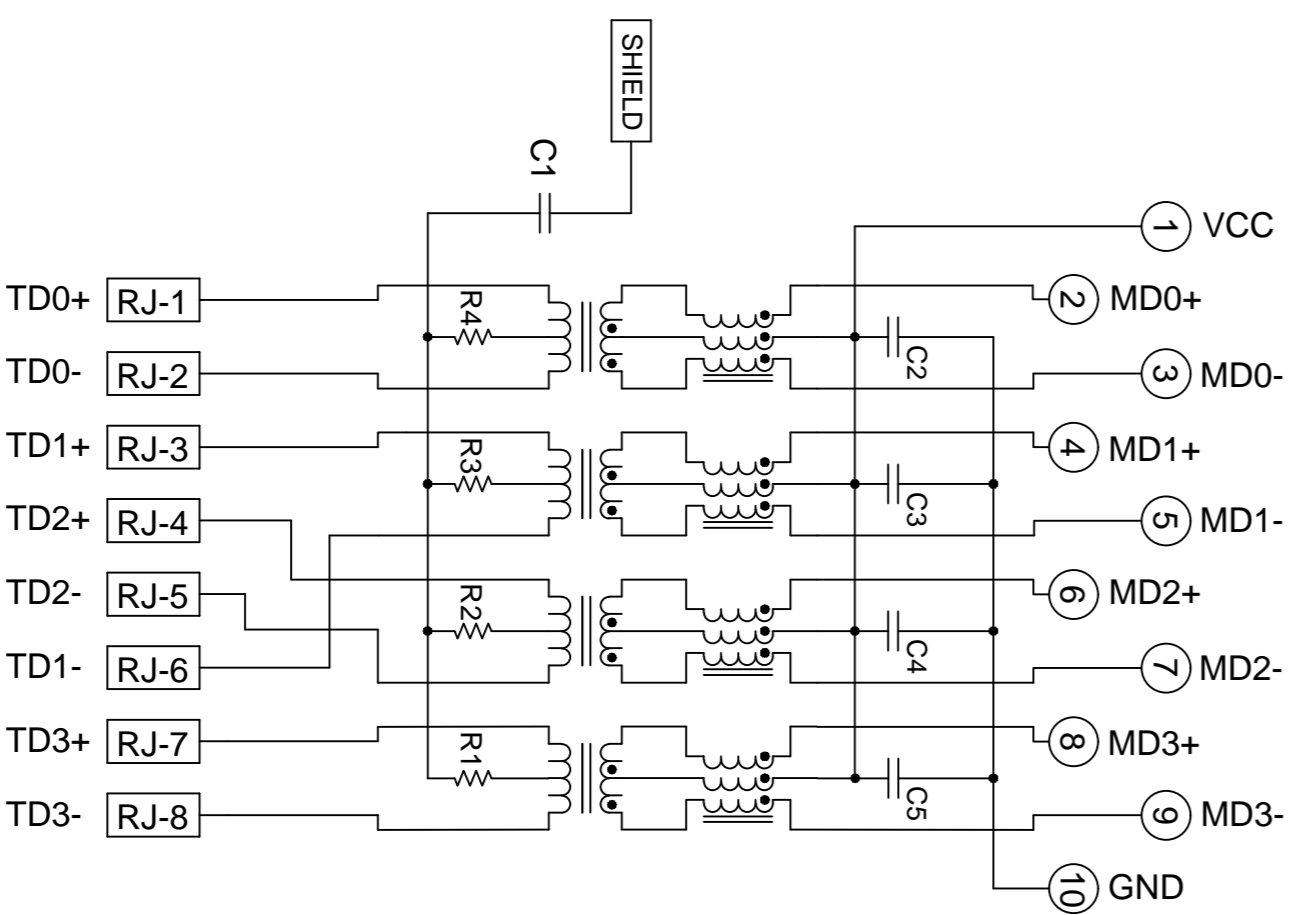

- C1=1000PF, CAPACITOR
- R1-R4=75 OHMS, 1/16W RESISTORS
- C2-C5=0.1uF, 50V CAPACITOR

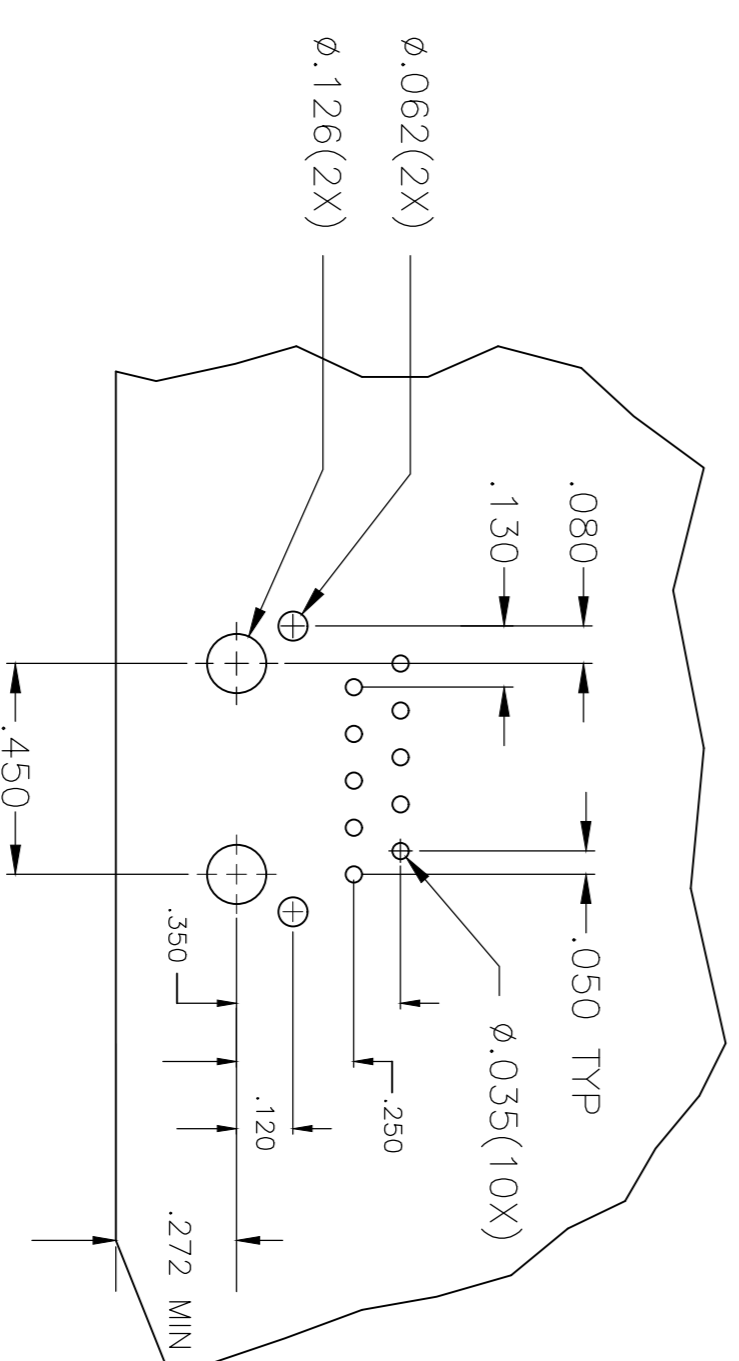

SUGGESTED PCB LAYOUT COMPONENT SIDE

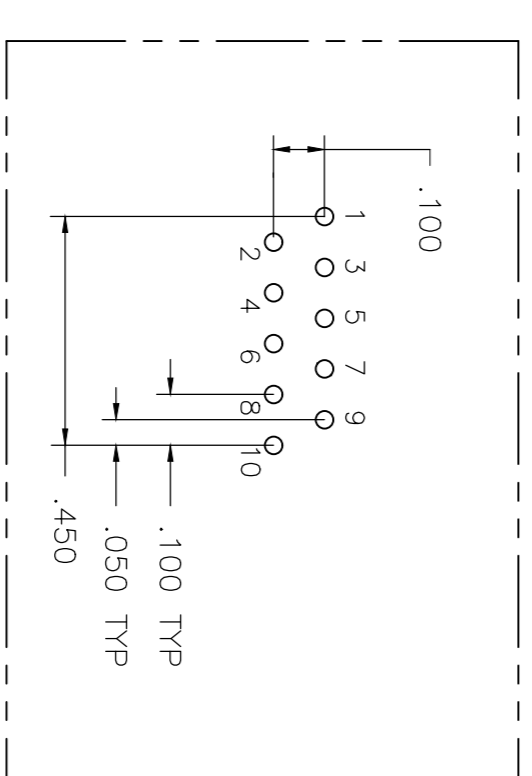

PIN DESIGNATIONS

- NOTES:
- MATERIALS
    - HOUSING: THERMOPLASTIC, FLAMMABILITY RATING UL 94V-0.
    - SHIELD: BRASS C26800 0.008 INCH THICK, PREPLATED WITH 50UNCH MIN SEMI-BRIGHT NICKEL. SOLDER TABS POST DIPPED WITH 100UNCH MIN SAC SOLDER.
    - CONTACTS: PHOSPHOR BRONZE 0.0157 X 0.018", 50UNCH MIN OVERALL NICKEL UNDERPLATE, WITH SELECTIVE 50UNCH MIN HARD GOLD FINISH PLATE.
    - SOLDER TAILS: 100UNCH MIN MATTE TIN AND/OR SAC SOLDER DIPP.
  - RJ45 JACK CAVITY CONFORMS TO FCC RULES AND REGULATIONS PART 68 SUB PART F.

- MAGNETICS
  - APPLICATION: 10/100/1000 BASE-T1, EXTENDED TEMPERATURE
  - IMPEDANCE: 100 OHMS
  - TURNS RATIO (CHIP: CABLE): 1:1 ALL FOUR PAIRS
  - OPEN CIRCUIT INDUCTANCE (OCL): 350uH MIN. @100kHz, 0.1VRMS, 8mADC BIAS FROM -40°C TO +85°C, ALL FOUR PAIRS
  - ALL FOUR PAIRS BI-DIRECTIONAL
  - PERFORMANCE @ 25°C:
    - INSERTION LOSS (IL): 1.1dB MAX. FROM 0.5MHz TO 100MHz
    - RETURN LOSS (RL): 18dB MIN FROM 0.5MHz TO 40MHz
    - CROSSTALK ATTENUATION: 35dB MIN. FROM 0.5MHz TO 40MHz
    - 33-20LOG(f/50)dB MIN. FROM 40.1MHz TO 100MHz
    - 12-20LOG(f/80)dB MIN. FROM 40.1MHz TO 100MHz
  - COMMON MODE REJECTION RATIO (CMRR): 30dB MIN. FROM 0.5MHz TO 100MHz
  - ISOLATION VOLTAGE:
    - 1840410-1, 1840410-2 COMPLY WITH IEEE802.3 2002, PARA 40.6.1.1, ITEM b.
    - 1840410-6 COMPLIES WITH IEEE802.3 2002, PARA 40.6.1.1, ITEM a and b.
- OPERATING TEMPERATURE: FROM -40°C TO +85°C.
- INDICATED MAGNETIC CONNECTIONS ARE SYMMETRICAL TO SUPPORT AUTO-MDI/MDIX.
- TRP CONNECTOR LOGO, PART NUMBER, DATE CODE, COUNTRY OF ORIGIN AND AGENCY APPROVAL MARKING IN APPROXIMATE LOCATION SHOWN.
- THESE PARTS ARE RECOMMENDED FOR WAVE SOLDERING PROCESS. PREHEAT TEMPERATURE IS 120°C TO 160°C, 120 SECONDS TO 180 SECONDS. PEAK WAVE SOLDERING TEMPERATURE IS 260°C MAX, 10 SECONDS MAX.

THIS DRAWING IS A CONTROLLED DOCUMENT.		REV	QUANTITY	DATE
DRAWING NO. 1840410-1		CMK	30002006	
DESIGNER: MICHAEL ZHANG		CHK	30002006	
DRAWN BY: TEDDY XIONG		APP	30002006	
PRODUCT SPEC: 108-2100		DATE		
APPLICATION SPEC: 108-2100		SCALE		
MATERIAL: 1		WEIGHT		
FINISH: 1		CUSTOMER DRAWING		

3 KV	0.090	1840410-6
2 KV	0.145	1840410-2
2 KV	0.090	1840410-1



TRP connector  
Dongguan China

1X1 MAG45(TM) MODULAR JACK  
4G46ETP1 GIGABIT CIRCUIT, 10 PIN FOOTPRINT

SIZE CODE DRAWING NO. RESTRICTED TO  
A1100779 ©=1840410