

P	LTR	DESCRIPTION	DATE	DWN	APVD
C		LOGO CHANGE	07APR2013	PP	KZ

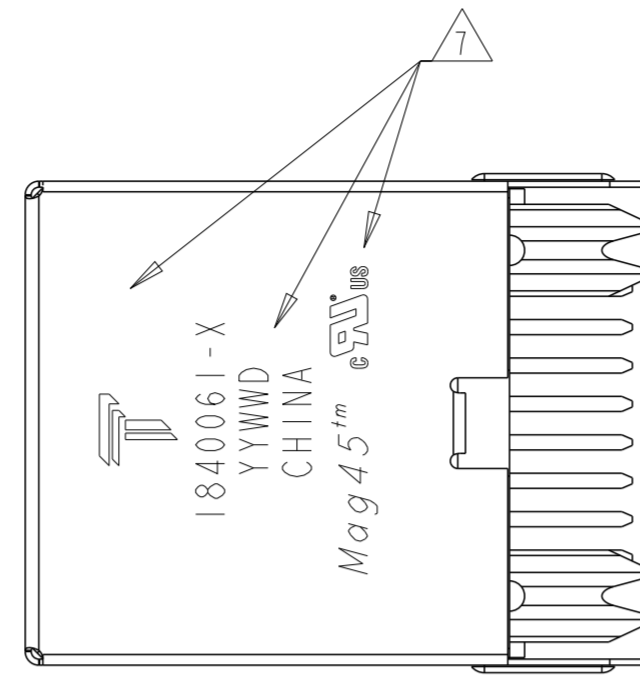
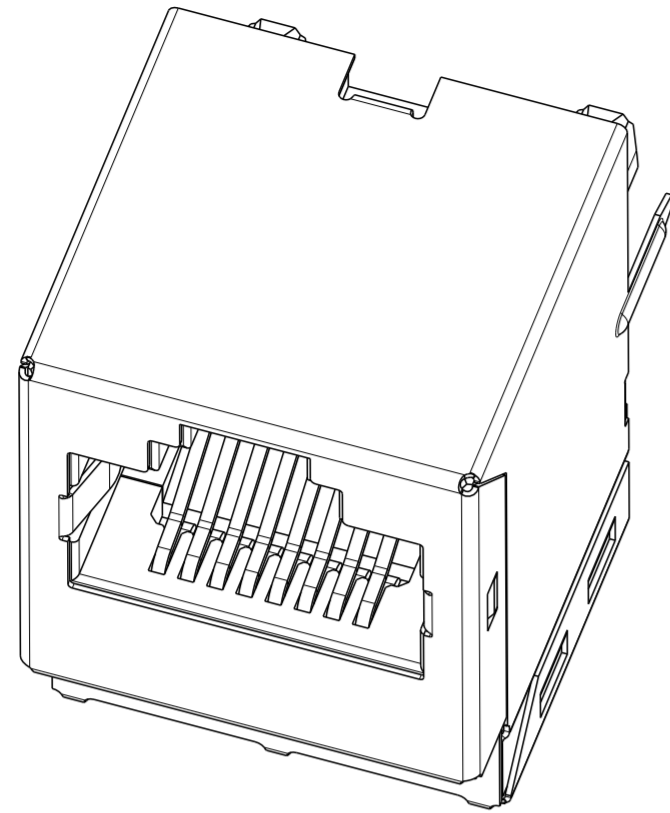

- 1 MATERIALS
 HOUSING: THERMOPLASTIC, BLACK, FLAMMABILITY RATED UL 94V-0
 SHIELD: BRASS, 0.20mm THICK, PREPLATED WITH MIN 0.76um SEMI-BRIGHT NICKEL POST DIPPED WITH 2.54um MIN SAC SOLDER AT GROUND PINS.
 CONTACT: PHOSPHOR BRONZE, WITH 1.27um MIN OVERALL NICKEL UNDERPLATE AND SELECTIVE 1.27um MIN GOLD PLATING AT MATING INTERFACE
 SOLDER TAIL: PHOSPHOR BRONZE, WITH 1.27um MIN OVERALL NICKEL UNDERPLATE AND PLATED WITH 2.54um MIN TIN

- 2 MAGNETICS
 -APPLICATION: 10/100 BASE-T, EXTENDED TEMPERATURE
 -IMPEDANCE: 100 OHMS
 -TURNS RATIO (CHIP:CABLE): TX = 1:1, RX = 1:1
 -OPEN CIRCUIT INDUCTANCE (OCL): 350uH MIN @100kHz, 0.1VRMS, 8mADC BIAS FROM -40°C TO +85°C, TX AND RX
 -PERFORMANCE @ 25°C:
 INSERTION LOSS (IL): 1.1dB MAX FROM 0.5MHz TO 100MHz
 RETURN LOSS (RL): 18dB MIN FROM 0.5MHz TO 30MHz
 18-20LOG(f/30)dB MIN FROM 30.1MHz TO 60MHz
 12dB MIN FROM 60.1MHz TO 80MHz
 CROSSTALK ATTENUATION: 35dB MIN FROM 0.5MHz TO 40MHz
 33-20LOG(f/50)dB MIN FROM 40.1MHz TO 100MHz
 COMMON MODE REJECTION RATIO (CMRR): 30dB MIN FROM 0.5MHz TO 100MHz
 -ISOLATION VOLTAGE: 2250VDC (MAX) FOR 60 SECONDS WITH A RISE TIME OF 500V/SEC

3 THE MAGNETIC ARE SYMMETRICAL AND SUPPORT AUTO-MDIX OPERATION.

4. OPERATING TEMPERATURE: FROM -40°C TO +85°C

5 ALL DIMENSIONS TO BE NOMINAL UNLESS OTHERWISE NOTED

6 RJ45 CAVITY CONFORMS TO FCC RULES AND REGULATION PART 68 SUB-PART F.

7 TRADEMARK, PART NUMBER, DATE CODE, COUNTRY OF ORIGIN, AND AGENCY APPROVAL MARKING IN APPROXIMATE LOCATION SHOW. DATE CODE: "YY" IS YEAR, "WW" IS WORK WEEK, "D" IS DAY OF WEEK, WITH SUNDAY=1

8 RECOMMENDED FOR WAVE SOLDERING PROCESS, PEAK SOLDERING TEMPERATURE IS 260 °C MAX, 10 SECONDS MAX

9 COMPLIANT IR REFLOW SOLDERING PROCESS, PEAK SOLDERING TEMPERATURE 260°C MAX DURATION TIME 10 SECONDS MAX, OVER 230°C WITHIN 40-60 SECONDS.

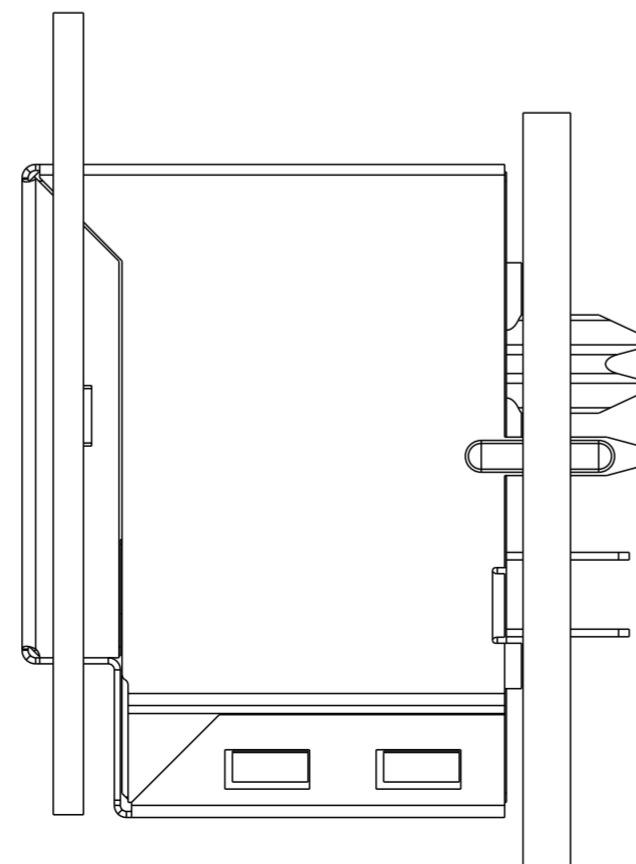
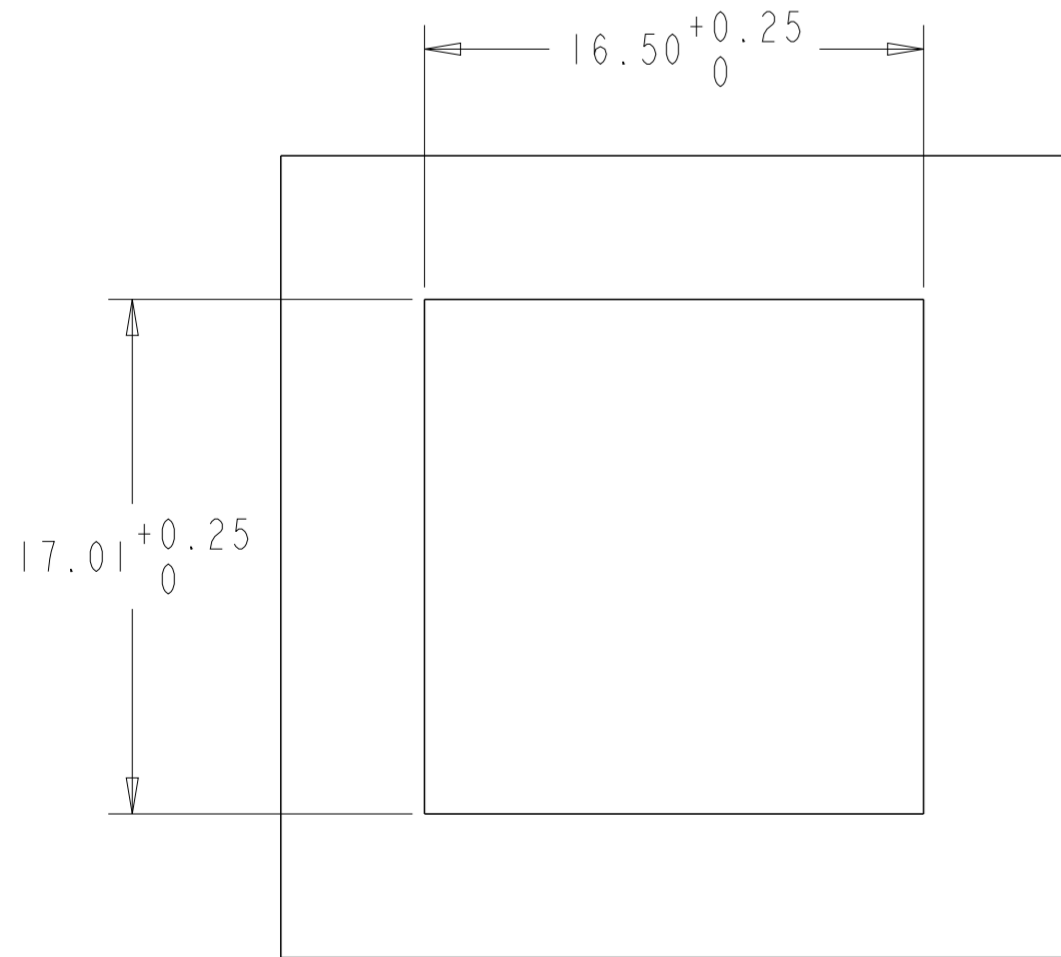
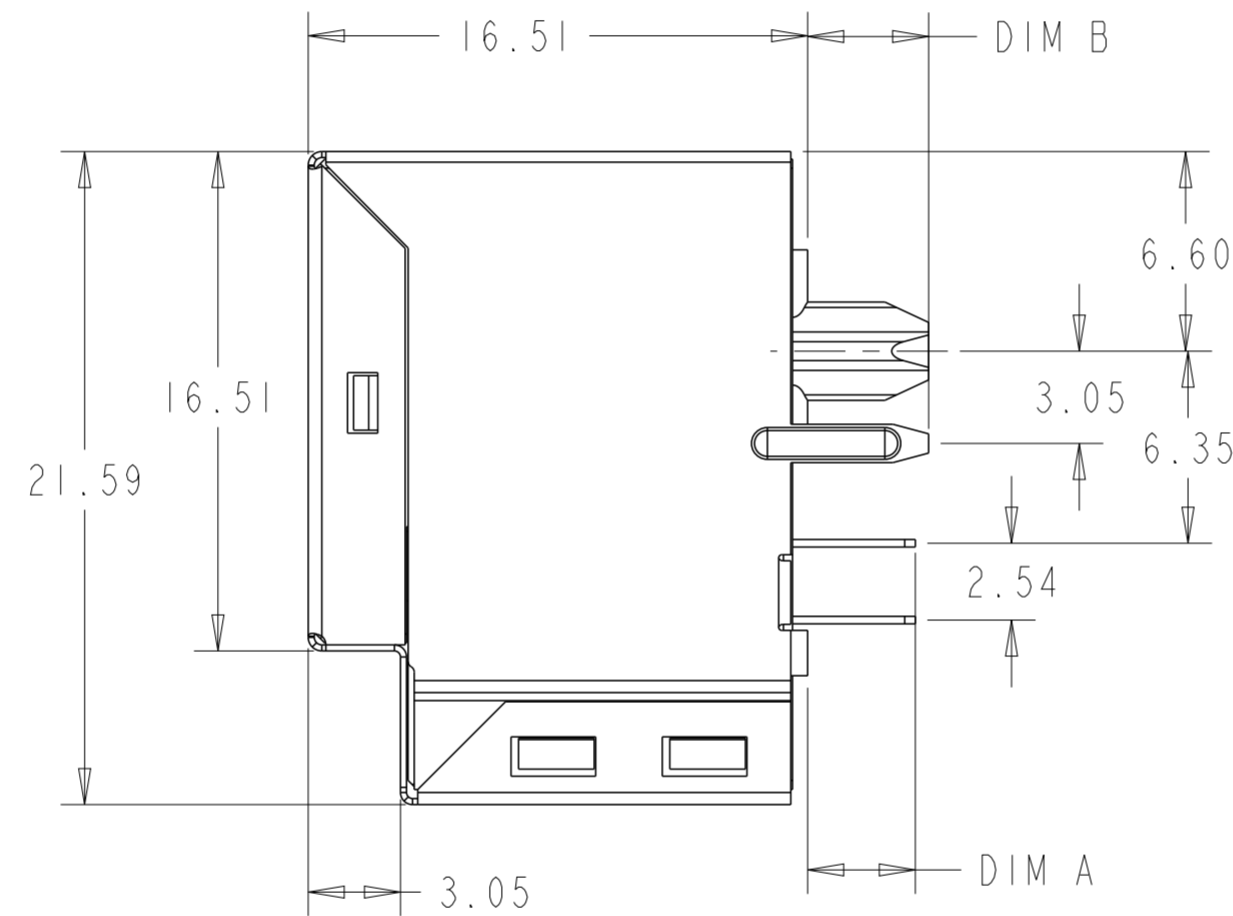
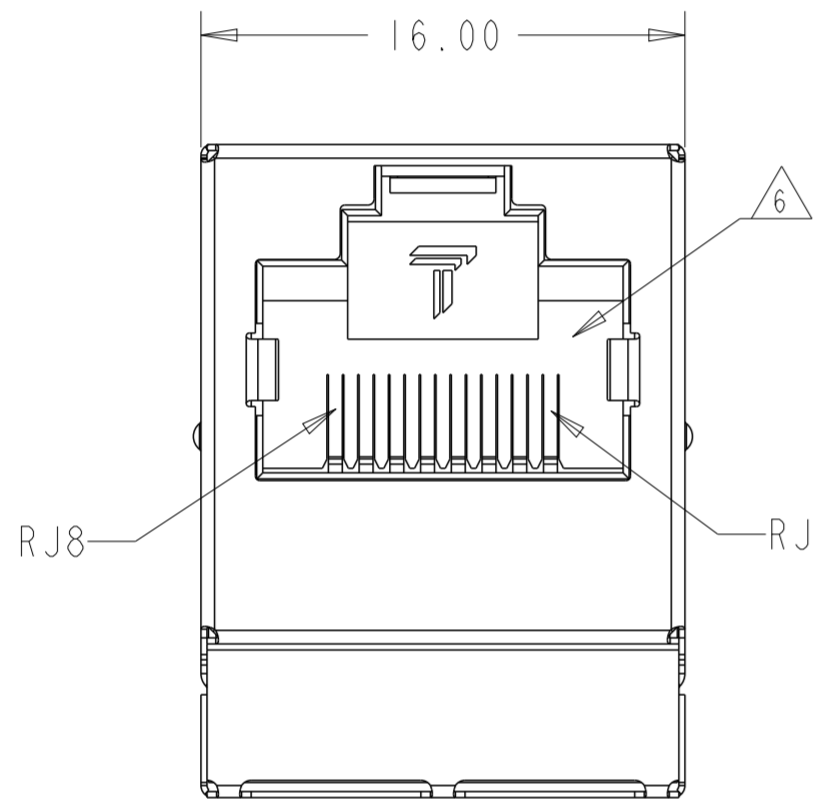

9	2.36	2.36	1840061-2
8	4.00	3.56	1840061-1
SOLDERING PROCESS	DIM B	DIM A	PART NUMBER

THIS DRAWING IS A CONTROLLED DOCUMENT.		DWN PAUL PENG 09MAY2011	 TRP connector Dongguan China	
DIMENSIONS: mm		CHK QUENTIN LIU 09MAY2011		
TOLERANCES UNLESS OTHERWISE SPECIFIED:		APVD LI JUN RAO 09MAY2011		
0 PLC ±0.25 1 PLC ±0.25 2 PLC ±0.25 3 PLC ±0.25 4 PLC ± ANGLES ± FINISH ±		PRODUCT SPEC 108-2100 APPLICATION SPEC WEIGHT CUSTOMER DRAWING		
MATERIAL 1		NAME IXI MAG45(TM) MODULAR JACK, VERTICAL TYPE, 426ETPI3 CIRCUIT, WITHOUT LED SIZE A2 CAGE CODE 00779 DRAWING NO C-1840061 RESTRICTED TO SCALE 3:1 SHEET 1 OF 2 REV C		

426ETPI3 10/100 BASE-T CIRCUIT

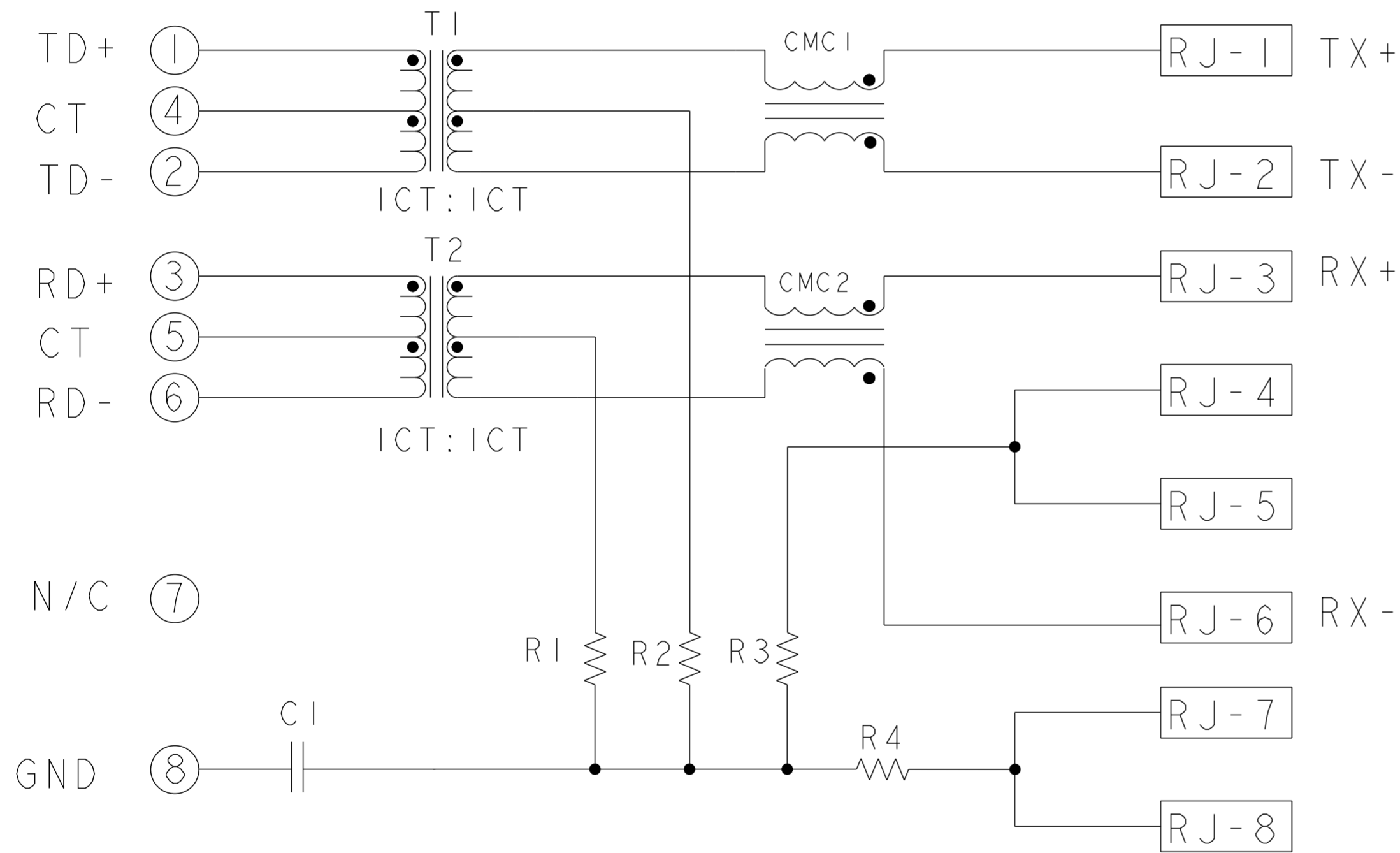

C1 = 1000pF, 2KV, CAPACITOR
 R1 - R4 = 75 ohms, RESISTOR

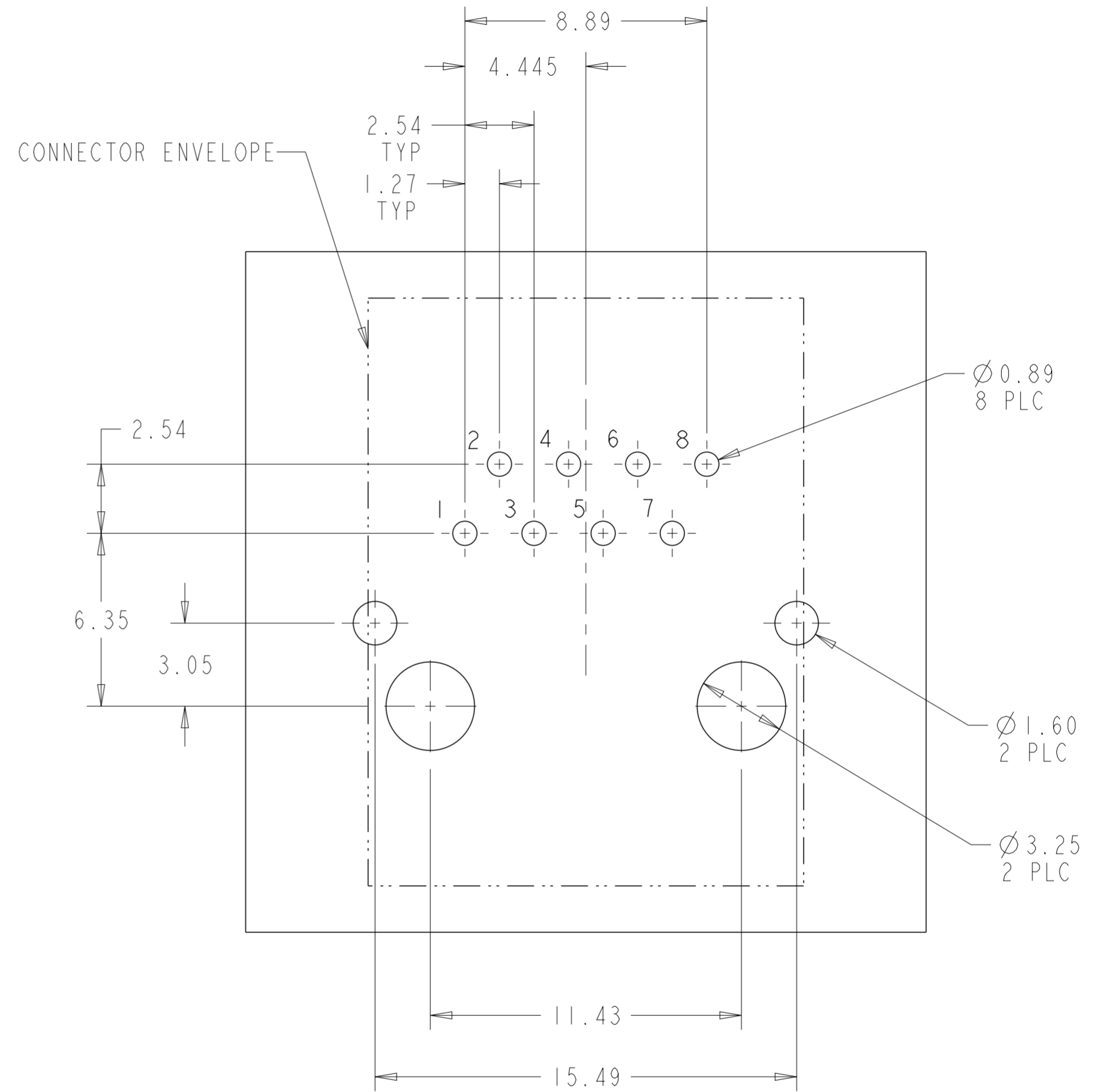

SUGGESTED PCB LAYOUT (TOL: ±0.05)
 (COMPONENT SIDE VIEW)

THIS DRAWING IS A CONTROLLED DOCUMENT.		DWN PAUL PENG 09MAY2011	 TRP connector Dongguan China
DIMENSIONS: mm		CHK QUENTIN LIU 09MAY2011	
		APVD LI JUN RAO 09MAY2011	
TOLERANCES UNLESS OTHERWISE SPECIFIED:		PRODUCT SPEC 108-2100	NAME 1X1 MAG45(TM) MODULAR JACK, VERTICAL TYPE, 426ETPI3 CIRCUIT, WITHOUT LED
0 PLC ±0.25		APPLICATION SPEC	SIZE A2
1 PLC ±0.25		WEIGHT	CAGE CODE 00779
2 PLC ±0.25		CUSTOMER DRAWING	DRAWING NO C-1840061
3 PLC ±0.25		SCALE 3:1	RESTRICTED TO
4 PLC ±		SHEET 2 OF 2	REV C
ANGLES ±			
FINISH ±			