

P	LTR	DESCRIPTION	DATE	DWN	APVD
C		LOGO CHANGE	07APR2013	PP	KZ

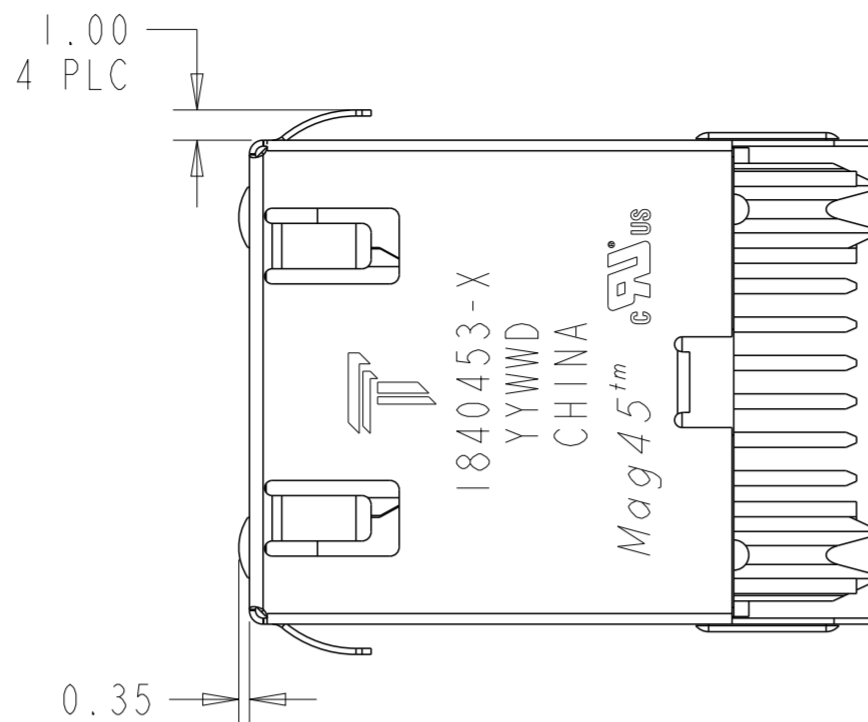
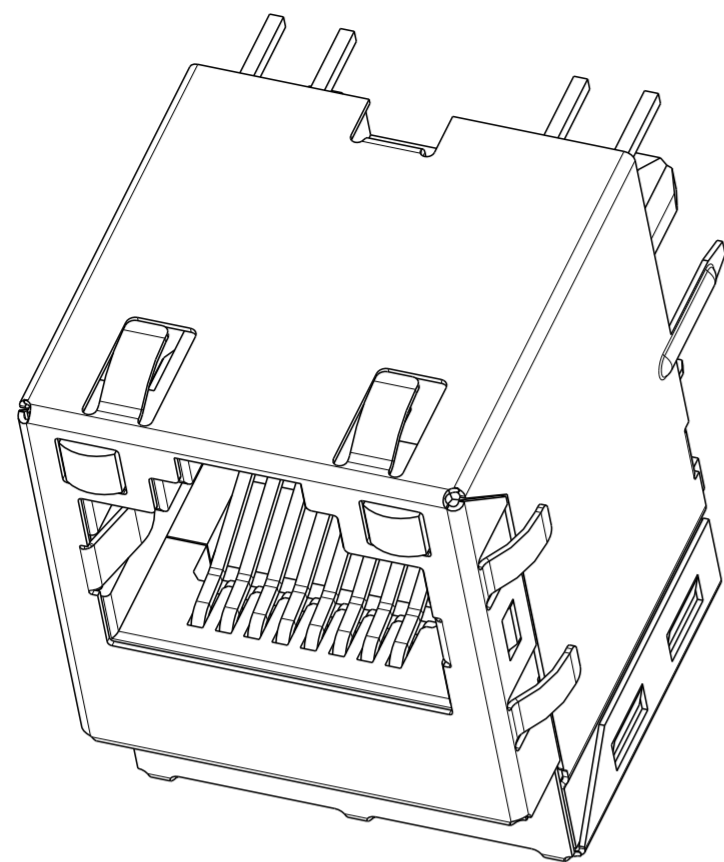

1. MATERIALS

HOUSING: THERMOPLASTIC, BLACK, FLAMMABILITY RATED UL 94V-0  
 SHIELD: BRASS, 0.20mm THICK, PREPLATED WITH MIN 0.76um SEMI-BRIGHT NICKEL POST DIPPED WITH 2.54um MIN SAC SOLDER AT GROUND PINS.  
 CONTACT: PHOSPHOR BRONZE, WITH 1.27um MIN OVERALL NICKEL UNDERPLATE AND SELECTIVE 1.27um MIN GOLD PLATING AT MATING INTERFACE  
 SOLDER TAIL: PHOSPHOR BRONZE, WITH 1.27um MIN OVERALL NICKEL UNDERPLATE AND PLATED WITH 2.54um MIN TIN  
 LED: DIFFUSED EPOXY LENS, 0.50mm SQUARE CARBON STEEL WIREFRAME LEADS PREPLATED WITH 2.03um MIN SILVER OVER 1.02um MIN NICKEL OVER 1.02um MIN COPPER UNDERPLATE POST PLATED WITH 2.54um MIN TIN

2. MAGNETICS

-APPLICATION: 10/100/1000 BASE-T  
 -IMPEDANCE: 100 OHMS  
 -TURNS RATIO (CHIP:CABLE): 1:1 ALL FOUR PAIRS  
 -OPEN CIRCUIT INDUCTANCE (OCL): 350uH MIN @100kHz, 0.1VRMS, 8mADC BIAS FROM 0°C TO 70°C, ALL FOUR PAIRS  
 -ALL FOUR PAIRS BI-DIRECTIONAL  
 -PERFORMANCE @ 25°C:  
 INSERTION LOSS (IL): 1.1dB MAX FROM 0.5MHz TO 100MHz  
 RETURN LOSS (RL): 18dB MIN FROM 0.5MHz TO 40MHz  
 12-20LOG(f/80)dB MIN FROM 40.1MHz TO 100MHz  
 CROSSTALK ATTENUATION: 35dB MIN FROM 0.5MHz TO 40MHz  
 33-20LOG(f/50)dB MIN FROM 40.1MHz TO 100MHz  
 COMMON MODE REJECTION RATIO (CMRR): 30dB MIN FROM 0.5MHz TO 100MHz  
 -ISOLATION VOLTAGE: COMPLIES WITH IEEE802.3 2002, PARA 40.6.1.1, ITEM b.

3. THE MAGNETIC ARE SYMMETRICAL AND SUPPORT AUTO-MDIX OPERATION.

4. OPERATING TEMPERATURE: 0 ~ 70°C

5. LED IS DRIVEN WITH CONSTANT CURRENT AT APPROX 20mA.

DOMINANT WAVELENGTH(λD)  
 GREEN 568nm TYP.at IF=20mA  
 YELLOW 588nm TYP.at IF=20mA

FORWARD VOLTAGE(VF):  
 GREEN 2.2V TYP.at IF=20mA  
 YELLOW 2.1V TYP.at IF=20mA

6. ALL DIMENSIONS TO BE NOMINAL UNLESS OTHERWISE NOTED

7. RJ45 CAVITY CONFORMS TO FCC RULES AND REGULATION PART 68 SUBPART F.

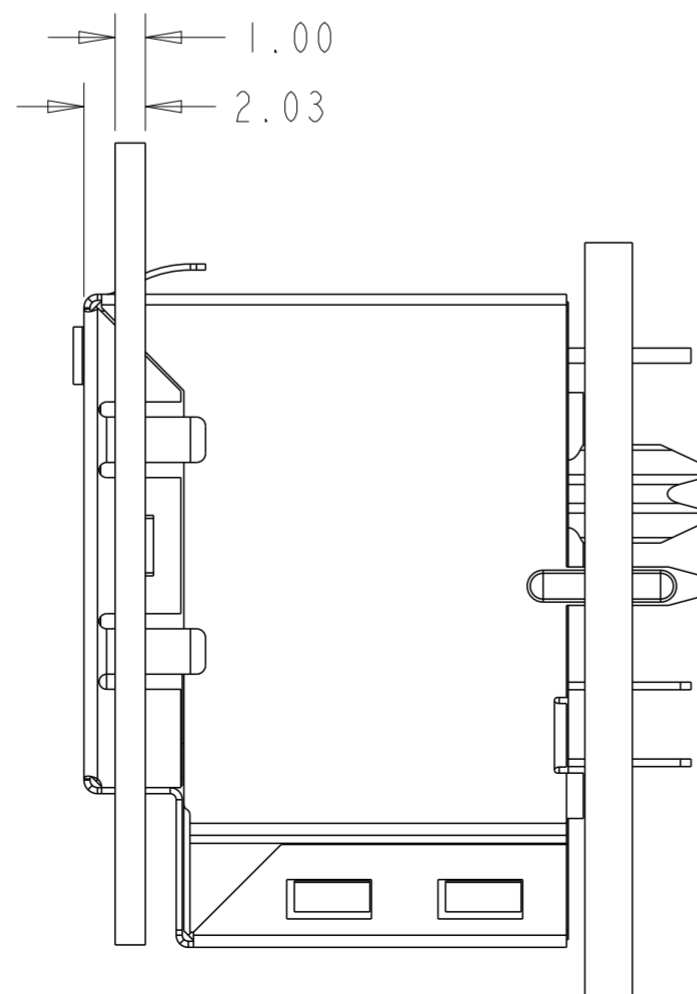
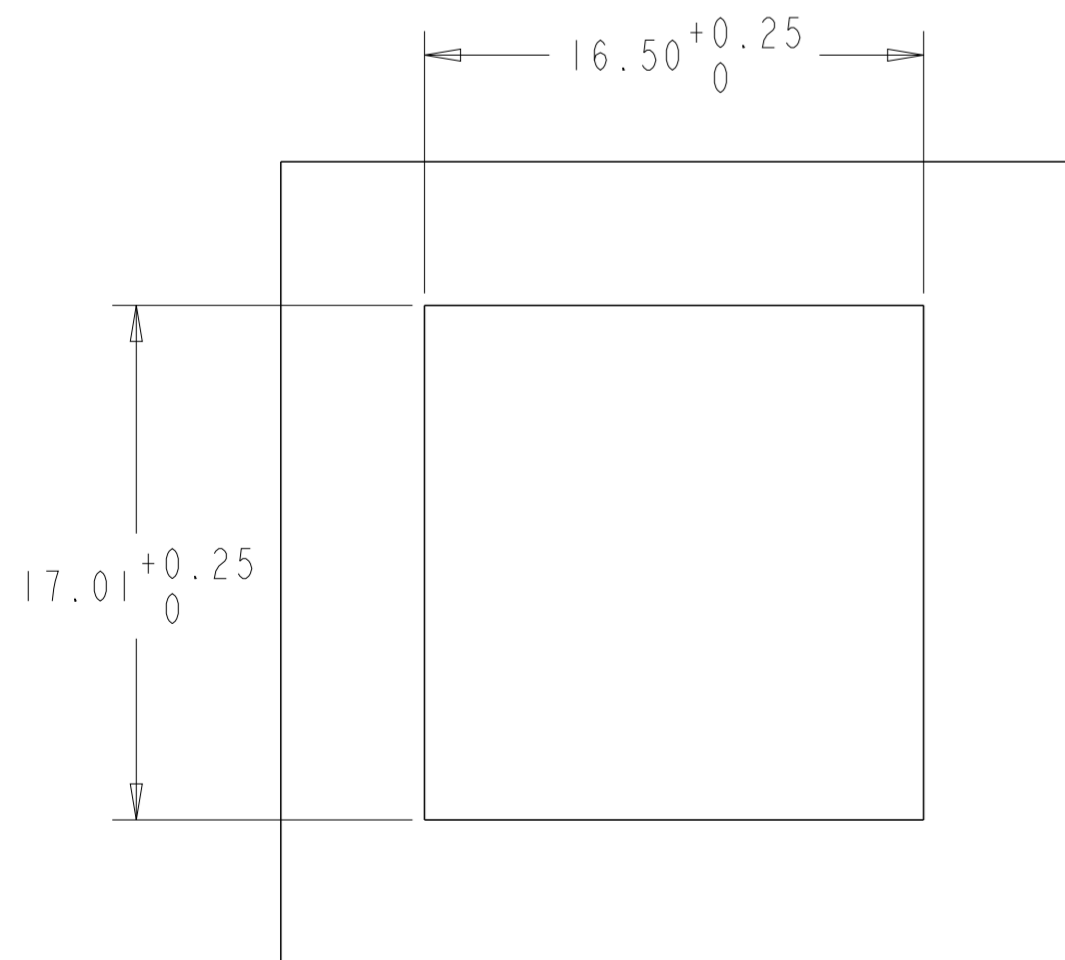
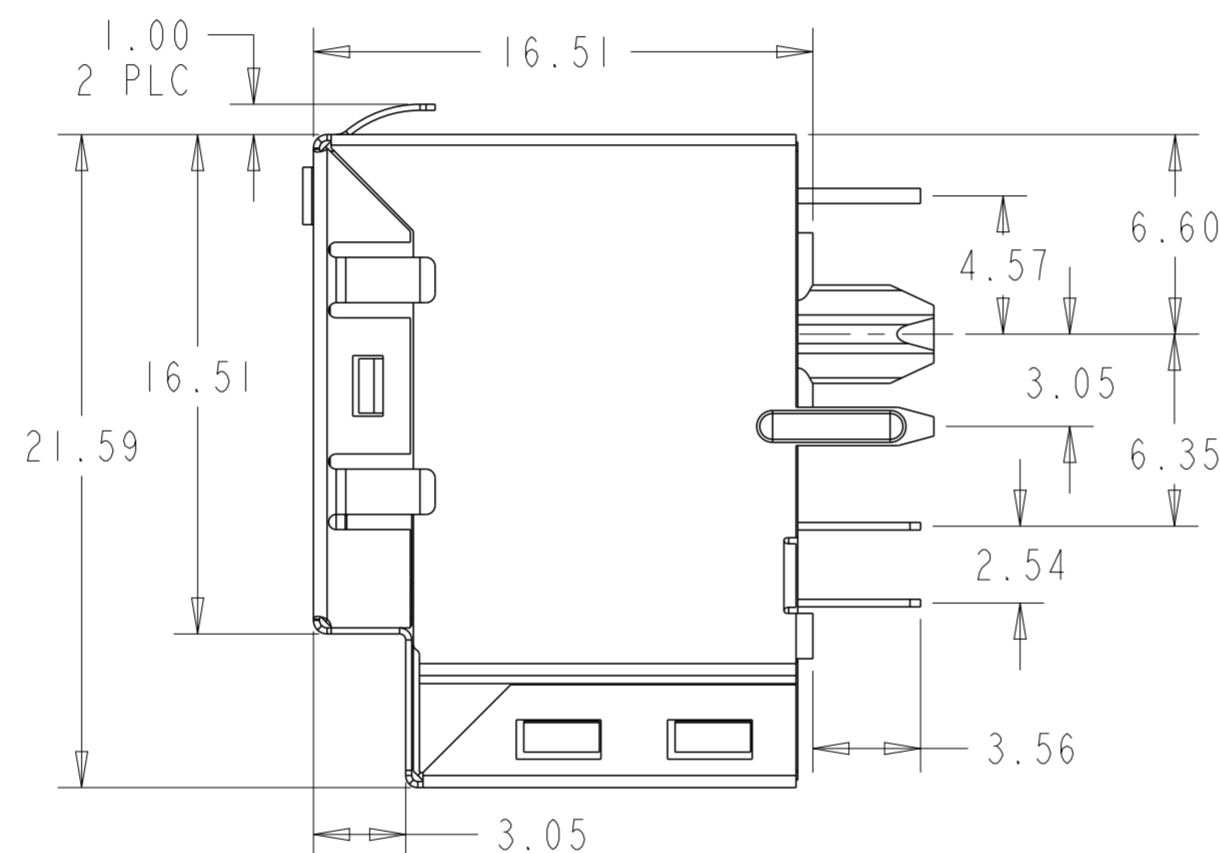
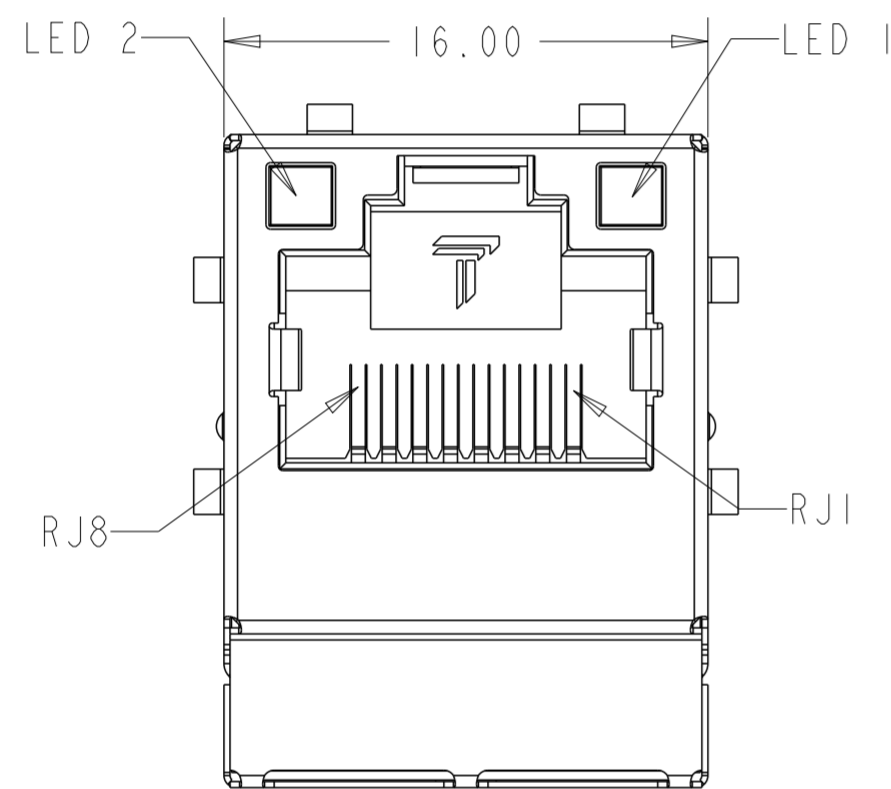

GRN/YEL	GRN/YEL	1840453-4
YELLOW	GREEN	1840453-3
GREEN	YELLOW	1840453-2
GREEN	GREEN	1840453-1
LED 1	LED 2	PART NUMBER

THIS DRAWING IS A CONTROLLED DOCUMENT.		DWN	19NOV2007	 TRP connector Dongguan China	
DIMENSIONS:		CHK	19NOV2007		
mm		APVD	19NOV2007		
		PRODUCT SPEC	108-2100		
TOLERANCES UNLESS OTHERWISE SPECIFIED:		APVD	19NOV2007	NAME	1X1 MAG45(TM) MODULAR JACK, VERTICAL, 4G46PI CIRCUIT, WITH LED
0 PLC	±0.25	APVD	19NOV2007	SIZE	A2
1 PLC	±0.25	APVD	19NOV2007	CAGE CODE	00779
2 PLC	±0.25	APVD	19NOV2007	DRAWING NO	C-1840453
3 PLC	±0.25	APVD	19NOV2007	RESTRICTED TO	
4 PLC	±	APVD	19NOV2007	SCALE	3:1
ANGLES	±	APVD	19NOV2007	SHEET	1 OF 2
FINISH	±	APVD	19NOV2007	REV	C
MATERIAL		WEIGHT		CUSTOMER DRAWING	

# 4G46PI GIGABIT CIRCUIT △△

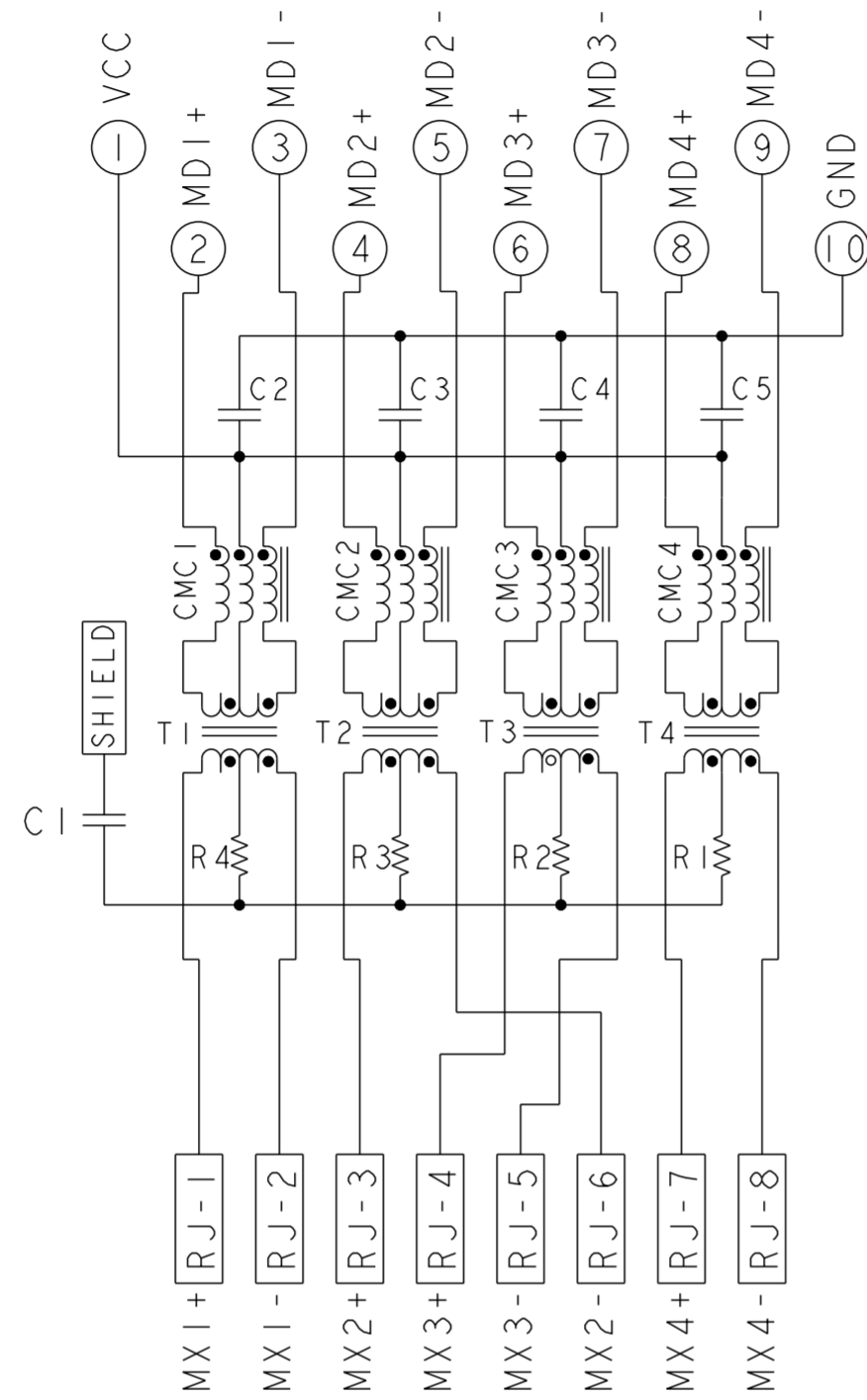

C2 - C5 = 0.1uF, 50V, CAPACITOR  
 C1 = 1000pF, 2KV, CAPACITOR  
 R1 - R4 = 75 ohms, RESISTOR

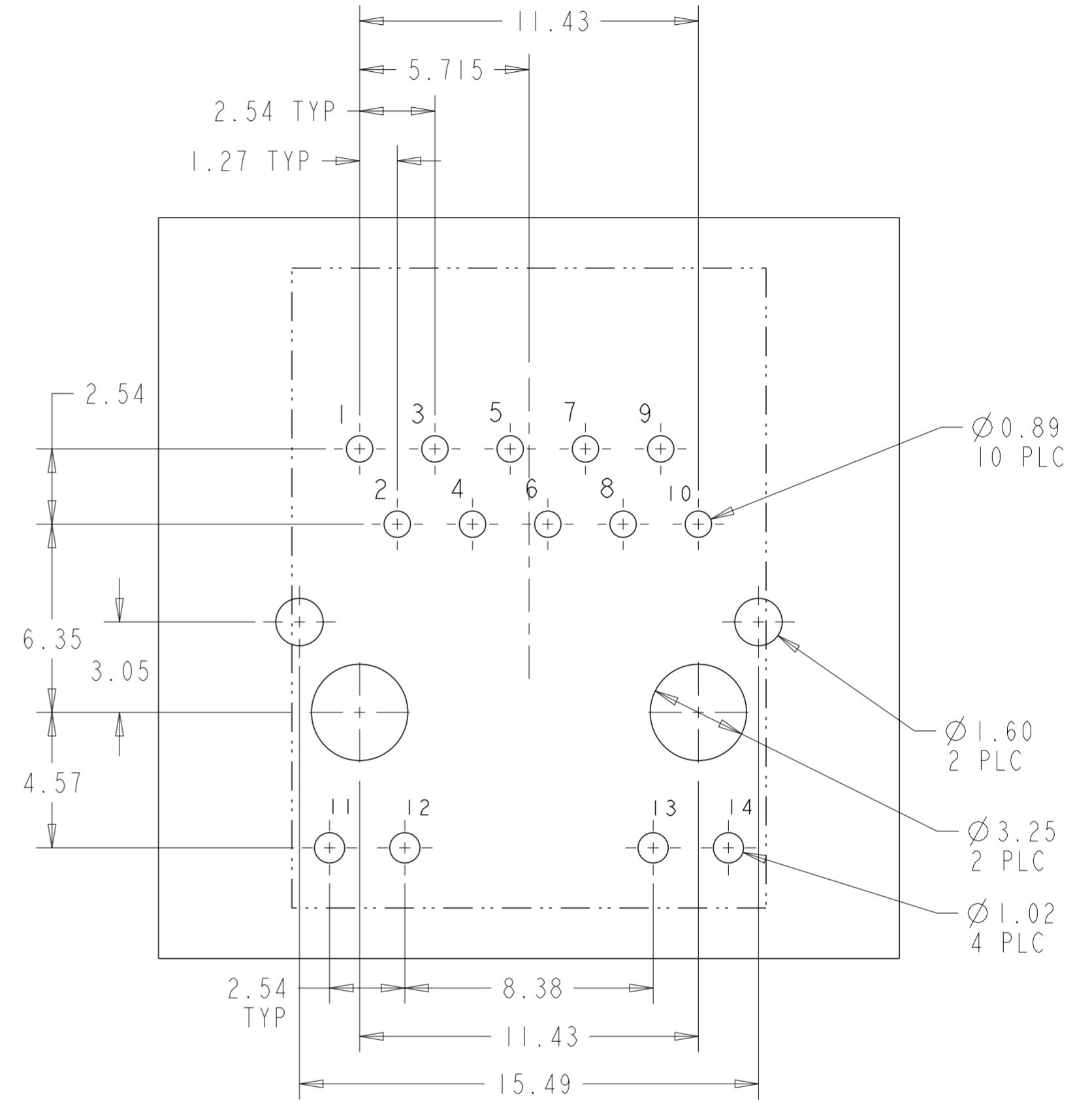

SUGGESTED PCB LAYOUT (TOL: ±0.05)  
 (COMPONENT SIDE VIEW)

SINGLE COLOR LED

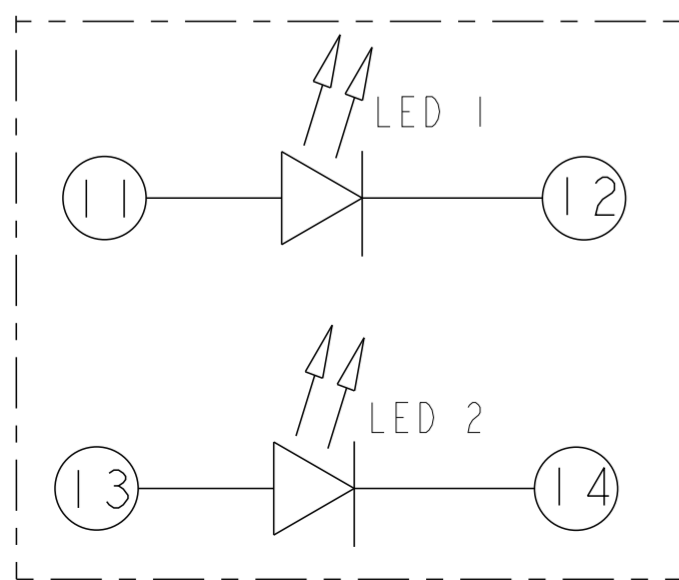

BI-COLOR LED

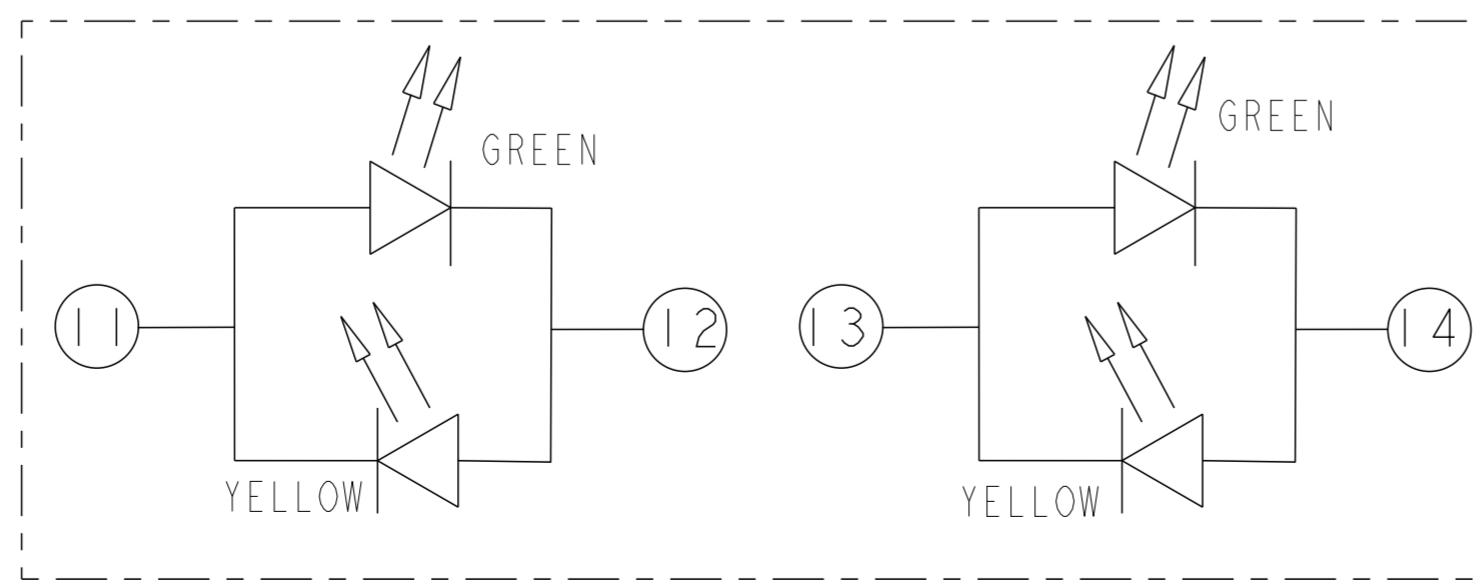

THIS DRAWING IS A CONTROLLED DOCUMENT.		DWN TOMMY REN 19NOV2007	 TRP connector Dongguan China
DIMENSIONS: mm		CHK KEITH ZHU 19NOV2007	
TOLERANCES UNLESS OTHERWISE SPECIFIED:		APVD TEDDY XIONG 19NOV2007	
0 PLC ±0.25 1 PLC ±0.25 2 PLC ±0.25 3 PLC ±0.25 4 PLC ± ANGLES ± FINISH ±		PRODUCT SPEC 108-2100 APPLICATION SPEC WEIGHT CUSTOMER DRAWING	
MATERIAL		NAME IX1 MAG45(TM) MODULAR JACK, VERTICAL, 4G46PI CIRCUIT, WITH LED	RESTRICTED TO
		SIZE A2	CAGE CODE 00779
		DRAWING NO. C-1840453	SCALE 3:1
		SHEET 2	REV C