

REVISIONS				
#	LR	DESCRIPTION	DATE	APPD
E		LOGO CHANGE	07APR2013	QL KZ

MECHANICAL:

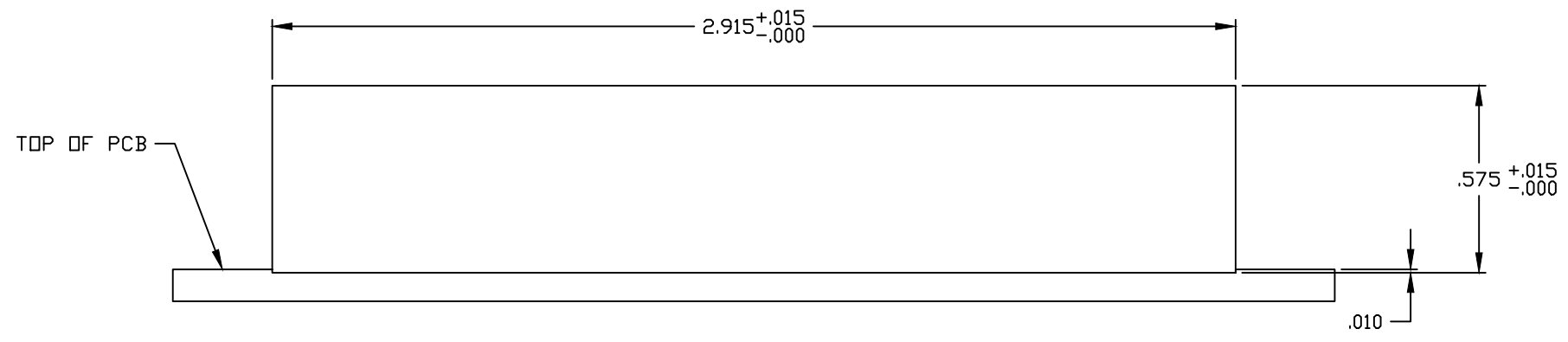
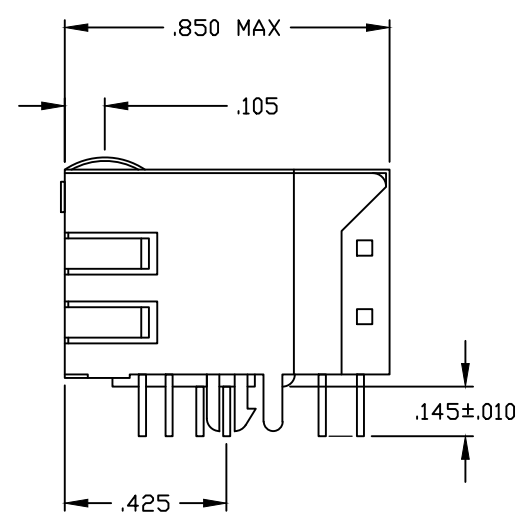
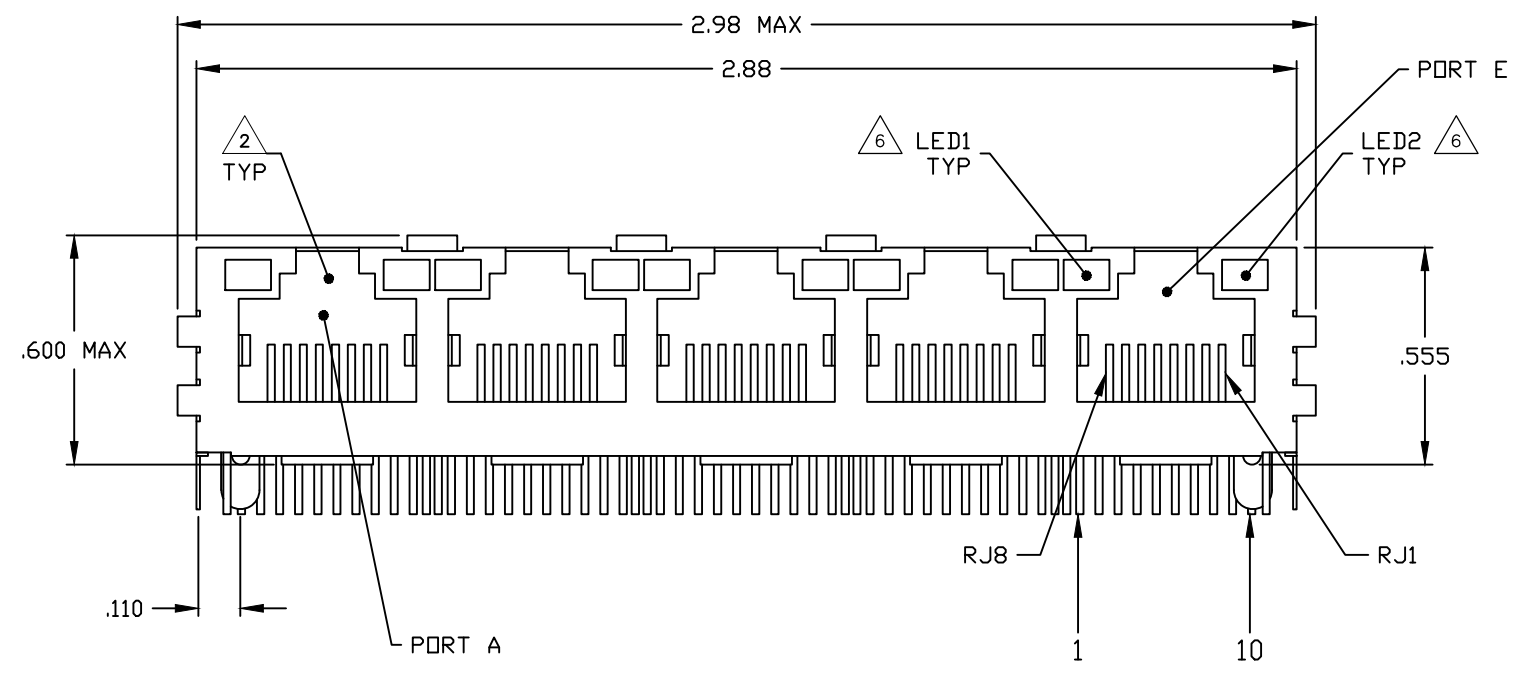
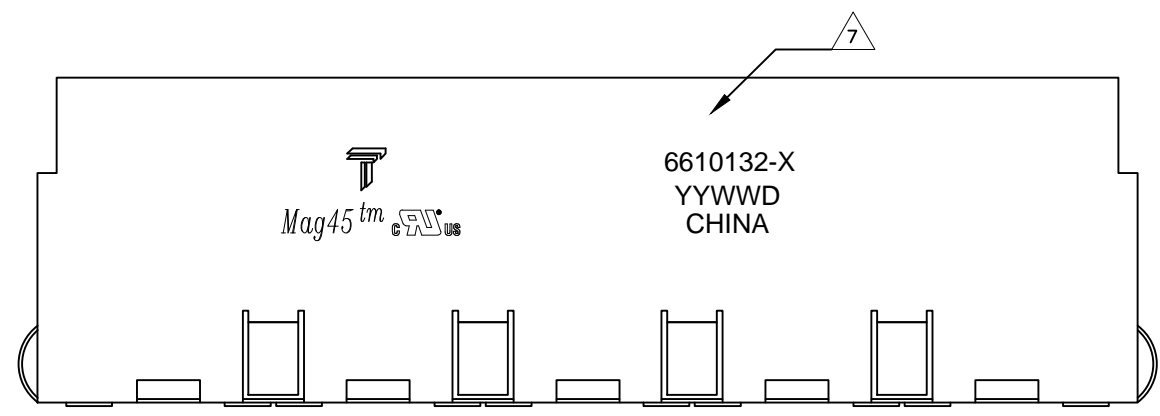

1X5 SUGGESTED PANEL CUTOUT

- 1 MATERIALS:  
 -HOUSING - THERMOPLASTIC PET POLYESTER FLAMMABILITY RATING UL 94V-0.  
 -SHIELD - .010" THICK, C26800 BRASS PREPLATED WITH 30µINCH MIN SEMI-BRIGHT NICKEL. SOLDER TABS POST DIPPED WITH 100µINCH MIN SAC SOLDER.  
 -MOD JACK CONTACTS - 0.0157 X 0.018" PHOSPHOR BRONZE, 50µINCH MIN OVERALL NICKEL UNDERPLATE WITH SELECT 50µINCH MIN HARD GOLD FINISH PLATE.  
 SOLDER TAILS WITH 100µINCH MIN MATTE TIN AND/OR SAC SOLDER DIP.  
 -LIGHT EMITTING DIODE(LED) - DIFFUSED EPOXY LENS, .020" X .020" CARBON STEEL WIREFRAME LEADS PRE-PLATED WITH 80µINCH SILVER OVER 4.0µINCH NICKEL UNDERPLATE OVER 4.0µINCH COPPER UNDERPLATE. POST-PLATED WITH 100µIN MIN MATTE TIN AND/OR SAC SOLDER DIP OR PURE TIN SOLDER DIP.
- 2 RJ45 JACK CAVITY CONFORMS TO FCC RULES AND REGULATIONS PART 68, SUB PART F.
- 3 MAGNETICS  
 -APPLICATION: 10/100/1000 BASE-T  
 -IMPEDANCE: 100 OHMS  
 -TURNS RATIO (CHIP:CABLE): 1:1 ALL FOUR PAIRS  
 -OPEN CIRCUIT INDUCTANCE (OCL): 350µH MIN @100kHz, 0.1VRMS, 8mADC BIAS FROM 0°C TO 70°C, ALL FOUR PAIRS  
 -ALL FOUR PAIRS BI-DIRECTIONAL  
 -PERFORMANCE @ 25°C:  
 INSERTION LOSS (IL): 1.1dB MAX FROM 0.5MHz TO 100MHz  
 RETURN LOSS (RL): 18dB MIN FROM 0.5MHz TO 40MHz  
 12-20LOG(f/80)dB MIN FROM 40.1MHz TO 100MHz  
 CROSSTALK ATTENUATION: 35dB MIN FROM 0.5MHz TO 40MHz  
 33-20LOG(f/50)dB MIN FROM 40.1MHz TO 100MHz  
 COMMON MODE REJECTION RATIO (CMRR): 30dB MIN FROM 0.5MHz TO 100MHz  
 -ISOLATION VOLTAGE: 2250VDC (MAX) FOR 60 SECONDS WITH A RISE TIME OF 500V/SEC AND WITH ALL PORTS CONNECTED.
- 4. OPERATING TEMPERATURE: FROM 0°C TO +70°C.
- 5 THE MAGNETICS ARE SYMMETRICAL TO SUPPORT AUTO-MDI/MDIX.
- 6 THE 250 OHM RESISTOR IS OPTIONAL, PLEASE SEE CHART FOR PRESENCE OR ABSENCE OF LED RESISTORS. IF LEDS WITHOUT 250 OHM RESISTOR, LEDS ARE DRIVEN WITH CONSTANT CURRENT AT APPROX 20 mA  
 LED COLOR: DOMINANT WAVELENGTH (AD): GREEN 568 nm TYP @ IF=20 mA  
 FORWARD VOLTAGE (VF): GREEN 2.2V TYP @ IF=20 mA  
 DOMINANT WAVELENGTH (AD): YELLOW 588 nm TYP @ IF=20 mA  
 FORWARD VOLTAGE (VF): YELLOW 2.1V TYP @ IF=20 mA  
 IF LEDS WITH BUILT-IN RESISTOR, LEDS ARE DRIVEN WITH 5V VOLTAGE AND THE MAX OPERATING CURRENT IS 20mA.  
 LED COLOR: DOMINANT WAVELENGTH (AD): GREEN 568 nm TYP @ VF=5V  
 FORWARD CURRENT (IF): GREEN 12mA TYP @ VF=5V  
 DOMINANT WAVELENGTH (AD): YELLOW 588 nm TYP @ VF=5V  
 FORWARD CURRENT (IF): YELLOW 13mA TYP @ VF=5V
- 7 TRP CONNECTOR LOGO, PART NUMBER, DATE CODE, COUNTRY OF ORIGIN AND AGENCY APPROVAL MARKING IN APPROXIMATE LOCATION SHOWN.
- 8 THESE PARTS ARE RECOMMENDED FOR WAVE SOLDERING PROCESS, PREHEAT TEMPERATURE IS 120°C TO 160°C, 120 SECONDS TO 180 SECONDS, PEAK WAVE SOLDERING TEMPERATURE IS 260°C MAX, 10 SECONDS MAX.

GREEN	YES	GREEN	YES	1-6610132-1
YELLOW	NO	YELLOW	NO	1-6610132-0
YELLOW	NO	GREEN	NO	6610132-9
GREEN	NO	YELLOW	NO	6610132-8
GREEN	NO	GREEN	NO	6610132-7
GREEN/YELLOW	NO	GREEN/YELLOW	NO	6610132-6
GREEN/YELLOW	NO	GREEN	NO	6610132-5
GREEN/YELLOW	NO	GREEN	YES	6610132-4
YELLOW	YES	YELLOW	YES	6610132-3
YELLOW	YES	GREEN	YES	6610132-2
GREEN	YES	YELLOW	YES	6610132-1
LED 1	250 OHMS RESISTOR	LED 2	250 OHMS RESISTOR	PART NUMBER

THIS DRAWING IS A CONTROLLED DOCUMENT.

DIMENSIONS:		TOLERANCES UNLESS OTHERWISE SPECIFIED:	
INCHES:		0 PLC	± .
		1 PLC	± .
		2 PLC	± .010
		3 PLC	± .005
		4 PLC	± .
		ANGLES	± .

APPROVED:	DATE:	SCALE:	SHEET:	REV:
A. FERNANDEZ-DOCKES	18MAR2005	4:1	1	2
D. FAROLE	18MAR2005			
D. FAROLE	18MAR2005			

TRP connector  
Dongguan China

PRODUCT SPEC: 108-2100  
APPLICATION SPEC: 108-2100

SIZE: A1  
CAGE CODE: 00779  
DRAWING NO: 6610132

CUSTOMER DRAWING

7G05 GIGABIT CIRCUIT 

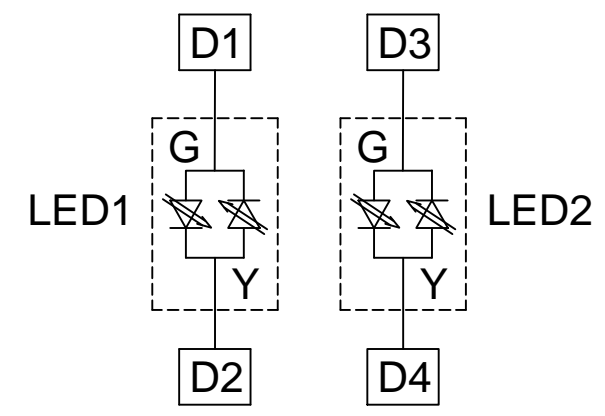
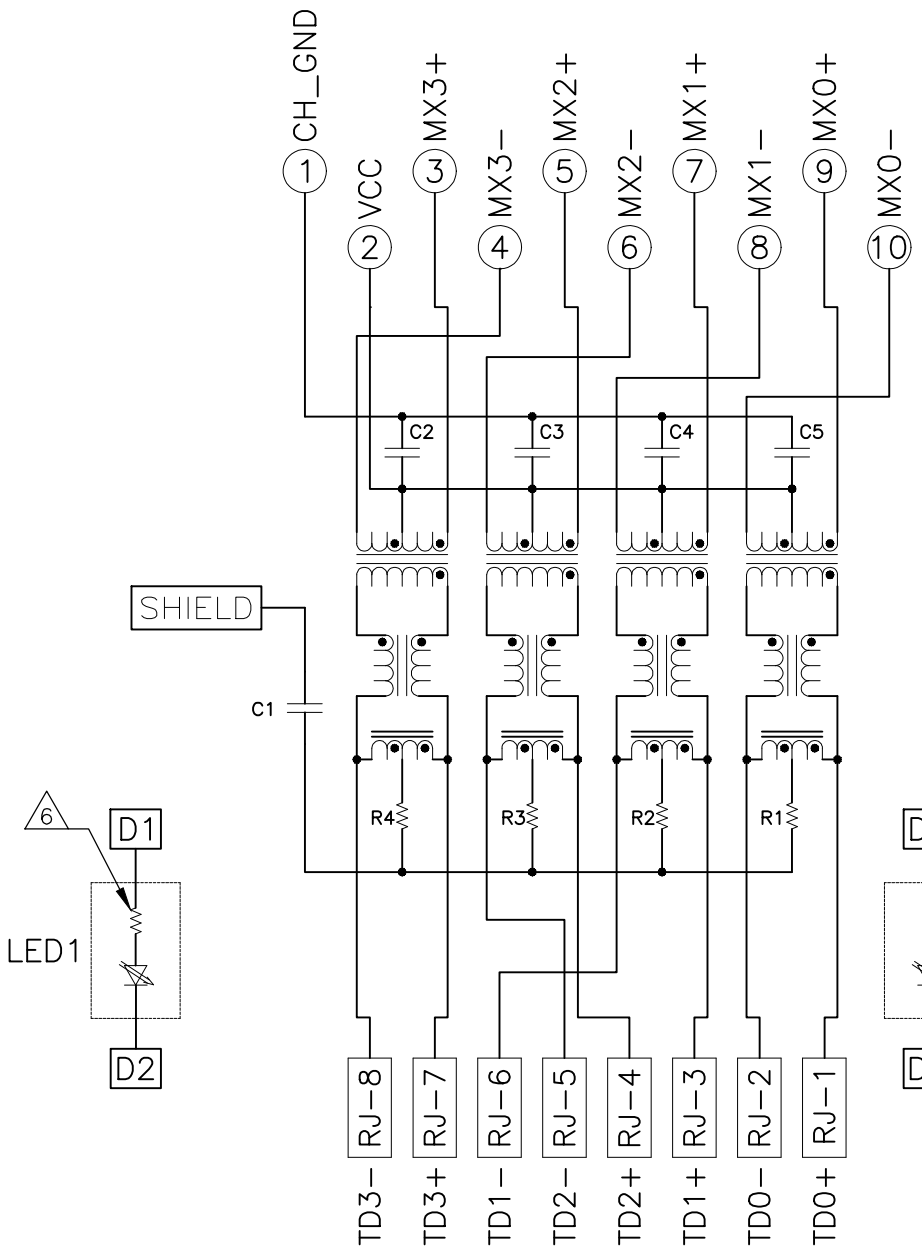

LED CONFIGURATION FOR BI-COLOR

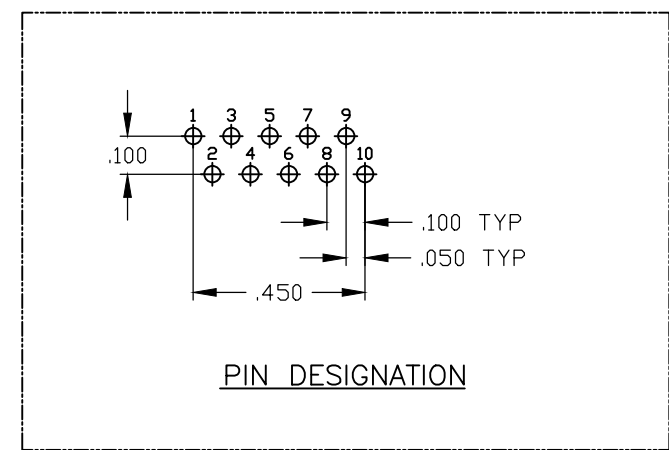

PIN DESIGNATION

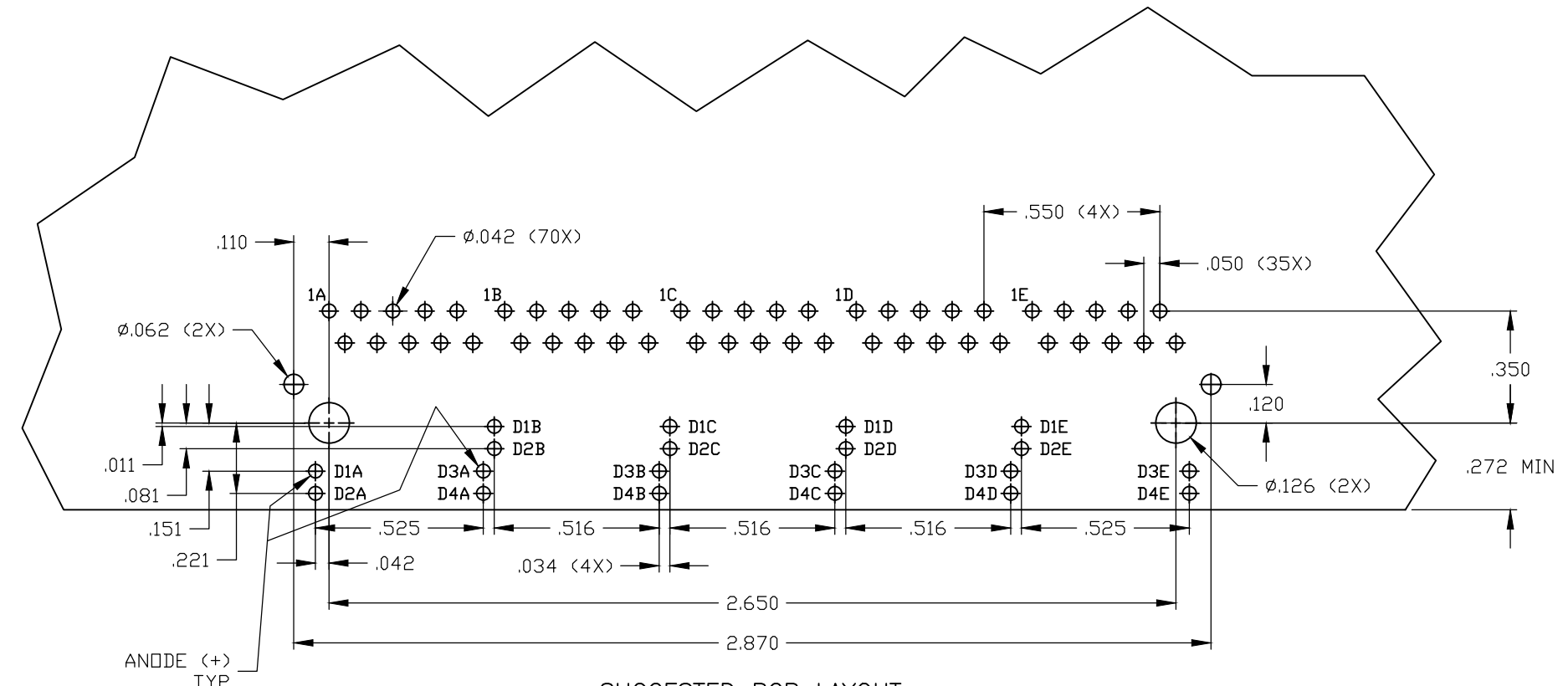

SUGGESTED PCB LAYOUT (Component Side)

R1-R4 = 75 OHMS, 1/16W RESISTORS  
 C1 = 1000pF, 2kV CAPACITOR  
 C2 - C5 = 0.1uF, 10%, 50V CAPACITORS

THIS DRAWING IS A CONTROLLED DOCUMENT.		DRW A. FERNANDEZ-DOCKS 18MAR2005	TRP connector Dongguan China
DIMENSIONS: INCHES		CHK D. FAROLE 18MAR2005	APPRO D. FAROLE 18MAR2005
TOLERANCES UNLESS OTHERWISE SPECIFIED:		PRODUCT SPEC 108-2100	
Ø	PLC	± .010	M4X5 MAG45(TM) MODULAR JACK, 7G4 SCHEMATIC, 7G05 SERIES GIGABIT CIRCUIT (10 PIN HORIZONTAL), SHIELDED, WITH LEADS
Ø	PLC	± .005	
Ø	PLC	± .005	
Ø	PLC	± .005	
MATERIAL		FINISH	SIZE CASE CODE DRAWING NO A1 00779 C-6610132
RESTRICTED TO		WEIGHT	SCALE 4:1 SHEET 2 OF 2 REV E
CUSTOMER DRAWING		RESTRICTED TO	