

REVISIONS				
#	LR	DESCRIPTION	DATE	APP'D
E		LOGO CHANGE	07APR2013	QL KZ

MECHANICAL:

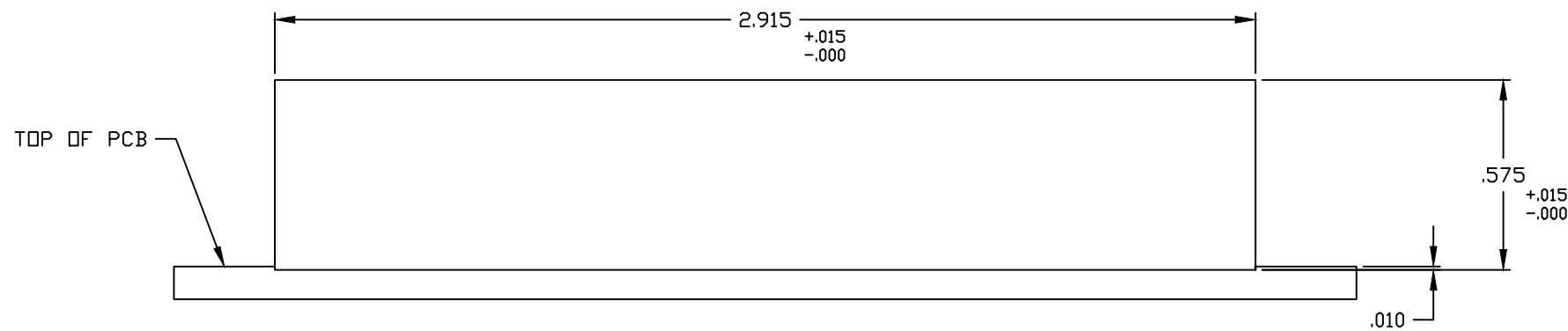
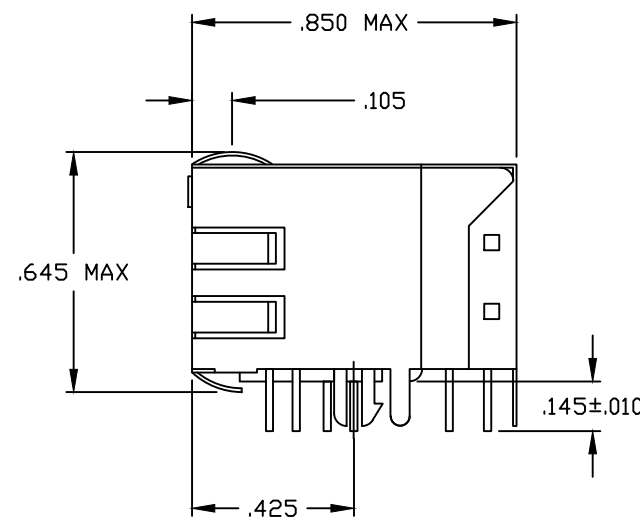
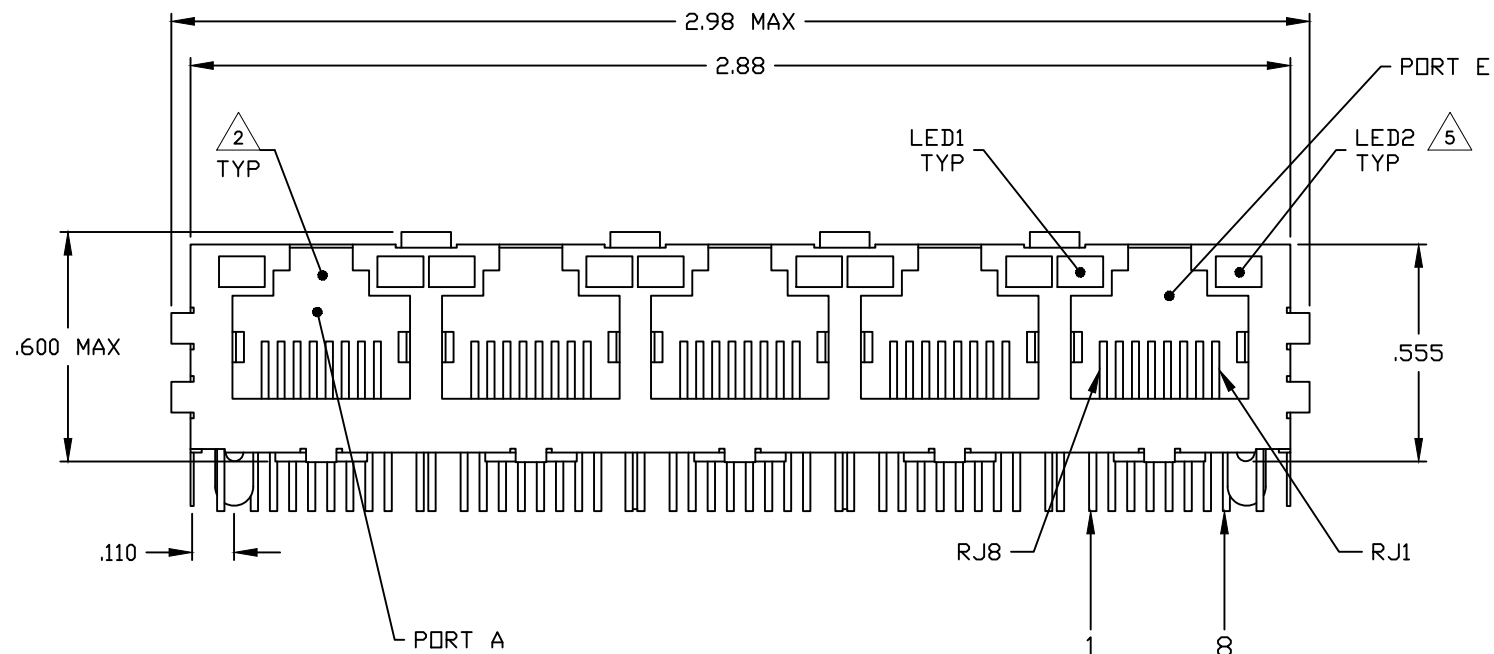
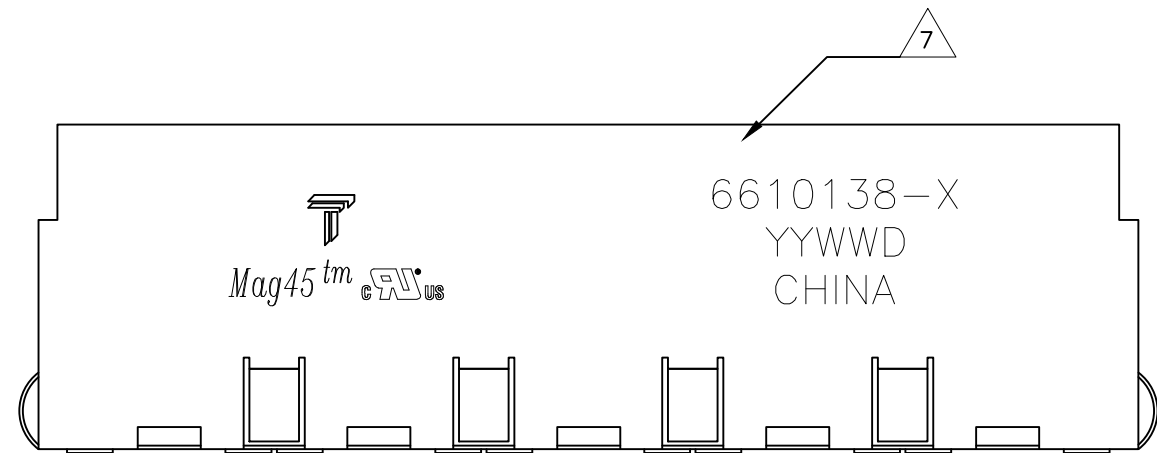

1X5 SUGGESTED PANEL CUTOUT

- 1. MATERIALS:
  - HOUSING - THERMOPLASTIC PET POLYESTER FLAMMABILITY RATING UL 94V-0.
  - SHIELD - 0.010" THICK, C26800 BRASS PREPLATED WITH 30μINCH MIN SEMI-BRIGHT NICKEL. SOLDER TABS POST DIPPED WITH 100μINCH MIN SAC SOLDER.
  - MOD JACK CONTACTS - 0.0157" X 0.018" PHOSPHOR BRONZE, 50μINCH MIN OVERALL NICKEL UNDERPLATE WITH SELECT 50μINCH MIN HARD GOLD FINISH PLATE. SOLDER TAILS WITH 100μINCH MIN MATTE TIN AND/OR SAC SOLDER DIP.
  - LIGHT EMITTING DIODE(LED) - DIFFUSED EPOXY LENS, 0.020" X 0.020" CARBON STEEL WIREFRAME LEADS PRE-PLATED WITH 80μINCH SILVER OVER 40μINCH NICKEL UNDERPLATE OVER 40μINCH COPPER UNDERPLATE. POST-PLATED WITH 100μINCH MIN MATTE TIN AND/OR SAC SOLDER DIP OR PURE TIN SOLDER DIP.
- 2. RJ45 JACK CAVITY CONFORMS TO FCC RULES AND REGULATIONS PART 68, SUB PART F.
- 3. MAGNETICS
  - IMPEDANCE: 100 OHMS
  - TURNS RATIO (CHIP: CABLE): TX = 1:1, RX = 1:1
  - OPEN CIRCUIT INDUCTANCE (OCL): 350μH MIN @100kHz, 0.1VRMS, 8mADC BIAS FROM 0°C TO 70°C, TX AND RX
  - PERFORMANCE @ 25°C:
    - INSERTION LOSS (IL): 1.1dB MAX FROM 0.5MHz TO 100MHz
    - RETURN LOSS (RL): 18dB MIN FROM 0.5MHz TO 30MHz
    - 18-20LOG(f/30)dB MIN FROM 30.1MHz TO 60MHz
    - 12dB MIN FROM 60.1MHz TO 80MHz
    - CROSSTALK ATTENUATION: 35dB MIN FROM 0.5MHz TO 40MHz
    - 33-20xLOG(f/50)dB MIN FROM 40.1MHz TO 100MHz
    - COMMON MODE REJECTION RATIO (CMRR): 30dB MIN FROM 0.5MHz TO 100MHz
    - ISOLATION VOLTAGE: 2250VDC (MAX) FOR 60 SECONDS WITH A RISE TIME OF 500V/SEC AND WITH ALL PORTS CONNECTED.
- 4. OPERATING TEMPERATURE: FROM 0°C TO +70°C.
- 5. THE 250 OHM LED RESISTORS ARE OPTIONAL, PLEASE SEE CHART FOR PRESENCE OR ABSENCE OF LED RESISTORS. IF THE LED WITHOUT 250 OHM RESISTORS, LED IS DRIVEN WITH CONSTANT CURRENT AT APPROX 20mA.LED COLOR:
  - DOMINANT WAVELENGTH (λD): GREEN 568 nm TYP. at IF=20mA
  - FORWARD VOLTAGE (VF): GREEN 2.2V TYP. at IF=20mA
  - DOMINANT WAVELENGTH (λD): YELLOW 588 nm TYP. at IF=20mA
  - FORWARD VOLTAGE (VF): YELLOW 2.1V TYP. at IF=20mA.
  - IF THE LED WITH 250 OHM RESISTORS,LED IS DRIVEN WITH 5V VOLTAGE AND THE MAX OPERATING CURRENT IS 20mA.LED COLOR :
    - DOMINANT WAVELENGTH (λD): GREEN 568 nm TYP. At VF=5V
    - FORWARD CURRENT (IF): GREEN 12 mA TYP. at VF=5V
    - DOMINANT WAVELENGTH (λD): YELLOW 588 nm TYP. At VF=5V
    - FORWARD CURRENT (IF): YELLOW 13 mA TYP. at VF=5V
- 6. INDICATED CONNECTIONS ARE FOR HUB CONFIGURATION. THE MAGNETICS ARE SYMMETRICAL AND SUPPORT AUTO-MDI/MDIX.
- 7. TRP CONNECTOR LOGO, PART NUMBER, DATE CODE, COUNTRY OF ORIGIN AND AGENCY APPROVAL MARKING IN APPROXIMATE LOCATION SHOWN.
- 8. THESE PARTS ARE RECOMMENDED FOR WAVE SOLDERING PROCESS,PEAK WAVE SOLDERING TEMPERATURE IS 265°C MAX, 10 SECONDS MAX.

NO	GREEN/YELLOW	GREEN/YELLOW	5-6610138-6
YES	GREEN	YELLOW	5-6610138-1
LED RESISTORS	LED1	LED2	PART NUMBER

THIS DRAWING IS A CONTROLLED DOCUMENT.

DIMENSIONS: INCHES 0 PLC ± - 1 PLC ± - 2 PLC ± .010 3 PLC ± .005 4 PLC ± - ANGLES ± -		TOLERANCES UNLESS OTHERWISE SPECIFIED: 0 PLC ± - 1 PLC ± - 2 PLC ± .010 3 PLC ± .005 4 PLC ± - ANGLES ± -	
MATERIAL:		FINISH:	
WEIGHT: -		SCALE: 4:1	
CUSTOMER DRAWING		SHEET 1 OF 2 REV E	

DRN: A. FERNANDEZ-DOCKS  
 CHK: D. FAROLE  
 APP'D: D. FAROLE  
 DATE: 18MAR2005  
 PRODUCT SPEC: 108-2100  
 APPLICATION SPEC: -  
 SIZE: A1  
 CASE CODE: 00779  
 DRAWING NO: C-6610138  
 TRP connector  
 Dongguan China  
 1X5 MAG45(TM) MODULAR JACK, 7H2 SCHEMATIC, 766 SERIES CIRCUIT, DECOUPLING CAPACITOR, SHIELDED, WITH LEDS, S3 TABS

766 SERIES MAGNETIC CIRCUIT

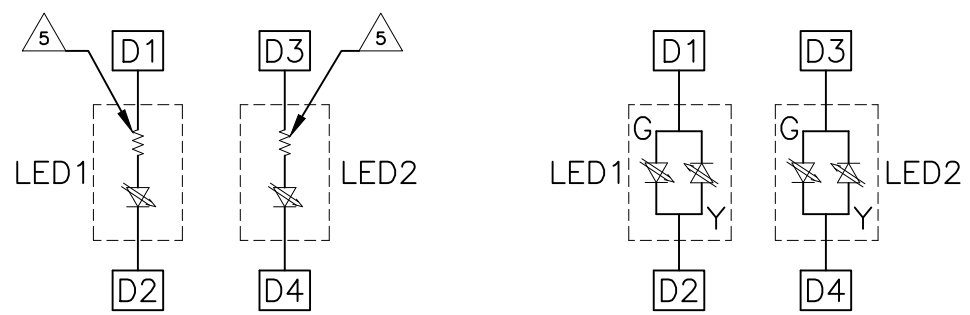
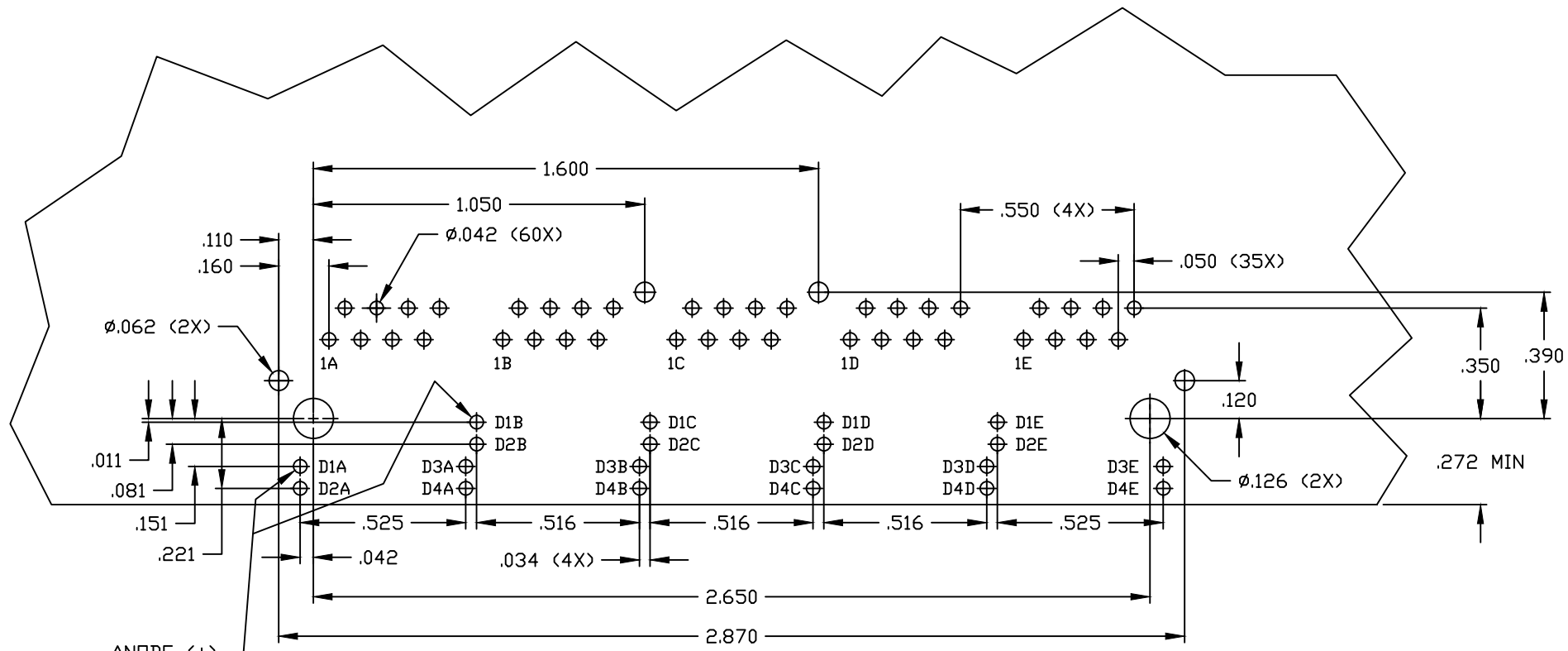
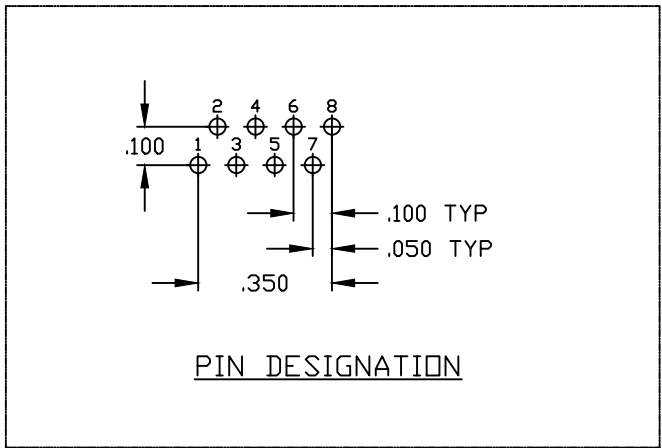
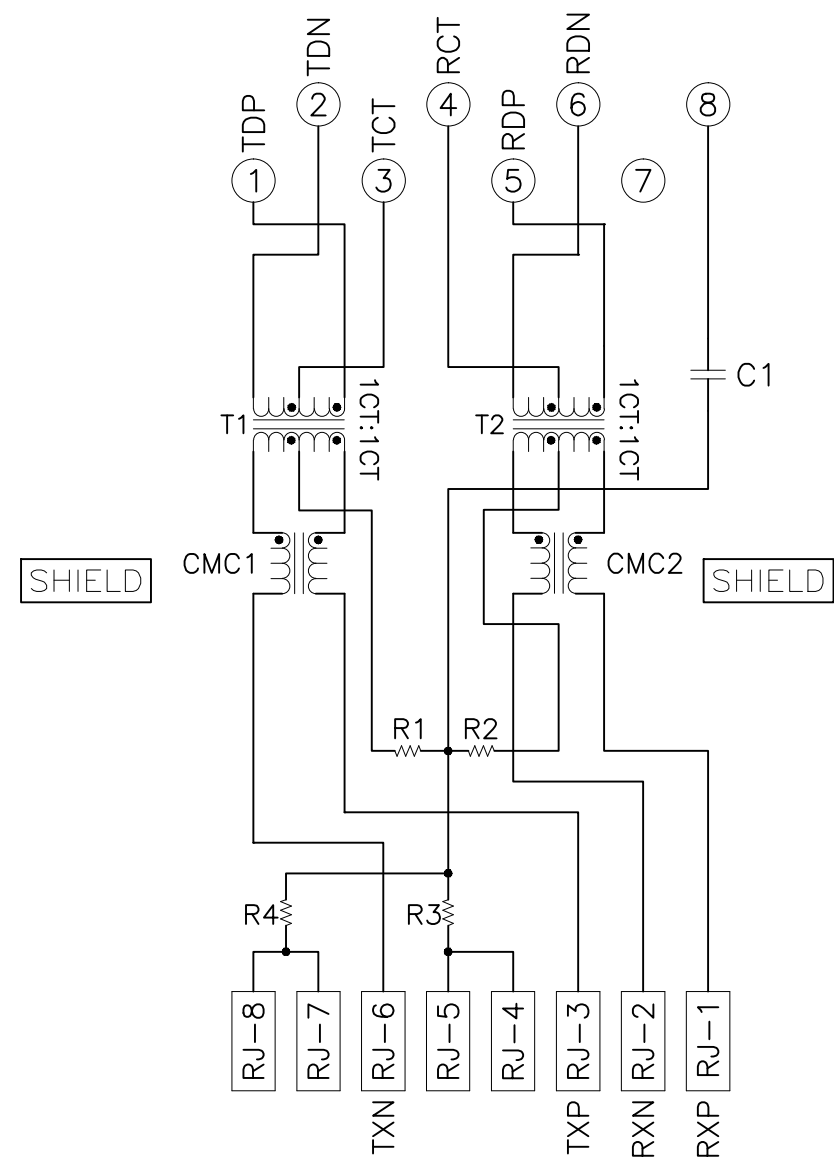

5-6610138-1

5-6610138-6

C1 = 1000pF, 2kV CAPACITOR  
R1-R4 = 75 OHMS, 1/16W RESISTORS

THIS DRAWING IS A CONTROLLED DOCUMENT.		DRW A. FERNANDEZ-DOCKS 18MAR2005	TRP connector Dongguan China
DIMENSIONS: INCHES		CHK D. FAROLE 18MAR2005	PRODUCT SPEC 108-2100
TOLERANCES UNLESS OTHERWISE SPECIFIED:		APPD D. FAROLE 18MAR2005	APPLICATION SPEC -
0 PLC	± .	WEIGHT	-
1 PLC	± .	SIZE	A1
2 PLC	± .010	CASE CODE	00779
3 PLC	± .005	DRAWING NO	C-6610138
4 PLC	± .	RESTRICTED TO	-
ANGLES	± .	SCALE	4:1
MATERIAL	-	SHEET	2 OF 2
FINISH	-	REV	E
CUSTOMER DRAWING			