



VRLA Rechargeable Battery

EP65-12 (EP65-12FR)



FEATURES

- Absorbent Glass Mat technology for efficient gas recombination
- Maintenance free(no water topping-up required)
- No free acid(Non-spillable battery)
- Can be used in any orientation(excluding used inverted)
- The battery is designed for heavy duty cyclic application
- Low self-discharge rate, lower than 3% capacity loss per month

APPLICATION

- UPS
- Golf-Carts
- Lawn Mowers



SPECIFICATIONS

Nominal Voltage	12 V
Nominal Capacity	65Ah @ 20 hour rate F.V.(1.75V/cell)
Approx. Weight	22.8Kg(50.30lbs.)
Terminals	B5 (Fitting M6 bolt & nut) I2 is optional
Internal Resistance	≤6mΩ (Fully Charged)
Max. Discharge Current	650 A (5 sec.)
Max. Charge Current	19.5 A
Operating Temperature Range	Charge : 0°C~40°C(32°F~104°F) Discharge : -20°C~50°C(-4°F~122°F) Storage. : -20°C~40°C(-4°F~104°F)
Container Material	ABS(UL94-HB, UL94-V0 is optional)

ISO 9001	
ISO14001	
UL	
CE	
<ul style="list-style-type: none"> ● IEC 61056-1 ● JIS C 8702-1 ● GB/T 19639.1 	

DIMENSION(mm/inch)

OUTER DIMENSIONS

TERMINAL TYPE

Length

350±2.0 (13.78±0.08)

Width

166±2.0 (6.54±0.08)

Container Height

174±2.0 (6.85±0.08)

Total Height

174±2.0 (6.85±0.08)

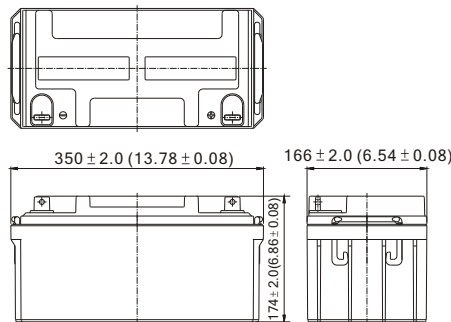

Terminal B5

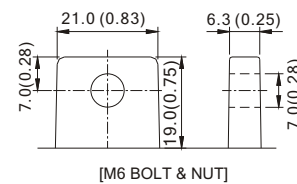

[M6 BOLT & NUT]

Terminal I2

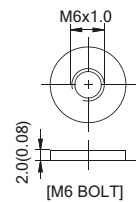

[M6 BOLT]

Terminal Hardware Initial Torque: B5/ I2(5.5 Nm ± 5%)

Constant power discharge characteristics at 25 °C/77 °F Unit: W

F.V. (V/cell) \ Discharge Time	10 Min	15 Min	30 Min	1 Hr	3 Hr	5 Hr	10 Hr	20 Hr
1.80V	1568	1298	808	455.0	192.0	132.4	73.90	39.00
1.75V	1700	1362	842	469.0	195.6	134.9	74.70	39.60
1.70V	1769	1408	862	478.0	198.3	136.0	75.20	39.90
1.65V	1833	1442	878	484.0	199.2	136.5	75.50	40.20
1.60V	1878	1465	886	488.0	200.2	136.5	76.00	40.50

Constant current discharge characteristics at 25 °C/77 °F Unit: A

F.V. (V/cell) \ Discharge Time	10 Min	15 Min	30 Min	1 Hr	3 Hr	5 Hr	10 Hr	20 Hr
1.80V	141.7	113.8	68.4	40.70	16.39	11.25	6.26	3.30
1.75V	155.7	119.4	71.0	42.30	16.60	11.36	6.35	3.37
1.70V	162.2	123.2	72.7	43.10	16.72	11.53	6.40	3.38
1.65V	166.7	126.7	73.6	43.70	16.78	11.57	6.42	3.39
1.60V	169.2	129.1	74.5	44.20	16.98	11.63	6.42	3.41

All data shall be changed without prior notice, BB reserves the right to explain and update the information contained hereinto.