



VRLA Rechargeable Battery

EVP35-12 (EVP35-12FR)

Finger Type



FEATURES

- Absorbent Glass Mat technology for efficient gas recombination
- Maintenance free(no water topping-up required)
- No free acid(Non-spillable battery)
- Low self-discharge rate, lower than 3% capacity loss per month
- Can be used in any orientation(excluding used inverted)
- The battery is designed for high power & high cyclic usage

APPLICATION

- UPS
- Wheelchairs
- Lawn Mowers
- Electronic Vehicle
- Golf-Carts
- Electronic Medical Equipment



SPECIFICATIONS

Nominal Voltage	12 V
Nominal Capacity	35Ah @ 20 hour rate F.V.(1.75V/cell)
Approx. Weight	12.5Kg(27.571lbs.)
Terminals	B7 (Fitting M6 bolt & nut) I2 is optional
Internal Resistance	≤6mΩ (Fully Charged)
Max. Discharge Current	525 A (5 sec.)
Max. Charge Current	10.5 A
Operating Temperature Range	Charge : 0°C~40°C(32°F~104°F) Discharge : -20°C~50°C(-4°F~122°F) Storage. : -20°C~40°C(-4°F~104°F)
Container Material	ABS(UL94-HB, UL94-V0 is optional)

ISO 9001	
ISO14001	
UL	
CE	
<ul style="list-style-type: none"> ● IEC 61056-1 ● JIS C 8702-1 ● GB/T 19639.1 	

DIMENSION(mm/inch)

OUTER DIMENSIONS

TERMINAL TYPE

Length

195±1.5 (7.68±0.06)

Width

129±1.5 (5.08±0.06)

Container Height

168±1.5 (6.61±0.06)

Total Height

B7:179±2.0 (7.05±0.08)

I2:168±2.0 (6.61±0.08)

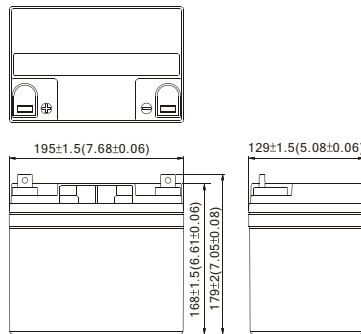

Terminal B7

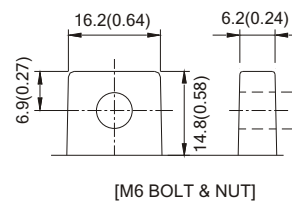

[M6 BOLT & NUT]

Terminal I2

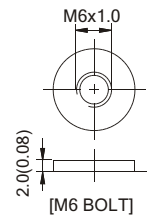

[M6 BOLT]

Terminal Hardware Initial Torque: B7/I2(5.5Nm±5%)

Constant power discharge characteristics at 25 °C/77 °F

Unit: W

F.V. (V/cell) \ Discharge Time	5 Min	10 Min	15 Min	30 Min	1 Hr	3 Hr	5 Hr	10 Hr	20 Hr
1.80V	1503	1065	766	481	274	111.4	70.4	39.2	20.5
1.75V	1740	1154	810	500	282	114.1	71.6	40.0	21.0
1.70V	1849	1200	834	511	289	115.0	72.1	40.3	21.1
1.65V	1933	1227	856	519	292	116.1	72.5	40.3	21.1
1.60V	1997	1249	871	525	294	116.5	72.7	40.3	21.1

Constant current discharge characteristics at 25 °C/77 °F

Unit: A

F.V. (V/cell) \ Discharge Time	5 Min	10 Min	15 Min	30 Min	1 Hr	3 Hr	5 Hr	10 Hr	20 Hr
1.80V	139.20	96.83	72.59	42.59	23.06	9.28	5.87	3.27	1.71
1.75V	164.19	105.89	76.94	44.21	23.73	9.51	5.97	3.33	1.75
1.70V	174.47	110.12	79.18	45.19	24.27	9.59	6.01	3.35	1.76
1.65V	182.35	112.53	80.99	45.90	24.53	9.68	6.04	3.36	1.76
1.60V	188.36	114.57	82.44	46.46	24.73	9.71	6.06	3.36	1.76

All data shall be changed without prior notice, BB reserves the right to explain and update the information contained hereinto.