

REVISION RECORD		
REV	DESCRIPTION	DRFT

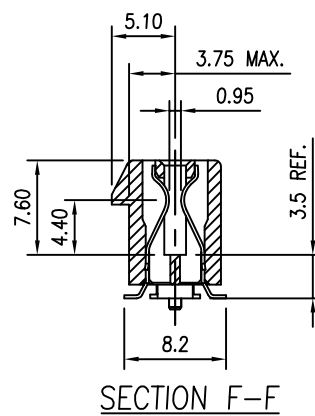

DIMENSIONS					
POSITION	A ±0.20	B ^{+0.20} / _{-0.08}	C ±0.25	D ±0.25	E ±0.25
36	6	7.65	9.15	25.00	27.00
64	20	21.65	23.15	39.00	41.00
98	37	38.65	40.15	56.00	58.00
164	70	71.65	73.15	89.00	91.00

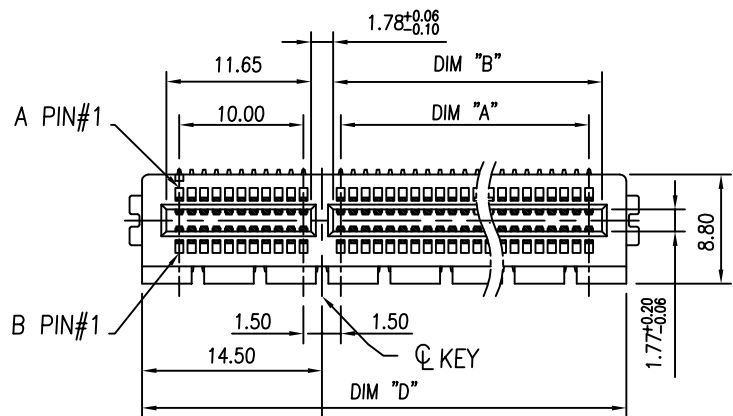
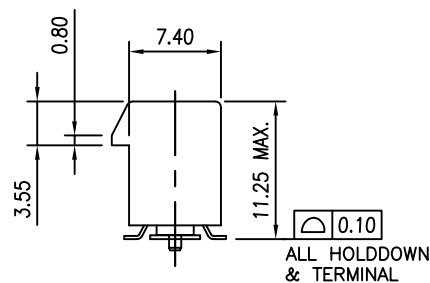
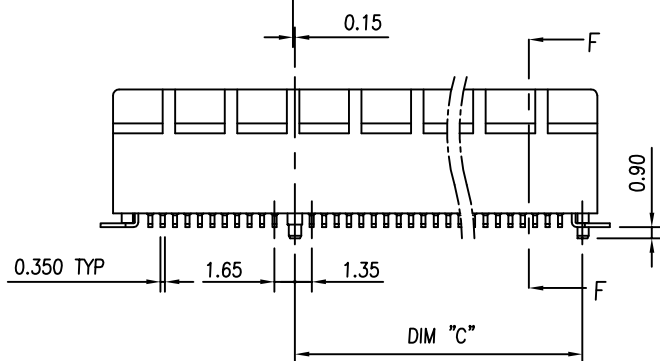

NOTES:

1. MATERIAL:
 - 1.1 HOUSING: THERMOPLASTIC, HIGH TEMP, UL94V-0, COLOR: BLACK.
 - 1.2 CONTACTS: COPPER ALLOY.
 - 1.3 HOLDDOWN: COPPER ALLOY.
2. FINISH:
 - 2.1 CONTACT:
 - SELECTIVE GOLD PLATING ON CONTACT AREA.
 - 100µ" MIN. MATTE TIN PLATING ON SOLDER TAILS,
 - 50µ" MIN. NICKEL UNDERPLATING OVERALL.
 - 2.2 HOLDDOWN:
 - 100µ" MIN. MATTE TIN PLATING WITH 50µ" MIN. NICKEL UNDERPLATE OVERALL.

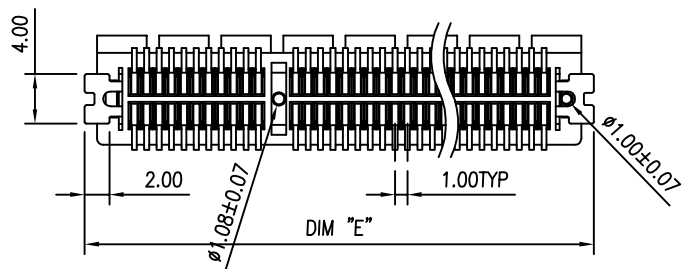

MM (INCH)		DFTO Roy	DATE 11/14/2012	Pulse Electronics	RoHS Compliant	
TOLERANCES EXCEPT AS NOTED		CHKD	DATE			
MM	±	APPVL	DATE	TITLE PCI EXPRESS SMT TYPE WITH POST		
.40	±	MATERIAL :				
.30	±	ANGLES ± 0.5°		DRAWING NO. E9002-XXX-XX		
.20	±	THIRD ANGLE PROJECTION				
.10	±	SCALE : 1:1		DO NOT SCALE DRAWING		SIZE A3
.00	±	FINISH :		SHEET 1 OF 3		REV 01
.000	±	SCALE : 1:1		DO NOT SCALE DRAWING		REV 01

REVISION RECORD		
REV	DESCRIPTION	DRFT

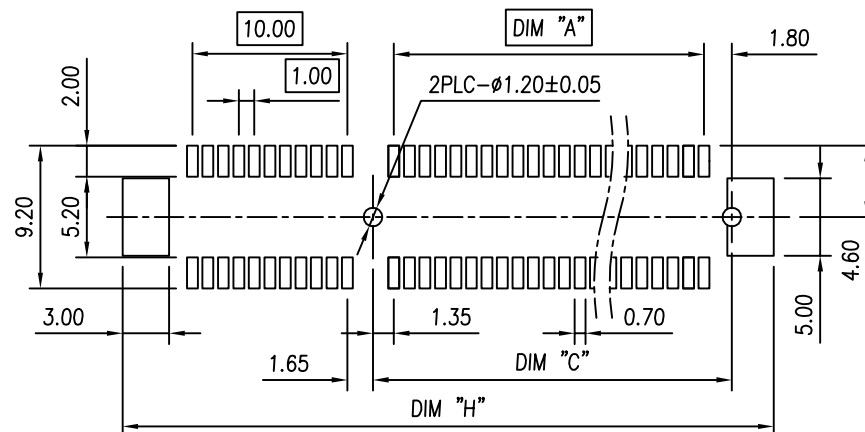
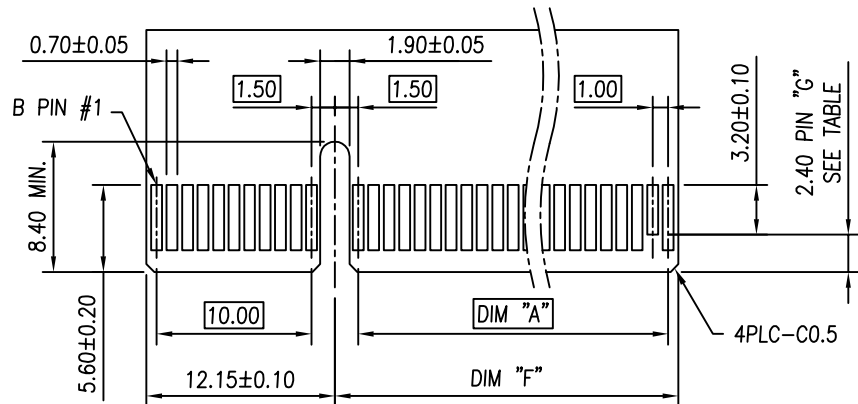

RECOMMENDED PCB LAYOUT, POST TYPE

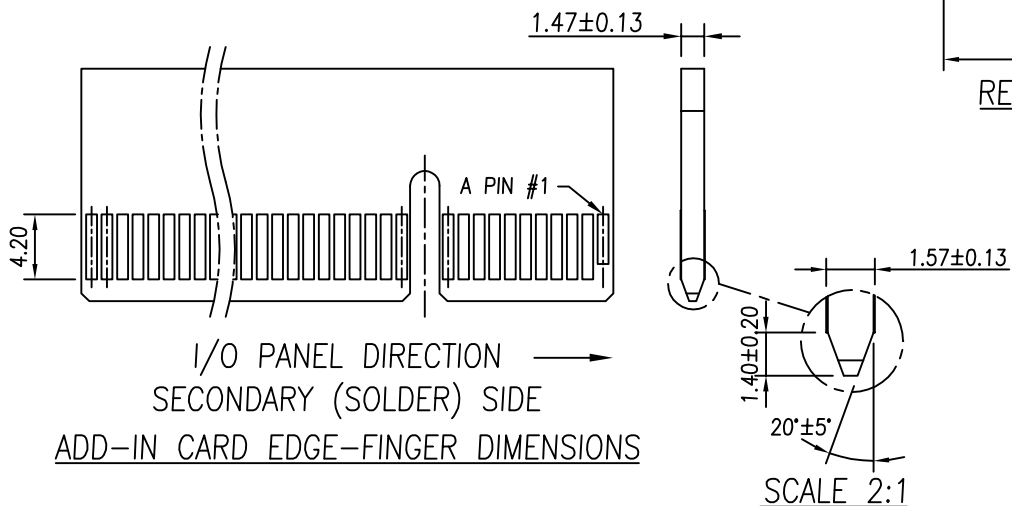

DIMENSIONS					
POSITION	A ±0.10	F ±0.10	C ±0.10	G	H ±0.10
36	6	8.15	9.15	B PIN#17	28.00
64	20	22.15	23.15	B PIN#31	42.00
98	37	39.15	40.15	B PIN#48	59.00
164	70	72.15	73.15	B PIN#81	92.00

DETACHED LISTS	 THIRD ANGLE PROJECTION		DFTO Roy	DATE 11/14/2012	 RoHS Compliant	TITLE PCI EXPRESS SMT TYPE WITH POST		
	TOLERANCES EXCEPT AS NOTED		CHKD	DATE				
	MM . ± 0.40 .0 ± 0.30 .00 ± 0.20 .000 ± 0.10		APPVL	DATE	DRAWING NO. E9002-XXX-XX /PART NO. E9002-XXX-XX		SIZE A3	REV 01
	ANGLES ± 0.5°		MATERIAL :				DO NOT SCALE DRAWING	
			QTY :		SCALE : 1:1			

REVISION RECORD		
REV	DESCRIPTION	DRFT

PRAT NUMBER	DESCRIPTION	PLATING Au	No.of Pins	Packing
E9002-001-01	PCI Express Connector, Vertical, SMT,	1u"	36pin	Tray with cap
E9002-001-02		15u"	36pin	
E9002-002-01		1u"	64pin	
E9002-002-02		15u"	64pin	
E9002-003-01		1u"	98pin	
E9002-003-02		15u"	98pin	
E9002-004-01		1u"	164pin	
E9002-004-02		15u"	164pin	

DETACHED LISTS			DFTO Roy	DATE 11/14/2012		RoHS Compliant
	TOLERANCES EXCEPT AS NOTED		CHKD	DATE		
	MM		APPVL	DATE	TITLE PCI EXPRESS SMT TYPE WITH POST	
	. ± 0.40	±	MATERIAL :			
	.0 ± 0.30	±	QT'Y :		DRAWING NO. E9002-XXX-XX	SIZE A3
.00 ± 0.20	±	FINISH :		/PART NO. E9002-XXX-XX		
.000 ± 0.10	±	THIRD ANGLE PROJECTION		SCALE : 1:1	DO NOT SCALE DRAWING	SHEET 3 OF 3

8

7

6

5

4

3

2

1

H

G

F

E

D

C

B

A