

REVISION RECORD				
REV	ECO	DESCRIPTION	DRFT	CHKD
△		ADD PART NO.	CHM 08/21/08	

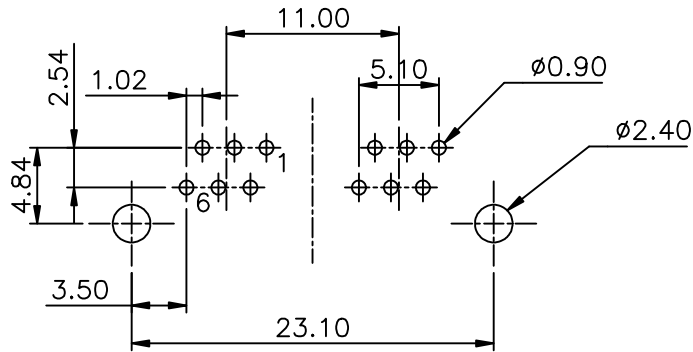
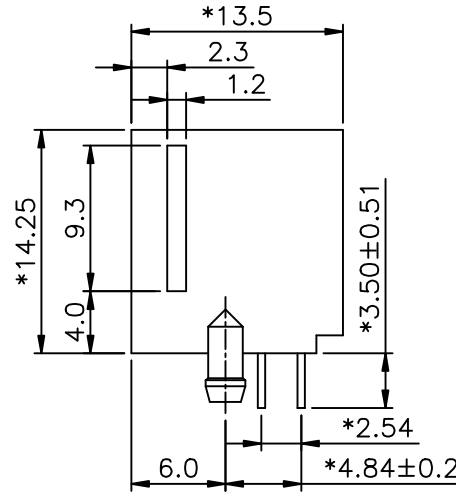
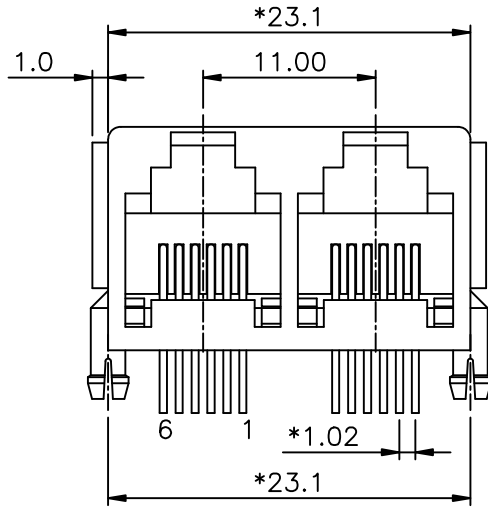

PC Board Layout Component Side Shown

**NOTES:**

**ELECTRICAL:**

- 1. VOLTAGE RATING : 125 VAC RMS.
- 2. CURRENT RATING : 1.5 AMP.
- 3. CONTACT RESISTANCE : 45 MILLIOHMS MAX.
- 4. INSULATION RESISTANCE: 1000 MEGOHMS MIN @ 500 VDC.
- 5. DIELECTRIC STRENGTH : 1000 VAC RMS 60Hz, 1MIN.

**MECHANICAL:**

- 1. HOUSING MATERIAL : PBT +30% .G.F
- 2. CONTACT MATERIAL : PHOSPHOR BRONZE Ø0.46mm.
- 3. PLATING : GOLD PLATING OVER NICKEL.
- 4. OPERATING LIFE : 750 CYCLES MIN.
- 5. PCB RETENTION PRE-SOLDER : 1 LB MIN.
- 6. PCB RETENTION POST-SOLDER: 10 LBS MIN.

**ENVIRONMENTAL:**

- 1. STORAGE : -40°C TO +85°C.
- 2. OPERATION: : -40°C TO +85°C.
- 3. WAVE SOLDERING TEMPERATURE: 230~250°C (3~5 SECONDS)

MATES WITH MODULAR PLUG CONFORMING TO FCC PART 68, SUBPART F.

CUL FILE NO. E163191  
PART NUMBER: E556X-20AXXX-L

NO. OF CONTACT	1- 3u" 2- 6u" 3-15u"
2-2 CONTACTS	4-30u" 5-50u" 6-Pd20u"
4-4 CONTACTS	7-Pd30u" 8-Pd10u"
6-6 CONTACTS	5-BK
	D-GY
	0-A06-0100 BK
	1-W/ PANEL STOP
	2-W/O PANEL STOP

DETACHED LISTS	MM (INCH)	DFTO CHLOE	DATE 2005/07/29	FULL RISE ELECTRONIC CO., LTD		
	TOLERANCES EXCEPT AS NOTED	CHKD	DATE			
	MM	MFO	DATE	TITLE MINI L/P SIDE ENTRY PCB JACK 6P		
	.0 ±0.20	APPVL XLF	DATE 08/30/05			
.00 ±0.15	MATERIAL :	DRAWING NO. GE553009-LC		SIZE	REV	
.000 ±0.075	ANGLES ±	QT'Y :	/PART NO. SEE NOTE		A3	1
	THIRD ANGLE PROJECTION	FINISH :	DO NOT SCALE DRAWING		SHEET	OF
		SCALE : 3:1				