

C6162NL

- o DIPLEXER
- o 5-1002/1125-1525 MHz
- o IMPEDANCE = 75 OHMS
- o DESIGNED FOR MOCA APPLICATIONS
- o SURFACE MOUNT

NOTES: UNLESS OTHERWISE SPECIFIED

1. METAL COVER
2. FR4 PCB SUBSTRATE WITH IMMERSION SILVER PLATING.
3. OPERATING TEMPERATURE: 0°C TO +70°C
4. JEDEC MOISTURE: LEVEL 1.
5. DIMENSIONS ARE IN INCHES WITH THE FOLLOWING TOLERANCE:
 .XX= ±.02
 .XXX= ±.005
6. ROHS COMPLIANT



ELECTRICAL SPECIFICATIONS: @ 25°C

INSERTION LOSS: CATV

FREQUENCY	
5-1002 MHz	-1.8 dB MAX
1125-1525 MHz	-40 dB MIN
2300-3000 MHz	-35 dB MIN
4600 MHz	-25 dB MIN
6000 MHz	-5 dB MIN

INSERTION LOSS: MOCA

FREQUENCY	
5-42 MHz	-60 dB MIN
42-1002 MHz	-40 dB MIN
1125-1525 MHz	-2.5 dB MAX
2300-3000 MHz	-41 dB MIN
4600 MHz	-25 dB MIN
6000 MHz	-5 dB MIN

ISOLATION: MOCA to CATV

FREQUENCY	
5-42 MHz	-60 dB MIN
42-1002 MHz	-40 dB MIN
1125-1525 MHz	-40 dB MIN
2300-3000 MHz	-41 dB MIN
4600 MHz	-25 dB MIN
6000 MHz	-5 dB MIN

RETURN LOSS: COMMON PORT

FREQUENCY	
5-1002 MHz	-15 dB MIN
1125-1525 MHz	-12 dB MIN

PASSBAND SLOPE:

6 MHz BAND	
5-1002 MHz	0.35 dB MAX
50 MHz BAND	
1125-1525 MHz	1.0 dB MAX

MECHANICAL SPECIFICATIONS:

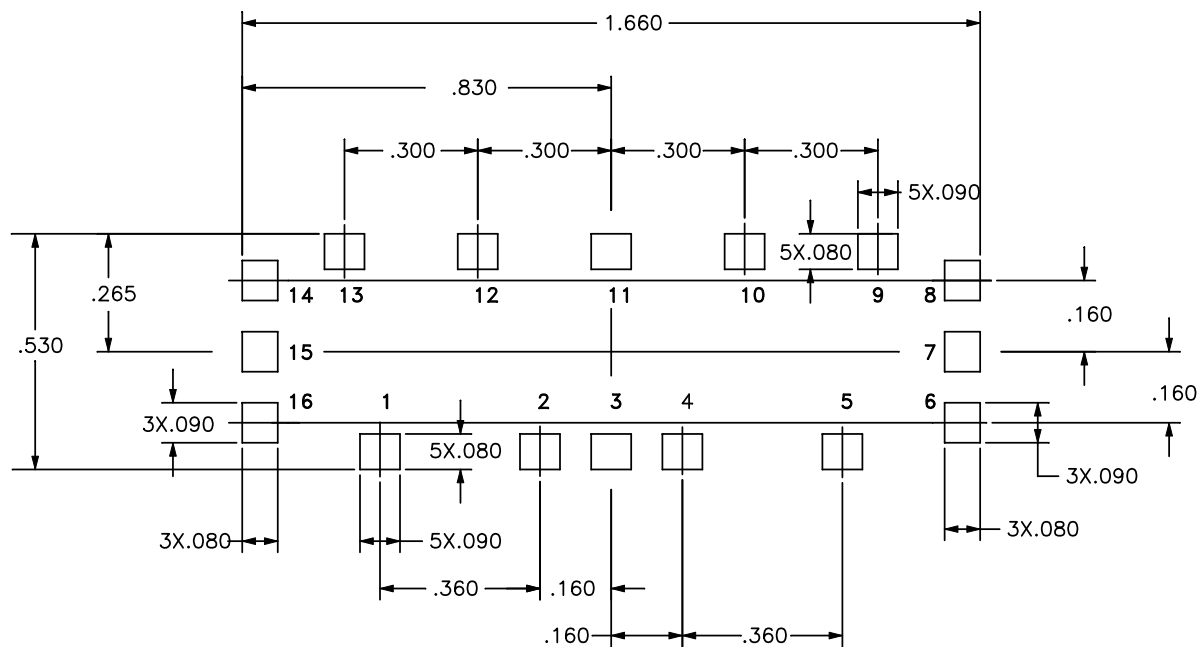
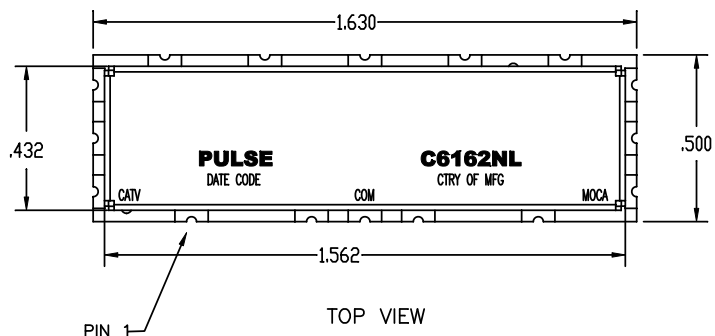

SUGGESTED PAD LAYOUT
TOP VIEW

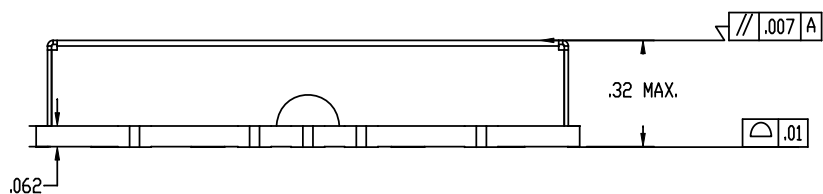

FRONT VIEW

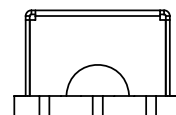

RIGHT SIDE VIEW

DESIGNATIONS	
COMMON PORT (COM)	PIN 3
MOCA	PIN 7
CATV	PIN 15
GROUND (GND)	PINS 1,2,4,5
GROUND (GND)	PINS 6,8,14,16
GROUND (GND)	PINS 9-13

© Copyright, 2012. Pulse Engineering, Inc. All rights reserved. Drawing specifications subject to change without notice. Date (04/23/12)

PULSE CONFIDENTIAL
&
PROPRIETARY

PRODUCT SPECIFICATION:
DPLXR, 5-1002/1125-1525 MHz, SM

DWG. NO./ PART NO.	SHEET:	REV.
C6162NL	2	M10