

DEPT	
1	1
2	
3	
4	2
5	
6	
7	
8	
9	
10	
11	
12	
NC	
JZ	

PART NAME: FEMALE TERMINAL

PART NO: 3500H 109/-2

PART NUMBER	MATERIAL	FINISH	QC STAMP
3500H 109A-2	.016 ±.0005 THICK BRASS R15T 83.0-86.5	PRETINNED	YES
3500H 109AB-2	.016 ±.0005 THICK BRASS R15T 83.0-86.5	NONE	YES
3500H 109J-2	.014 ±.001 THICK C.R. STEEL, R15T 80.0-85.0 #3 TEMPER	NICKEL PLATE	NO

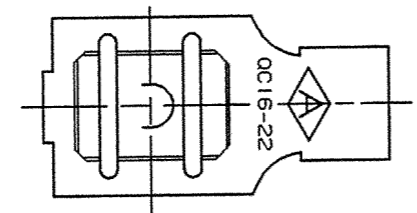
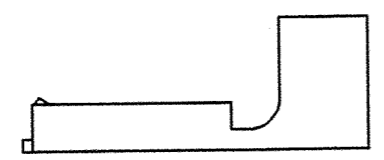
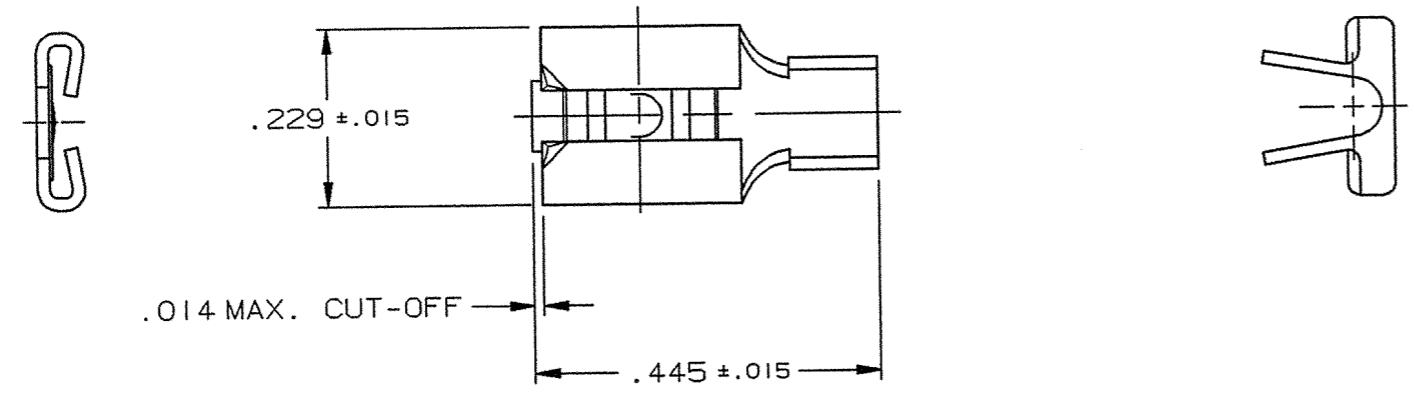

ARK-LES
UNCONTROLLED

- NOTES:
1. TO ACCEPT A .187 X .020 MALE TAB.
 2. TO ACCOMMODATE #16 - #22 GAUGE WIRE.
 3. RECOMMENDED STRIP LENGTH: 5/32 ±1/32.
 4. FOR LOOSE PIECE PARTS ADD SUFFIX "-1" TO PART NUMBER. (i.e. 3500H 109A-2-1)
 5. FOR PARTS WITH PAPER INTERLEAVING ADD SUFFIX "K" TO PART NUMBER (i.e. 3500H 109A-2K)
 6. FOR STANDARD REELING SEE FIGURE 1.
 7. FOR REVERSE REELING ADD SUFFIX "R" TO PART NUMBER. (i.e. 3500H 109A-2R) SEE FIGURE 2.
 8. FIRST INSERTION FORCE TO BE 12.0 LBS. MAX. - 6.0 LBS. MIN. WHEN USING MALE TEST TAB CS3500M-6. ALL OTHER FORCES MUST COMPLY WITH UL 310.

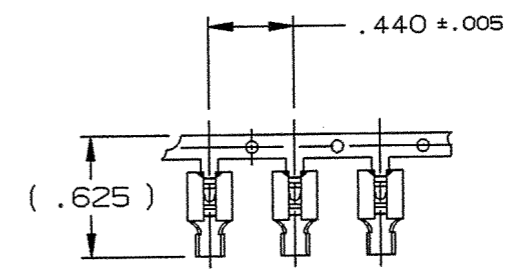

FABRICATED TERMINAL STRIP
SCALE 1=1

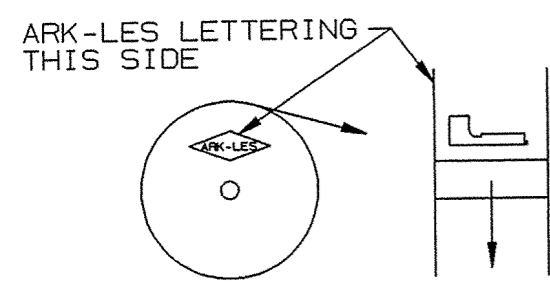

FIGURE 1
STANDARD REELING
(I.E. 3500H 109A-2)

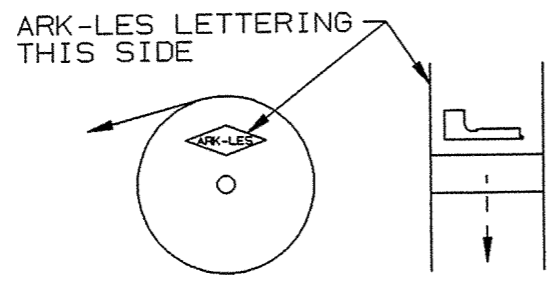

FIGURE 2
REVERSE REELING
(I.E. 3500H 109A-2R)

				PROD. REL.	PER CAB	2/11/74	PC	TOLERANCES UNLESS OTHERWISE SPECIFIED:		
				QUOTE REL.				DECIMALS ±.010	METRIC ±0.25mm	ANGLES ±1°
				DR:	R. TASTULA	7/19/01		MATERIAL: SEE TABLE		
				CHK'D:	R.W.J.	7-24-03		FINISH: SEE TABLE		
T	REVISED PER ECR #S000002	7/23/03	RT	APP:	LTD	7-31-03		PART NO: 3500H 109/-2		
S	REVISION S WAS E PER ECR #12192	7/19/01	RT	SUPERCEDES DWG. DATED: 6/15/01						
REV.	DESCRIPTION	DATE	DR.	SCALE: 4=1	CAD NO: BTU0030					

ORIGINAL IF RED