

DEPT	
1	1
2	
3	
4	3
5	
6	
7	
8	
9	
10	
11	
12	
NC	
JZ	

PART NAME: TERMINAL, FEMALE

PART NO: 3500H 504A/

PART NUMBER	MATERIAL	FINISH	Q.C. STAMP
3500H 504A	.020 ±.001 THK. BRASS C26000, 1/2 HARD R1ST 80.0-85.5 PRETINNED	SEE MAT'L	NO
3500H 504AB	.020 ±.001 THK. BRASS C26000, 1/2 HARD R1ST 80.0-85.5	NONE	NO

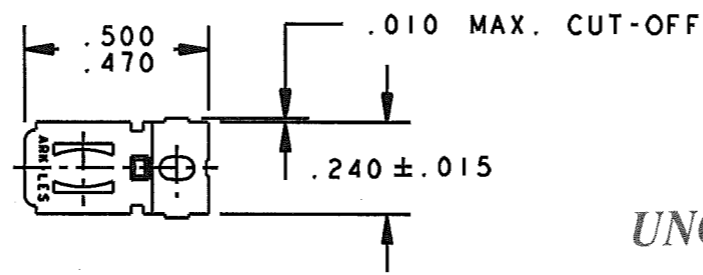
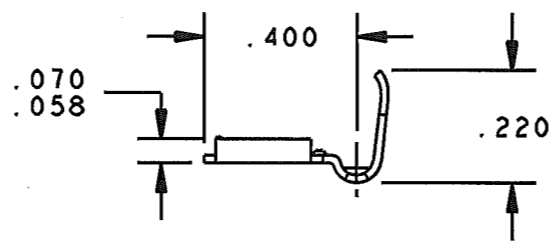
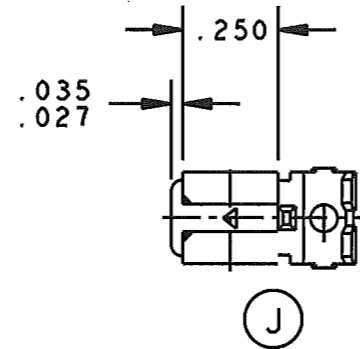

- NOTES:
1. TO ACCEPT .187 X .020 MALE TAB.
 2. TO ACCOMMODATE #16-#22 AWG.
 3. RECOMMENDED STRIP LENGTH: 9/32 ±1/32.
 4. FOR REVERSE REELING ADD SUFFIX "R" TO PART NUMBER (I.E. 3500H 504AR).
 5. FOR PARTS LOOSE PIECE ADD SUFFIX "-1" TO PART NUMBER (I.E. 3500H 504A-1).
 6. FOR STANDARD REELING SEE FIGURE 1.

ARK-LES UNCONTROLLED

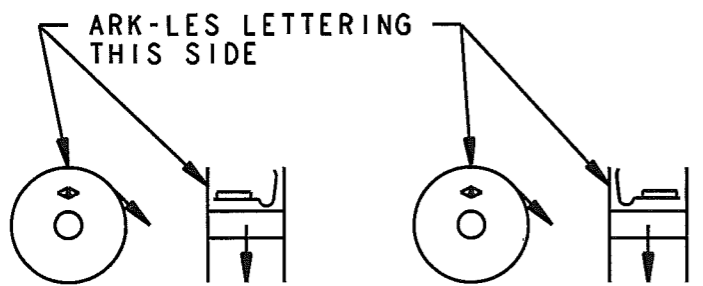
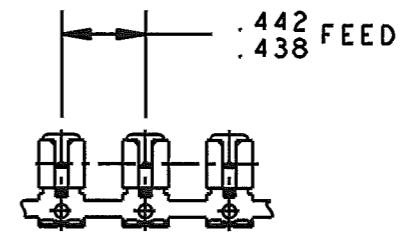

FIGURE 1
STANDARD REELING
(I.E. 3500H 504A)

FIGURE 2
REVERSE REELING
(I.E. 3500H 504AR)

WINDING DIAGRAMS

FABRICATED TERMINAL STRIP

SCALE: FULL

ORIGINAL IF RED

REV.	DESCRIPTION	DATE	DR.	SCALE: 2:1	CAD NO: 3500H-504A-REV. CUST	PART NO: 3500H 504A/
K	REVISED PER ECR #S000223	10/20/06	DON	PROD. REL. JA 0808 2/4/81 RT	TOLERANCES UNLESS OTHERWISE SPECIFIED: DECIMALS ±.010 METRIC ±0.25mm ANGLES ±1°	
J	REVISED PER ECR #12100	11/10/00	RT	QUOTE REL.	MATERIAL: SEE TABLE	
H	REVISED PER ECR #11252	5/13/97	BJC	DR: R. TASTULA 11/27/95		
G	REVISED PER ECR #11211	2/7/97	RT	CHK'D: <i>Donnell</i> 11/6/06	FINISH: SEE TABLE	
F	REV. & REDWN PER ECR #10730	11/27/95	RT	APP: <i>RT</i> 11/26/06		
				SUPERCEDES DWG. DATED: 2/9/93		