

DEPT	
1	1
2	
3	
4	2
5	
6	
7	
8	
9	
10	
11	
12	
NC	
JZ	

PART NAME: TERMINAL - FEMALE

PART NO: 3000H49/

PART NUMBER	MATERIAL	FINISH	Q.C. STAMP	REMARKS
3000H49A	.020 ±.001 THICK BRASS, PRETINNED	SEE MAT'L	YES	
3000H49AB	.020 ±.001 THICK BRASS	NONE	YES	
3000H49AC	.018 ±.001 THICK C.R. STEEL	NICKEL PLATE	NO	
3000H49J	.018 ±.001 THICK C.R. STEEL PRE-NICKEL PLATE	SEE MAT'L	NO	

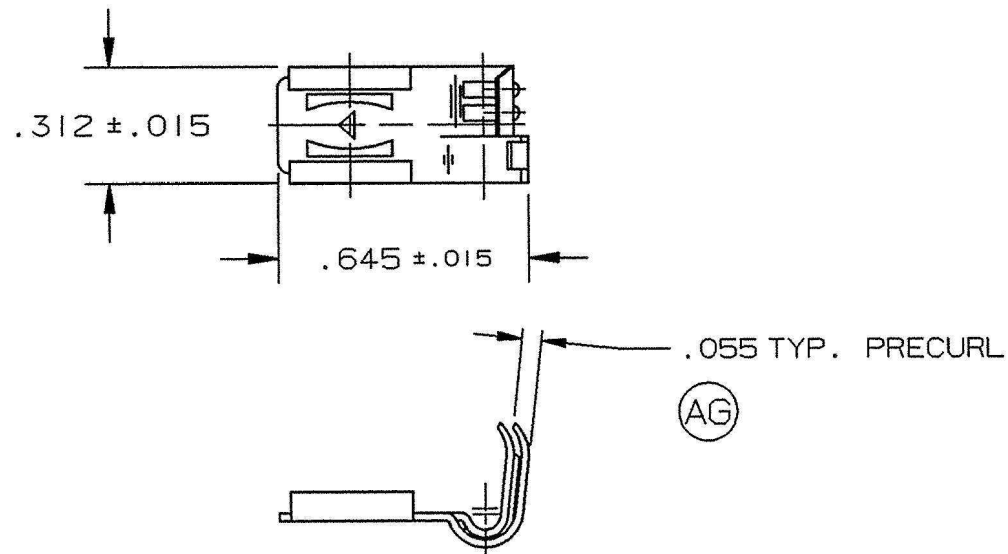

NOTES:

- TO FIT STANDARD .250 X .032 MALE TAB.
- TO ACCOMMODATE #14-#20 GAUGE WIRE.
- INSULATION RANGE: .075-.155 DIA.
- RECOMMENDED STRIP LENGTH: 5/32 ±1/32.
- FOR TERMINAL LOOSE PIECE ADD SUFFIX "-1" TO PART NUMBER. (I.E. 3000H49A-1)
- EACH REEL TO BE SEALED WITH A PLASTIC BAG & 2 BAGS OF DESICCANT.
- FOR STANDARD REELING SEE FIGURE 1. FOR REVERSE REELING ADD SUFFIX "R" TO PART NUMBER (I.E. 3000H49AR) SEE FIGURE 2.
- FOR PARTS REQUIRING PAPER INTERLEAVING ADD SUFFIX "K" TO PART NUMBER. (I.E. 3000H49AK)

(AH)

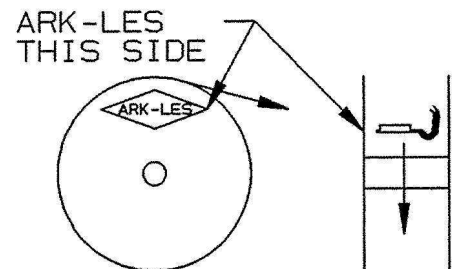
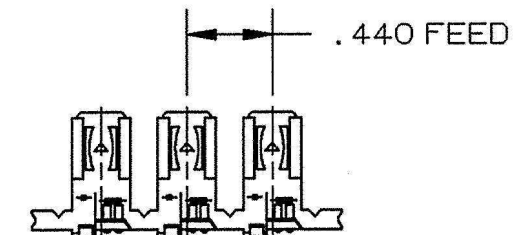

3000H49A
STANDARD REELING DIAGRAM
FIGURE 1

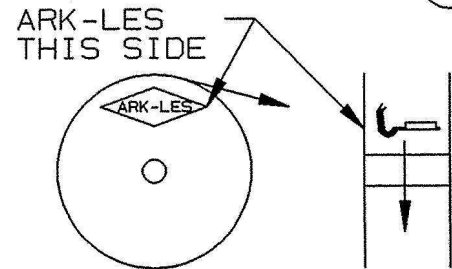

3000H49AR
REVERSE REELING DIAGRAM
FIGURE 2

ARK-LES
UNCONTROLLED

FABRICATED TERMINAL STRIP

SCALE: FULL

			PROD. REL.	1/27/61	SED	TOLERANCES UNLESS OTHERWISE SPECIFIED:		
			QUOTE REL.	1/27/61	SED	DECIMALS ±.010	METRIC ±0.25mm	ANGLES ±1°
			DR: R. TASTULA	10/1/97		MATERIAL: SEE TABLE		
			CHK'D: R.W.T.	6-28-00		FINISH: SEE TABLE		
AH	NOTE 8 ADDED PER ECR #12003	5/26/00	RT	APP: J. Bishop	7-3-00	PART NO: 3000H49/		
AG	REVISED & REDRAWN PER ECR #11364	10/1/97	RT	SUPERCEDES DWG. DATED: 8/14/92				
REV.	DESCRIPTION	DATE	DR.	SCALE: 2:1	CAD NO: BT00039			

ORIGINAL IF RED