

CUSTOMER PRINT

- DEPT
- 1 /
- 2
- 3
- 4 /
- 5
- 6
- 7
- 8
- 9
- 10
- 11
- 12
- 13
- 14
- 15
- 16
- 17
- 18
- 19
- 20
- 21
- 22
- 23
- 24
- 25
- 26
- 27
- 28
- 29
- 30
- 31
- 32
- 33
- 34
- 35
- 36
- 37
- 38
- 39
- 40
- 41
- 42
- 43
- 44
- 45
- 46
- 47
- 48

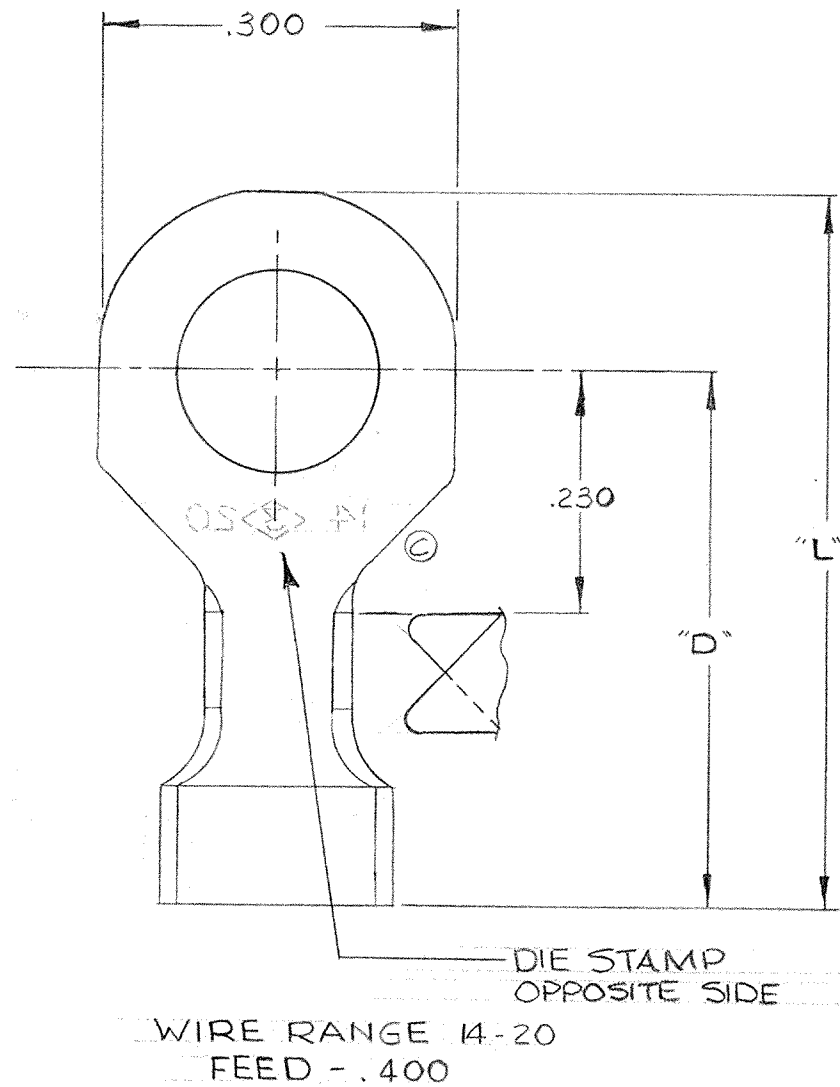

PART NO	INS. DIA.	STUD SIZE	STOCK THK. ±.001	MATERIAL & FINISH	"L" DIM.	"D" DIM.	REL. FOR QUOTE	REL. FOR DP#	REL. FOR PROD.
(A) 3G1-8-2	.075-.175	8	.020	BRASS	.718	.547	31546	31720 363	31546
3G2-8-2				PRETINMED BRASS					
(E) (B) 3G11-8-2	.075-.175	8	.020	C.R. STEEL NICKEL PLATE	.718	.547	88315	31720 774	88315

ARK-LES
UNCONTROLLED

E	4000-3G11-8-2; OBSOLETE; ECR 4986	9-11-84	PJP	RELEASED FOR PRODUCTION				TOLERANCES UNLESS OTHERWISE SPECIFIED:		
D	DIE STAMP REV DCR 726	2-25-76	KS	RELEASED FOR TOOLS				DECIMALS ±.010	FRACTIONS ±.010	ANGLES ±1°
C	ARK-LES 3 & 14-20 ADDED	4-8-74	P.C.	RELEASED FOR QUOTATION				DO NOT SCALE DRAWING		
B	3G11-8-2 ADDED	11-27-72	R.F.	NEW DRAWING SUPERSEDES						
A	3G1-8-2 ADDED	1-28-72	J.B.	DRAWN BY R. Jarvis	MATERIAL	AK				
	REVISIONS	DATE	APP	CHECKED BY R. Jarvis						
				APPROVED BY	FINISH	AK				
DATE OF DRAWING 5-24-67				SCALE AK		DATE OF PRINT				
DESTROY ALL PREVIOUS PRINTS										

ORIGINAL IF RED