

DEPT	
1	1
2	
3	
4	2
5	
6	
7	
8	
9	
10	
11	
12	
NC	
JZ	

PART NAME:

RING TERMINAL

SHEET 1 OF 2

PART NO:

4000-5G/

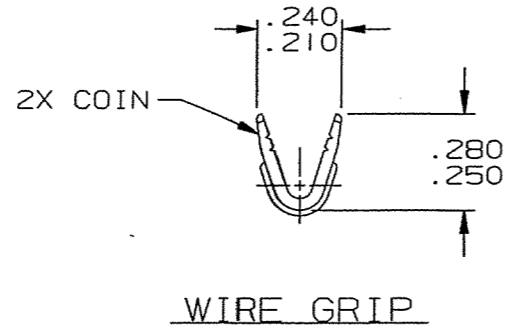
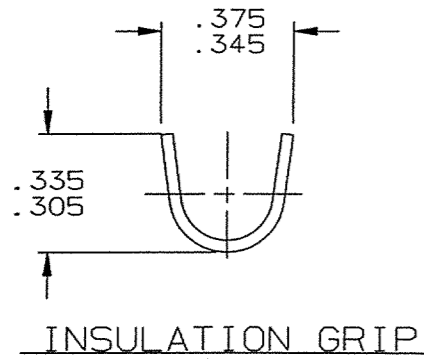
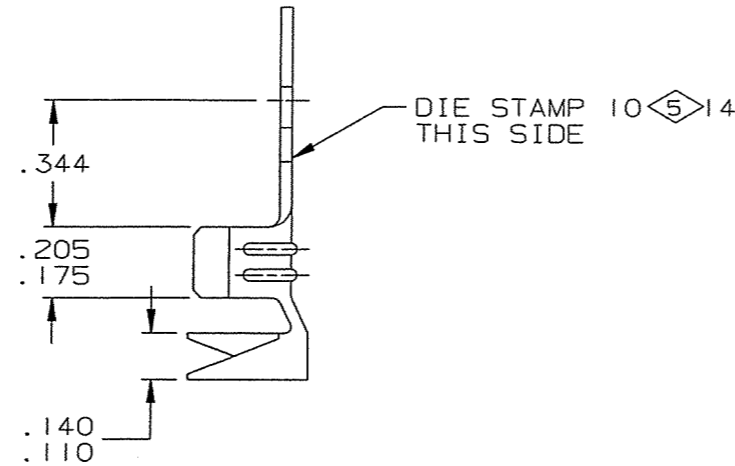
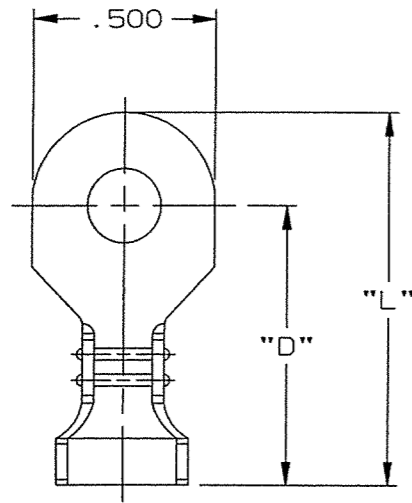

ARK-LES
UNCONTROLLED

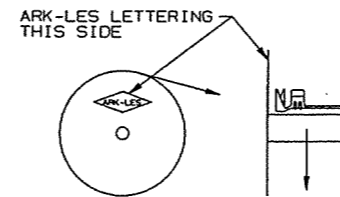

STANDARD REELING
(I.E. 4000-5G3-8)

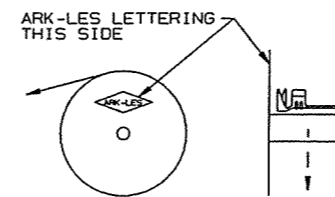

REVERSE REELING
(I.E. 4000-5G3-8R)

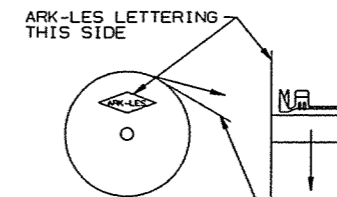

STANDARD REELING
WITH PAPER INTERLEAVING
(I.E. 4000-5G3-12K)

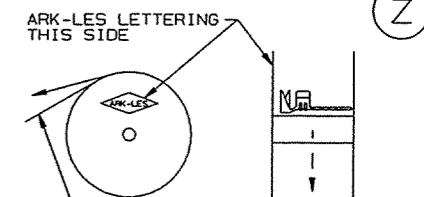

REVERSE REELING
WITH PAPER INTERLEAVING
(I.E. 4000-5G3-12RK)

NOTES:

1. WIRE RANGE: #10-#14
2. RECOMMENDED STRIP LENGTH: 7/32 ± 1/32
3. FEED: .600
4. FOR REVERSE REELING ADD SUFFIX "R" TO PART NUMBER, (I.E. 4000-5G3-8R).
5. FOR TERMINALS LOOSE PIECE ADD SUFFIX "-1" TO PART NUMBER, (I.E. 4000-5G3-8-1).
6. ADD SUFFIX "K" TO PART NUMBER FOR PAPER INTERLEAVED REELS, (I.E. 4000-5G3-8K).

PART NUMBER	INSULATION DIAMETER	STUD SIZE	STOCK THICK. ±.001	MATERIAL & FINISH	DIM. "L"	DIM. "D"
4000-5G3-7	NO INSULATION GRIP	#8	.032	BRASS	(.790)	.531
4000-5G4-7				BRASS PRETINNED		
4000-5G3-8	.150-.250	#8	.032	BRASS	1.000	.750
4000-5G4-8				BRASS PRETINNED		
4000-5G3-9	NO INSULATION GRIP	#10	.032	BRASS	(.790)	.531
4000-5G4-9				BRASS PRETINNED		
4000-5G3-10	.150-.250	#10	.032	BRASS	1.000	.750
4000-5G4-10				BRASS PRETINNED		
4000-5G4-60				ETP COPPER PRETINNED		
4000-5G3-11	NO INSULATION GRIP	1/4	.032	BRASS	(.790)	.531
4000-5G4-11				BRASS PRETINNED		
4000-5G3-12	.150-.250	1/4	.032	BRASS	1.000	.750
4000-5G4-12				BRASS PRETINNED		
4000-5G4-62				ETP COPPER PRETINNED		
4000-5G3-13	NO INSULATION GRIP	5/16	.032	BRASS	(.790)	.531
4000-5G4-13				BRASS PRETINNED		
4000-5G3-14	.150-.250	5/16	.032	BRASS	1.000	.750
4000-5G4-14				BRASS PRETINNED		
4000-5G3-15	NO INSULATION GRIP	3/8	.032	BRASS	(.790)	.531
4000-5G4-15				BRASS PRETINNED		
4000-5G3-16	.150-.250	3/8	.032	BRASS	1.000	.750
4000-5G4-16				BRASS PRETINNED		

			PROD. REL.	CA	3296	TOLERANCES UNLESS OTHERWISE SPECIFIED:		
			QUOTE REL.			DECIMALS ±.010	METRIC ±0.25mm	ANGLES ±1°
			DR: B J CARUTHERS 10/7/96			MATERIAL: SEE TABLE		
			CHK'D: RWT 4-27-01			FINISH: SEE TABLE		
Z	REVISED PER ECR #12158	4/26/01	RT	APP: Bishop 5-9-01			PART NO: 4000-5G/	
Y	REVISED PER ECR #11074	10/7/96	BJC	SUPERCEDES DWG. DATED: 9/24/92				
REV.	DESCRIPTION	DATE	DR.	SCALE: 2=1	CAD NO: BWQ0001			

ORIGINAL IF RED

DEPT	
1	1
2	
3	
4	2
5	
6	
7	
8	
9	
10	
11	
12	
NC	
JZ	

PART NAME:

RING TERMINAL

SHEET 2 OF 2

PART NO:

4000-5G/

PART NUMBER	INSULATION DIAMETER	STUD SIZE	STOCK THICK. ±.001	MATERIAL & FINISH	DIM. "L"	DIM. "O"
4000-5G2-7	NO INSULATION GRIP	#8	.020	BRASS PRETINNED	(.790)	.525

(Z)

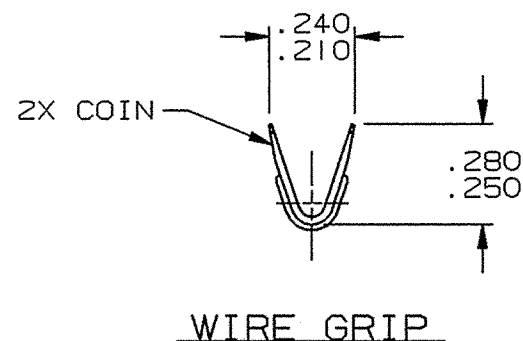
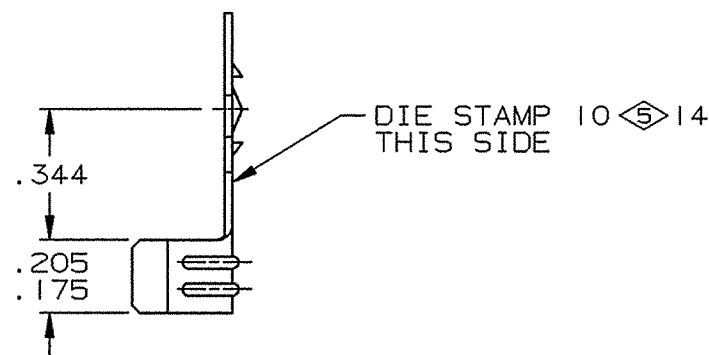
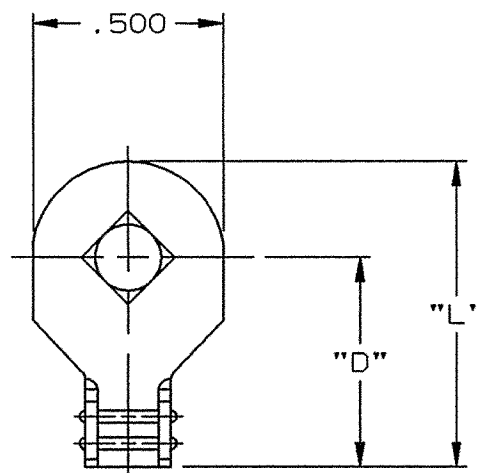

WIRE GRIP

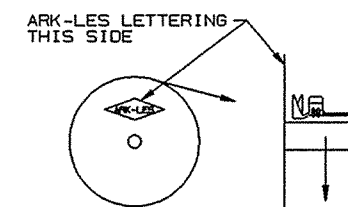

STANDARD REELING
(I.E. 4000-5G2-7)

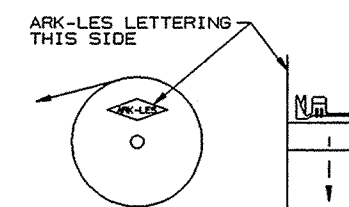

REVERSE REELING
(I.E. 4000-5G2-7R)

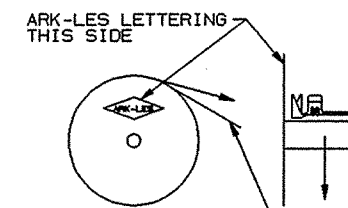

STANDARD REELING
WITH PAPER INTERLEAVING
(I.E. 4000-5G2-7K)

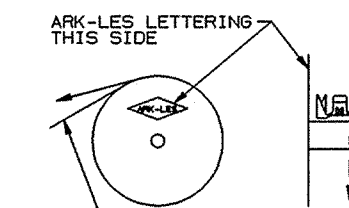

REVERSE REELING
WITH PAPER INTERLEAVING
(I.E. 4000-5G2-7RK)

**ARK-LES
UNCONTROLLED**

NOTES:

1. WIRE RANGE: #10-#14
2. RECOMMENDED STRIP LENGTH: 7/32 ±1/32
3. FEED: .600
4. FOR REVERSE REELING ADD SUFFIX "R" TO PART NUMBER, (I.E. 4000-5G2-7R).
5. FOR TERMINALS LOOSE PIECE ADD SUFFIX "-1" TO PART NUMBER, (I.E. 4000-5G2-7-1).
6. ADD SUFFIX "K" TO PART NUMBER FOR PAPER INTERLEAVED REELS, (I.E. 4000-5G2-7K).

				PROD. REL.	87074	3/16/64	HK	TOLERANCES UNLESS OTHERWISE SPECIFIED:		
				QUOTE REL.				DECIMALS ±0.010	METRIC ±0.25mm	ANGLES ±1°
				DR:	B J CARUTHERS		10/7/96	MATERIAL: SEE TABLE		
				CHK'D:	R.W.T.		4-27-01	FINISH: SEE TABLE		
Z	REVISED PER ECR #12158	4/26/01	RT	APP:	Bishop		5-9-01	PART NO: 4000-5G/		
Y	REVISED PER ECR #11074	10/7/96	BJC	SUPERCEDES DWG. DATED: 9/24/92						
REV.	DESCRIPTION	DATE	DR.	SCALE: 2=1	CAD NO: BW00002					

ORIGINAL IF RED