

General Specifications

- Motor Protection:**
Auto Restart/Polarity Protection
- Insulation Resistance:**
10M Ω or over with a DC500V Megger
- Dielectric Withstand Voltage:** AC 700V 1s
- Allowable Ambient Temperature Range:**
-10°C ~ +60°C (Operating)
-40°C ~ +70°C (Storage)
(non-condensing environment)

Expected Life

Failure Rate: 10%
40°C 70,000 Hours (B00)

Material

- Casing : Plastic (Black) 94V-0
- Impeller : Plastic (Black) 94V-0
- Bearing : Ball Bearing
- Lead Wire : UL10368, AWG24, +Red, -Black
- Tach Sig. : White PWM Control : Brown

Panel Cut-Outs

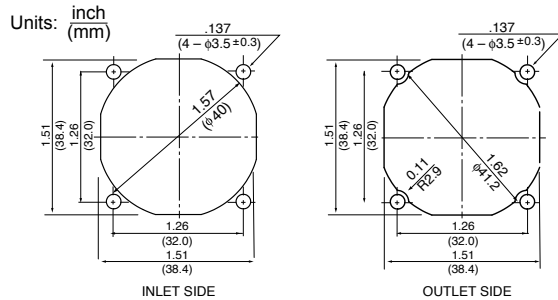

Characteristic Curves

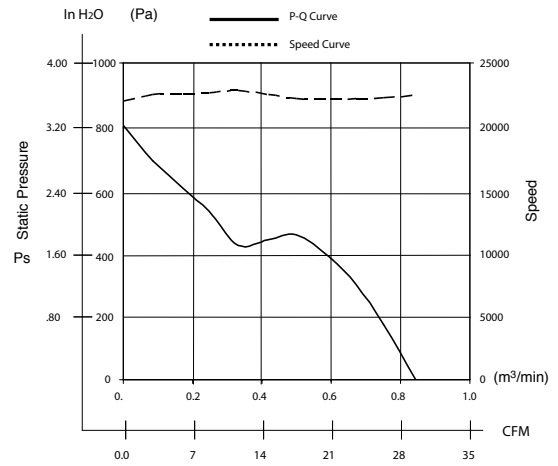

Outline

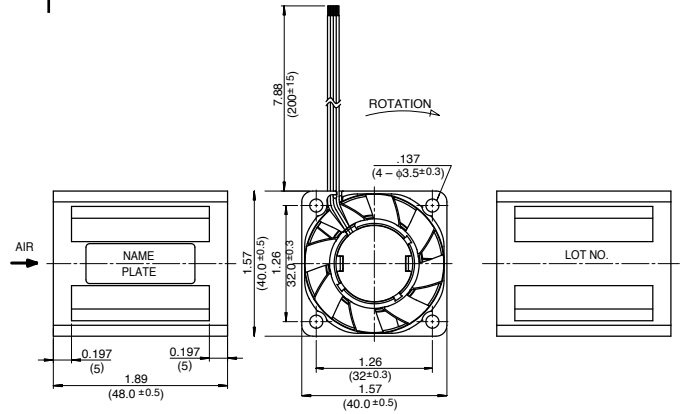

PWM Control Voltage

- Vst = 0V ~ 0.5V Stop (On Duty 0%)
 - Vst = 3.3V ~ 5.0V Full Speed (On Duty 100%)
 - Vst = Open Full Speed
- (At Ta = 25°C, rated voltage 12VDC)

Reference PWM Duty Vs. Speed Curve

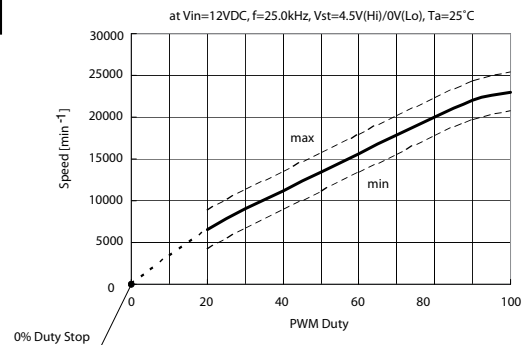

Specifications

MODEL	Product No.	Rated Voltage	Operating Voltage	Current	Input Power	Speed	Max. Flow		Max. Static Pressure		Noise	Mass
		(V)	(V)	(A) ^{*1}	(W) ^{*1}	(min ⁻¹) ^{*1}	Air CFM ^{*1}	(m ³ /min) ^{*1}	in HzO	(Pa) ^{*1}	(dB) ^{*1}	(g)
1619FT-04W-B86-	BXX	12	10.8 ~ 13.2	1.05	12.60	23,000	28.9	0.82	3.29	820.0	62.0	71

Rotation: Clockwise

Airflow Outlet: Air Out Over Struts

*1: Average Values in Free Air