

# FBL09A (92<sup>□</sup> x 25.5<sup>L</sup>)



EMINEBEA.COM

**THIS MODEL IS NO LONGER AVAILABLE FOR NEW DESIGNS**  
See other models available in this frame size here - 3610KL

## General Specifications

### Allowable Ambient Temperature Range:

- 10°C ~ +70°C (65%RH) (Operating)
- 40°C ~ +75°C (65%RH) (Storage)
- (non-condensing environment)

## Expected Life

**Failure Rate: 10%**  
50,000 Hours (40°C, 65%RH)

## Outline

Units:  $\frac{\text{inch}}{\text{mm}}$

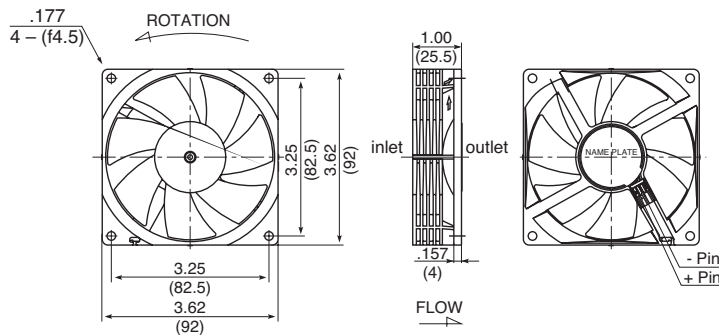

## Characteristic Curves

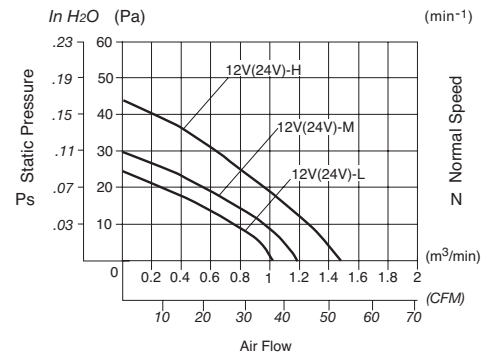

## Panel Cut-outs

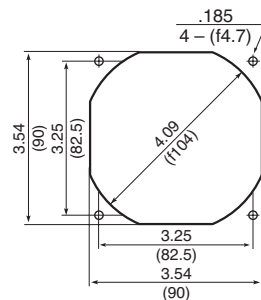

OUTLET SIDE

## Material

Bearing: Hydro Wave Bearing

## Specifications

| MODEL      | Rated Voltage | Operating Voltage | Current           | Input Power       | Rated Speed                        | Max. Air Flow     |                                     | Max. Static Pressure |                    | Noise              | Mass |
|------------|---------------|-------------------|-------------------|-------------------|------------------------------------|-------------------|-------------------------------------|----------------------|--------------------|--------------------|------|
|            | (V)           | (V)               | (A) <sup>*1</sup> | (W) <sup>*1</sup> | (min <sup>-1</sup> ) <sup>*1</sup> | CFM <sup>*1</sup> | (m <sup>3</sup> /min) <sup>*1</sup> | in H <sub>2</sub> O  | (Pa) <sup>*1</sup> | (dB) <sup>*1</sup> | (g)  |
| FBL09A 12L | 12            | 7.0 ~ 13.8        | 110               | 1.32              | 2200                               | 42.7              | 1.21                                | .10                  | 25.5               | 27.0               | 110  |
| FBL09A 12M | 12            | 7.0 ~ 13.8        | 150               | 1.80              | 2450                               | 48.0              | 1.36                                | .11                  | 29.4               | 30.0               | 110  |
| FBL09A 12H | 12            | 7.0 ~ 13.8        | 255               | 2.70              | 2950                               | 56.8              | 1.61                                | .16                  | 42.1               | 35.0               | 110  |
| FBL09A 24L | 24            | 14.0 ~ 27.6       | 80                | 1.92              | 2200                               | 42.7              | 1.21                                | .10                  | 25.5               | 27.0               | 110  |
| FBL09A 24M | 24            | 14.0 ~ 27.6       | 110               | 2.64              | 2450                               | 48.0              | 1.36                                | .11                  | 29.4               | 30.0               | 110  |
| FBL09A 24H | 24            | 14.0 ~ 27.6       | 140               | 3.36              | 2950                               | 56.8              | 1.61                                | .16                  | 42.1               | 35.0               | 110  |

Rotation: Clockwise

Airflow Outlet: Air Out Over Struts

\*1: Average Values in Free Air