



Mallory Sonalert Products, Inc.

Part #:

MSE14LCM3

Sales Outline Drawing

Revision:

A

Specifications:

Sound Level Category	Loud
Mode of Operation	Chime @ Once per 1 Second
Voltage Rating	7 to 14 VDC
Frequency	3500 ± 500 Hz
Loudness @ 1 FT	85 to 95 dB(A) Typ.
Current Draw	50mA MAX
Housing Material	Valox (UL94V-0), Color: Black
Storage Temperature	-40° to +80°C
Operating Temperature	-40° to +65°C
Weight (Typical)	4.0g
Options	Please contact factory.

Dimensions: Inches (mm)

ROHS Compliant

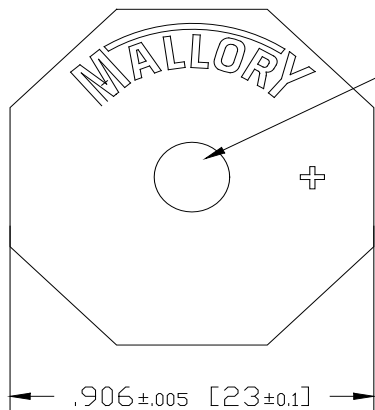

EMISSION HOLE
 $\varnothing .188 \pm .005$ [4.8±0.1]

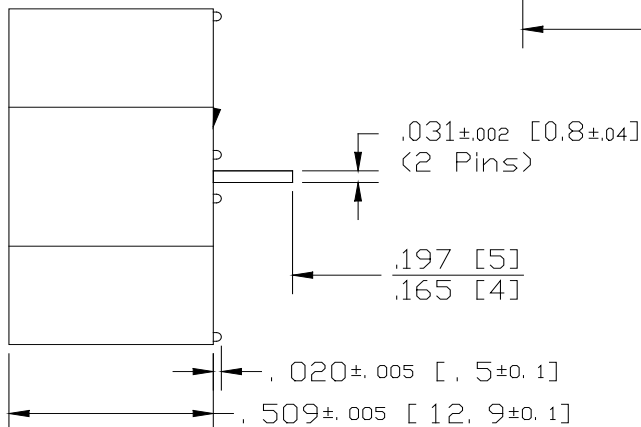
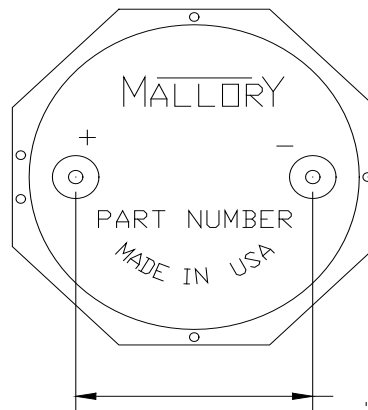

NOTE A:
TERMINALS - .031" DIA. NICKEL/TIN COATED BRASS.

NOTE B:
MOUNTING- INSERT INTO PRINTED CIRCUIT BOARD AND HAND OR MACHINE SOLDER.
UNITS ARE SUITABLE FOR WAVE SOLDERING. RECOMMENDED MAXIMUM TEMPERATURE
AND TIME DURATION FOR WAVE SOLDERING IS +270°C AND 3 SECONDS RESPECTIVELY.