

REV.	DESCRIPTION/ECO NO.	DATE
	RELEASED	3/14/01
A	CHANGE TO (Pb) FREE ASSEMBLY	2/17/05

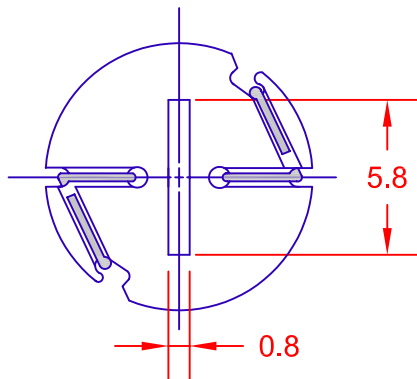
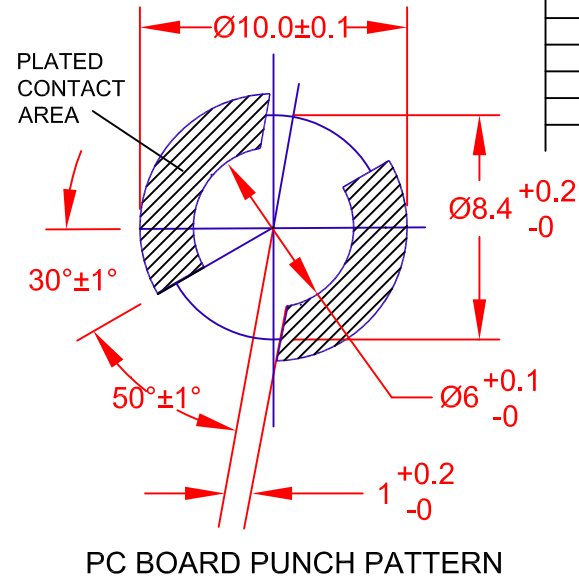
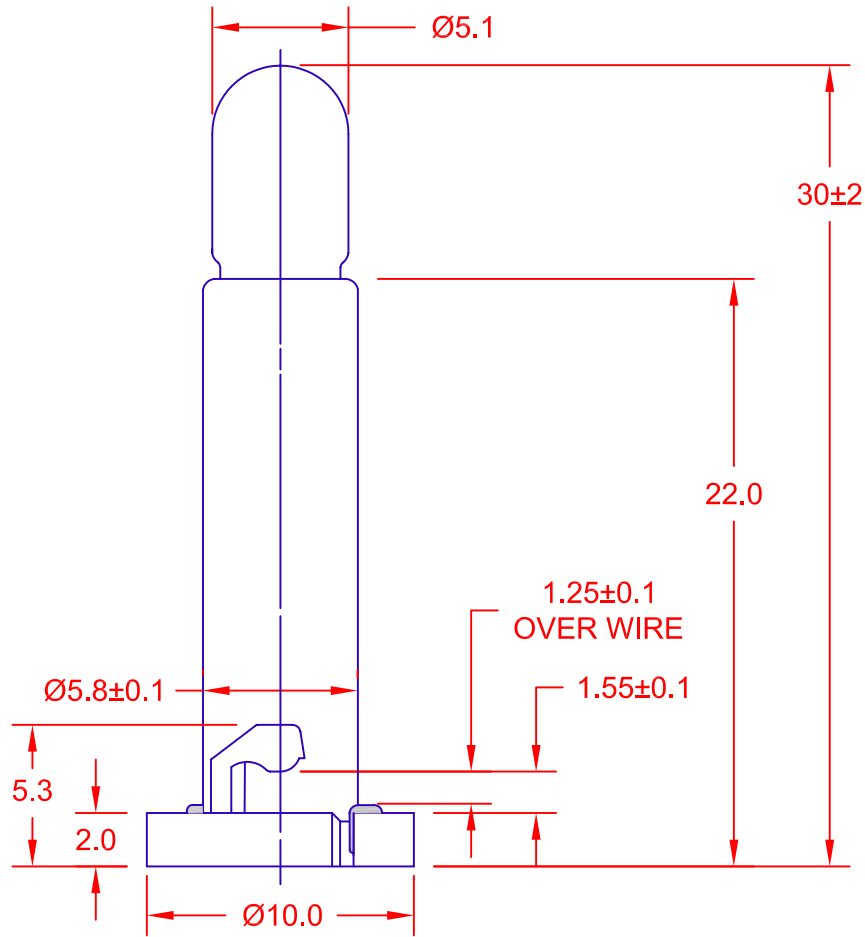

JKL PART NUMBER: DNW1-EW33/30MM***

LAMP NUMBER: EW33**					
VOLTS RATED	AMPS $\pm 10\%$	*MSCP $\pm 25\%$	*LUMENS $\pm 25\%$	AVERAGE LIFE HRS.	FILAMENT TYPE
14.0	.125	.700	9.00	10,000	C-2F

* LAMP RATING ONLY WITHOUT BASE.

** LAMP GLASS LEAD (Pb) FREE.

*** LAMP AND BASE ASSEMBLY LEAD (Pb) FREE.

CONTACT JKL FOR LEAD (Pb) FREE LOT IDENTIFICATION.

METRIC		DIMENSIONS ARE IN MILLIMETERS		JKL COMPONENTS CORPORATION				
 THIRD ANGLE PROJECTION		TOLERANCE UNLESS OTHERWISE SPECIFIED 1 PL +/- 0.2 2 PL +/- 0.20 ANGLE +/- 0		TITLE DNW1 EXTENDED NEO-WEDGE BASE WITH EW33 LAMP				
				DRAWN BY L. WENGSTROM	APPV'D BY J.K.	DATE 2/17/05	SIZE A	FSCM NO. 55335
- CAD DRAWING - MANUAL REVISIONS NOT PERMITTED				SCALE NONE	RELEASED DATE 3/14/01	REVISION DATE 2/17/05	REV. NO. A	SHEET 1 OF 1