

DESCRIPTION: HIGH DENSITY MALE - VERTICAL DIP SOLDER

DIMENSIONS

| No. OF PINS | A     | B     | C     | D     | E     | F     | G     | H     |
|-------------|-------|-------|-------|-------|-------|-------|-------|-------|
| 15          | 1.213 | 0.984 | 0.666 | 0.329 | 0.090 | 0.756 | 0.496 | 0.429 |
|             | 30.80 | 24.99 | 16.92 | 8.36  | 2.29  | 19.20 | 12.60 | 10.90 |
| 26          | 1.541 | 1.312 | 0.970 | 0.329 | 0.090 | 1.091 | 0.496 | 0.429 |
|             | 39.15 | 33.32 | 24.65 | 8.36  | 2.29  | 27.70 | 12.60 | 10.90 |
| 44          | 2.087 | 1.852 | 1.512 | 0.329 | 0.090 | 1.618 | 0.496 | 0.429 |
|             | 53.00 | 47.04 | 38.40 | 8.36  | 2.29  | 41.10 | 12.60 | 10.90 |
| 62          | 2.728 | 2.500 | 2.157 | 0.329 | 0.095 | 2.256 | 0.496 | 0.429 |
|             | 69.30 | 63.50 | 54.80 | 8.36  | 2.41  | 57.30 | 12.60 | 10.90 |
| 78          | 2.638 | 2.406 | 2.079 | 0.436 | 0.095 | 2.169 | 0.606 | 0.526 |
|             | 67.00 | 61.10 | 52.80 | 11.07 | 2.41  | 55.10 | 15.40 | 13.35 |

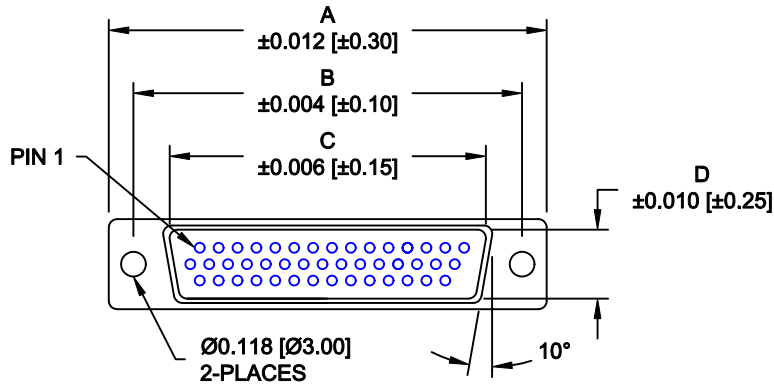

4 ROWS

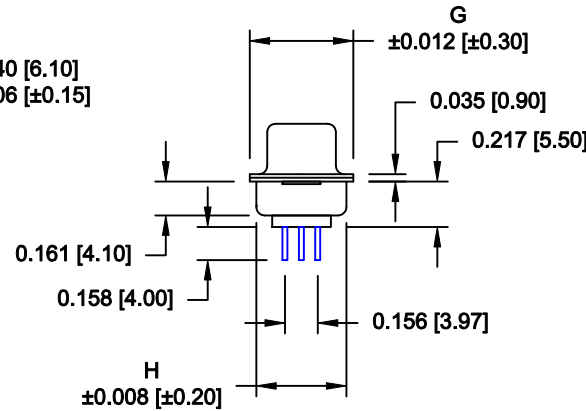
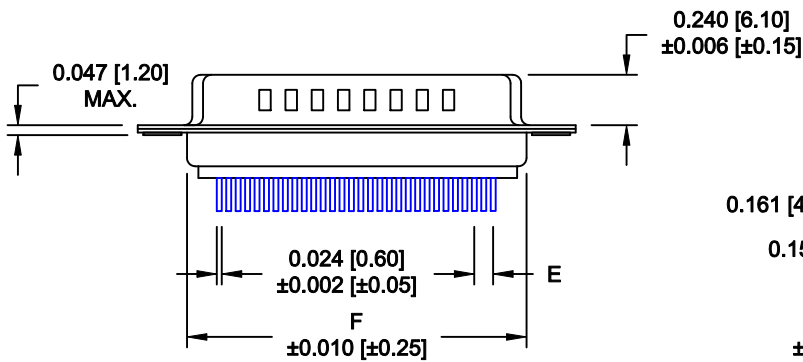

MATERIAL:

SHELL: STEEL, NICKEL PLATED  
 INSULATOR: PBT, UL 94V-O RATED,  
 +30% FIBER-GLASS OR NYLON-66  
 CONTACT: BRASS, GOLD PLATED OVER NICKEL

ELECTRICAL:

CURRENT RATING: 5 AMPS  
 CONTACT RESISTANCE: 15 mOhms Max.  
 INSULATION RESISTANCE: 1,000 MOhms min.  
 VOLTAGE: 500VAC FOR 1 MINUTE  
 TEMPERATURE: -50° C TO 100° C

RoHS COMPLIANT

**180-YYY-113RYY1**

SERIES \_\_\_\_\_  
 POSITIONS \_\_\_\_\_  
 015 \_\_\_\_\_  
 026 \_\_\_\_\_  
 044 \_\_\_\_\_  
 062 \_\_\_\_\_  
 078 \_\_\_\_\_  
 GENDER \_\_\_\_\_  
 1 = MALE  
 TERMINATION \_\_\_\_\_  
 1 = VERTICAL DIP SOLDER  
 SHELL PLATING \_\_\_\_\_  
 3 = NICKEL (GROUND INDENTS)  
 RoHS COMPLIANT (260°C) \_\_\_\_\_  
 HARDWARE OPTIONS \_\_\_\_\_  
 00 = NO HARDWARE  
 01 = .098" CLINCH NUT (BOARD SIDE)  
 02 = .236" CLINCH NUT (BOARD SIDE)  
 03 = .236" CLINCH NUT (MATING SIDE)  
 05 = .237 4-40 BOARD LOCK  
 91 = .237 4-40 SPACER/BOARD LOCK  
 PLATING OPTIONS \_\_\_\_\_  
 1 = GOLD FLASH  
 2 = 30u" GOLD

DO NOT SCALE FROM DRAWING

|  |   |   |                                |
|--|---|---|--------------------------------|
|  | THESE DRAWINGS AND SPECIFICATIONS ARE THE PROPERTY OF NorComp AND SHALL NOT BE REPRODUCED, COPIED OR USED AS THE BASIS FOR THE MANUFACTURE OF SALE OF APPARATUS WITHOUT WRITTEN PERMISSION. | DRAWN: <b>PAM JENKINS</b><br>CHECKED:               | DATE: <b>09-12-05</b><br>DATE: |
|  | <p><b>NorComp</b></p>   | SCALE: <b>1:1</b><br>DWG NO. <b>180-YYY-113RYY1</b> | SHEET <b>1</b> OF <b>3</b>     |

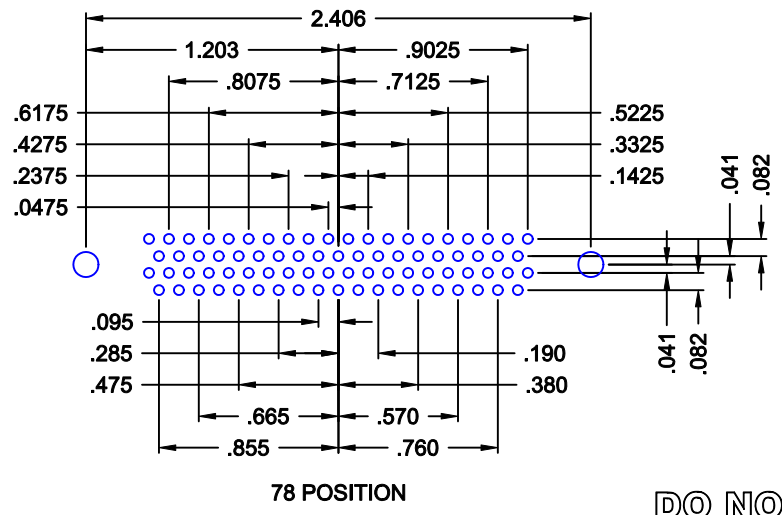
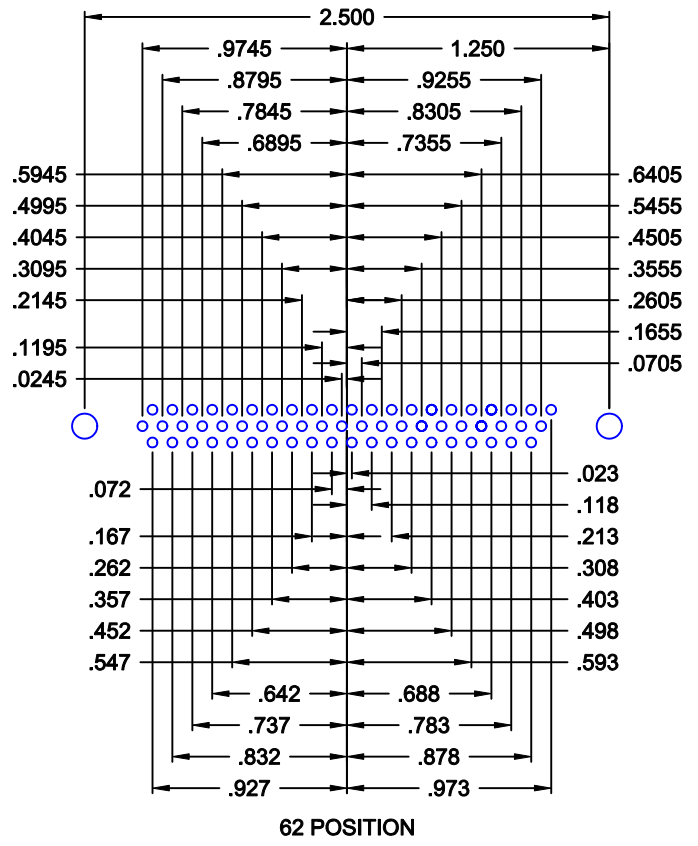
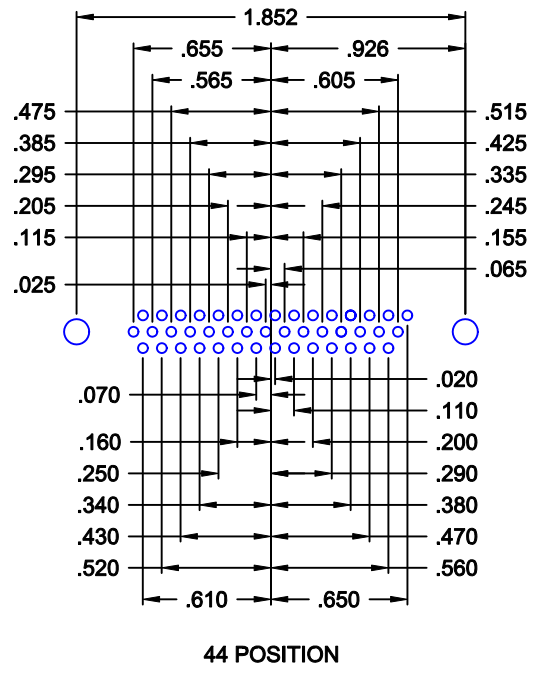
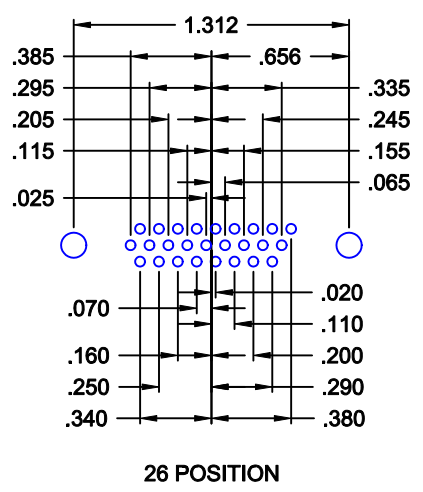
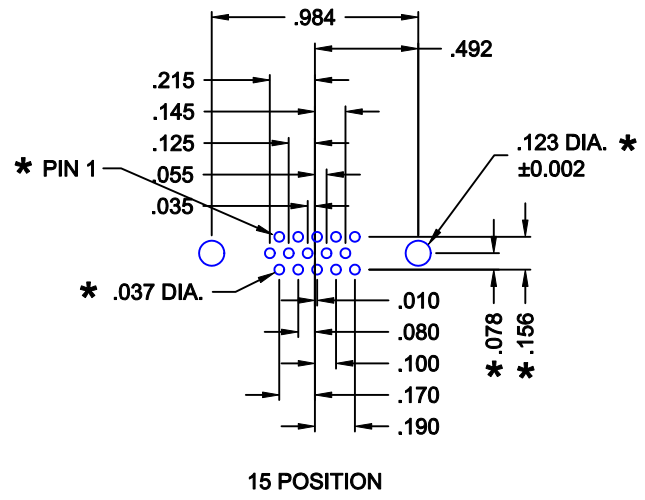

180 SERIES  
HIGH DENSITY  
VERTICAL

HOLE PATTERN SHOWN  
ARE FOR MALE

\* TYP. ON ALL SIZES

DO NOT SCALE FROM DRAWING

|                |   |                                |                              |                          |
|----------------|---|--------------------------------|------------------------------|--------------------------|
|                | THESE DRAWINGS AND SPECIFICATIONS ARE THE PROPERTY OF NorComp AND SHALL NOT BE REPRODUCED, COPIED OR USED AS THE BASIS FOR THE MANUFACTURE OF SALE OF APPARATUS WITHOUT WRITTEN PERMISSION. |                                | DRAWN:<br><b>PAM JENKINS</b> | DATE:<br><b>09-12-05</b> |
|                |   |                                | CHECKED:                     | DATE:                    |
| <b>NorComp</b> |   | SCALE:                         | SHEET <b>2</b> OF <b>3</b>   | REV <b>12</b>            |
|                |   | DWG NO. <b>180-YYY-113RYY1</b> |                              |                          |

**ALL CLINCH-NUTS ARE 4-40 INTERNAL THREADS**

01X ..... 0.098" (BOARD SIDE) - CN1

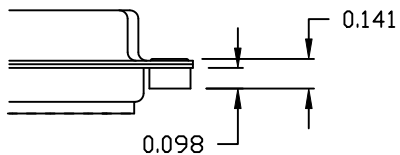

02X ..... 0.236" (BOARD SIDE) - CN2

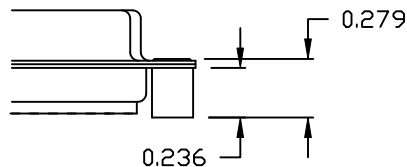

03X..... 0.236" (MATING SIDE) - CN8

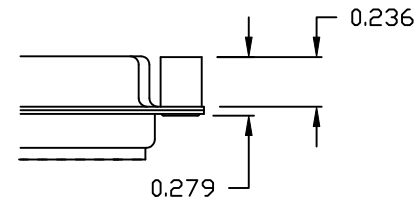

05X ..... 0.237" (BOARD SIDE) - CN10

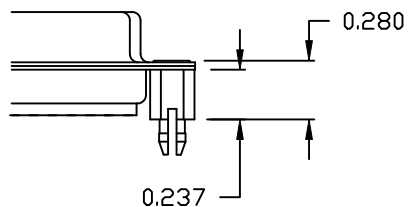

91X ..... 0.237" BOARD SIDE  
0.197 MATING SIDE  
CN10/SFSO4404

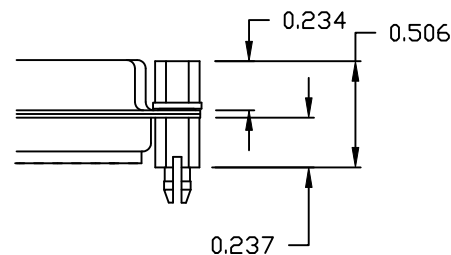

NOTE: 4-40 FEMALE SCREW LOCK IS REMOVABLE

**DO NOT SCALE FROM DRAWING**

**RoHS COMPLIANT**

|                  |   |                                |                                |                          |
|------------------|---|--------------------------------|--------------------------------|--------------------------|
|                  | THESE DRAWINGS AND SPECIFICATIONS ARE THE PROPERTY OF NorComp AND SHALL NOT BE REPRODUCED, COPIED OR USED AS THE BASIS FOR THE MANUFACTURE OF SALE OF APPARATUS WITHOUT WRITTEN PERMISSION. |                                | DRAWN:<br><b>WAYNE ROBBINS</b> | DATE:<br><b>11-28-05</b> |
|                  |   |                                | CHECKED:                       | DATE:                    |
| <h1>NorComp</h1> |   | SCALE:                         | SHEET <b>3</b> OF <b>3</b>     | REV <b>12</b>            |
|                  |   | DWG NO. <b>180-YYY-113RYY1</b> |                                |                          |