

DESCRIPTION: .085" RIBBON FEMALE R/A BOARD MOUNT

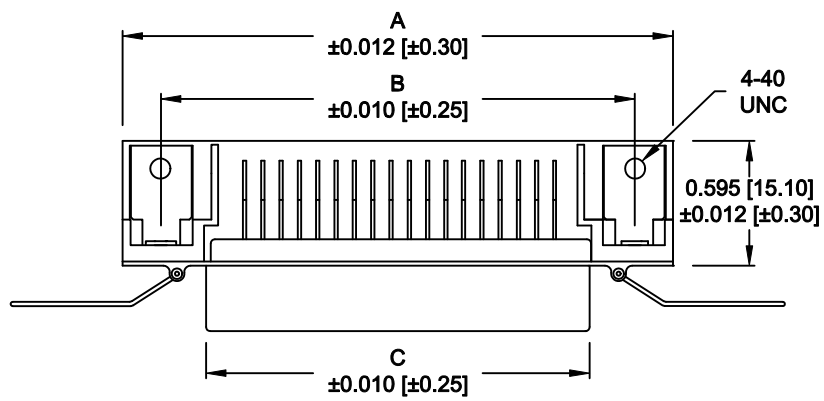

No. OF PINS	DIMENSIONS			
	A	B	C	D
14	1.728	1.417	0.992	0.602
	43.90	36.00	25.20	15.30
24	2.154	1.843	1.417	0.600
	54.70	46.80	36.00	15.25
36	2.667	2.352	1.925	0.600
	67.75	59.74	48.90	15.25
50	3.272	2.947	2.524	0.600
	83.10	74.85	64.10	15.25

**MATERIAL:**  
 COLD ROLLED STEEL,  
 NICKEL PLATED  
 PBT UL 94V-0 RATED  
 PHOSPHOR BRONZE OR BRASS,  
 GOLD FLASH

**SPECIFICATION:**  
 CURRENT RATING: 1 AMP  
 INSULATION RESISTANCE: 1,000 MegOhms min. AT 500VDC  
 WITHSTANDING VOLTAGE: 1,000VAC FOR 1 MINUTE  
 CONTACT RESISTANCE: 30 milliOhms max.  
 OPERATING TEMPERATURE: -55° C TO 105° C  
 INSERTION FORCE: 25 Lb. max.  
 WITHDRAWAL FORCE: 2 Lb. min.

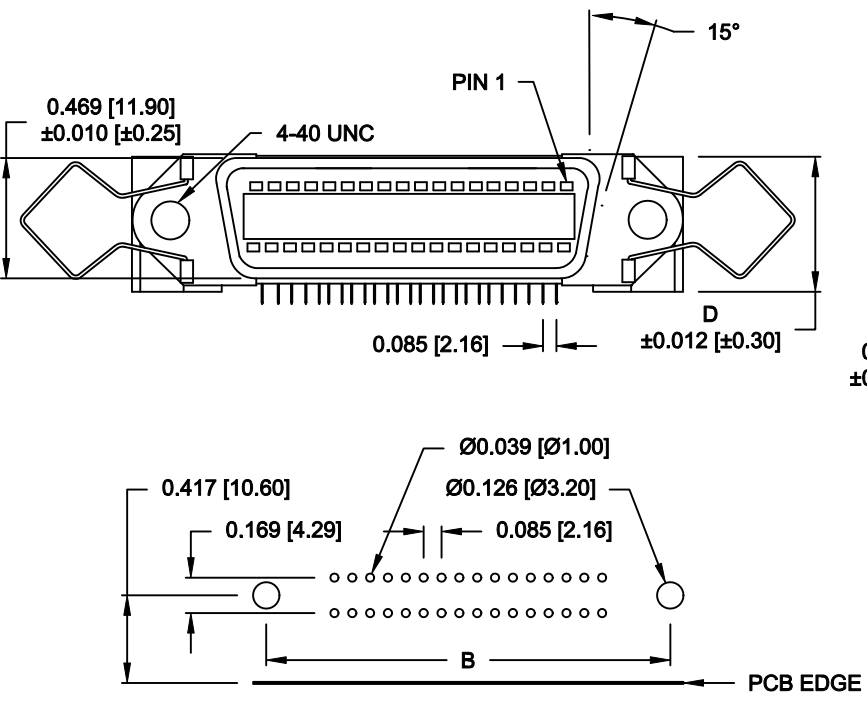

RECOMMENDED PCB LAYOUT

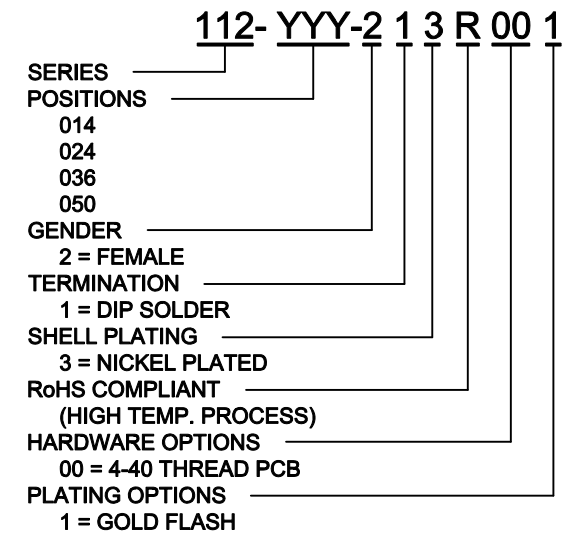
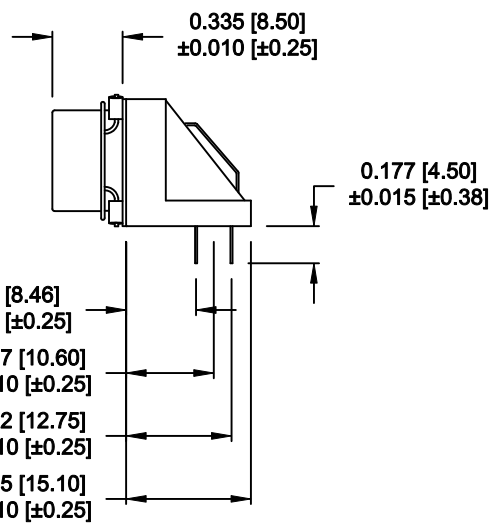

DO NOT SCALE FROM DRAWING

RoHS COMPLIANT

	THESE DRAWINGS AND SPECIFICATIONS ARE THE PROPERTY OF NorComp AND SHALL NOT BE REPRODUCED, COPIED OR USED AS THE BASIS FOR THE MANUFACTURE OR SALE OF APPARATUS WITHOUT WRITTEN PERMISSION.	DRAWN: WAYNE ROBBINS DATE: 9-15-05
	CHECKED:	DATE:
SCALE: 1:1		SHEET 1 OF 2
DWG NO. 112-YYY-213R001		REV 5

NorComp

**DESCRIPTION: 0.085 RIBBON - BOARD CUTOUT**

	<b>014</b>	<b>024</b>	<b>036</b>	<b>050</b>
<b>C</b>	<b>1.417</b>	<b>1.843</b>	<b>2.352</b>	<b>2.947</b>
	<b>36.00</b>	<b>46.80</b>	<b>59.74</b>	<b>74.85</b>

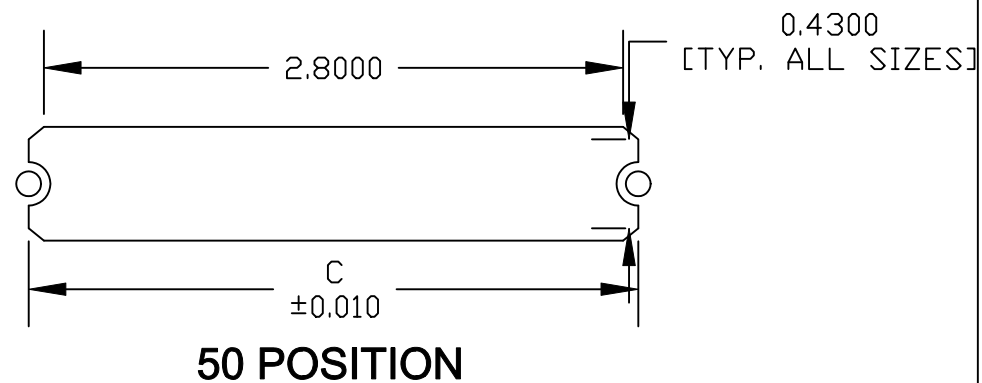
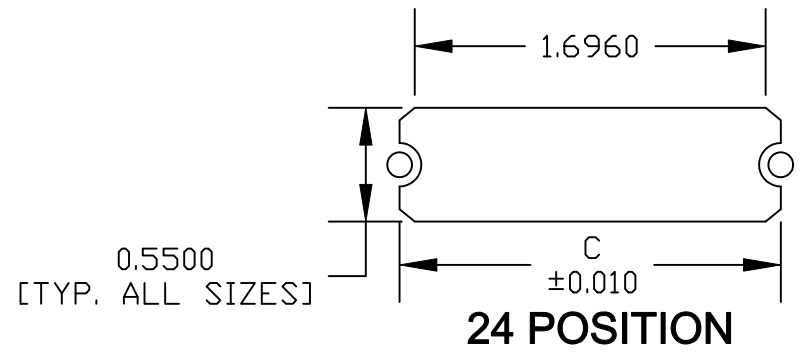
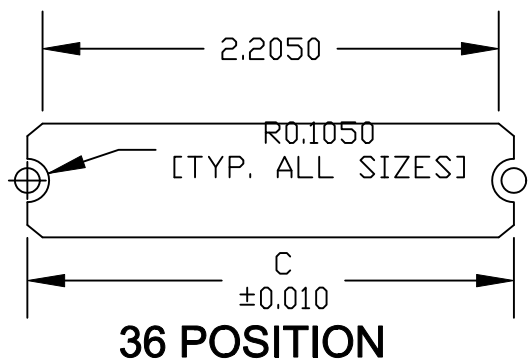
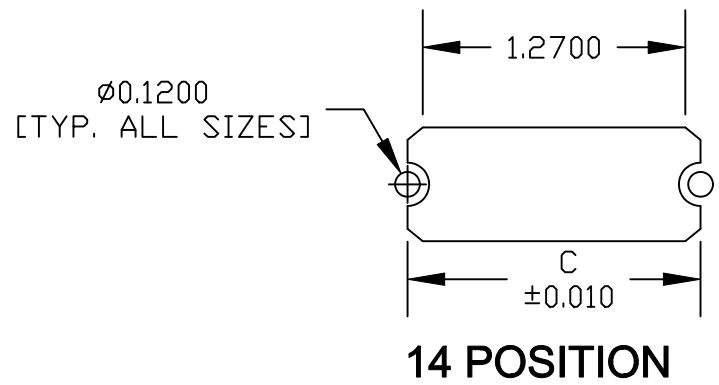

**\*\*\*NOTE\*\*\* DIMENSION "C" =  
 CENTER TO CENTER OF MOUNTING HOLES  
 CENTER OF RADI  
 OVERALL LENGTH OF CUTOUT**

**DO NOT SCALE FROM DRAWING**

**RoHS COMPLIANT**

	THESE DRAWINGS AND SPECIFICATIONS ARE THE PROPERTY OF NorComp AND SHALL NOT BE REPRODUCED, COPIED OR USED AS THE BASIS FOR THE MANUFACTURE OF SALE OF APPARATUS WITHOUT WRITTEN PERMISSION.		DRAWN: <b>M. SIGMON</b>	DATE: <b>01-14-11</b>
				CHECKED:
<b>NorComp</b>		SCALE: <b>NONE</b>	SHEET OF <b>2 2</b>	REV <b>5</b>
		DWG NO. <b>112-YYY-213R001</b>		