

## GENERAL SPECIFICATIONS FOR PUSH-PULL PUSHBUTTONS

### Electrical Capacity (Resistive & Inductive Load)

**Power Level:** Shown in the following tables



### Other Ratings

**Contact Resistance:** 10 milliohms maximum  
**Insulation Resistance:** 200 megohms minimum @ 500V DC  
**Dielectric Strength:** 1,500V AC min. for 1 minute min.  
**Mechanical Life:** 30,000 operations minimum  
**Electrical Life:** 10,000 operations minimum  
**Total Travel:** .177" (4.5mm) for SB862;  
 .059" (1.5mm) for SB282  
**Operating Temp Range:** -10°C through +70°C  
 (+14°F through +158°F)

### Materials & Finishes

**Plunger:** Brass with nickel plating  
**Bushing:** Brass with nickel plating  
**Case:** Phenolic resin  
**Case Cover:** Steel with zinc plating  
**Movable Contactor:** Brass with silver plating - SB862;  
 copper with silver plating - SB282  
**Movable & Stationary Contacts:** Silver - SB862;  
 copper with silver plating - SB282  
**Terminals:** Brass with silver plating - SB862;  
 copper with silver plating - SB282

## SINGLE POLE PUSH-PULL WITH SOLDER LUG

Model	Approvals	Pole & Throw	Pushbutton Position/Connected Terminals ( ) = Momentary		Electrical Capacity (Resistive)	
			Normal  Keyway	Down 	AC 125V	AC 250V
SB862	— —	SPST	ON 1-2	OFF —	10A	5A

**Throw & Schematic:**



**Note:** Terminal numbers are not on the switch.



- Standard Hardware: AT504M Knurled Nut, AT508 Lockwasher, AT527M Hex Backup Nut. See Accessories & Hardware section for details.
- Solder lug terminal hole accommodates one 12-gauge solid or stranded wire.

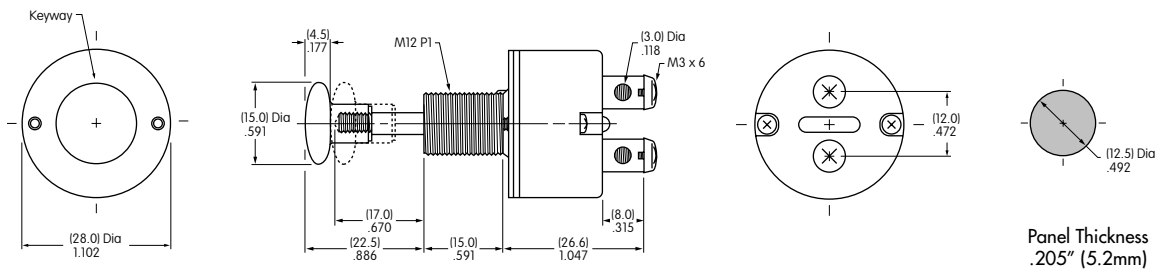

**SB862**  
 Supplied with  
 Black Knob AT424A



## DOUBLE POLE PUSH-PULL WITH SOLDER LUG

Model	Approvals	Pole & Throw	Pushbutton Position/Connected Terminals ( ) = Momentary		Electrical Capacity (Resistive)	
			Normal  Keyway	Down 	AC 125V	AC 250V
SB282	— —	DPDT	ON 2-1 5-4	ON 2-3 5-6	6A	3A

**Throw & Schematic:**



**Note:** Terminal numbers are actually on the switch.

- Standard Hardware: AT504M Knurled Nut, AT508 Lockwasher, AT527M Hex Backup Nut. See Accessories & Hardware section for details.
- Solder lug terminal hole accommodates one 12-gauge solid or stranded wire.



**SB282**  
 Supplied with  
 Black Knob AT423A;  
 Red Knob AT423C  
 Available on Request

