

SIGN	DATE	DESCRIPTION	APPROVER
		<i>THIS IS CAD DRAWING, DO NOT REVISE MANUALLY!!!</i>	

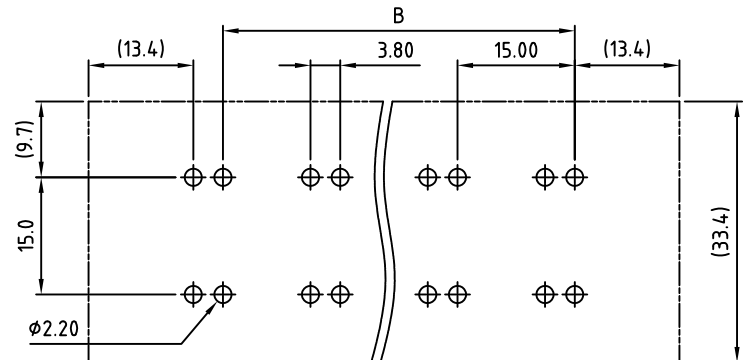
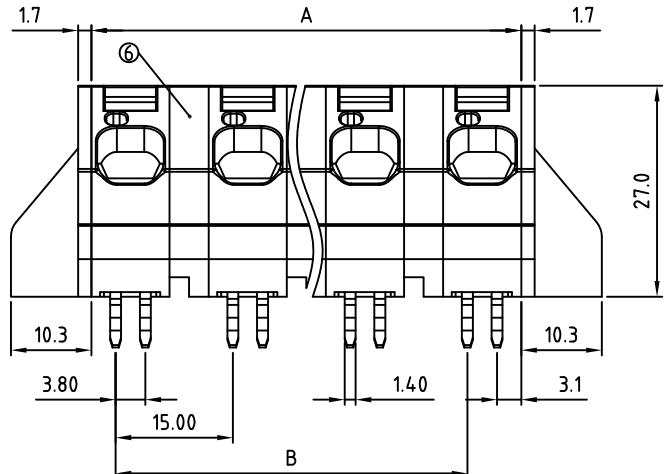
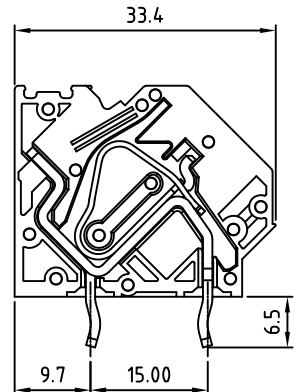

PCB Layout

- Material:
- Insulator(housing): Thermoplastic (UL94V-0)
  - Wire guard: Stainless steel
  - Terminal Body(contact pin): Copper. Tin platd
  - With flange left cover: Thermoplastic (UL94V-0)
  - With flange right cover: Thermoplastic (UL94V-0)
  - Pad board: Thermoplastic ( UL94V-0 )

- Electrical:
- |                          |                  |       |
|--------------------------|------------------|-------|
|                          | cULus            | VDE   |
| ● Voltage rating:        | 600V             | 1000V |
| ● Current rating:        | 37A              | 76A   |
| ● Wire range:            | 0.2-16 mm²       |       |
| Solid wire(AWG):         | 6-24             |       |
| Stranded wire(AWG):      | 6-24             |       |
| ● Wire strip length:     | 12-13mm          |       |
| ● Withstanding Voltage:  | 2.2KV            | 3.5KV |
| ● Operating temperature: | -40°C to +115°C  |       |
| ● Soldering temperature: | 250°C±10°C/5 Sec |       |
| ● Safety Approval:       |                  |       |

RoHS Compliant

PART NUMBER:

**OSTH8XX1081**

- |              |                    |
|--------------|--------------------|
| No. of Poles | COLOR              |
| 02 2 Poles   | 0: Black           |
| 03 3 Poles   | 5: Green           |
| ... ..       | 6: Blue            |
| 08 8 Poles   | 8: Grey (Standard) |

THESE DRAWINGS AND SPECIFICATIONS ARE THE PROPERTY OF ON-SHORE TECHNOLOGY, INC. AND SHALL NOT BE REPRODUCED, COPIED OR USED IN ANY MANNER WITHOUT THE PRIOR WRITTEN CONSENT OF ON-SHORE TECHNOLOGY, INC.

POLE	2	3	4	5	6	7	8	
A	25.00	40.00	55.00	70.00	85.00	100.00	115.00	
B	15.00	30.00	45.00	60.00	75.00	90.00	105.00	
Tol.	±0.15			±0.25				
POLE	9	10	11	12	13	14	15	16
A	130.00	145.00	160.00	175.00	190.00	205.00	220.00	235.00
B	120.00	135.00	150.00	165.00	180.00	195.00	210.00	225.00
Tol.	±0.35				±0.50			

**ON-SHORE TECHNOLOGY, INC.**

TITLE		OSTH8 15.0mm with flange Series						
PART NO.	OSTH8XX1081			DWG NO.	OSTH8XX1081.DWG			
APPROVED	CHECKED	DESIGNED	DRAWN	CUST NO.				
		Aaron 2010.06.08	Aaron 2007.09.14					
					UNIT:	mm		
					SCALE:	NONE		
				SHEET:	01/01		REV:	A
						Tolerance		
						X.	±0.50	
						X.X	±0.30	
						X.XX	±0.10	
						X*	±1*	