

SIGN	DATE	DESCRIPTION	APPROVER

THIS IS CAD DRAWING, DO NOT REVISE MANUALLY!!!

Material

- Solid PIN: Brass(CuZn)
- Surface of solder tail: Tin or Au plated.
- Insulator (housing): Thermoplastic (UL94V-0)

Electrical cULus

- Voltage rating: 300V
- Current rating: 10A
- Withstanding Voltage: 1.6KV
- Operating temperature: -30°C to +105°C
- Soldering temperature: 250°C±10°C/5 Sec
- Safety Approval: cULus

RoHS Compliant

PART NUMBER:

OSTOPXX4200

- No. of Poles
- 02: 2 Poles
 - 03: 3 Poles
 -
 - 24: 24 Poles

THESE DRAWINGS AND SPECIFICATIONS ARE THE PROPERTY OF ON-SHORE TECHNOLOGY, INC. AND SHALL NOT BE REPRODUCED, COPIED OR USED IN ANY MANNER WITHOUT THE PRIOR WRITTEN CONSENT OF ON-SHORE TECHNOLOGY, INC.

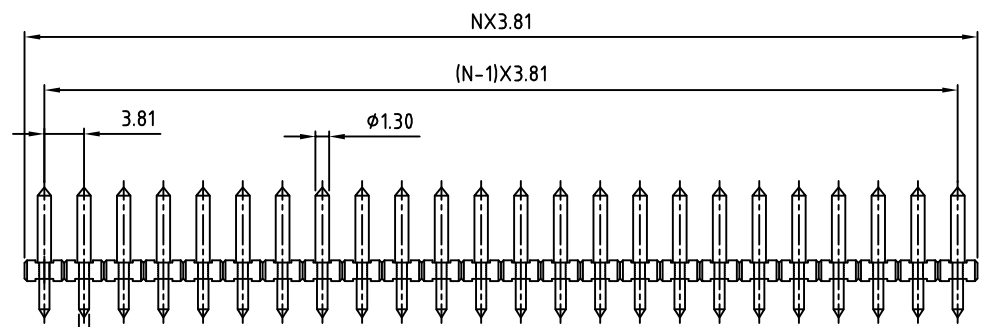

N = Number of contact

P.C.B. LAYOUT

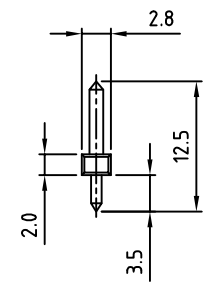
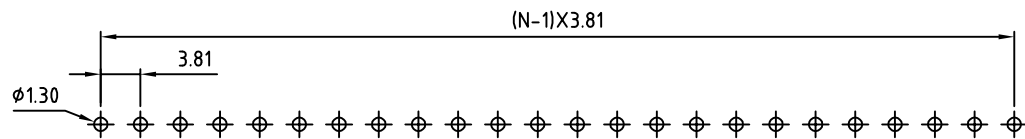

TITLE		OSTOP-3.81mm series 2p-24p				
PART NO.	OSTOPXX4200	DWG NO.	OSTOPXX4200.DWG			
APPROVED	CHECKED	DESIGNED	DRAWN	CUST NO.	Tolerance	
Shi Jun 2006.10.30	Marvin 2006.10.30	Marvin 2006.10.30	Marvin 2006.10.30		X. ±0.50	
					UNIT: mm	X.X ±0.30
				SHEET: 01/01	SCALE: NONE	X.XX ±0.10
					REV.: D	X° ±1°