

5	6	7
SIGN	DATE	DESCRIPTION
THIS IS CAD DRAWING, DO NOT REVISE MANUALLY!!!		
		APPROVER

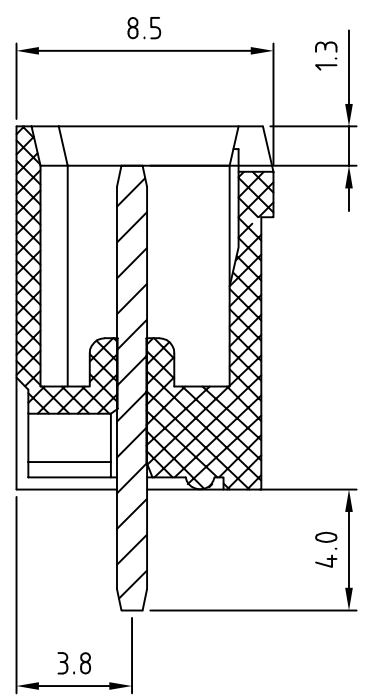
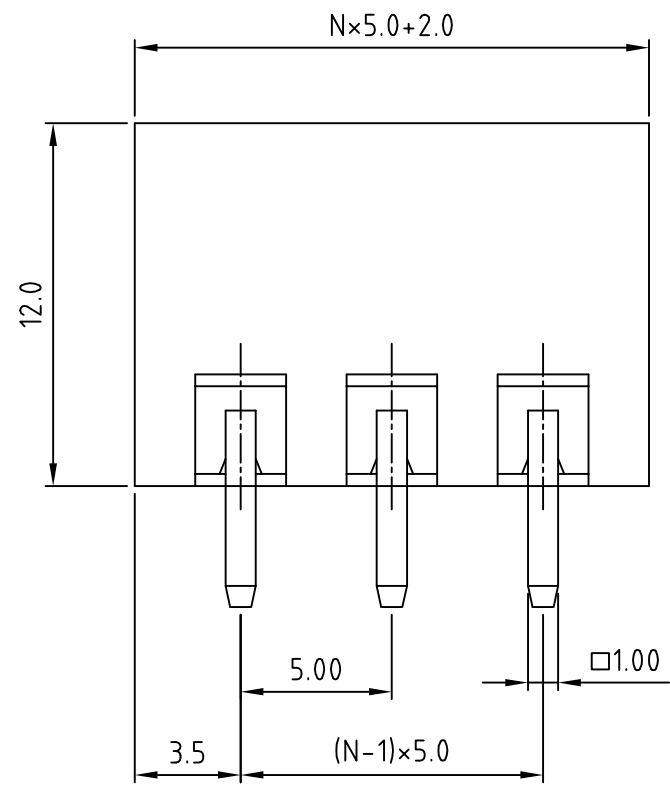
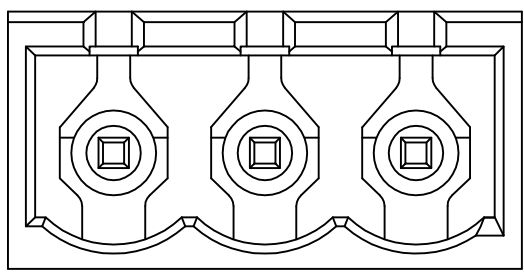

Material

- Terminal body
(contact pin): Brass(CuZn) Tin plated
- Insulator (housing): Thermoplastic (UL94V-0)

Electrical cULus/VDE/TUV

- Voltage rating: 300VAC/300VAC/300VAC
- Current rating: 20A/20A/20A
- Withstanding Voltage: 1.6KV/2.5KV/2.5KV
- Operating temperature: -30°C to +105°C
- Soldering temperature: 250°C±10°C/5 Sec
- Safety Approval:

RoHS Compliant

PART NUMBER:

OSTOQXX7150

- | | |
|--------------|---------------------|
| No. of Poles | COLOR |
| 02: 2 Poles | 0: Black |
| : | 5: Green (Standard) |
| : | 6: Blue |
| 24: 24 Poles | 8: Grey |

N = Number of contacts

P.C.B LAYOUT

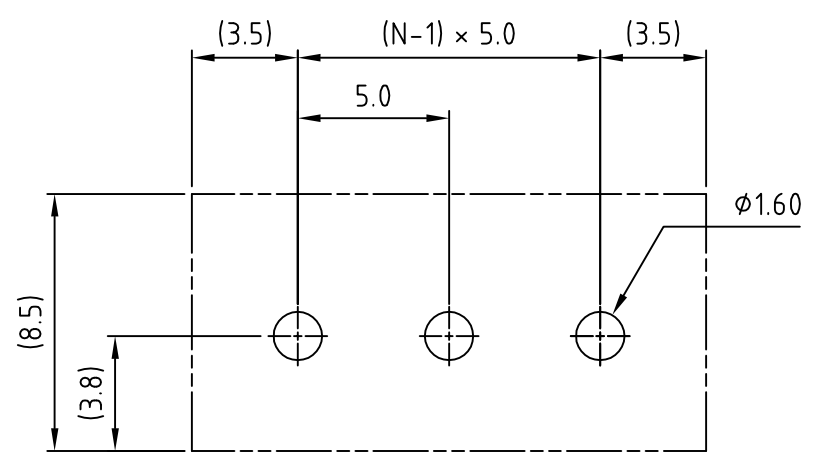

THESE DRAWINGS AND SPECIFICATIONS ARE THE PROPERTY OF ON-SHORE TECHNOLOGY, INC. AND SHALL NOT BE REPRODUCED, COPIED OR USED IN ANY MANNER WITHOUT THE PRIOR WRITTEN CONSENT OF ON-SHORE TECHNOLOGY, INC.



TITLE		OSTOQ 5.0mm series Closed vertical 2p-24p				
PART NO.		OSTOQXX7150		DWG NO.		OSTOQXX7150.DWG
APPROVED	CHECKED	DESIGNED	DRAWN	CUST NO.		Tolerance
Shi Jun 2006.10.31	Marvin 2006.10.31	Marvin 2006.10.31	Marvin 2006.10.31			X. ±0.50
						UNIT: mm
				SHEET: 01/01		X.XX ±0.10
				REV.: G		X° ±1°