

|      |      |   |          |
|------|------|---|----------|
| SIGN | DATE | DESCRIPTION   | APPROVER |
|      |      | <i>THIS IS CAD DRAWING, DO NOT REVISE MANUALLY!!!</i> |          |

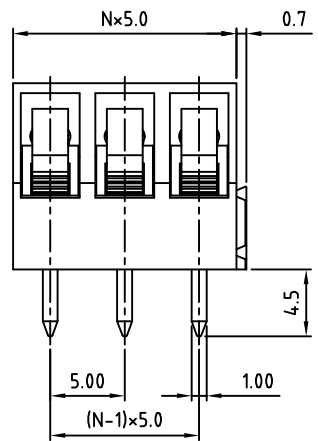

N= Number of poles

P.C.B LAYOUT

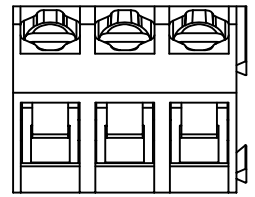
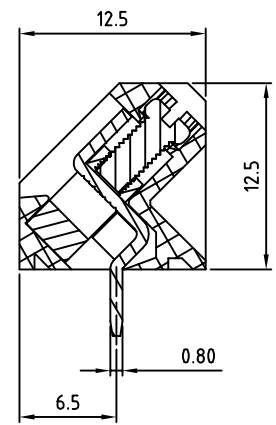
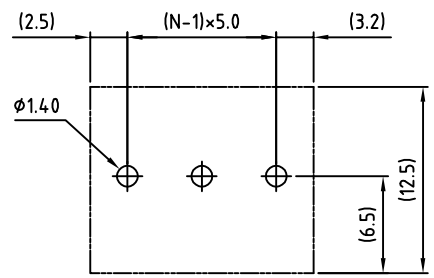

**Material**

- Terminal body
- (metal housing): Brass(CuZn)
- Terminal screw: Steel Zinc plating "-" slot type
- Contacts: Brass
- Insulator (housing): Thermoplastic (UL94V-0)

**Electrical**

- Voltage rating: 300VAC
- Current rating: 15A
- Wire range:
  - Solid wire(AWG): 12-24
  - Stranded wire(AWG): 12-24
- Torque(Lb-In): 3.5
- Screw: M2.5
- Wire strip length: 6-7mm
- Withstanding Voltage: 1.6KV
- Operating temperature: -30°C to +105°C
- Soldering temperature: 250°C±10°C/5 Sec
- Safety Approval:
- RoHS Compliant

PART NUMBER:

OSTTGXX0160B

- |              |                    |
|--------------|--------------------|
| No. of Poles | COLOR              |
| 02: 02 Poles | 0: Black           |
| 03: 03 Poles | 5: Green           |
| ...          | 6: Blue (Standard) |
| 24: 24 Poles | 8: Grey            |



THESE DRAWINGS AND SPECIFICATIONS ARE THE PROPERTY OF ON-SHORE TECHNOLOGY, INC. AND SHALL NOT BE REPRODUCED, COPIED OR USED IN ANY MANNER WITHOUT THE PRIOR WRITTEN CONSENT OF ON-SHORE TECHNOLOGY, INC.

|                       |                       |                                   |                       |              |   |
|-----------------------|-----------------------|-----------------------------------|-----------------------|--------------|---|
| TITLE                 |                       | OSTTG 5.0mm Series Long Interlock |                       |              |   |
| PART NO.              |                       | OSTTGXX0160B                      |                       | DWG NO.      | OSTTGXX0160B.DWG                              |
| APPROVED              | CHECKED               | DESIGNED                          | DRAWN                 | CUST NO.     | Tolerance                                     |
| Shi Jun<br>2006.10.20 | Shi Jun<br>2006.10.20 | Shi Jun<br>2006.10.20             | Shi Jun<br>2006.10.20 |              | X. ±0.50<br>X.X ±0.30<br>X.XX ±0.10<br>X* ±1* |
|                       |                       |                                   |                       | SHEET: 01/01 | REV.: D                                       |