

| SIGN   | DATE | DESCRIPTION | APPROVER |
|--|------|-------------|----------|
|  |      |             |          |
| THIS IS CAD DRAWING, DO NOT REVISE MANUALLY!!! |      |             |          |

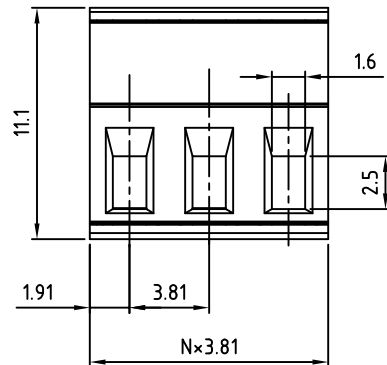

N=Number of poles

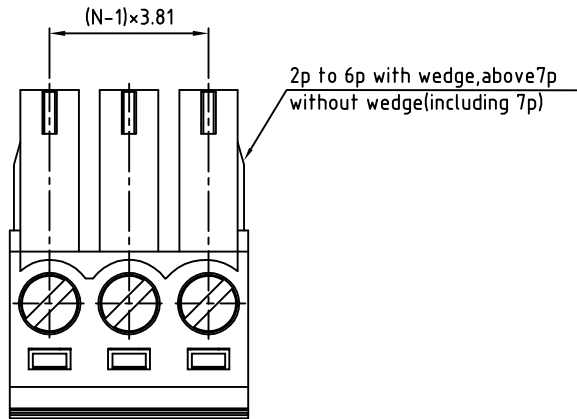
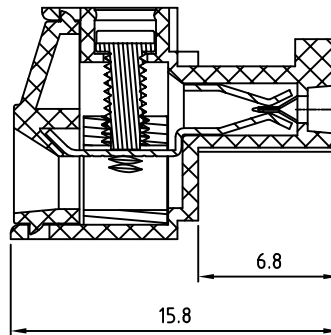

**Material**

- Terminal body (metal housing): Brass(CuZn)
- Terminal screw: Steel Zinc plating "-" slot type
- Wire guard: PhBz ,Tin plated
- Insulator (housing): Thermoplastic (UL94V-0)

**Electrical** cULus/ CSA/ VDE

- Voltage rating: 300VAC/125VAC/300VAC
- Current rating: 10A/8A/10.5A
- Wire range: Solid wire(AWG): 16-26/16-26/1.5mm<sup>2</sup>  
Stranded wire(AWG): 16-26/16-26/1.5mm<sup>2</sup>
- Torque: 2.5Lb-In/3.5kgf.cm/0.2N.m
- Screw: M2
- Wire strip length: 6-7mm
- Withstanding Voltage: 1.6KV/1.6KV/2.5KV
- Operating temperature: -30° C to +105° C
- Safety Approval:

RoHS Compliant

PART NUMBER:

OSTTJXX31530

No. of Poles  
02 2 Poles  
03 3 Poles  
... ..  
24 24 Poles

COLOR  
0: Black  
5: Green (Standard)  
6: Blue  
8: Grey



THESE DRAWINGS AND SPECIFICATIONS ARE THE PROPERTY OF ON-SHORE TECHNOLOGY, INC. AND SHALL NOT BE REPRODUCED, COPIED OR USED IN ANY MANNER WITHOUT THE PRIOR WRITTEN CONSENT OF ON-SHORE TECHNOLOGY, INC.

|                       |                      |                            |                      |              |                  |            |
|-----------------------|----------------------|----------------------------|----------------------|--------------|------------------|------------|
| TITLE                 |                      | OSTTJ-3.81mm Series 2p-24p |                      |              |                  |            |
| PART NO.              | OSTTJXX31530         |                            |                      | DWG NO.      | OSTTJXX31530.DWG |            |
| APPROVED              | CHECKED              | DESIGNED                   | DRAWN                | CUST NO.     |                  |            |
| Shi Jun<br>2006.10.23 | Marvin<br>2006.10.23 | Marvin<br>2006.10.23       | Marvin<br>2006.10.23 |              | UNIT: mm         | Tolerance  |
|                       |                      |                            |                      | SHEET: 01/01 | SCALE: NONE      | X. ±0.50   |
|                       |                      |                            |                      |              | REV.: F          | X.X ±0.30  |
|                       |                      |                            |                      |              |                  | X.XX ±0.10 |
|                       |                      |                            |                      |              |                  | X° ±1°     |