

SIGN	DATE	DESCRIPTION	APPROVER
------	------	-------------	----------

THIS IS CAD DRAWING, DO NOT REVISE MANUALLY!!!

SPECIFICATIONS

VOLTAGE & CURRENT:	300 V, 25 A
WITHSTANDING VOLTAGE:	AC 2000 V/Min
INSULATION RESISTANCE:	1000 MΩ OR MORE AT DC 500 V
TEMPERATURE RANGE:	-40 °C ~ +105 °C
SCREW TORQUE VALUE:	8.8 Lb-In.
WIRE RANGE:	22 - 12 AWG
1) MOLDED PARTS:	POLYIMIDE 66, UL 94 V-0 BLACK
2) TERMINAL:	BRASS, 0.8t, Tin PLATED
3) TERMINAL SCREWS:	STEEL, Ni PLATED, M3.5
APPROVAL:	(Signature) PENDING

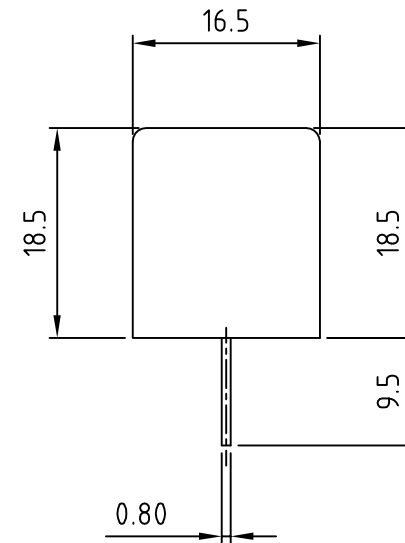
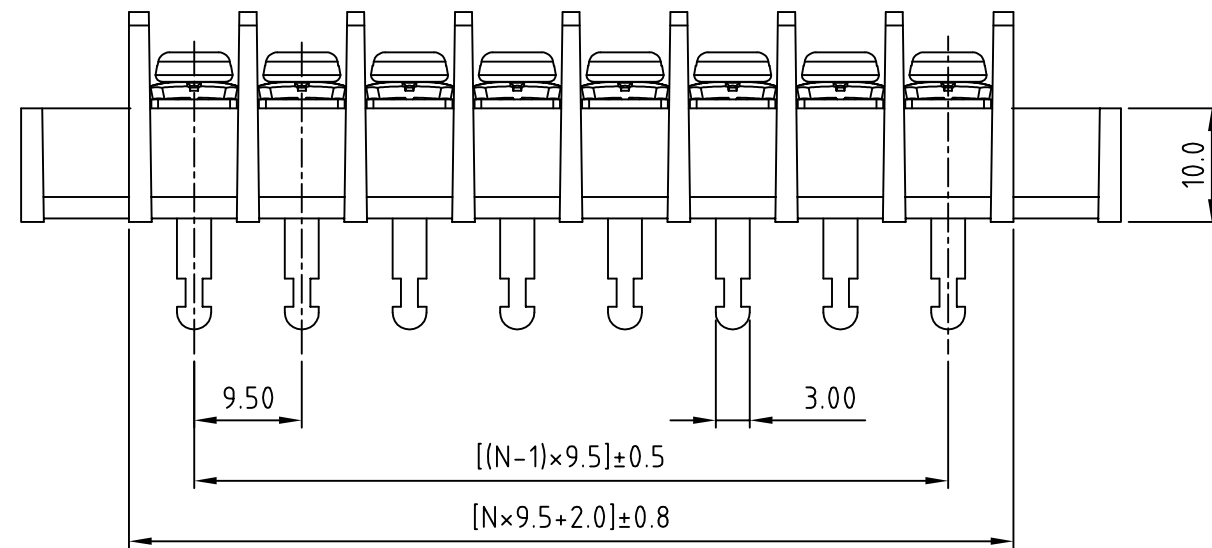
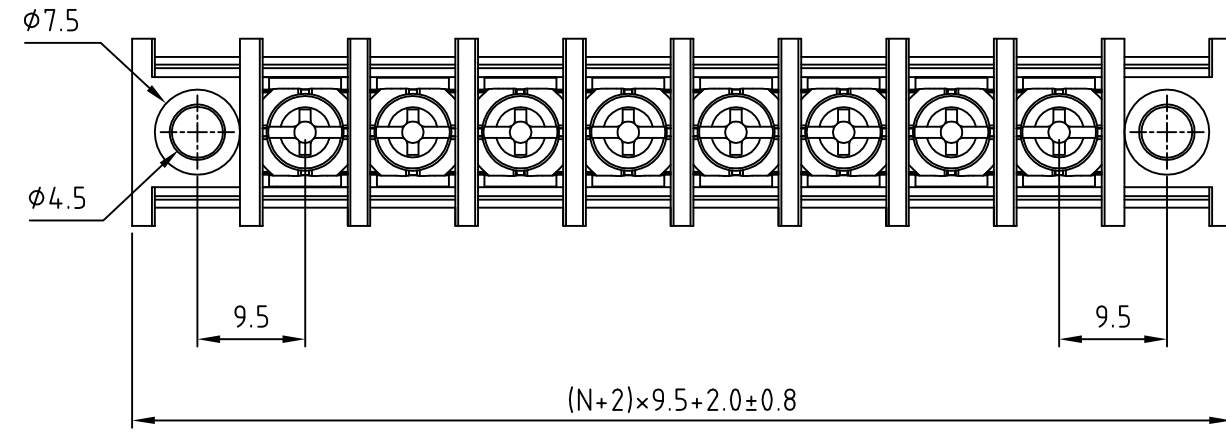

PART NUMBER:

OSTYK516XX330

No. of Poles _____

- 02: 2 Poles
- 03: 3 Poles
- 04: 4 Poles
- ⋮
- 30: 30 Poles

N=Number of poles

THESE DRAWINGS AND SPECIFICATIONS ARE THE PROPERTY OF ON-SHORE TECHNOLOGY, INC. AND SHALL NOT BE REPRODUCED, COPIED OR USED IN ANY MANNER WITHOUT THE PRIOR WRITTEN CONSENT OF ON-SHORE TECHNOLOGY, INC.



TITLE		OSTYK-516 W/Flange Series				
PART NO.		OSTYK516XX330		DWG NO.		OSTYK516XX330.DWG
APPROVED	CHECKED	DESIGNED	DRAWN	CUST NO.		Tolerance
Shi Jun 2006.11.07	Seamus 2006.11.06	Tony 2006.04.05	Tony 2006.04.05			X. ±0.50
						UNIT: mm
				SHEET: 01/01		SCALE: NONE
				REV.: A		X.XX ±0.10
						X° ±1°