

SIGN	DATE	DESCRIPTION	APPROVER
THIS IS CAD DRAWING, DO NOT REVISE MANUALLY!!!			

**Material**

- Terminal body
- (metal housing): Brass(CuZn)
- Terminal screw: Steel Zinc plating "-" slot type
- Contacts: Brass
- Surface of solder tail: Tin plated
- Insulator (housing): Thermoplastic (UL94V-0)

**Electrical**

- Voltage rating: 300VAC
- Current rating: 10A
- Wire range:
  - Solid wire(AWG): 12-24
  - Stranded wire(AWG): 12-24
- Torque(Lb-In): 3.5
- Screw: M2.5
- Wire strip length: 6-7mm
- Withstanding Voltage: 1.6KV
- Operating temperature: -30°C to +105°C
- Soldering temperature: 250°C±10°C/5 Sec
- Safety Approval:  us

RoHS Compliant

PART NUMBER:

**OSTYMX2150**

No. of Poles	↓	COLOR
04: 2×02 Poles		0: Black
06: 2×03 Poles		5: Green (Standard)
:		6: Blue
48 2×24 Poles		8: Grey

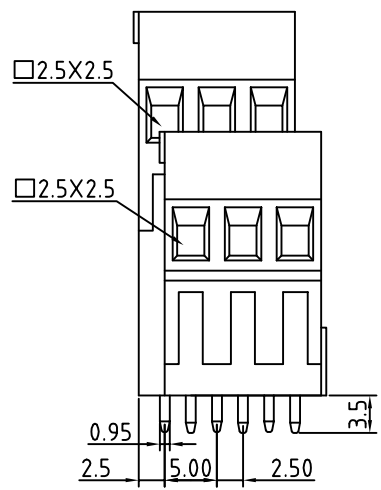
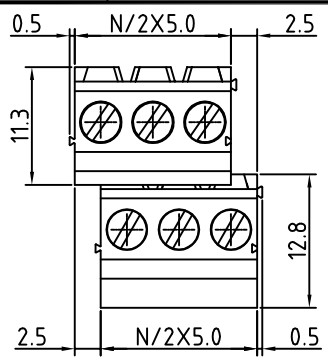

N=Number of poles

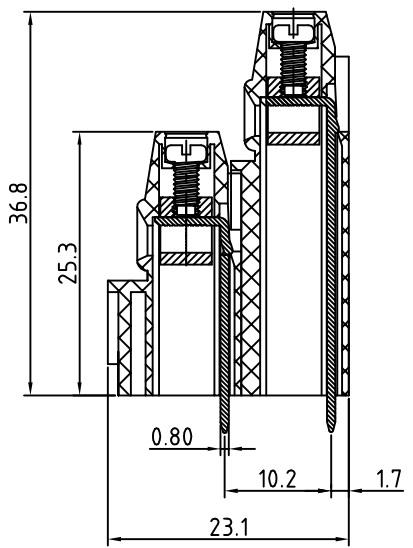

**P.C.B LAYOUT**

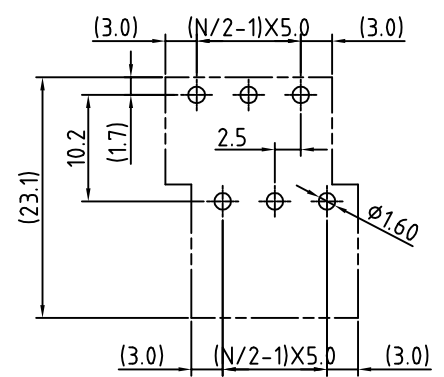

THESE DRAWINGS AND SPECIFICATIONS ARE THE PROPERTY OF ON-SHORE TECHNOLOGY, INC. AND SHALL NOT BE REPRODUCED, COPIED OR USED IN ANY MANNER WITHOUT THE PRIOR WRITTEN CONSENT OF ON-SHORE TECHNOLOGY, INC.



TITLE		OSTYM-5.0mm series right		DWG NO.		OSTYMX2150.DWG	
PART NO.	OSTYMX2150	CHECKED	DESIGNED	DRAWN	CUST NO.	Tolerance	
APPROVED	Shi Jun 2006.10.20	Shi Jun 2006.10.20	xionghaitao 2006.10.20	xionghaitao 2006.10.20		UNIT: mm	X. ±0.50
						SCALE: NONE	X.X ±0.30
						REV.: D	X.XX ±0.10
							X° ±1°

SHEET: 01/01