

# BTS

## BTS

### Brass Male-Female Threaded Standoff

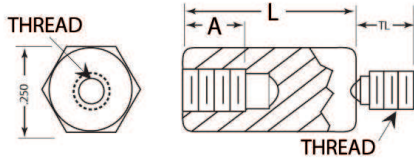
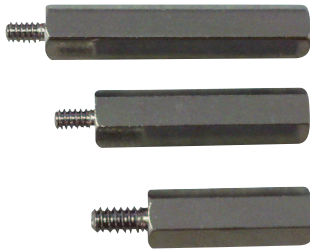

- Provides an electrical connection between the PCB and the chassis
- Sturdy and robust

Material: Brass with Nickel Plating					
Part No	Thread	"L" Standoff Height	"TL"	"A"	Standard Pack
BTS005A	#4-40	.250 (6.4)	.187 (4.7)	.200 (5.1)	500
BTS010A		.375 (9.5)			
BTS015A		.500 (12.7)			
BTS020A		.625 (15.9)		.250 (6.4)	250
BTS025A		.750 (19.1)			
BTS030A		.875 (22.2)			
BTS035A		1.000 (25.4)			
BTS040A		1.250 (31.8)			
BTS045A		1.500 (38.1)			
BTS105A	#6-32	.250 (6.4)	.250 (6.4)	.200 (5.1)	500
BTS110A		.375 (9.5)			
BTS115A		.500 (12.7)			
BTS120A		.625 (15.9)		.375 (9.5)	250
BTS125A		.750 (19.1)			
BTS130A		.875 (22.2)			
BTS135A		1.000 (25.4)			
BTS140A		1.250 (31.8)			
BTS145A		1.500 (38.1)			
BTS205A	#8-32	.250 (6.4)	.375 (9.5)	.200 (5.1)	500
BTS210A		.375 (9.5)			
BTS215A		.500 (12.7)			
BTS220A		.625 (15.9)		.375 (9.5)	250
BTS225A		.750 (19.1)			
BTS230A		.875 (22.2)			
BTS235A		1.000 (25.4)			
BTS240A		1.250 (31.8)			
BTS245A		1.500 (38.1)			