

AVAILABLE BY SPECIAL ORDER- NAFTA REGION ONLY

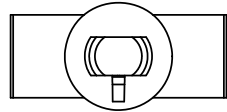

TO SNAP-LOCK IN A .156±.003  
[4±0.08] DIA. HOLE, IN A  
.093 [2.4] PANEL THICKNESS

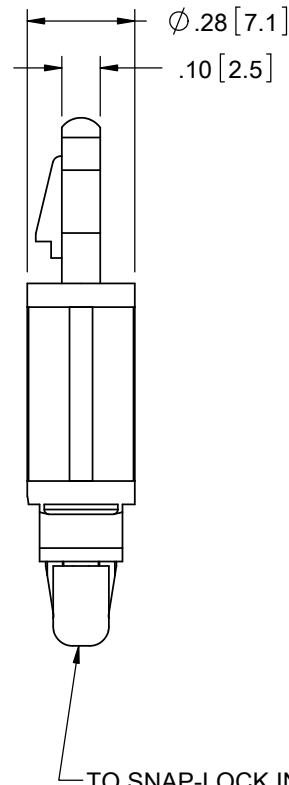
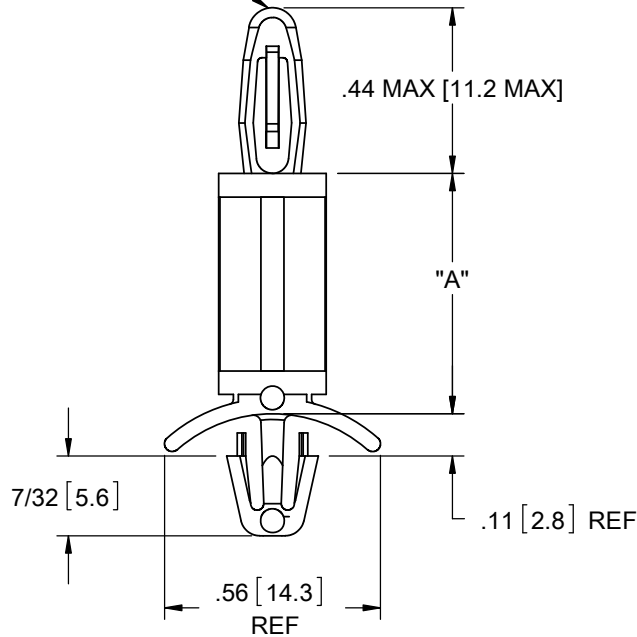

TO SNAP-LOCK IN A .187±.003  
[4.75±0.08] DIA. HOLE, IN A  
.031-.078 [0.79-1.98] PANEL THICKNESS

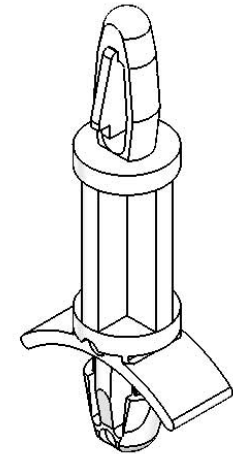

MATERIAL: NYLON 6/6 UL 94 V-2 (RMS-01) PART NO.	DIM. "A"±.015 [0.4]
LCBSA-3-3-01	3/16 [4.8]
LCBSA-3-4-01	1/4 [6.4]
LCBSA-3-5-01	5/16 [7.9]
LCBSA-3-6-01	3/8 [9.5]
LCBSA-3-7-01	7/16 [11.1]
LCBSA-3-8-01	1/2 [12.7]
LCBSA-3-10-01	5/8 [15.9]
LCBSA-3-12-01	3/4 [19.1]
LCBSA-3-14-01	7/8 [22.2]
LCBSA-3-16-01	1 [25.4]
LCBSA-3-18-01	1-1/8 [28.6]
LCBSA-3-20-01	1-1/4 [31.7]
LCBSA-3-22-01	1-3/8 [34.9]

NOTES:

1. MATERIAL: NYLON 6/6 UL 94 V-0 (RMS-19), AVAILABLE BY SPECIAL ORDER. TO ORDER REPLACE "-01" WITH "-19".
2. COLOR: NATURAL.
3. ALTERNATE UNITS FOR REFERENCE ONLY.

TITLE: <b>LOCKING CKT BD. SUPPORT, SPECIAL</b>				UNITS: IN [mm]		FINAL	
CREATED USING SOLIDWORKS	FILE #: LCBSA-3	DWN: SK	APP: RT	PART #		PRINT TYPE	
TOLERANCES UNLESS NOTED .XX=±.010 .XXX=±.005 FRAC.=±1/64 ANG.=±1°	SHEET: 1 OF 1 SHEET SIZE: A	DT: 08/24/06	CHKD: SJ				
REV.	DESCRIPTION	ENGR.	DATE	RE: RICHCO, INC.		SEE TABLE	
E	DIMENSION FROM .43 TO .44 MAX, ECN#1384	DZ	10/24/2013	RICHCO, INC.		CA	
D	CHANGED PART NUMBER, CO 200605	SK	12/02/2010	ENG@RICHCO-INC.COM			
C	REDRAWN, SEE ECN #1208 FOR CHANGES	SK	11/29/2006	(773) 539-4060			
B	SEE ECN #862 FOR CHANGES	SM	10/04/2004				
A	UPDATED PRINT AND CHANGED FILE NUMBER	SM	09/27/2001				