

MUELLER®

MODEL: BU-P5167-*

Banana Jack (In-Line)

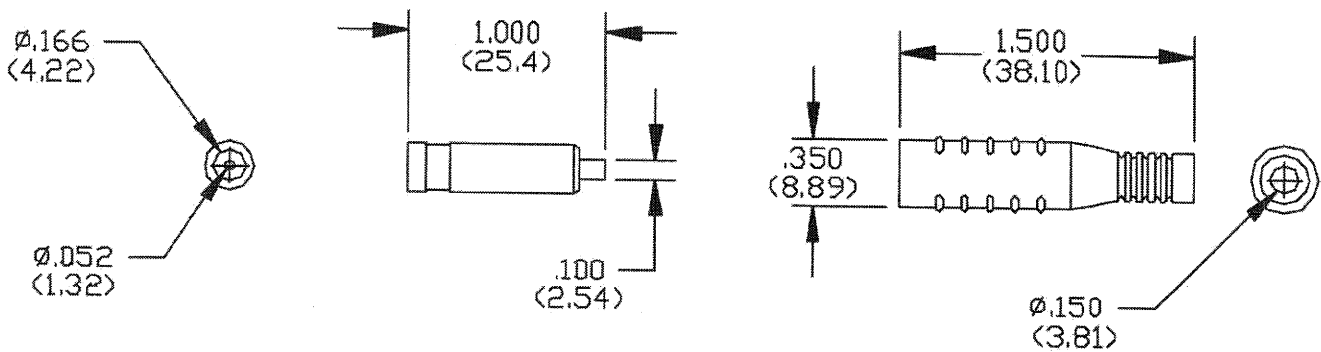

MATERIALS:

Body – Nickel Plated Brass

Insulator – Flexible PVC. Comes in -0 Black, -2 Red

For use with 18AWG, 20AWG, and 22AWG wires. Can be soldered or crimped

RATING:

15 Amps

Hands free testing to 5000 VDC max.

Temperature: -70°C to 50°C