

PART NAME: NON-METALLIC ENCLOSURE (STYLE E) PART No.: NBE-10547 AND NBE-10567

**MATERIAL:**  
 SOLID BODY & COVER \_\_\_\_\_ ABS/PC BLENDED PLASTIC  
 UL94-5VB FLAMMABILITY RATING  
  
 CLEAR COVER \_\_\_\_\_ POLYCARBONATE PLASTIC  
 UL94V-0 FLAMMABILITY RATING  
 UV STABILIZED  
  
 PANEL \_\_\_\_\_ 0.078 THICK ALUMINUM  
 LATCHES & HINGES \_\_\_\_\_ NON-METALLIC  
 WALL MOUNTING BRACKETS \_\_\_\_\_ STAINLESS STEEL

**FINISH:**  
 BODY \_\_\_\_\_ LIGHT GRAY  
 COVER \_\_\_\_\_ LIGHT GRAY OR CLEAR  
 PANEL \_\_\_\_\_ ANODIZED  
  
 COVER INCLUDES GRAY POLY-URETHANE GASKET.  
  
 UNIT COMES COMPLETE WITH (4) WALL MOUNTING BRKTS. & (4) M5 x 10mm LG. TRUSS HD. MACHINE SCREWS (NOT SHOWN)

**INDUSTRY STANDARDS:**  
 UL508 TYPE 1, 2, 4, 4X INDOOR, 12 & 13  
 NEMA TYPE 1, 2, 4, 4X, 12 & 13  
 IEC529-IP65  
  
 AIR AND MOISTURE VENTS, GALVANIZED STEEL INTERNAL PANEL AND STAINLESS STEEL LOCKING HASP ARE NOT INCLUDED, BUT CAN BE PURCHASED SEPARATELY.

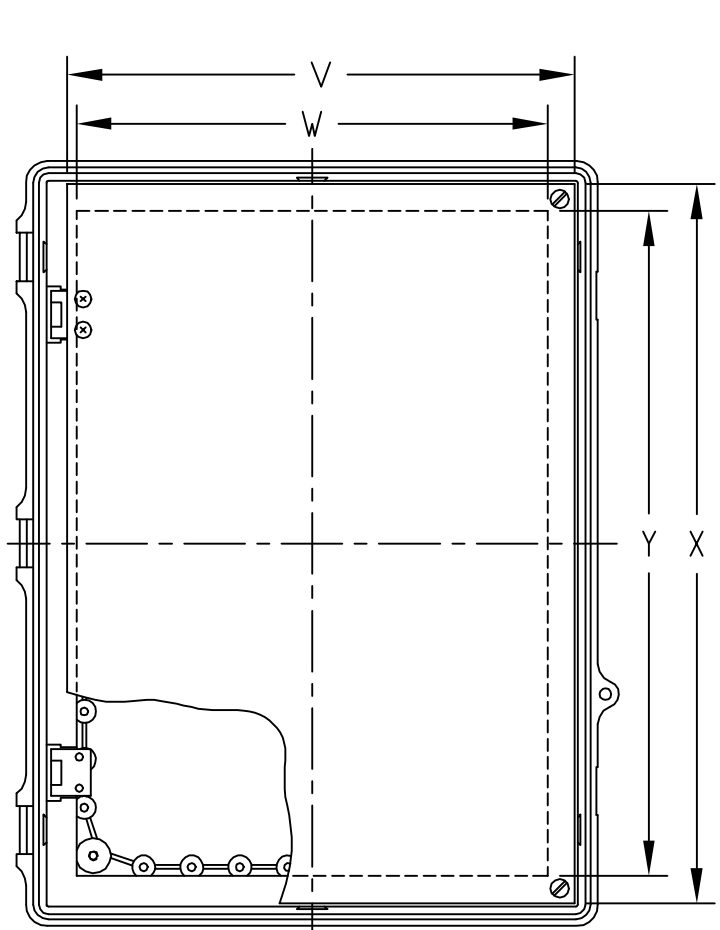
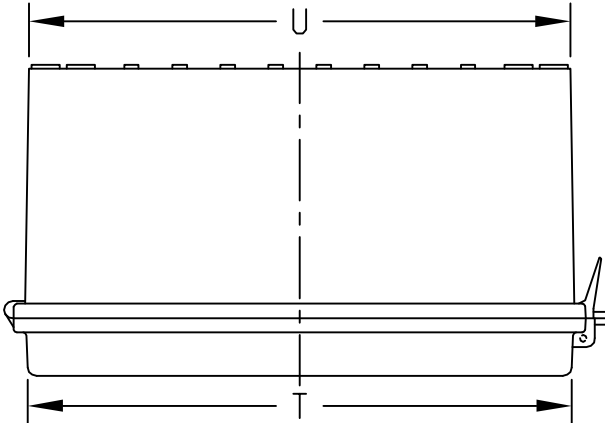

VIEW LESS COVER

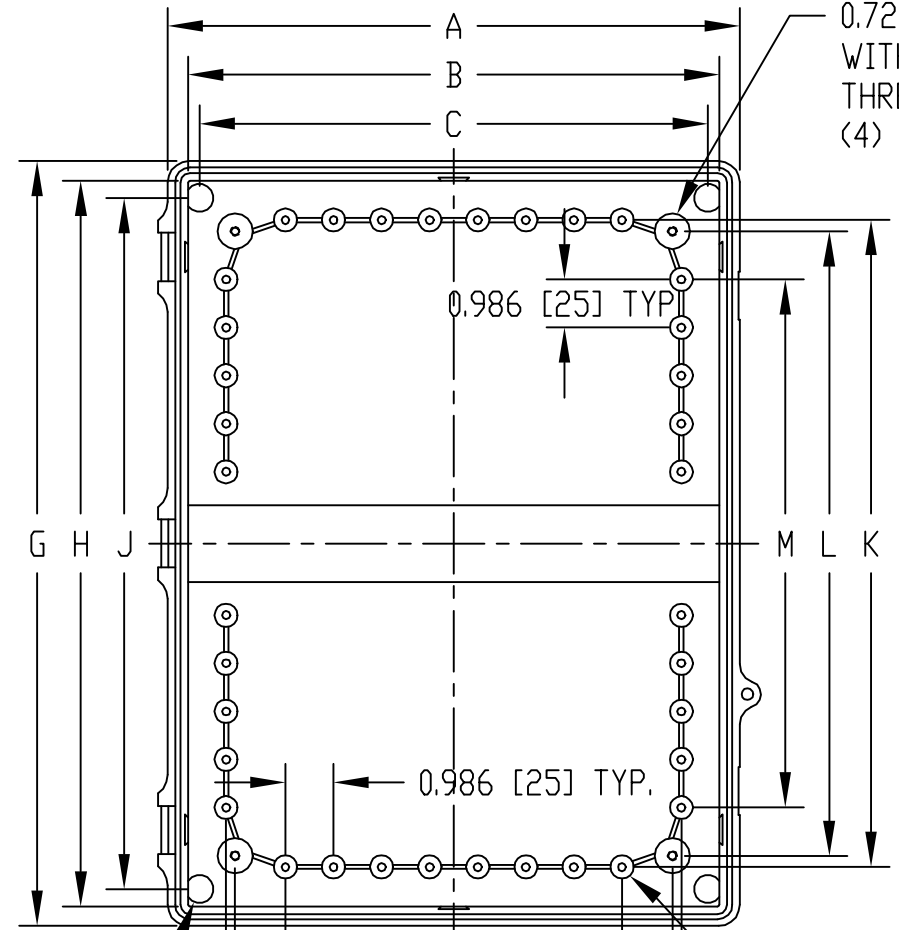

VIEW LESS COVER AND SWINGFRAME PANEL

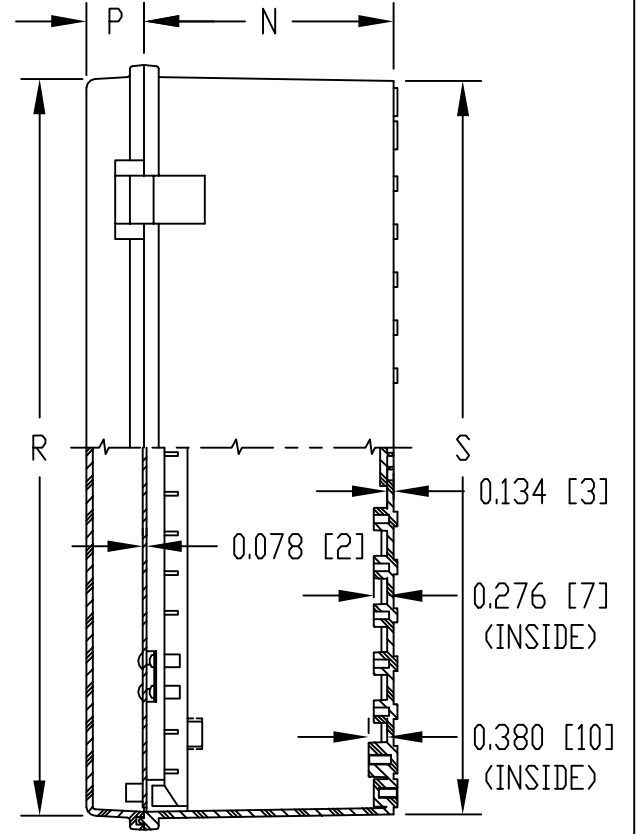
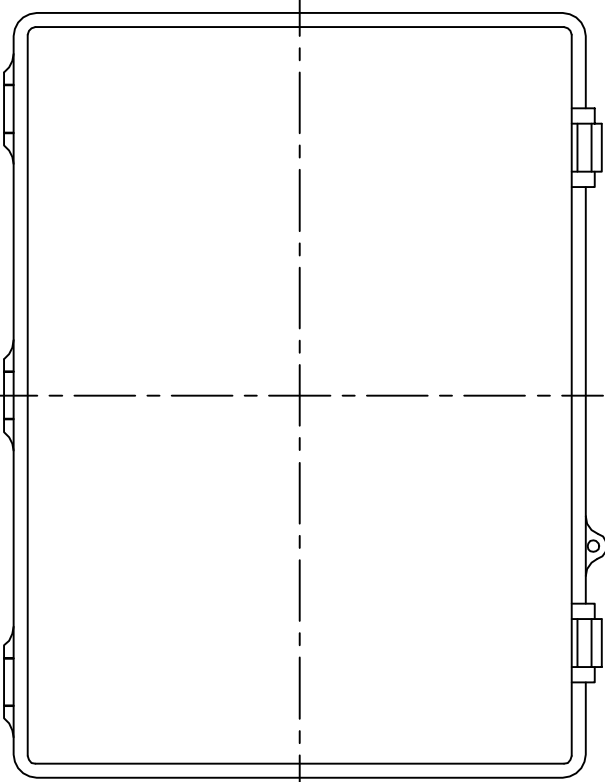

DIMENSIONS = INCHES [MILLIMETERS]

0.575 [15] DIA. BOSS WITH M5 x 0.8mm THREADED BRASS INSERT (4) PLACES (FAR SIDE)

0.725 [18] DIA. BOSS WITH M5 x 0.8mm THREADED BRASS INSERT (4) PLACES

0.476 [12] DIA. BOSS WITH 0.166 [4] DIA. HOLE x 0.325 [8] DEEP (36) PLACES BOSSSES ACCEPT M5 METRIC OR #10 STD. SHEET METAL SCREWS x 0.250 [6] LG. (NOT SUPPLIED)

NOTE: ALL DIMENSIONS HAVE ±0.039 [±1] TOLERANCE UNLESS OTHERWISE SPECIFIED

PART NO.		DIMENSIONS																					
SOLID COVER	CLEAR COVER	A	B	C	D	E	F	G	H	J	K	L	M	N	P	R	S	T	U	V	W	X	Y
NBE-10547	NBE-10567	11.727	10.894	10.424	9.335	8.969	6.902	15.680	14.877	14.167	13.265	12.801	10.828	5.110	1.185	15.105	15.035	11.147	11.090	10.400	9.659	14.740	13.635
		[298]	[277]	[265]	[237]	[228]	[175]	[398]	[378]	[360]	[337]	[325]	[275]	[130]	[30]	[384]	[382]	[283]	[282]	[264]	[245]	[374]	[346]