

THE INFORMATION CONTAINED IN THIS DRAWING IS THE SOLE PROPERTY OF BUD INDUSTRIES INC. ANY REPRODUCTION IN PART OR WHOLE WITHOUT THE WRITTEN PERMISSION OF BUD INDUSTRIES INC. IS PROHIBITED.

| SNC-3755 | |
|----------|--------------------------------|
| ISSUE | REVISIONS |
| (A) | REVISED DESIGN 6-30-08 DAB |
| (B) | PER ECN # 10404 12-4-08 DAB |
| (C) | PER ECN # 10446 1-13-09 BT |

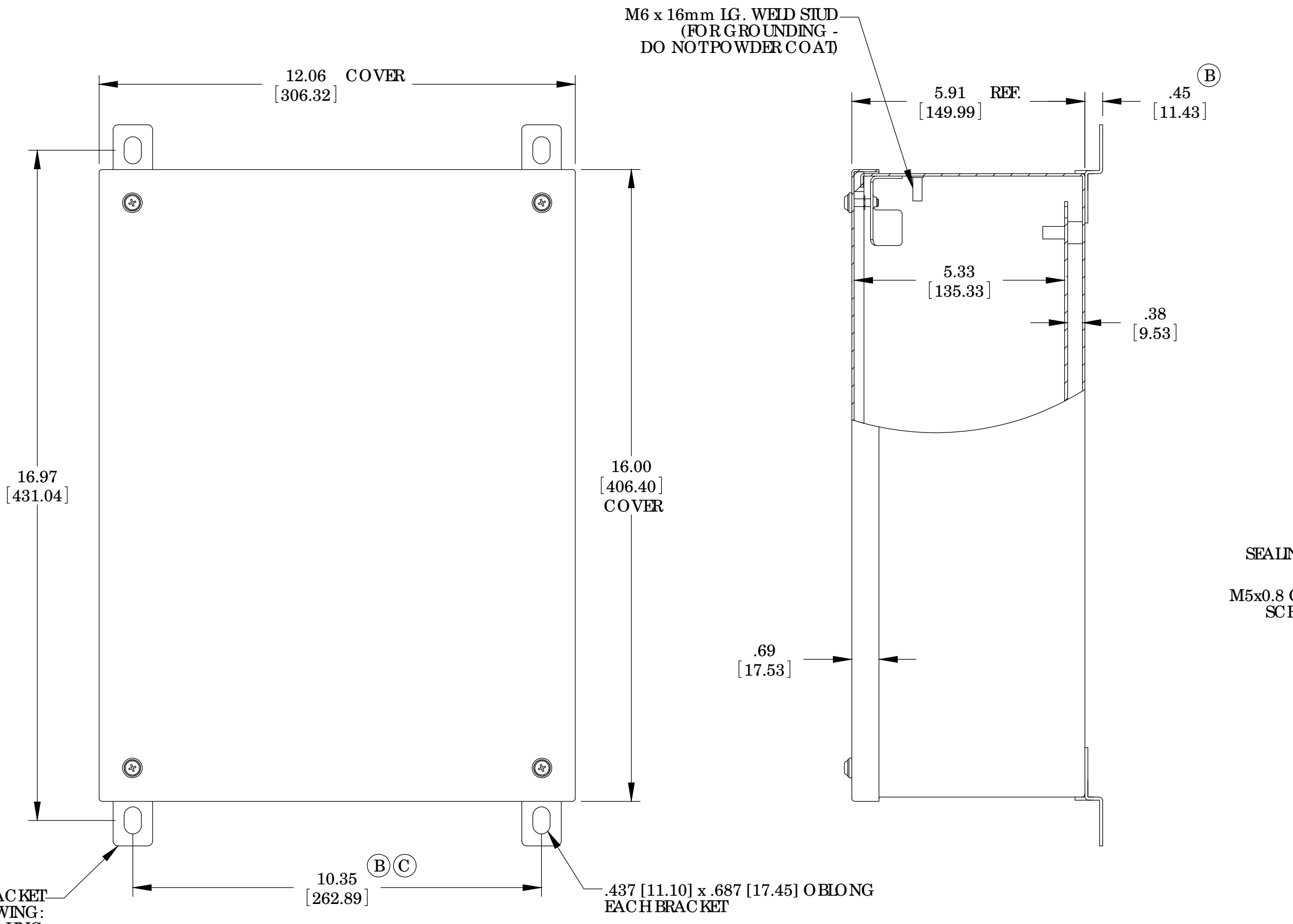

MATERIAL:
 BODY, COVER MOUNTING BRACKETS COVER - 16 GA. [1.5mm] C.R.S.
 INTERNAL PANEL - 14 GA. [2.0mm] C.R.S.
 WALL MOUNTING BRACKETS - 14 GA. [2.0mm] STAINLESS STEEL
 HARDWARE - STAINLESS STEEL
 GASKET - .25 [6.35] THICK NBR PRENE (BLACK) OR EQUIVALENT
 SEALING WASHERS - BLACK NBR PRENE OR EQUIVALENT

FINISH:
 BODY & COVER - LIGHT GRAY SMOOTH POWDER COAT
 INTERNAL PANEL - ZINC CHROMATE
 WALL MOUNTING BRACKETS - NATURAL

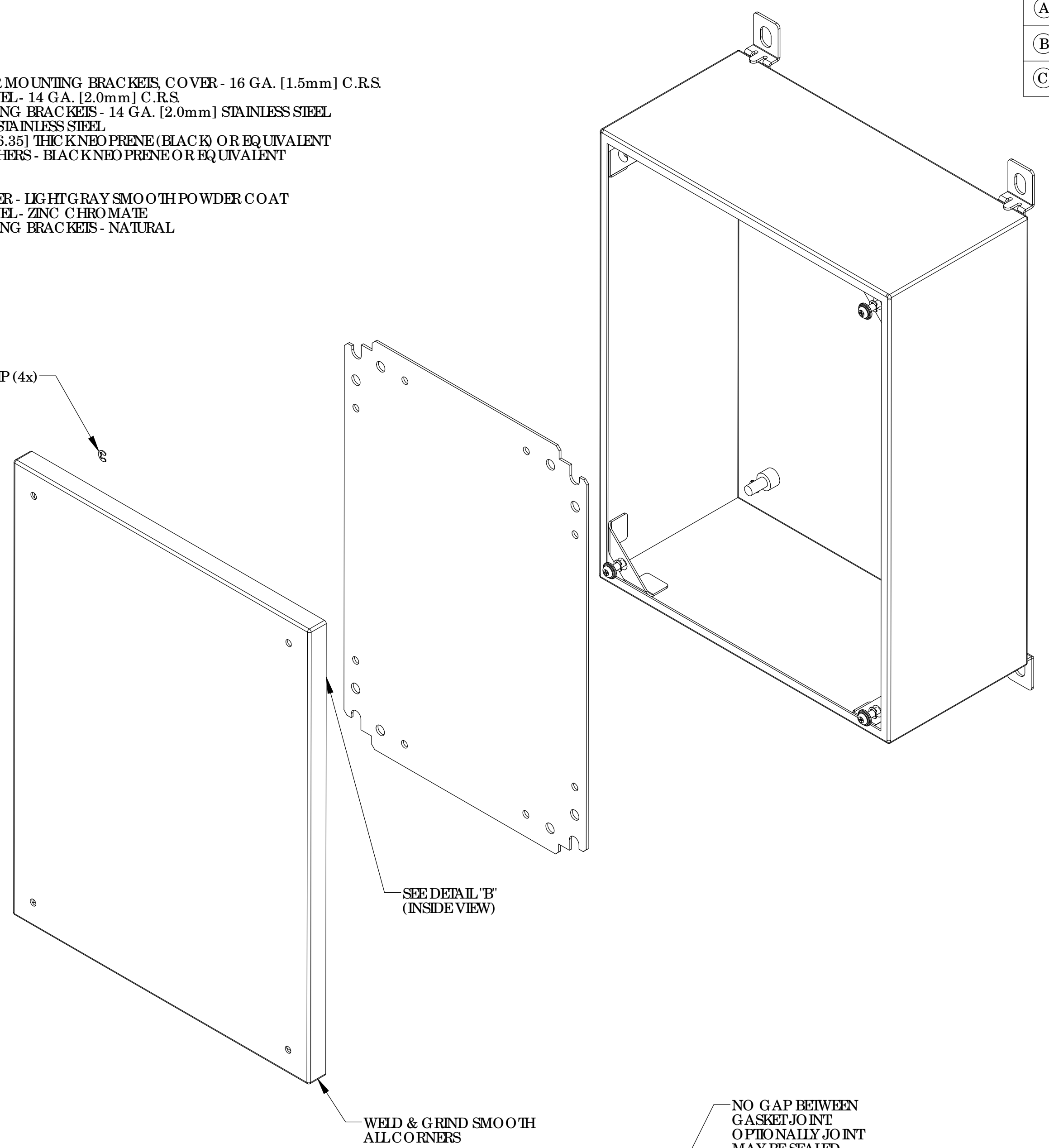
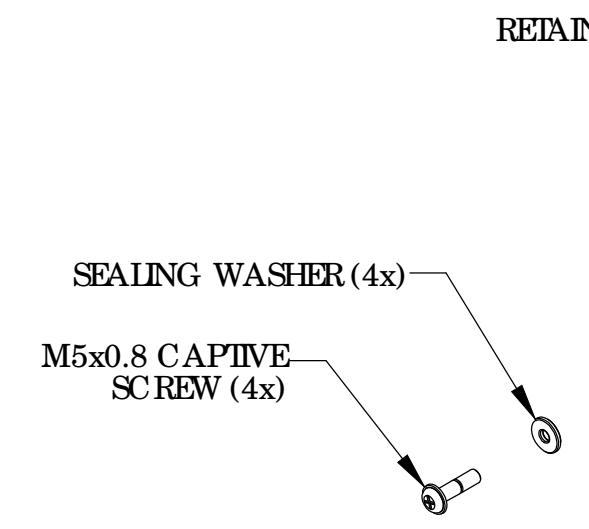

WALL MOUNTING BRACKET KIT TO CONTAIN THE FOLLOWING:
 (4) BRACKETS, (4) BOLTS, (4) SEALING WASHERS, (4) FLAT WASHERS, (4) LOCK WASHERS & (4) HEX NUTS

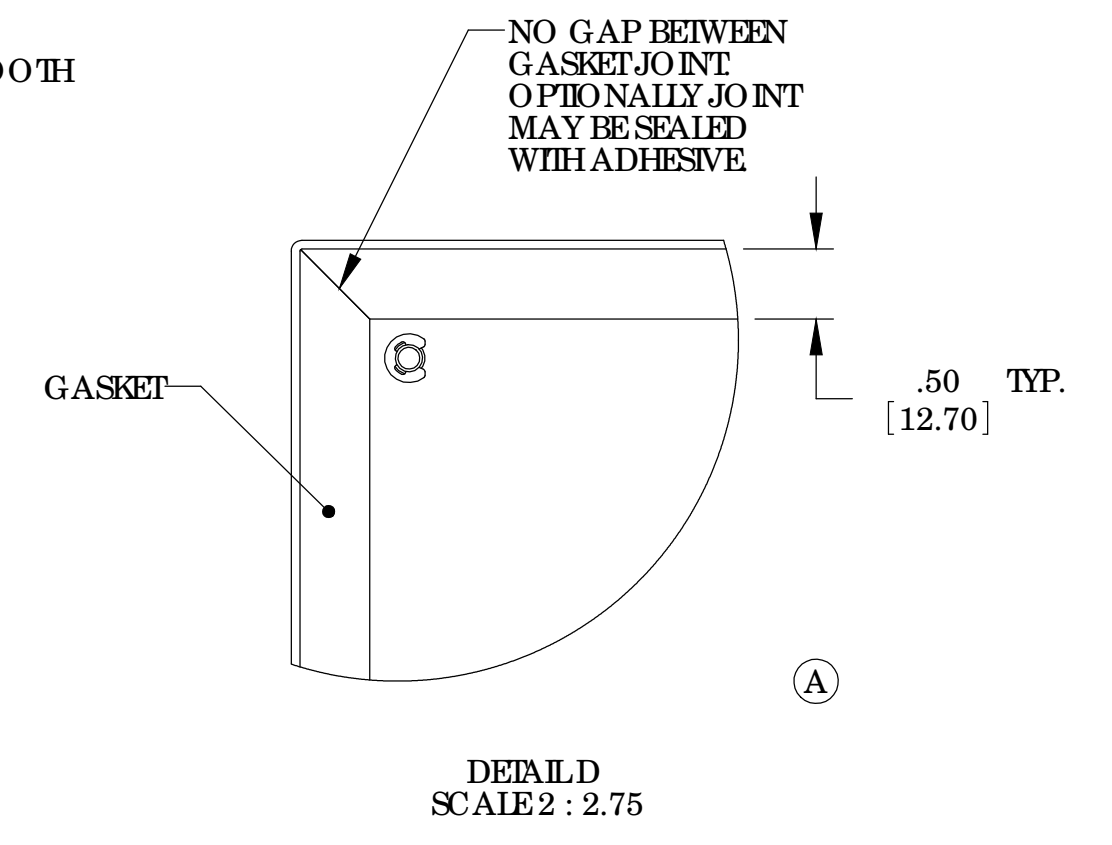
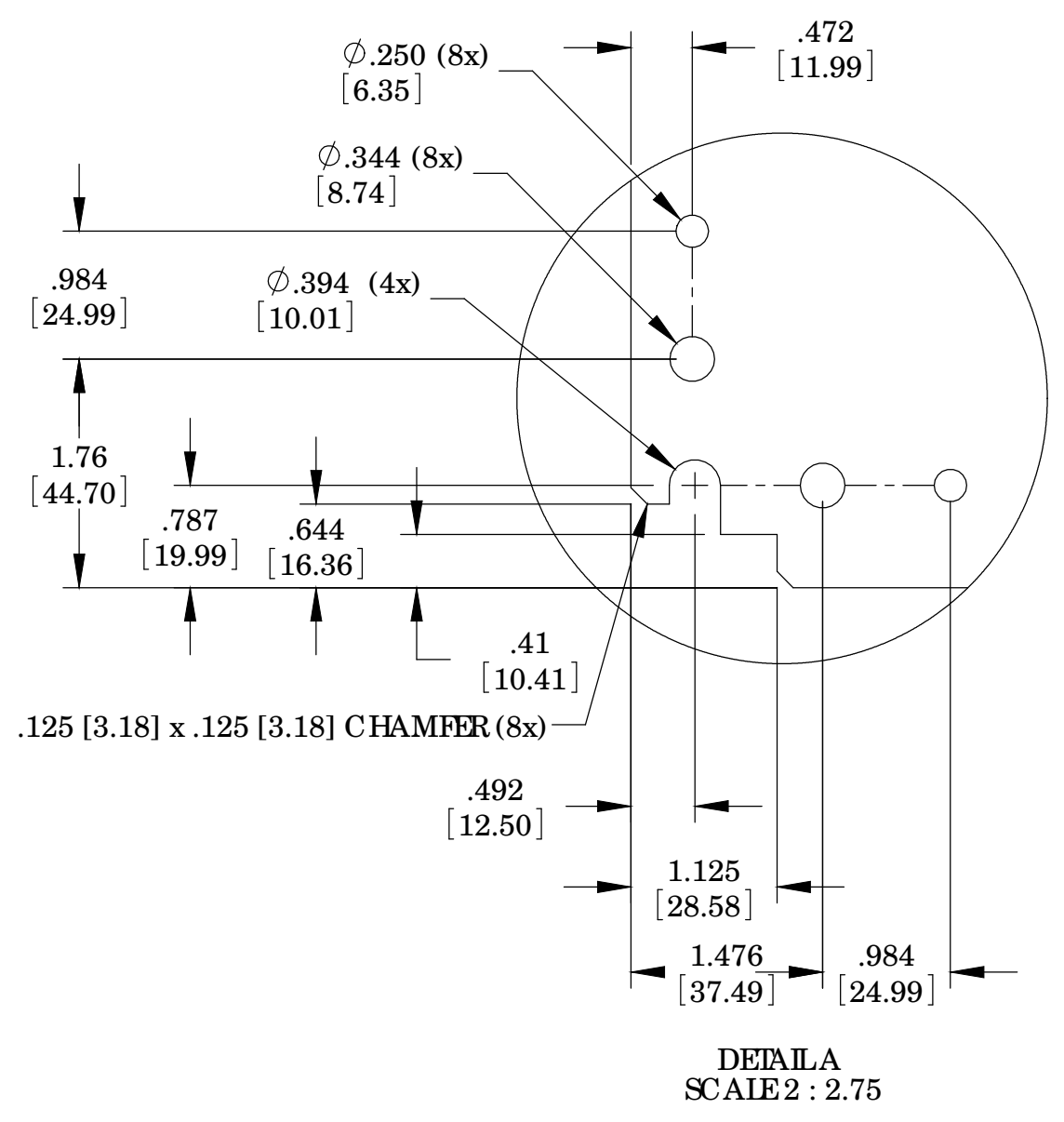
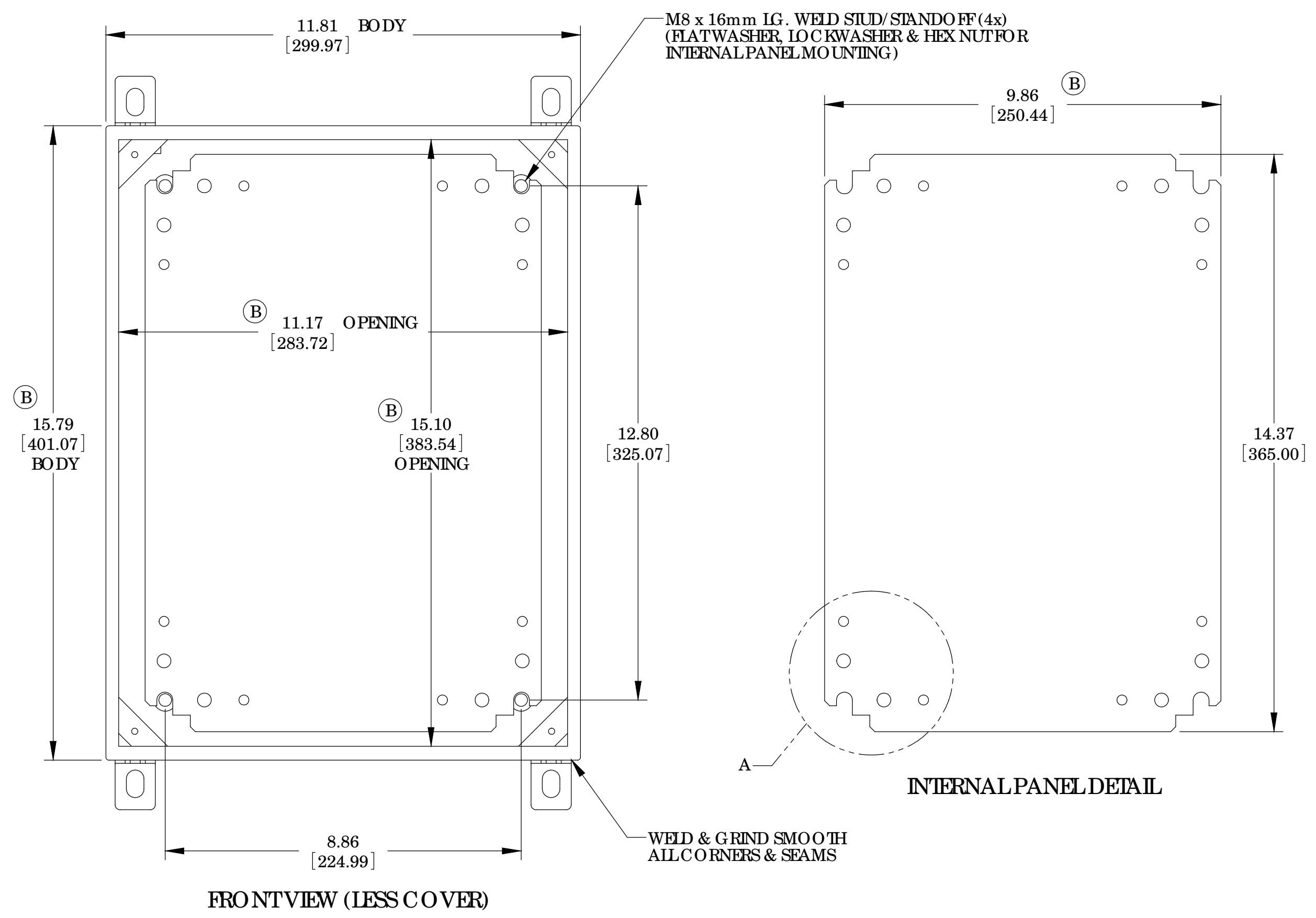

| PARTS LIST | |
|--|--|
| UNLESS OTHERWISE SPECIFIED ALL DIMENSIONS ARE IN INCHES AND DECIMALS THEREOF | CAD GENERATED DRAWING DO NOT MANUALLY UPDATE |
| APPROVALS | DATE |
| DAB | 5-5-08 |
| AS NOTED | |
| BUD INDUSTRIES INC. | |
| NEMA SHEET METAL BOX w/LIFT-OFF SCREW COVER | |
| REV | DATE |
| 1 | SNC-3755 |
| 2 | SCALE |